

CABLE GUARD RAIL REQUIRED
ON RIGHT
Sta. 69+00 to Sta. 72+60 Length 360ft.

WOOD GUANO RAIL REQUIRED
ON LEFT
Sta. 76+13 to Sta. 76+37 Length 24ft.
ON RIGHT
Sta. 76+13 to Sta. 76+37 Length 24ft.

NEW CULVERTS REQUIRED
Sta. 76+25 New 20" Corrug. Galv. Metal Pipe Length 32ft.
Concrete Class. 7(1-2-4)
Elongating Steel
28 cu yds.
54 lbs.

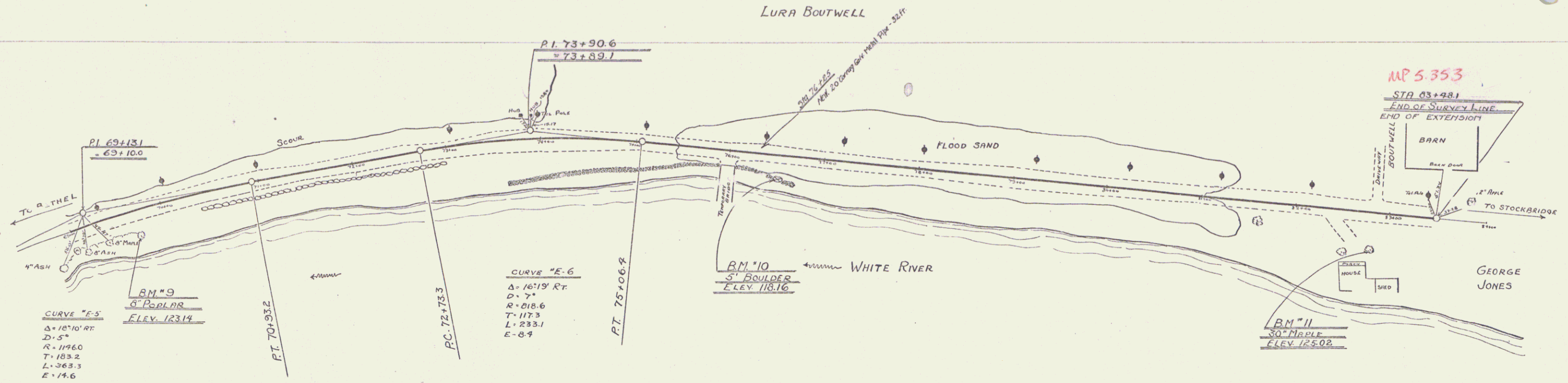

GRADE DESIGNED ON THIS SHEET FOR GRAVEL SURFACE ONLY ON ENVIRONMENT. THE BORDERS MUST THEREFORE BE OF GOOD MATERIAL, PREFERABLY TAKEN FROM THE RIVER BED.

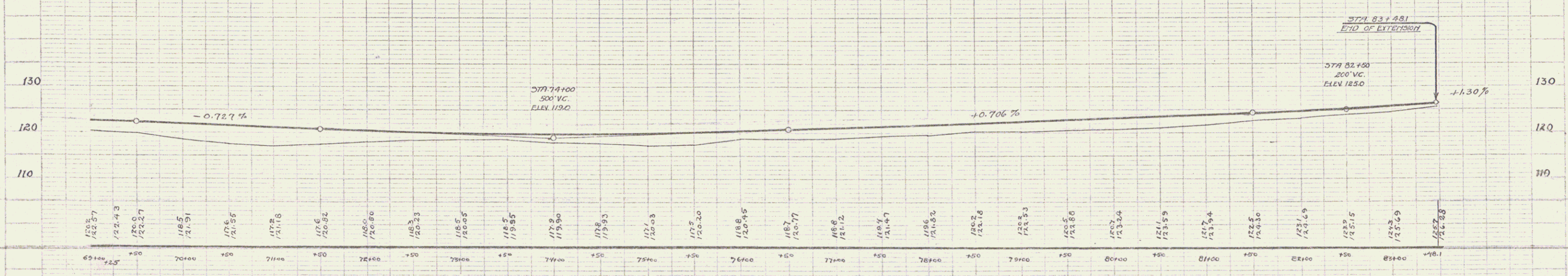

B.M. 9: SPIKE IN 8' POPLAR, RT. STA. 69+66 ~ ELEV. 123.14
B.M. 10: 5' BOULDER, RT. STA. 76+52 ~ ELEV. 118.16
B.M. 11: SPIKE IN 30' MAPLE, RT. STA. 82+77, ~ ELEV. 125.02

SERIES FR. N. 38
SHEET 3 OF
EXTENSION TOWARD STOCKBRIDGE