

SHEET NO.	TITLE PAGE
1	TITLE PAGE
2, 3, 4	TYPICAL CROSS-SECTION OF IMPROVEMENT
5, 6, 7	PLAN & PROFILE
8, 9	DRAINAGE DETAILS - PLAN & PROFILE
10	DETAILS OF GRAVITY WALL
10A	DETAILS OF PIPE RAIL
11	DETAILS OF CONCRETE BEAMS
12, 13, 14	DETAILS OF BRIDGE ABUTMENTS & STEEL SUPERSTRUCTURE
15	STD. STRUCTURE SHEET S.B.-11. BARRICADES, SIGNS, & LIGHTS (BR.)
16	" " " " S.B.-20. BRIDGE DETAILS 'C', 'E', 'F', & 'Gen. Notes'
17	" " " " S-28. PIPE CULVERTS.
18	" " " " S-30. C&M WALL, WOOD GUARD RAIL.
19	" " " " S-30A. BRICK CATCH BASINS, STD. UNDERDRAIN.
20	" " " " CONC. PAVES, CONC. CURBS & GUTTERS, CONC. S. L.M.M.
21	" " " " S-33. 7" CHD COURSE GEN. CONC. PAVT.
22	" " " " S-40. BARRICADES, SIGNS & LIGHTS (ROAD)
23-32	Cross Section Sheets.
33	Plan of False work (Not Erected by Contractor)

STANDARD STRUCTURE SHEETS,
APPROVED BY THE CHIEF ENGINEER:
S-28 July 11, 1933.
S-30 Aug 15, 1934.
S-31 July 23, 1934.

LIST OF SHEETS SHOWING LOCATIONS
OF PLACING SURPLUS MATERIAL:
SHEET No. 34-35 Layout
" " 36 Detail Sheet for 4'x6' Box
" " 37-43 Cross Section Sheets.

STATE OF VERMONT
STATE HIGHWAY DEPARTMENT

PLAN AND PROFILE OF PROPOSED
STATE HIGHWAY

F. A. G. H. PROJECT
101-D(1)

TOWN OF BETHEL

BETHEL-STOCKBRIDGE ROAD

UNDERPASS AND APPROACHES AT THE
INTERSECTION OF ROUTES 12 AND 107

BEGINNING ON MAIN STREET AT A POINT 1758.5 FEET SOUTH OF ITS INTERSECTION WITH CHURCH STREET AND EXTENDING SOUTH-WESTERLY ALONG RIVER STREET TO THE WHITE RIVER BRIDGE
ALSO EXTENDING SOUTHERLY 526.0 FT. ON MAIN STREET.

LENGTH OF MAIN ST. ----- 526.0 FT.
" A-LINE ----- 520.7 FT.
" B-LINE ----- 106.0 FT.
TOTAL LENGTH OF PROJECT --1152.7 FT. = 0.218 MILES. MP 3.451
" CONTRACT --1256.2 FT. = 0.237

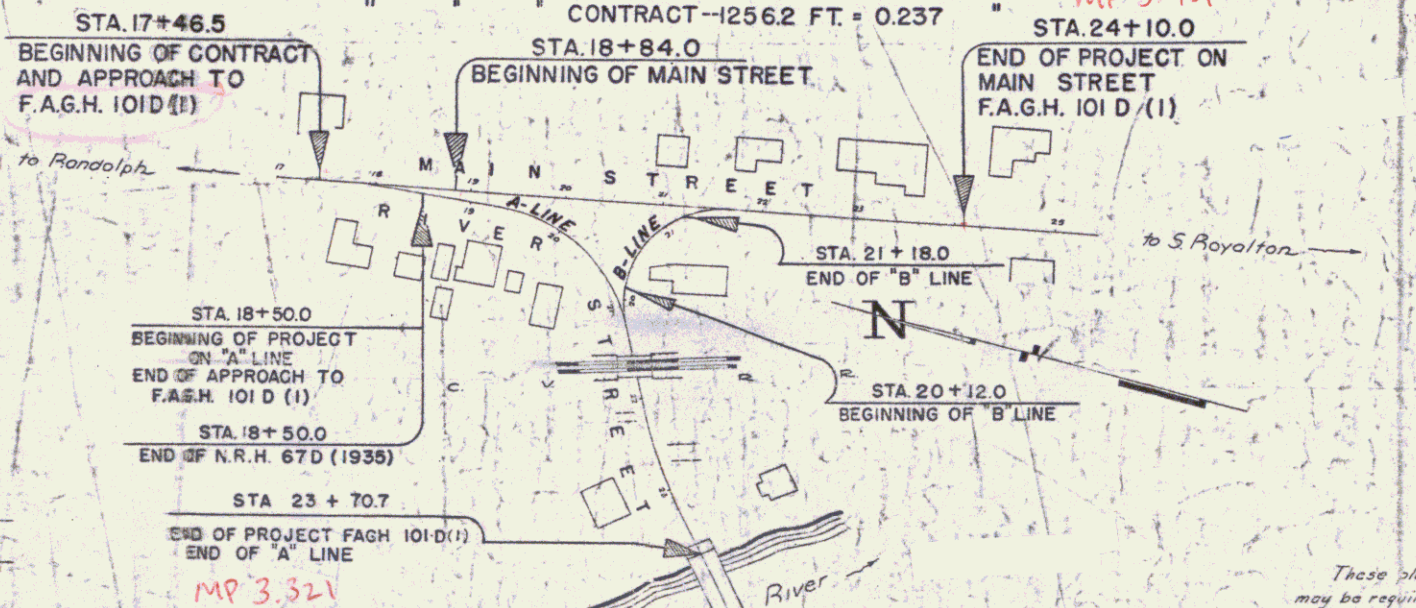

CONVENTIONAL SIGNS

- COUNTY LINE
- TOWN LINE
- FENCE LINE
- STONE WALL
- UNFENCED PROPERTY
- GUARD RAIL
- TRAVELED WAY
- RAILROAD
- RETAINING WALL
- CENTER LINE
- SURVEY LINE
- CULVERT
- DROP INLET
- TROLLEY POLE
- POWER POLE
- TELEPHONE POLE
- TREES
- HEDGE

GROUND ELEVATION. DATUM. FEET. LINE
GRADE ELEVATION. DATUM. FEET. LINE

CURVE DATA
DEFLECTION ANGLE. Δ
DEGREE OF CURVE. D
RADIUS OF CURVE. R
TANGENT DISTANCE. T
LENGTH OF CURVE. L
EXTERNAL DISTANCE. E
POINT OF INTERSECTION. P.I.
POINT OF CURVE. P.C.
POINT OF TANGENT. P.T.
POINT ON TANGENT. P.O.T.

S C A L E S

TITLE 1" = 100'
TYPICAL 1" = 2'
PLAN 1" = 20'
PROFILE HORIZ. 1" = 20'
VERT. 1" = 10'
CROSS-SECTIONS 1" = 5'
DRAINAGE LAYOUT 1" = 25'

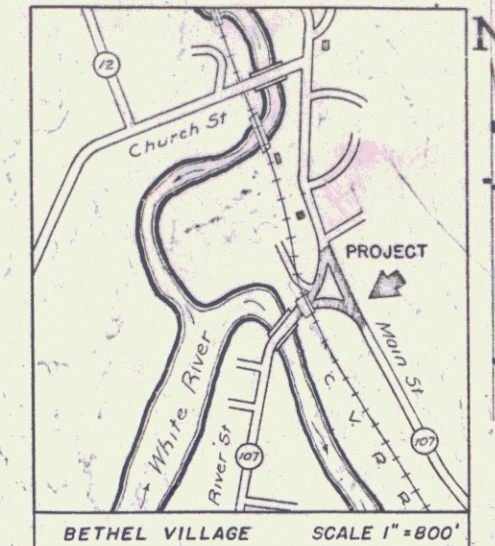

RIGHT-OF-WAY DIVISION
TOWN FILE
PERPETUAL
Town of Bethel
(To Be Returned To R.O.W. Division)

APPROVED: *[Signature]*
CHIEF ENGINEER
CENTRAL VERMONT RAILWAY INC.

APPROVED: *[Signature]*
OCT 2 1937
COMMISSIONER OF HIGHWAYS

SUBMITTED BY ORDER OF THE STATE HIGHWAY BOARD

Pin # 009015
Route VT 107
Date 9/22/1939

These plans are subject to such revisions as may be required by the Public Roads Administration or the Commissioner of Highways.
Construction is to be carried on in accordance with the plans and the Standard Road and Bridge Specifications of 1936, as approved December 29th, 1936, by the Public Roads Administration, including all subsequent approved revisions and such revised specifications and special provisions as are submitted with the plans.

APPROVED *[Signature]* 9-22-1939 BRIDGE ENGINEER
APPROVED *[Signature]* 9-22-1939 DISTRICT HIGHWAY COMMISSIONER
APPROVED *[Signature]* 9-22-1939 ROAD ENGINEER

RECOMMENDED FOR APPROVAL
DISTRICT ENGINEER
PUBLIC ROADS ADMINISTRATION
FEDERAL WORKS AGENCY
APPROVED
COMMISSIONER OF HIGHWAYS
PUBLIC ROADS ADMINISTRATION
FEDERAL WORKS AGENCY
SERIES F.A.G.H. NO. 101-D(1) REED
SHEET (1) OF 43