

THIS IS PART OF THE SAME LAND AND PREMISES ACQUIRED BY THE STATE OF VERMONT FROM FRANK M. & MARY M. ARNOLD BY WARRANTY DEED OF EASEMENT DATED SEPT. 2, 1958 AND RECORDED IN BOOK 41, PAGES 393A & 394; AND FROM FRANCIS A. DUVAL BY CONDEMNATION ORDER DATED JULY 21, 1958 AND RECORDED IN BOOK 41 PAGE 373; BOTH OF THE LAND RECORDS OF THE TOWN OF BETHEL.

MP 0167

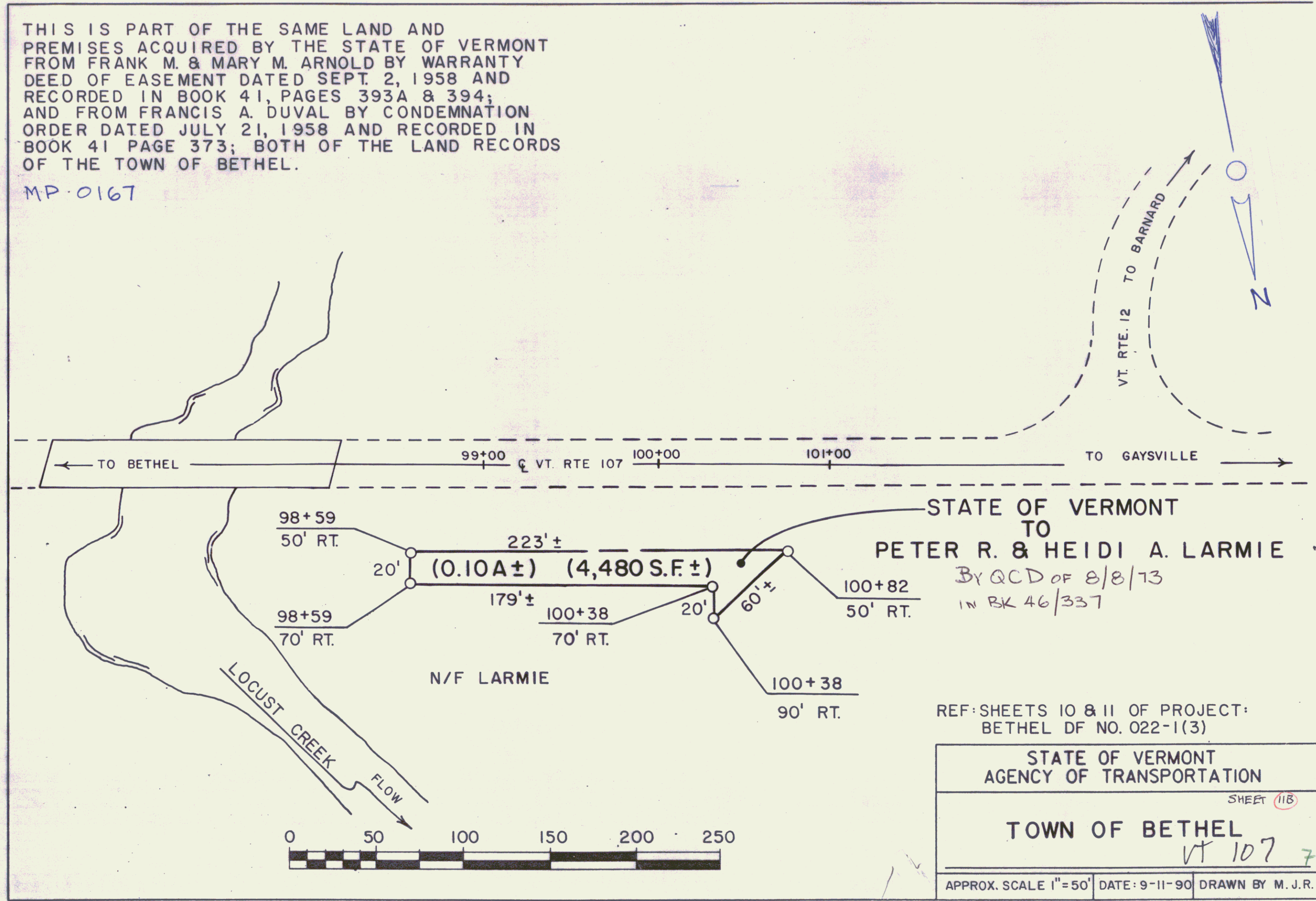

REF: SHEETS 10 & 11 OF PROJECT: BETHEL DF NO. 022-1(3)

STATE OF VERMONT AGENCY OF TRANSPORTATION		
SHEET 118		
TOWN OF BETHEL		
VT 107 7		
APPROX. SCALE 1"=50'	DATE: 9-11-90	DRAWN BY M. J. R.