

WOOD GUARD RAIL REQUIRED
 ON LEFT
 Sta. 9+00 to Sta. 9+60 Length 60 ft
 Sta. 7+70.7 to 8+00 Length 29.3 ft
 Sta. 10+21 10+45 Length 24 ft

CABLE GUARD RAIL REQUIRED
 ON RIGHT
 Sta. 0+00 to Sta. 11+00 Length 1100 ft
 3" x 3"

NEW CURBETS REQUIRED
 Sta. 7+50 20" Corrugated Metal Pipe Length 38 ft
 Concrete Class B (1-2 1/2") 2.5 cu yds
 Reinforcing Steel 31 lbs
 Sta. 10+30 18" CMP Length 59 ft
 Concrete Class B (1-2 1/2") 1.7 cu yds
 Reinforcing Steel 27 lbs

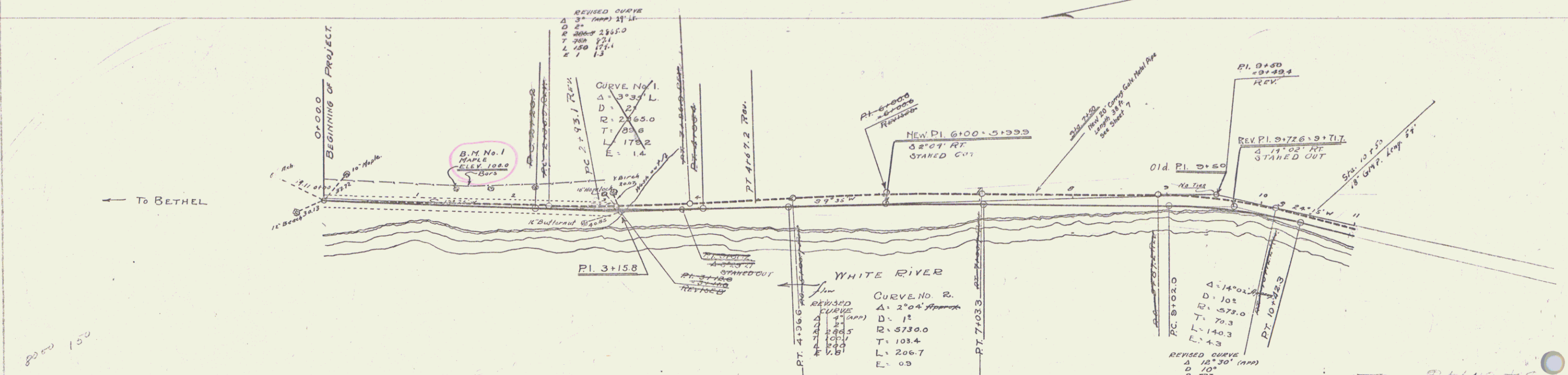

OFFSETS BETWEEN REVISED LINE AND STAKED OUT LINE

| STATION | OFFSETS |
|---------|---------|
| 0+00 | 0 |
| +30 | 1.0 LT |
| 1+00 | 2.0 LT |
| 2+00 | 3.0 LT |
| 3+00 | 4.0 LT |
| 4+00 | 5.0 LT |
| 5+00 | 6.0 LT |
| 6+00 | 6.0 LT |
| 7+00 | 11.0 LT |
| 8+00 | 11.0 LT |
| 9+00 | 11.0 LT |
| 10+00 | 11.0 LT |
| 11+00 | 11.0 LT |

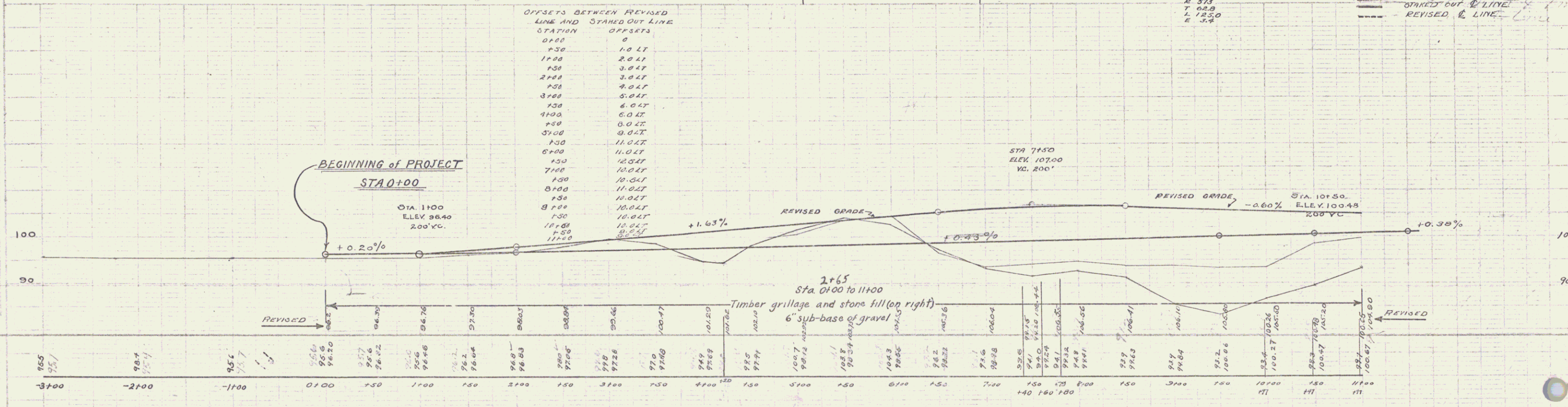

B.M. No. 1 Spike in Maple Left of Sta. 1+40 Elev 100.0

Series 101.C Sheet 3 of 24