

Item 549-A Removing + Resetting  
Two Cable Guard Rail.

Left	Right
Sta. 373+00 to Sta. 375+00	Sta. 374+78 to Sta. 373+48
Sta. 377+60 to Sta. 378+24	Sta. 375+32 to Sta. 375+96
Sta. 379+74 to Sta. 380+00	Sta. 377+74 to Sta. 380+00

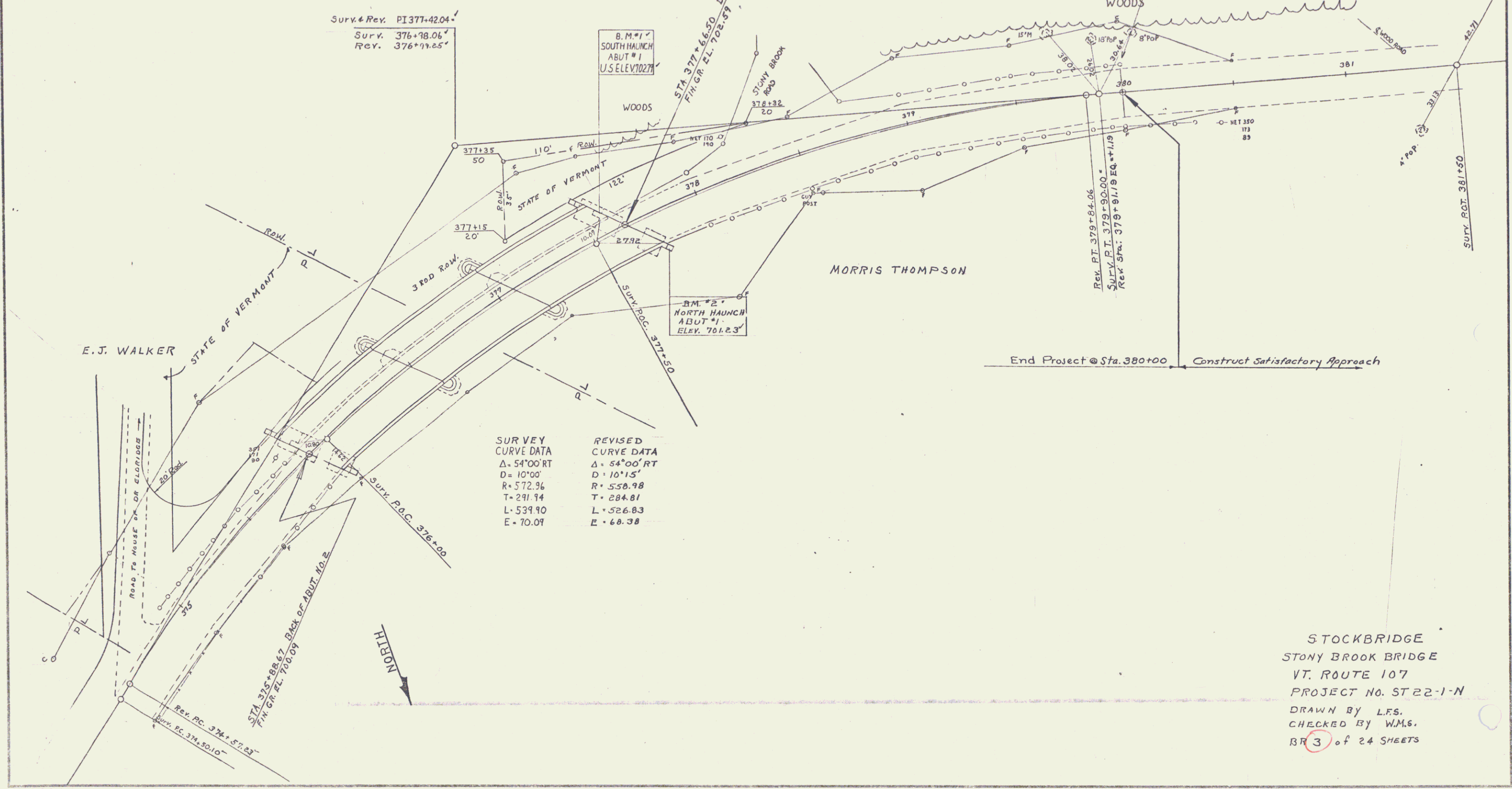

Surv. & Rev. PI 377+42.04  
Surv. 376+78.06  
Rev. 376+77.25

B.M. #1  
SOUTH HAUNCH  
ABUT #1  
U.S. ELEV. 702.77

B.M. #2  
NORTH HAUNCH  
ABUT #1  
ELEV. 701.23

SURVEY	REVISED
CURVE DATA	CURVE DATA
Δ = 54°00'RT	Δ = 54°00'RT
D = 10°00'	D = 10°15'
R = 572.96	R = 558.98
T = 291.14	T = 284.81
L = 539.90	L = 526.83
E = 70.09	E = 68.38

End Project @ Sta. 380+00 Construct Satisfactory Approach

STOCKBRIDGE  
STONY BROOK BRIDGE  
VT. ROUTE 107  
PROJECT NO. ST 22-1-N  
DRAWN BY L.F.S.  
CHECKED BY W.M.S.  
BR 3 of 24 SHEETS