

INDEX OF SHEETS

SHEET NO.	TITLE PAGE
1	TITLE PAGE
2-23	TYPICAL CROSS-SECTION OF IMPROVEMENT (1% CRUSHED GRAVEL PAVED-IN-PLACE SURFACE COURSE WITH RETAINED TRAFFIC ITEMS 25' & 30')
3	BANKING AND WIDENING TABLES
4-7	PLAN AND PROFILE SHEETS
8	DETAIL OF SPECIAL CURVE INLET
9	CONCRETE CURB AROUND D&P WILET
10	4' x 5' R.C. BOX STA 466 + 25
11	4' x 5' R.C. BOX STA 490 + 31
12	SUBSTRUCTURE SIGNS 45° SKEW (USE 3-84 SKEW)
13	APPOINTMENT DETAILS
14	PIER DETAILS
15	CABLE GUARD RAIL SB NO. 50
16	SB NO. 20, DETAILS 5103, 5107, 5109, 5112 & GENERAL NOTES
17	STANDARD STRUCTURE SHEET 329, PIPE CULVERTS
18	329, BOX
19	330, GUARD RAIL
20	331, BOUNDARY MARKERS
21	335, CONCRETE CROSSING
22	340, BARRICADES, SIGNS & LIGHTS
23-130	CROSS-SECTION SHEETS

Standard Structure Sheets approved by the Chief Engineer

529	July 11, 1933
529	July 11, 1933
530	July 15, 1934
531	July 25, 1934

STATE OF VERMONT  
STATE HIGHWAY DEPARTMENT

**VT. RTE. 107**

FED. ROAD DIST. NO.	STATE	FED. AID PROJ. NO.	FISCAL YEAR
B	VT	223	1937

PLAN AND PROFILE OF PROPOSED  
STATE HIGHWAY  
FEDERAL AID PROJECT

**TOWN OF STOCKBRIDGE**  
BETHEL - RUTLAND ROAD

BEGINNING AT A POINT 0.523 MILES FROM THE WEST END OF STONEY BROOK BRIDGE AND EXTENDING WESTERLY 3.316 MILES TO A POINT 1.277 MILES EAST OF THE STOCKBRIDGE - PITTSFIELD TOWN LINE.

LENGTH OF ROADWAY 17,257.9 FT. = 3.268 MILES  
LENGTH OF BRIDGE 252.0 FT. = 0.048 MILES  
TOTAL LENGTH OF PROJECT 17,509.9 FT. = 3.316 MILES

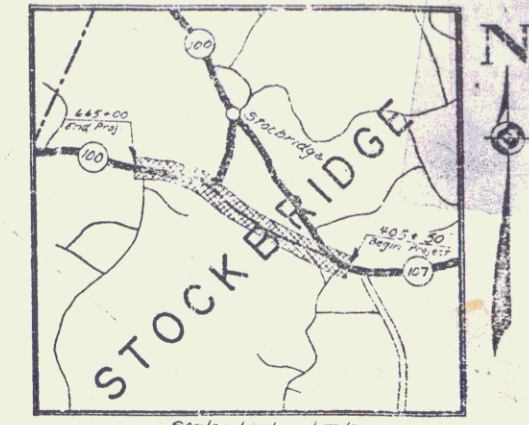

(To Be Returned to E.O.W. Division)  
Town of **VT 107**  
PERPETUAL  
E I I A N M O E  
NOISIAID AVA-MO-LHGIN

Project FAP 223  
Pin # 00R006  
Route VT107  
Date 6/7/1937

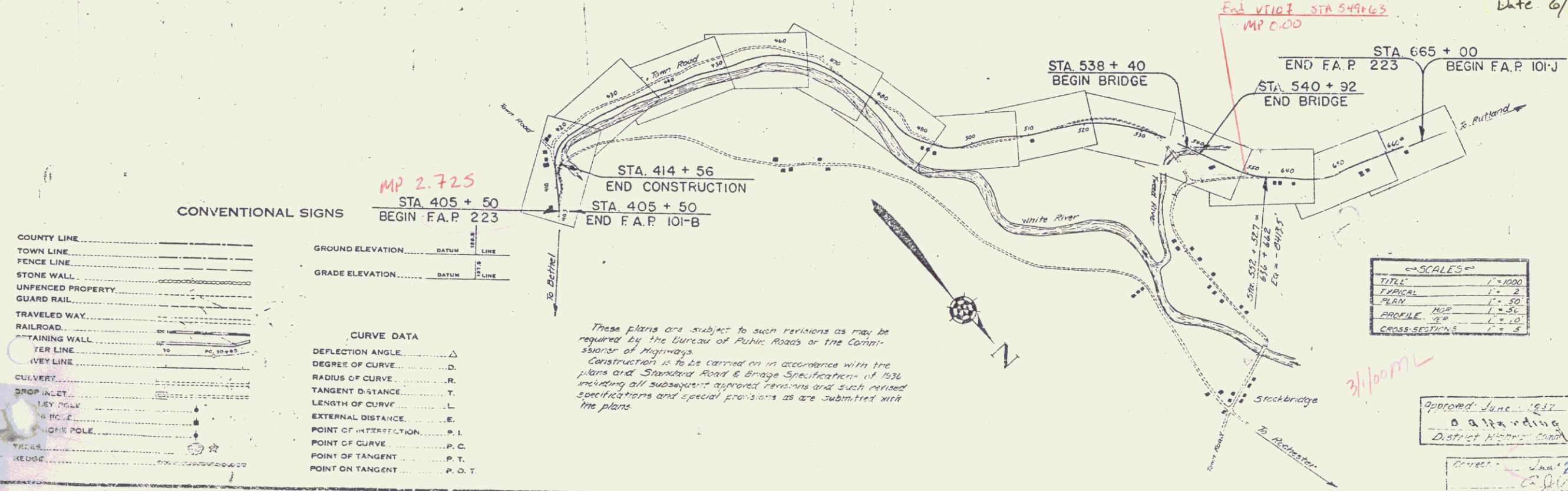

CONVENTIONAL SIGNS

COUNTY LINE	GROUND ELEVATION	DATE	LINE
TOWN LINE	GRADE ELEVATION	DATE	LINE
FENCE LINE			
STONE WALL			
UNFENCED PROPERTY			
GUARD RAIL			
TRAVELED WAY			
RAILROAD			
RETAINING WALL			
TRAIL LINE			
VEGETATION			
CULVERT			
DROP INLET			
KEY POLE			
WIRE POLE			
TRAIL			
KEDGE			

CURVE DATA

DEFLECTION ANGLE	Δ
DEGREE OF CURVE	D
RADIUS OF CURVE	R
TANGENT DISTANCE	T
LENGTH OF CURVE	L
EXTERNAL DISTANCE	E
POINT OF INTERSECTION	P. I.
POINT OF CURVE	P. C.
POINT OF TANGENT	P. T.
POINT ON TANGENT	P. O. T.

APPROVED: June 10, 1937  
H.E. Sargent  
COMMISSIONER OF HIGHWAYS  
SUBMITTED BY ORDER OF THE STATE HIGHWAY BOARD

SCALES

TITLE	1" = 1000'
PLAN	1" = 20'
PROFILE	1" = 10'
CROSS-SECTION	1" = 2'

Approved June 1937  
O. A. Harding  
District Highway Engineer

Approved Jan 2, 1937  
C. O. Brown  
District Highway Engineer

SERIES F NO. 20 P. 100  
SHEET 1 OF 100  
DIST. #4 PLANS

VT 107