

STATE OF VERMONT
AGENCY OF TRANSPORTATION

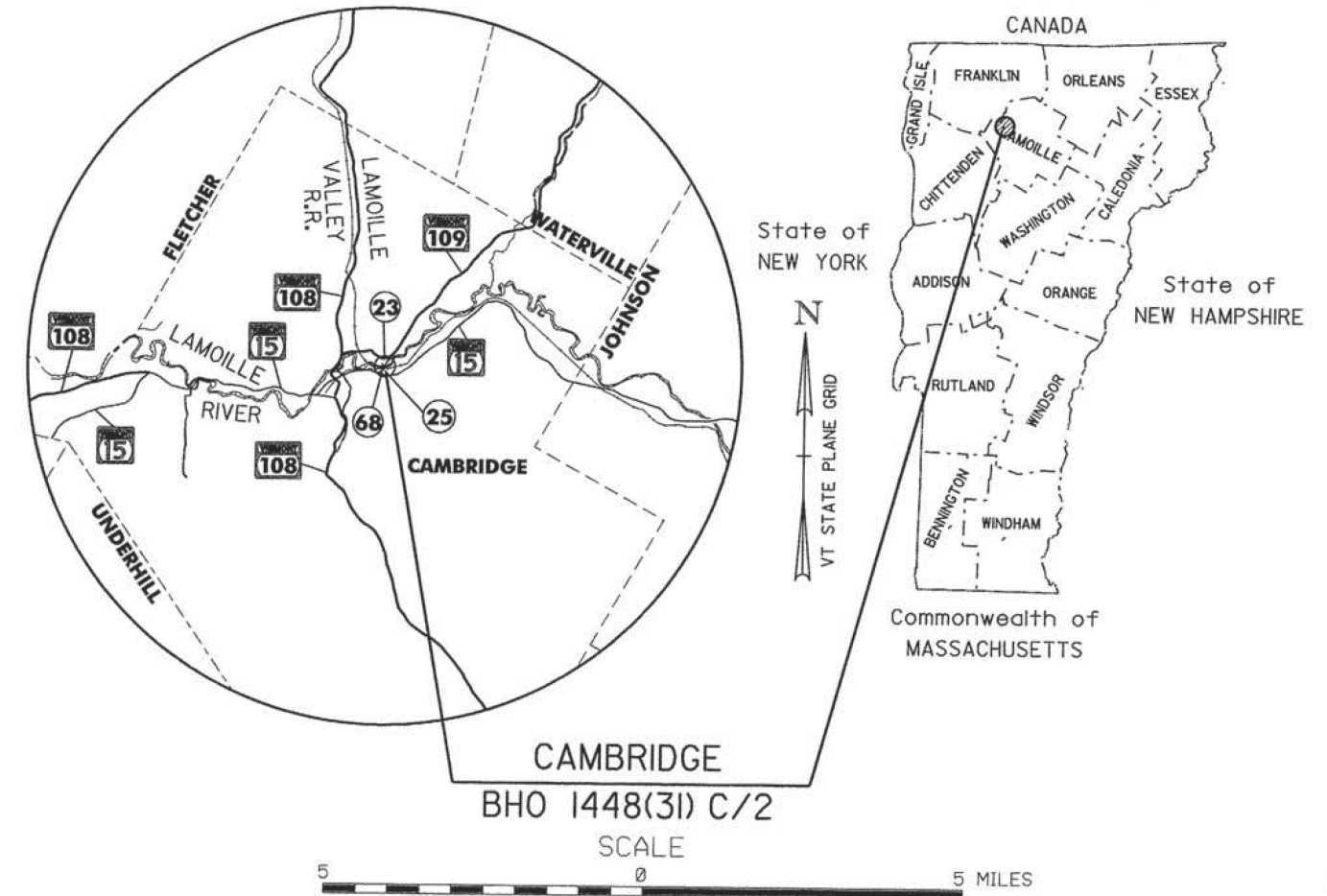

PROPOSED IMPROVEMENT
BRIDGE PROJECT
TOWN OF CAMBRIDGE
COUNTY OF LAMOILLE
ROUTE NO.: TH 23, CLASS 3; BRIDGE NO.: 29



R. O. W. PLANS

PROJECT LOCATION

BEGINNING AT A POINT APPROXIMATELY 475 FT NORTHERLY OF THE INTERSECTION OF TH 23 AND VT 15 AND EXTENDING NORTHERLY ALONG TH 23 FOR DISTANCE OF 446 FT.

STRUCTURE LENGTH: 155.14 FEET
ROADWAY LENGTH: 290.86 FEET
PROJECT LENGTH: 446 FEET
LENGTH OF ROW PROJECT: 79 FEET

PROJECT DESCRIPTION

WORK TO BE PERFORMED UNDER THIS PROJECT CONSISTS OF THE REHABILITATION OF THE CAMBRIDGE JUNCTION COVERED BRIDGE AND ANY ASSOCIATED APPROACH WORK.

BEGIN R. O. W. PROJECT
BHO 1448(31) C/2
STA. 10+94 16.5' LT.

END R. O. W. PROJECT
BHO 1448(31) C/2
STA. 11+73 29' RT.

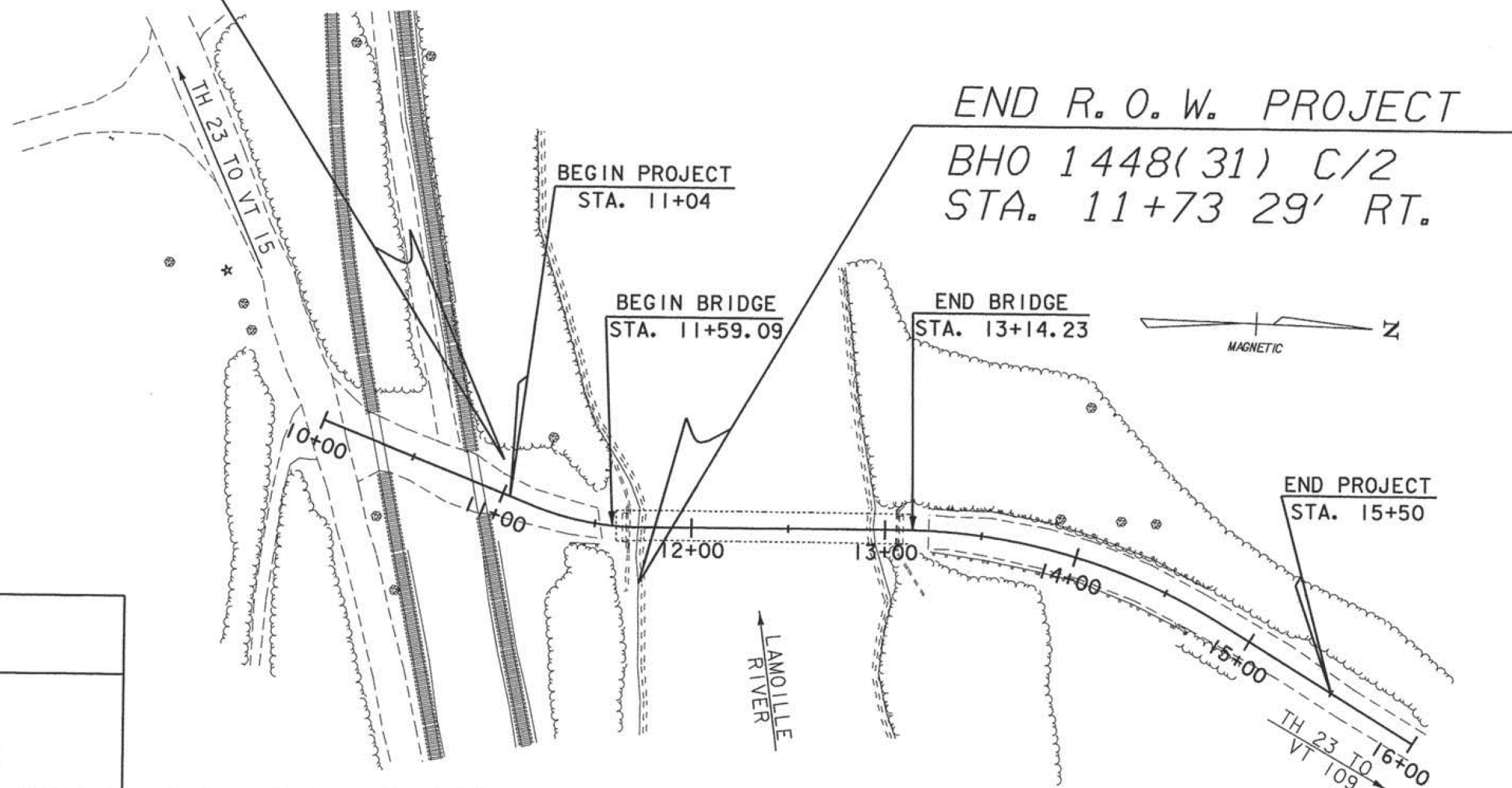

CONVENTIONAL SYMBOLS

COUNTY LINE	
TOWN LINE	
LIMITS OF ACCESS	
POINT OF ACCESS	
FENCE LINE	
STONE WALL	
TRAVELED WAY	
GUARD RAIL	
RAILROAD	
SURVEY LINE	
CULVERT	
POWER POLE	
TELEPHONE POLE	
TREES	
CONTROL OF ACCESS	
PROPERTY LINE	
R.O.W. TAKING LINE	
SLOPE RIGHTS	
TOP OF CUT	
TOE OF SLOPE	

SURVEYED BY : L. ORVIS
SURVEYED DATE : 1/2001

DATUM
VERTICAL NAVD 88
HORIZONTAL NAD 83 (92)

SCALE 1" = 50'-0"

THESE PLANS ARE SUBJECT TO SUCH ENGINEERING CHANGES AS MAY BE REQUIRED BY THE FEDERAL HIGHWAY ADMINISTRATION OR THE DIRECTOR OF PROJECT DEVELOPMENT.
CONSTRUCTION IS TO BE CARRIED ON IN ACCORDANCE WITH THESE PLANS AND THE STANDARD SPECIFICATIONS FOR CONSTRUCTION DATED 2001, AS APPROVED BY THE FEDERAL HIGHWAY ADMINISTRATION ON JANUARY 4, 2001 FOR USE ON THIS PROJECT, INCLUDING ALL SUBSEQUENT REVISIONS AND SUCH REVISED SPECIFICATIONS AND SPECIAL PROVISIONS AS ARE INCORPORATED IN THESE PLANS.

/00J244/str/sj244bdr.dgn sj244112.j

APPROVED DATE 12/12/01
Director of Project Development

APPROVED DATE 12/12/01
Chief of Right of Way

CAMBRIDGE
BHO 1448(31) C/2
R.O.W. SHEET 1 OF 6 SHEETS

BEGIN R. O. W. PROJECT
 BHO 1448(31) C/2
 STA. 10+94 16.5' LT.

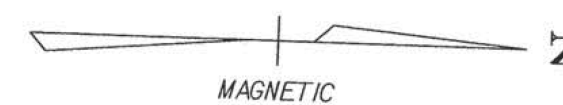

STATE OF VERMONT
 JOINED BY
 LAMOILLE VALLEY
 RAILROAD COMPANY



CURVE DATA
 $\Delta = 21^{\circ} 36' 49.7''$ LT
 $D = 38^{\circ} 00' 00.00''$
 $R = 150.78'$
 $T = 28.78'$
 $L = 56.88'$
 $E = 27.2'$
 BANK = NORMAL CROWN

EXEMPT

EXEMPT

BEGIN BRIDGE
 STA. 11+59.09

END BRIDGE
 STA. 13+14.23

BEGIN PROJECT
 STA. 11+04

END PROJECT
 STA. 15+50

MAINLINE STA. 13+00 =
 CHANNEL LINE STA. 100+00
 DELTA = 90°

CURVE DATA
 $\Delta = 31^{\circ} 34' 02.87''$ RT
 $D = 18^{\circ} 00' 00.00''$
 $R = 318.31'$
 $T = 89.98'$
 $L = 175.37'$
 $E = 12.47'$
 BANK = NORMAL CROWN
 ϕ TEL #2/1/2

END R. O. W. PROJECT
 BHO 1448(31) C/2
 STA. 11+73 29' RT.

POB
 Sta 98+50.00

POE STA 15+99.54

LINES SHOWN ON THIS PLAN AS EXISTING
 PROPERTY LINES P/L ARE BELIEVED TO
 BE ACCURATE BUT SHOULD NOT BE RELIED
 UPON FOR PURPOSES UNRELATED TO THE
 TOWN OF CLARENDON'S ACQUISITION OF LAND
 AND RIGHTS FOR THIS PROJECT.

SCALE 1" = 20'-0"
 20 0 20

LAYOUT SHEET

PROJECT NAME: CAMBRIDGE	PLOT DATE: 23-JAN-2002
PROJECT NUMBER: BHO 1448(31) C/2	DRAWN BY: R. PELLETT
FILE NAME: /00J244/s+r/sj244bdr.dgn	CHECKED BY: M. FOWLER
PROJECT LEADER: D. HOYNE	R. O. W. SHEET 6 OF 6
DESIGNED BY: M. FOWLER	