

\*Excluding Scuppers & Bearing Devices

DETAIL OF PARTIAL PARABOLIC CROWN OF SLAB

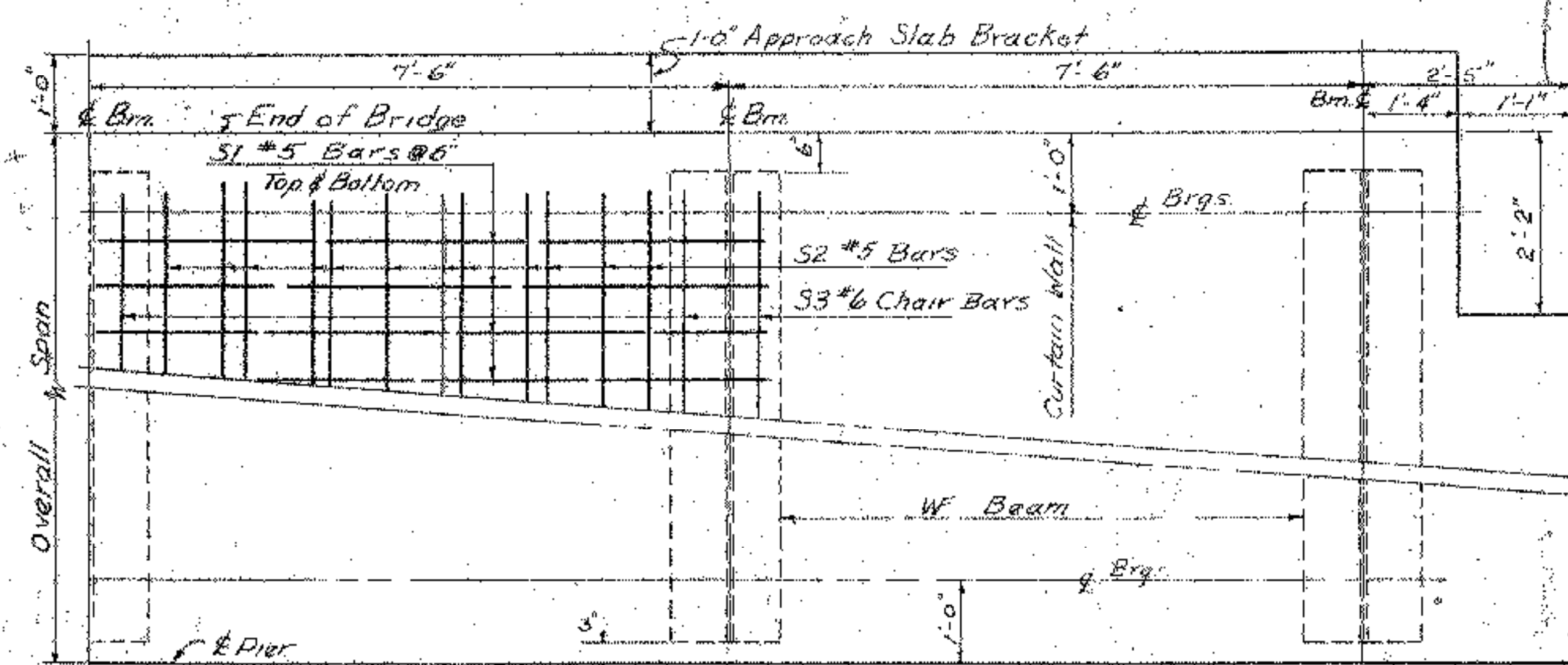

HALF PLAN

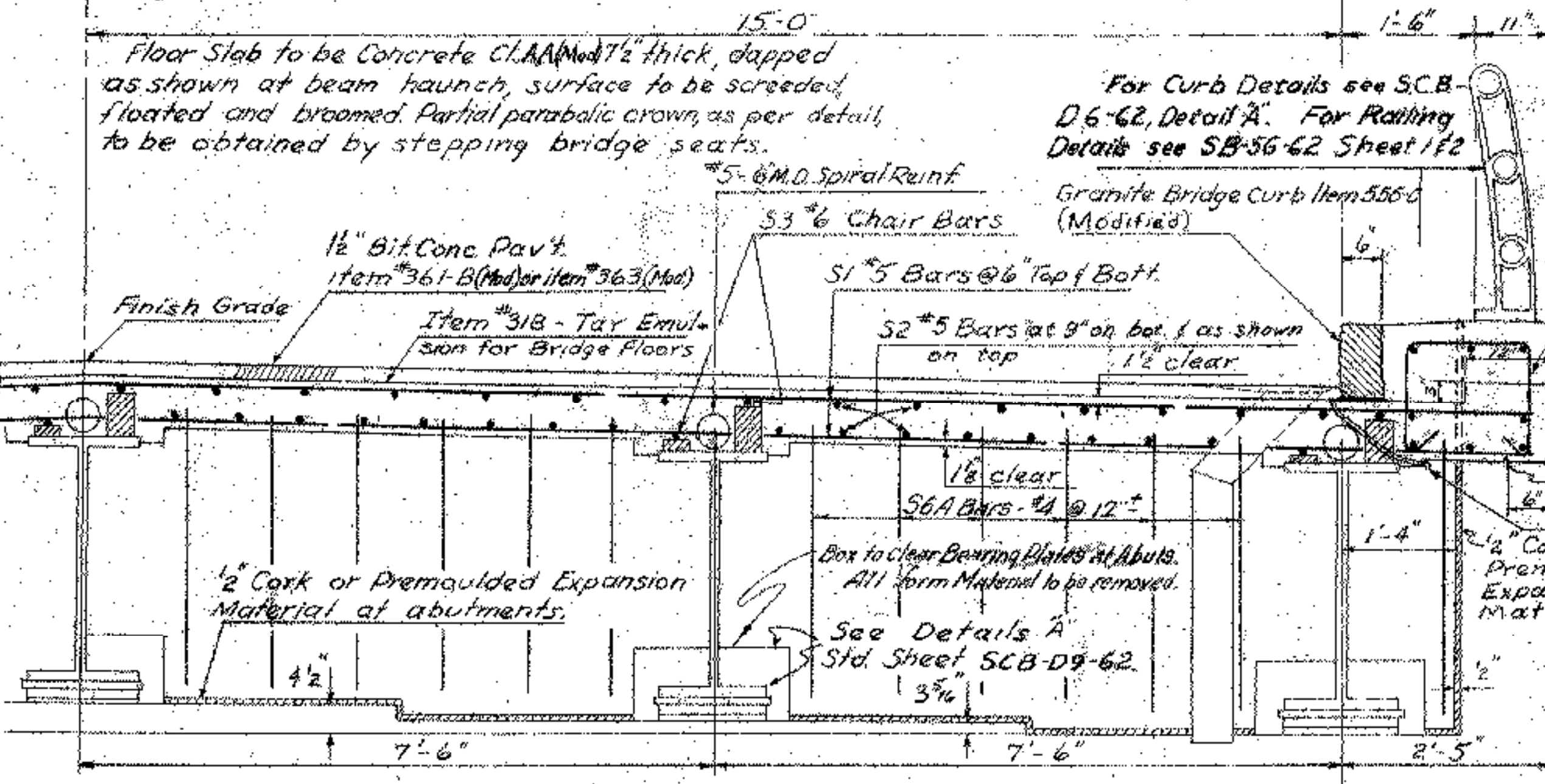

TYPICAL HALF SECTION

Span, Out to Out	99-0	91-0	89-0	84-0	79-0	74-0	69-0	64-0	59-0	54-0	49-0	44-0	39-0	34-0
Span, E to E Brngs.	97-0	92-0	87-0	82-0	77-0	72-0	67-0	62-0	57-0	52-0	47-0	42-0	37-0	32-0
Length of Bms.	98-0	93-0	88-0	83-0	78-0	73-0	68-0	63-0	58-0	53-0	48-0	43-0	38-0	33-0
Size W Beam	36WF280	36WF245	36WF230	36WF230	36WF194	36WF170	36WF150	36WF135	36WF135	36WF135	36WF135	36WF135	36WF118	30WF108
Lght # Size Cover (Bottom only)	6 1/2" x 7 1/2"	6 1/2" x 7 1/2"	5 1/2" x 7 1/2"	4 1/2" x 7 1/2"	4 1/2" x 7 1/2"	4 1/2" x 7 1/2"	4 1/2" x 7 1/2"	4 1/2" x 7 1/2"	4 1/2" x 7 1/2"	4 1/2" x 7 1/2"	4 1/2" x 7 1/2"	4 1/2" x 7 1/2"	4 1/2" x 7 1/2"	4 1/2" x 7 1/2"
Dead Load Deflection	3 1/2"	3 1/2"	2 1/2"	2 1/4"	1 1/2"	1 1/2"	1 1/2"	1 1/2"	1 1/2"	1 1/2"	1 1/2"	1 1/2"	1 1/2"	1 1/2"
Dia. of Spiral Bars							5"	5"	5"	5"	5"	5"	5"	5"
Mean Dia. of Spiral							6"	6"	6"	6"	6"	6"	6"	6"
Spiral Pitch @ 10' from Brng.	Double @ 5 1/2"	Double @ 5 1/2"	Double @ 5 1/2"	Double @ 5 1/2"	Double @ 5 1/2"	Double @ 5 1/2"	Double @ 5 1/2"	Double @ 5 1/2"	Double @ 5 1/2"	Double @ 5 1/2"	Double @ 5 1/2"	Double @ 5 1/2"	Double @ 5 1/2"	Double @ 5 1/2"
" 10' 20' or E Span	Double @ 6 1/2"	Double @ 6 1/2"	Double @ 6 1/2"	Double @ 6 1/2"	Double @ 6 1/2"	Double @ 6 1/2"	Double @ 6 1/2"	Double @ 6 1/2"	Double @ 6 1/2"	Double @ 6 1/2"	Double @ 6 1/2"	Double @ 6 1/2"	Double @ 6 1/2"	Double @ 6 1/2"
" 20' 30' or E Span	4"	4"	4 1/2"	4 1/2"	4 1/2"	4 1/2"	4 1/2"	4 1/2"	4 1/2"	4 1/2"	4 1/2"	4 1/2"	4 1/2"	4 1/2"
" 30' 40' or E Span	5"	5"	5"	6"	6"	6"	6"	5"	5 1/2"	6"	6"	6"	6"	6"
" 40' E Span	6 1/2"	6 1/2"	6"	6"										
*Tot Struct Steel (Ispan) (lbs.)	169,590	145,670	126,840	112,050	92,150	76,670	62,740	52,610	45,490	41,150	35,830	32,390	28,240	29,280
Reinforcing Bars - S1	396	376	356	336	316	296	276	256	236	216	196	176	156	136
" - S2	225	225	225	225	225	225	225	150	150	150	150	150	150	150
" - S3	90	90	90	90	90	90	90	20	20	20	20	20	20	20
" - S4	132	126	120	112	106	100	92	86	80	72	66	60	52	46
" - S5	16	16	16	16	16	16	16	16	16	16	16	16	16	16
" - S6A	52	52	52	52	52	52	52	52	52	52	52	52	52	52
" - S7	44	44	44	44	44	44	44	44	44	44	44	44	44	44
Tot Weight - Reinf. Bars (lbs.)	25,300	24,100	22,900	21,700	20,400	19,300	18,000	16,600	15,400	14,200	13,000	11,800	10,600	9,200
Approx Wt Spiral Reinf. (lbs.)	2,580	2,550	2,380	2,190	2,160	2,040	1,990	1,860	1,700	1,560	1,440	Non Composite	Non Composite	Non Composite
Tot Cyls. Conc. Class AA' (cu yds)	116	111	106	101	95	90	85	79	73	68	63	58	52	45
Tot Wt. Bottom Conc. Pavt. (tons)	32	30	29	27	26	24	22	21	19	18	16	15	13	12
Tar Emulsion for Bridge Floors (gals)	132	125	119	112	105	99	92	85	79	72	65	59	52	45
Approx Quantity #4 x 7 Studs	3180	3120	2940	2680	2640	2500	2440	2280	2120	1900	1760	Non Composite	Non Composite	Non Composite
Approx Quantity #6 x 7 Studs	2,110	2,080	1,960	1,790	1,760	1,670	1,630	1,520	1,410	1,270	1,170	Non Composite	Non Composite	Non Composite

Span	S1-#5 34'-4" Straight	S2-#5 33'-6" Straight	S3-#6 33'-6" Straight	S6A-#4 2'-6" Total Length	S4-#4 T.L. = 5'-3" B = 1'-6" D = 1'-6" C = 1'-5"	S6A-#4 T.L. Varies A-5" G-5" A-5" G-5" C-8" D-10"
34	33'-6"	33'-6"	2'-6"	6'-6"		
39	20'-3"	20'-6"	2'-9"	7'-0"		
44	22'-9"	23'-0"	3'-0"	7'-6"		
49	25'-3"	25'-6"	3'-0"	7'-6"		
54	27'-9"	28'-0"	3'-0"	7'-6"		
59	30'-3"	30'-6"	3'-0"	7'-6"		
64	32'-9"	33'-0"	3'-0"	7'-6"		
69	24'-3"	24'-6"	3'-2"	7'-10"	A-5" G-5"	C-8"
74	26'-0"	26'-3"	3'-2"	7'-10"	S7-#6	S6P-#5
79	27'-6"	28'-0"	3'-3"	8'-0"	T.L. = 3'-0"	T.L. = 4'-2"
84	29'-3"	29'-6"	3'-3"	8'-0"	B = 1'-8"	B = 2'-6"
89	31'-0"	31'-3"	3'-3"	8'-0"	J-6"	C-8"
94	32'-6"	33'-0"	3'-4"	8'-2"		
99	34'-3"	34'-6"	3'-4"	8'-2"	A-8" G-8"	D-10"

Revisions & Corrections

Drawn By: R.S.H. June 1960  
 Traced By: R.S.H. June 1960  
 Checked By: R.T.B. & R.S.H. July 1960

Recommended For Approval: [Signature] 11/62  
 Recommended For Approval: [Signature] 11/62  
 Approved By: [Signature] 11/62

TYPICAL SECTION, PLAN VIEW, & QUANTITIES  
 30 FOOT ROADWAY W/ BEAM BRIDGES  
 DESIGN LOADING - H-20-S16-44 (A.S.T.M. - A36-62T STEEL)  
 34-44 NON COMPOSITE, 49-99 COMPOSITE  
 FOR ADDITIONAL DETAILS SEE STANDARD SCB-D-62

DEPARTMENT OF HIGHWAYS  
 STANDARD STRUCTURES  
**SCB-30-62**