

Begin Bridge  
Back of Abut #1  
Sta. 422+75.00  
Fn. Gr. 489.29  
Fixed End.

Begin Approach Slab #1  
Sta. 422+60.67  
Fn. Gr. 487.01

Pier #1  
Sta. 423+49  
Fn. Gr. 492.84

Pier #2  
Sta. 424+28  
Fn. Gr. 491.51

Pier #3  
Sta. 424+82  
Fn. Gr. 500.30

Pier #4  
Sta. 425+76  
Fn. Gr. 504.37

End Approach Slab #2  
Sta. 427+14.29  
Fin. Grade 508.54

End Bridge  
Back of Abut #2  
Sta. 426+70.00  
Fn. Gr. 507.44  
Exp. End

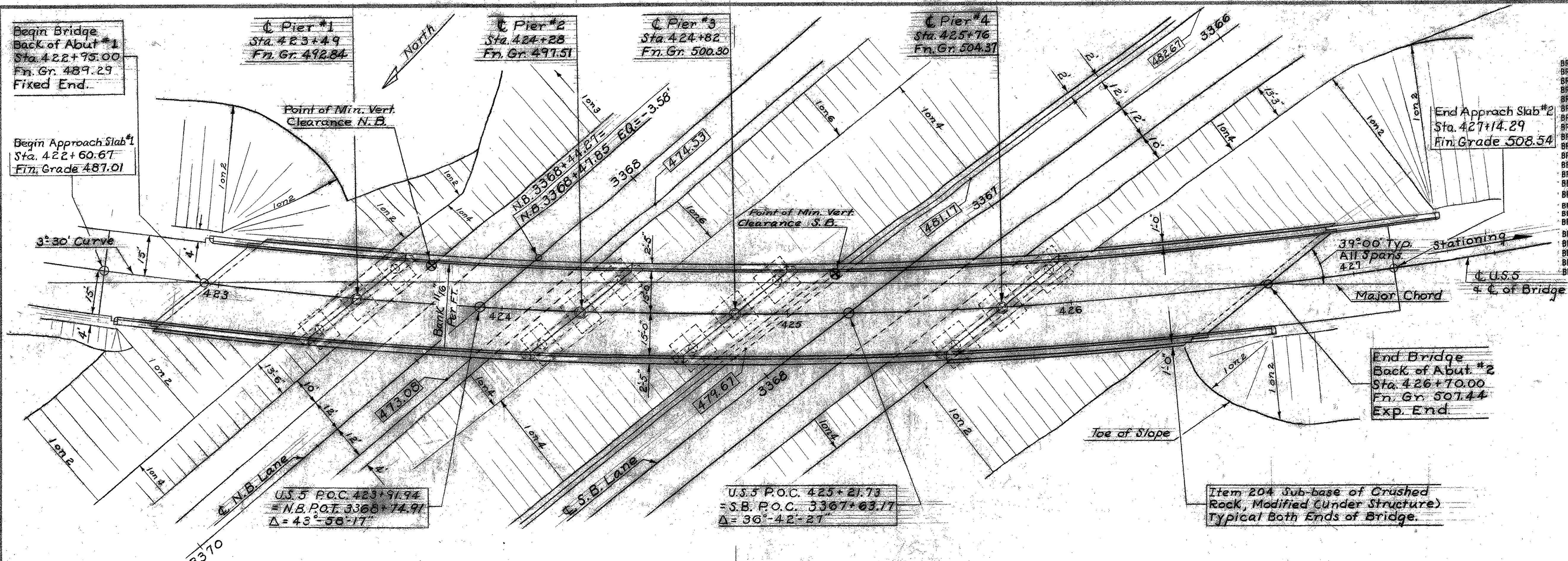

PLAN  
Scale: 1" = 20'

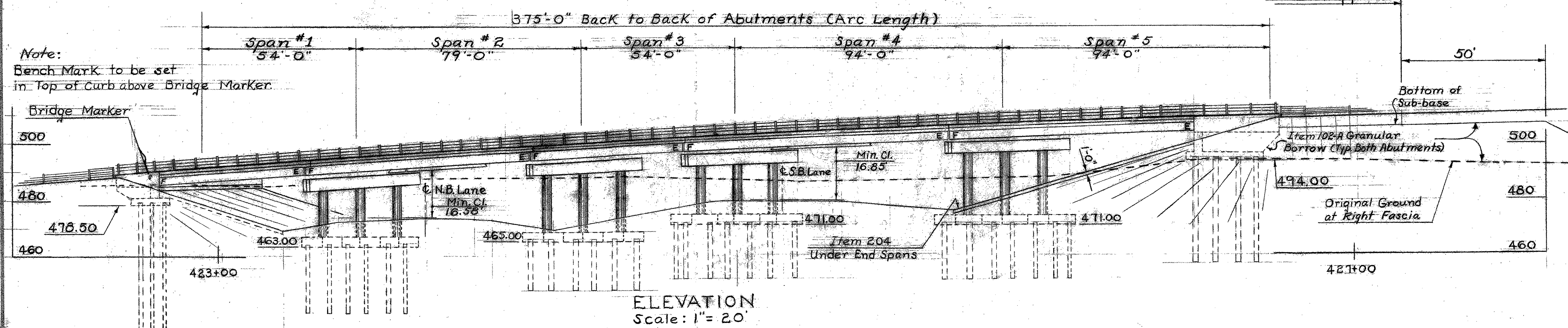

ELEVATION  
Scale: 1" = 20'

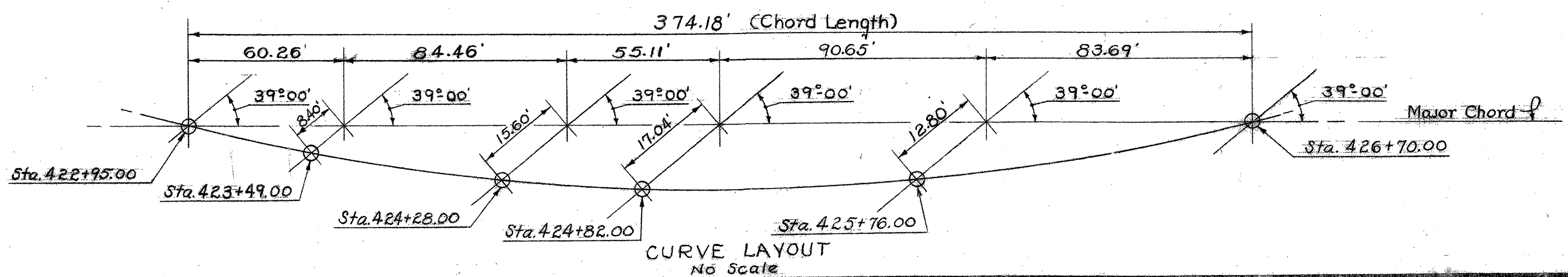

CURVE LAYOUT  
No Scale

- LIST OF BRIDGE SHEETS -

- BR-100 General Plan and Elevation
- BR-101 Bridge Quantity Sheet
- BR-102 Preliminary Information Sheet
- BR-103 Auger Borings - Sheet #1
- BR-104 Auger Borings - Sheet #2
- BR-105 Casing Borings
- BR-106 Framing Plan
- BR-107 Typical Section, Rail & Granite Curb Lengths
- BR-108 Details of Abutment #1 (Fixed End)
- BR-109 Details of Abutment #2 (Exp. End)
- BR-110 Details of Abutment #2 Wingwalls
- BR-111 Pier #1 Layout Details
- BR-112 Pier #2 Reinforcing Steel
- BR-113 Pier #2 Layout Details
- BR-114 Pier #2 Reinforcing Steel
- BR-115 Pier #3 Layout Details
- BR-116 Pier #3 Reinforcing Steel
- BR-117 Pier #4 Layout Details
- BR-118 Pier #4 Reinforcing Steel
- BR-119 Details of Approach Slab #1
- BR-120 Details of Approach Slab #2
- BR-121 Reinforcing Schedule - Sheet #1
- BR-122 Reinforcing Schedule - Sheet #2

- BRIDGE STANDARDS -

- SCB-30-62, Typical Section, Plan View and Quantities
- SCB-01-62, SCB-02-62, SCB-03-62, SCB-04-62, SCB-05-62, SCB-06-62, SCB-07-62, SCB-08-62, & SCB-09-62, Details of WF Beam Bridges
- SB-50-62, Sheets #1 & #2, Details of Bridge Railing
- G-3a, Dead End Anchorage at Bridge Approach. REFERENCE SHEETS -
- Interstate Plan, (Scale: 1"=50'), Sta. 3351+00 to 3383+00, (2 Sheets).
- Profile of Interstate, Northbound and Southbound, Sta. 3351+00 to 3383+00, (2 Sheets).
- U.S. Rte. 5 Plan, (Scale: 1"=50'), Sta. 419+00 to 430+00, (1 Sheet).
- Profile of U.S. Rte. 5, Sta. 419+00 to 430+00, (1 Sheet).
- Interstate Sections, Southbound Sta. 3365+50 to 3368+50, (4 Sheets).
- Interstate Sections, Northbound Sta. 3368+00 to 3370+50, (2 Sheets).
- U.S. Rte. 5 Sections, Sta. 420+50 to 429+00, (6 Sheets).

- NOTES -

1. For General Notes see Std. Dwg. SCB-D1-62.
2. The superstructure is of Composite WF Beam - Simple Span Design for a 30-ft. Roadway as per Std. Dwg. SCB-30-62.
3. Bridge seat elevations shown on these plans are for the centerline of bearings.
4. All exposed edges of concrete in the superstructure, abutments, and piers shall be chamfered 1" by 1".
5. Item 440 Water Repellent shall consist of furnishing and applying water repellent on exterior concrete surfaces on top of the safety walks, on the fascia and back to the drip bead under the slab, on the sides, ends and bottoms of all pier caps and on the exposed areas of abutments not otherwise treated.

Stage Construction

STATE OF VERMONT  
DEPARTMENT OF HIGHWAYS

TOWN OF HARTLAND-HARTFORD  
ROAD NO. 191 BRIDGE NO. \_\_\_\_\_  
General Plan & Elevation  
US 5 over I 91

SCALE As Noted

SURVEYED BY \_\_\_\_\_  
DRAWN BY J.I.C. CHECKED BY L.F.S.

PROJECT NO. 191-1122 Cont. #2  
SHEET 42 OF 220 Sheet 1102 of 242

THIS SHEET FOR REFERENCE ONLY  
HARTLAND IM 091-106  
1-91 BRIDGE 38  
SHEET 45 OF 85