

*** NOTE: REFER TO FRAMING PLANS FOR ALL OTHER CENTERLINE OF BEARING LOCATIONS FOR APPROACH SPAN

CURVE #3 DATA
 $\Delta = 31^{\circ}-00'-06.72''$ LT
 $D = 28^{\circ}-38'-52.40''$
 $R = 200.00$
 $T = 55.47$
 $L = 108.22$
 $E = 7.27$
 BANK = NORMAL CROWN

REFER TO SHEET 9 FOR THE TEMPORARY TRAFFIC CONTROL SIGN PACKAGE. THE SOUTHERN APPROACH WILL CONSIST OF THE SAME SIGNS ENDING 200' FROM THE INTERSECTION OF U.S. ROUTE 5 AND T.H. 78 (GILSON ROAD). ALSO, NOTE WI-3R WILL BE REPLACED BY WI-3L.

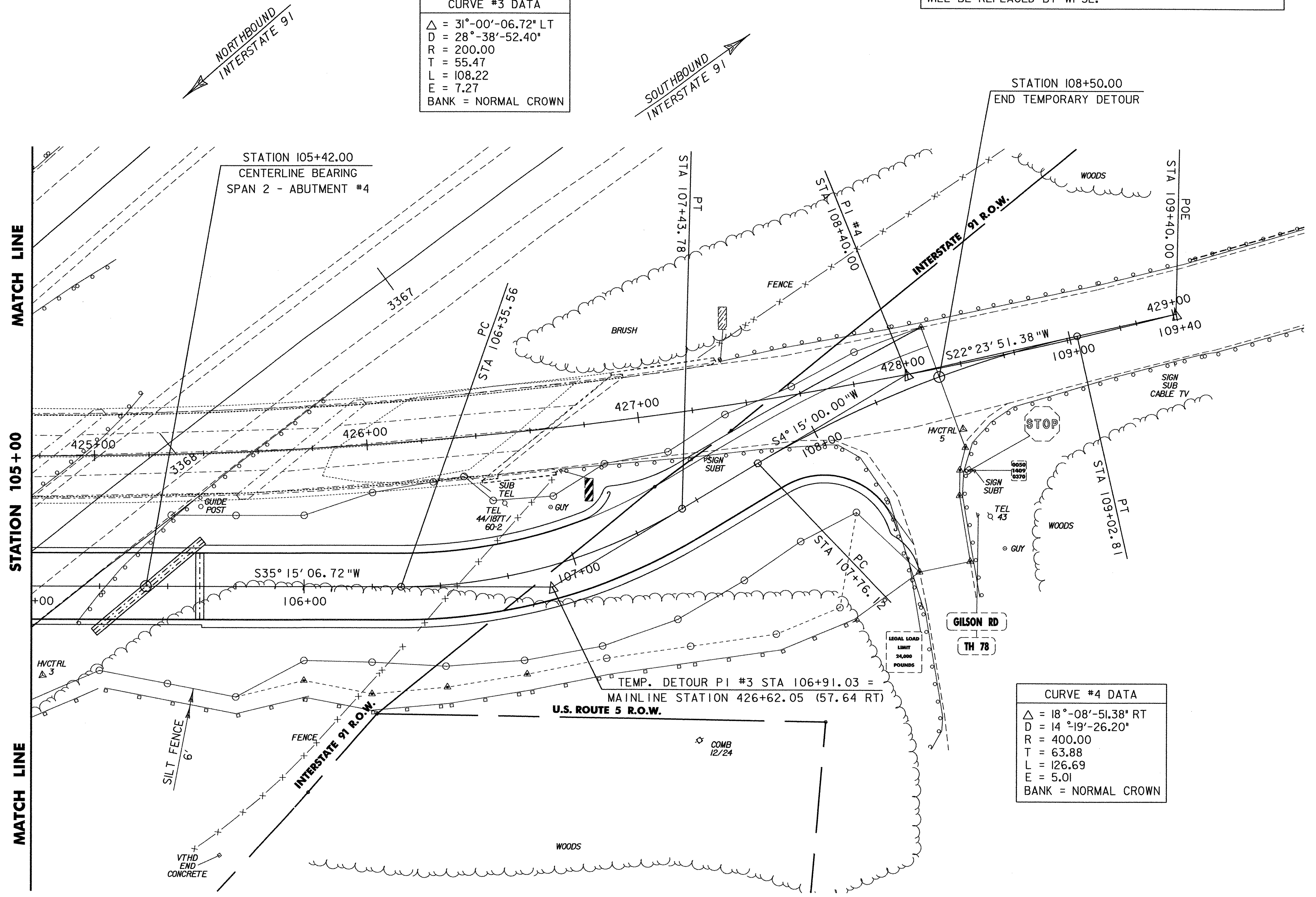
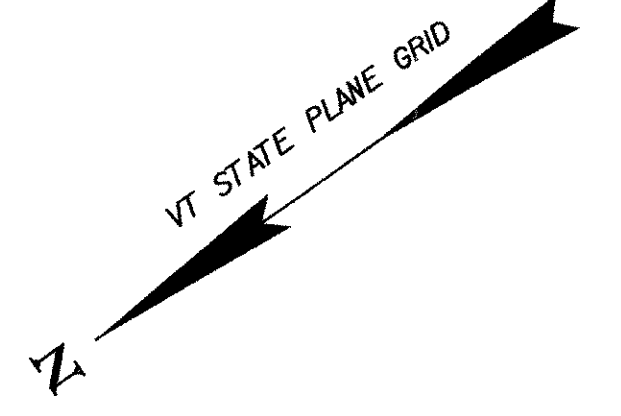

CURVE #4 DATA
 $\Delta = 18^{\circ}-08'-51.38''$ RT
 $D = 14^{\circ}-19'-26.20''$
 $R = 400.00$
 $T = 63.88$
 $L = 126.69$
 $E = 5.01$
 BANK = NORMAL CROWN

—▲— PERMANENT CONST. LIMIT
 - - -▲- - - TEMPORARY CONST. LIMIT

—□— SILT FENCE

TEMP. DETOUR PLAN - SHEET 2 OF 2

PROJECT NAME:	HARTLAND	FILE NAME:	str7/99a272/sa272bdr.dgn	PLOT DATE:	03-FEB-2003
PROJECT NUMBER:	IM 091-(136)	PROJECT LEADER:	S. FARNSWORTH	DRAWN BY:	K. UPMAL
		DESIGNED BY:	K. UPMAL	CHECKED BY:	
			SA272PL2.1	SHEET 10	OF 85

