

**ELEVATION**  
SCALE: 1/4"=1'-0"

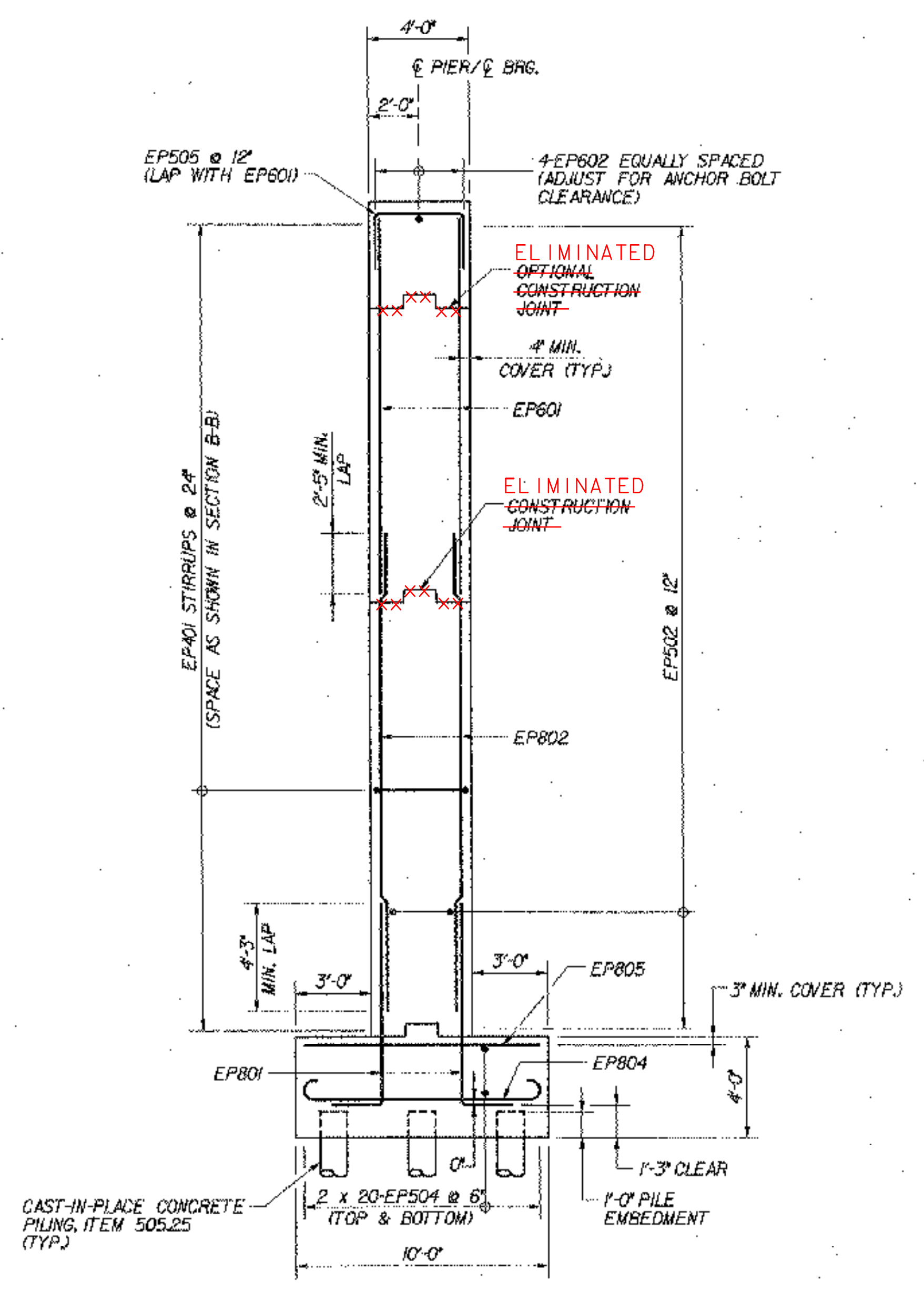

**SECTION A-A**  
SCALE: 1/4"=1'-0"

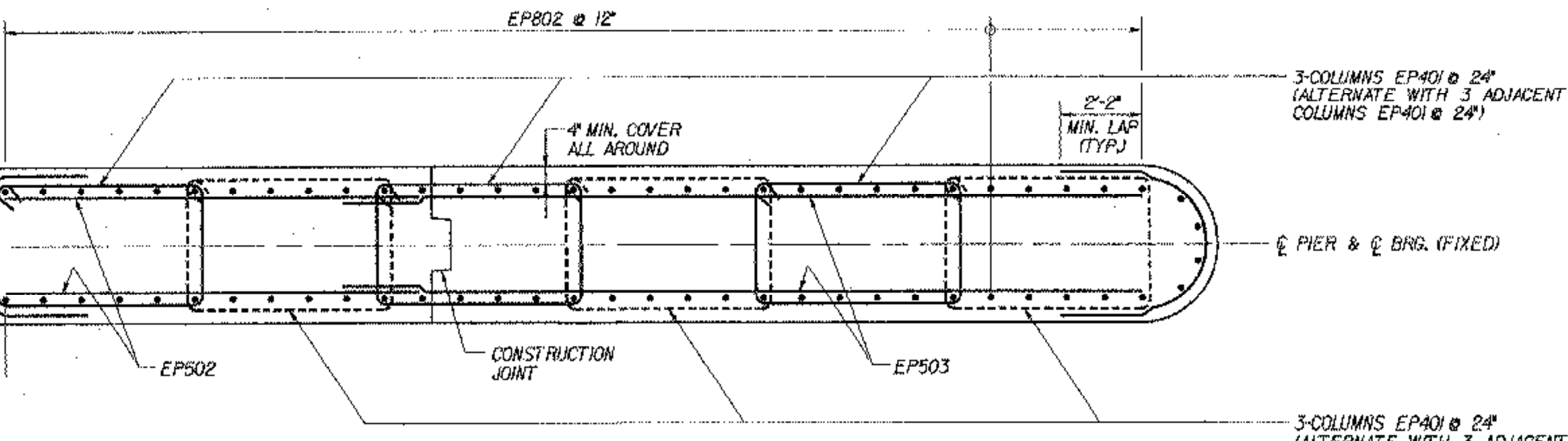

**SECTION B-B**  
SCALE: 3/8"=1'-0"

- KEY**
- NF NEAR FACE
  - FF FAR FACE
  - EF EACH FACE
  - ▲ REINFORCEMENT TO BE CUT TO FIT IN THE FIELD

<b>STATE OF VERMONT AGENCY OF TRANSPORTATION</b>			
Town Of	BOLTON	Bridge No.	<b>51N</b>
Highway No.	I-89	Log Sta.	
		Surv. Sta.	
I-89 OVER US ROUTE 2 AND JOINER BROOK			
<b>PIER NO. 2 REINFORCEMENT (51N)</b>			
Designed By	M.J. MOZER	Drawn By	R.A. BOTZENHART
Checked By	Date	Bridge Design Supervisor	
	P.W. SZUSTAK 10/99	J.P. HALSTEAD	Date 10/99
PROJECT	BOLTON	PROJECT NO.	IM-089-2(29)
		Date	10/99
TVGA ENGINEERING, SURVEYING, P.C.	TVGA CAD Drawing No.	51np2rel	Sheet 123 of 307
	Bridge Sheet No.	BR51-25	