

PLAN
SCALE: 3/8"=1'-0"

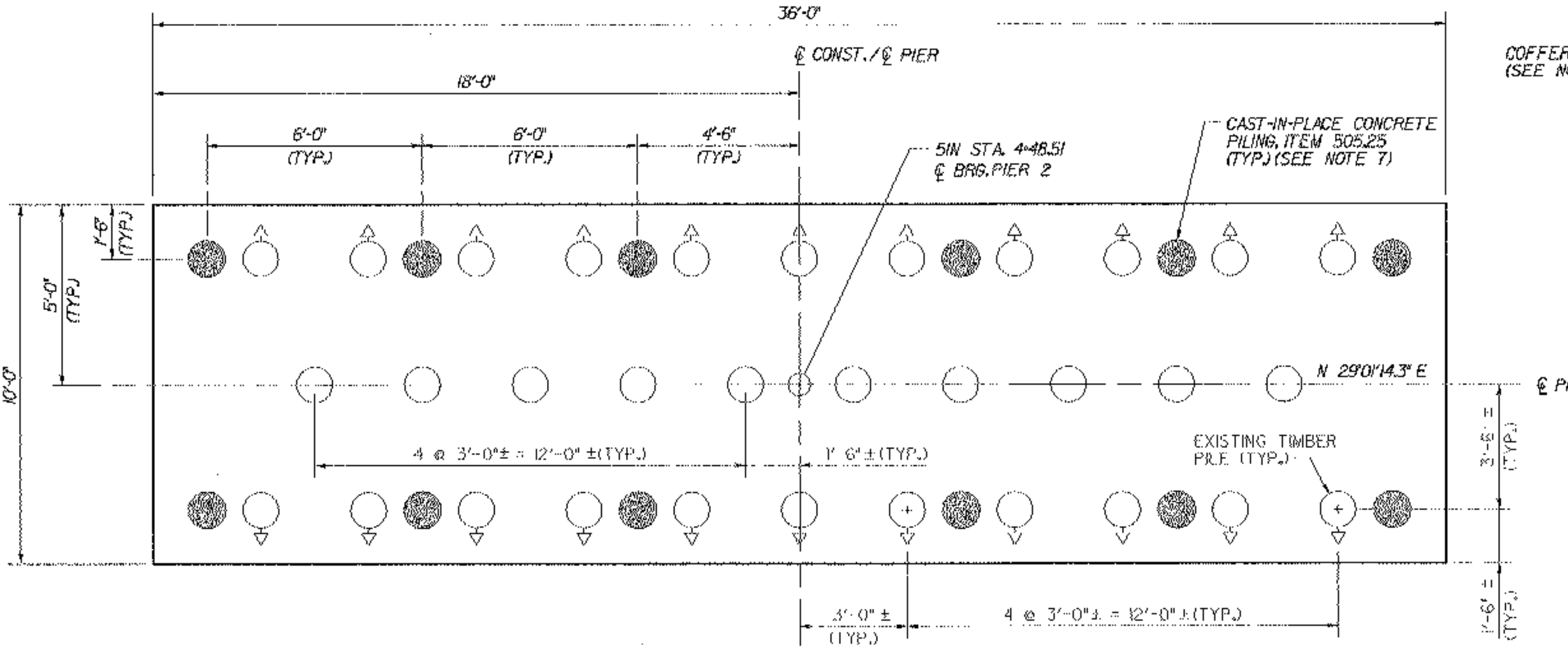

FOOTING PLAN
SCALE: 3/8"=1'-0"

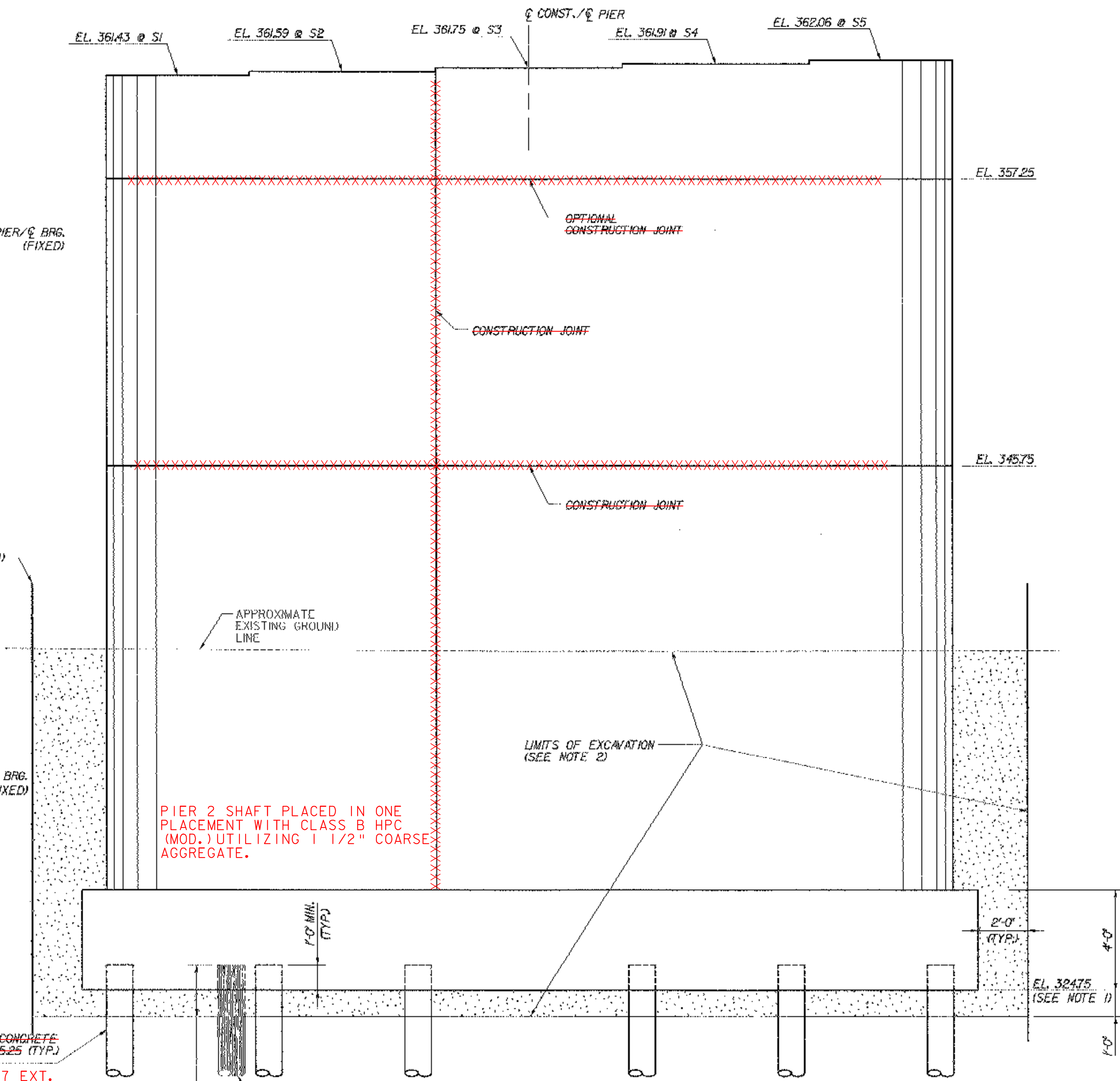

ELEVATION
SCALE: 3/8"=1'-0"

NOTES:

1. THE NEW BOTTOM OF FOOTING ELEVATION SHOWN IS APPROXIMATE. THE NEW BOTTOM OF FOOTING SHALL BE CONSTRUCTED AT THE SAME ELEVATION AS THE EXISTING FOOTING. THE CONTRACTOR SHALL VERIFY THE EXISTING BOTTOM OF FOOTING LOCATION PRIOR TO ORDERING REINFORCING STEEL.
2. REMOVAL OF THE EXISTING PIER TO EXISTING GROUND ELEVATION SHALL BE INCLUDED UNDER ITEM 529.20, "PARTIAL REMOVAL OF STRUCTURE (AT BR 51N)". THE COST OF ALL EARTH AND MASONRY EXCAVATION WITH LIMITS TWO FEET OUTSIDE AND ONE FOOT UNDER THE NEW PIER FOOTING SHALL BE INCLUDED UNDER ITEM 208.30, "COFFERDAM EXCAVATION, EARTH", AND ITEM 208.35 "COFFERDAM EXCAVATION, ROCK"
3. PAYMENT FOR ALL BACKFILL REQUIRED WITHIN THE NEAT LINES AS SHOWN SHALL BE MADE UNDER ITEM 204.30, "GRANULAR BACKFILL FOR STRUCTURES."
4. EXISTING TIMBER PILES SHALL BE REMOVED ONE FOOT MINIMUM BELOW THE NEW BOTTOM OF FOOTING (COSTS TO BE INCLUDED IN ITEM 529.20, "PARTIAL REMOVAL OF STRUCTURE (AT BR 51N)."
5. IF THE LOCATION OF EXISTING TIMBER PILES CONFLICTS WITH DRIVING NEW PILES, THE CONTRACTOR SHALL DRIVE NEW PILES IN DIFFERENT LOCATIONS, AS ORDERED BY THE STRUCTURES ENGINEER, AT NO ADDITIONAL EXPENSE TO THE CONTRACT. SHOULD EXHUMATION OF EXISTING TIMBER PILES BE REQUIRED, THIS WORK SHALL BE PAID FOR IN ACCORDANCE WITH SECTION 109.06, EXTRA AND FORCE ACCOUNT WORK.
6. THE SIZE AND LENGTH OF EXISTING PILES IS BASED ON EXISTING PLAN INFORMATION, AND IS PROVIDED FOR INFORMATION ONLY.
7. FOR DETAILS OF CAST-IN-PLACE CONCRETE PILING, SEE TYPICAL BRIDGE DETAILS, BRIDGE SHEET C-46.
8. A COFFERDAM IS REQUIRED FOR THE EXCAVATION OF THE EXISTING PIER AND THE CONSTRUCTION OF THE NEW PIER. THE CONTRACTOR SHALL PREPARE DETAILED PLANS IN ACCORDANCE WITH SUBSECTION 208 OF THE SPECIFICATIONS FOR APPROVAL BY THE STRUCTURES ENGINEER. PAYMENT FOR THE COFFERDAM SHALL BE MADE UNDER ITEM 208.40, "COFFERDAM."

"H" PILES
CAST-IN-PLACE CONCRETE
PILING, ITEM 505.25 (TYP.)
(SEE NOTE 7)
ITEM 900.07 EXT.
N.O. #7, LS

CUT OFF EXISTING TIMBER PILES 1'-0" MIN. BELOW BOTTOM OF NEW FOOTING

KEY

- EXISTING 12" DIA. TIMBER PILE (APPROX. 33' LONG - SEE NOTE 6)
- ▽ INDICATES BATTERED PILE 1:4 (SEE NOTE 6)
- NEW 12 3/4" DIA. CLOSED END CAST-IN-PLACE CONCRETE PILE
- ▒ GRANULAR BACKFILL FOR STRUCTURES

**STATE OF VERMONT
AGENCY OF TRANSPORTATION**

Town Of	BOLTON	Bridge No.	51N
Highway No.	I-89	Log Sta.	
I-89 OVER US ROUTE 2 AND JOINER BROOK			
PIER NO. 2 MASONRY (51N)			
Designed By	M.J. MOZER	Drawn By	R.A. BOTZENHART
Checked By	P.W. SZUSTAK	Bridge Design Supervisor	J.P. HALSTEAD
PROJECT	BOLTON	PROJECT NO.	IM-D89-2(29)
TVGA CAD Drawing No. 51np2mas		Date 10/99	
Bridge Sheet No. BR51-24		Sheet 122 of 307	