

STATION
PROFILE - (BR 51N)

AS A RESULT OF BEAM PROFILES, THE GRADE OF BR 51N WAS RAISED 1 INCH (0.08') TO MEET THE MINIMUM HAUNCH REQUIREMENTS.

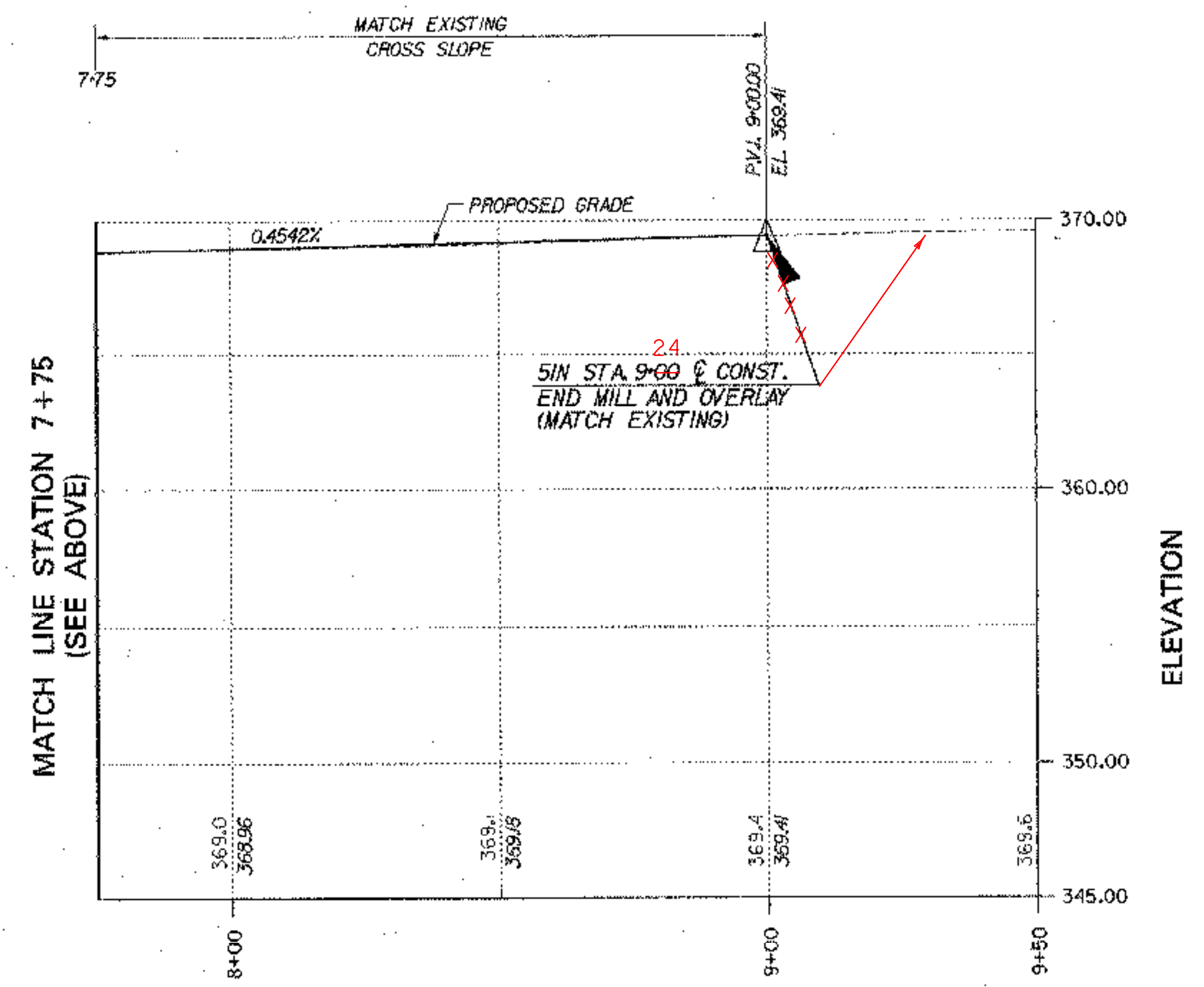

STATION
PROFILE - (BR 51N)

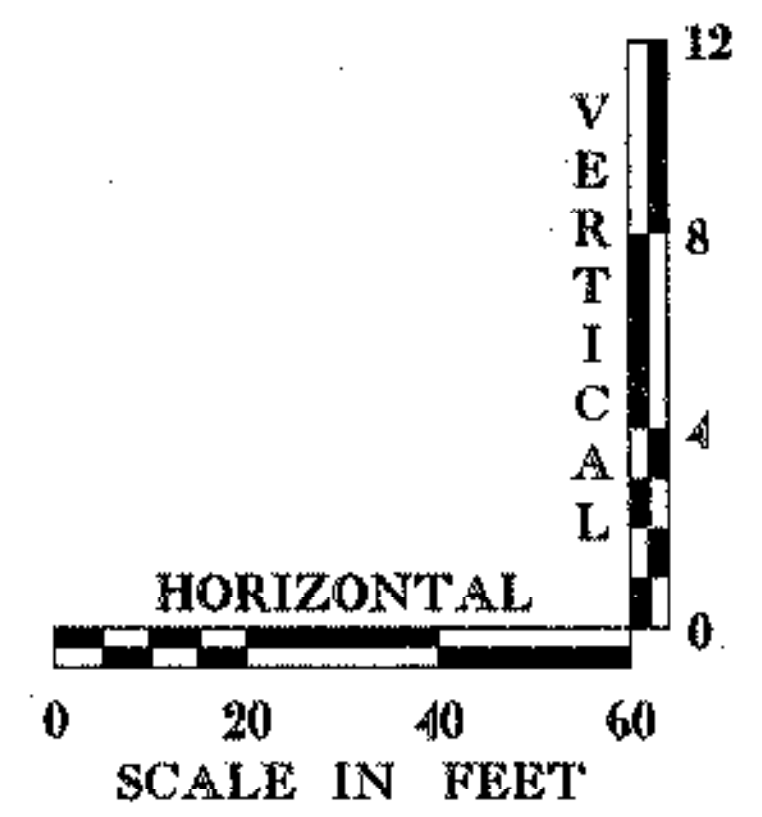

STATE OF VERMONT AGENCY OF TRANSPORTATION			
Town Of	BOLTON	Bridge No.	51N
Highway No.	I-89	Log Sta.	
		Surv. Sta.	
I-89 NB OVER U.S. ROUTE 2 AND JOINER BROOK			
PROFILE (51N)			
Designed By	P.W. SZUSTAK	Drawn By	R.A. BOTZENHART
Checked By	Date	Bridge Design Supervisor	
J.P. HALSTEAD	10/99	J.P. HALSTEAD	Date 10/99
PROJECT	BOLTON	PROJECT NO.	IM-089-2(29)
TVGA CAD Drawing No. 5inprof		Date 10/99	
Bridge Sheet No.	BR51-5	Sheet 103 of 307	

TVGA TVGA ENGINEERING,
SURVEYING, P.C.