

**DRIP PLATE DETAIL**

N.T.S.

NOTE: DRIP PLATES SHALL BE PLACED ON OUTSIDE EDGE OF FASCIA STRINGERS ON THE HIGH SIDE OF ALL PIERS AND LOW ABUTMENTS OR AS INDICATED ON PROJECT PLANS.

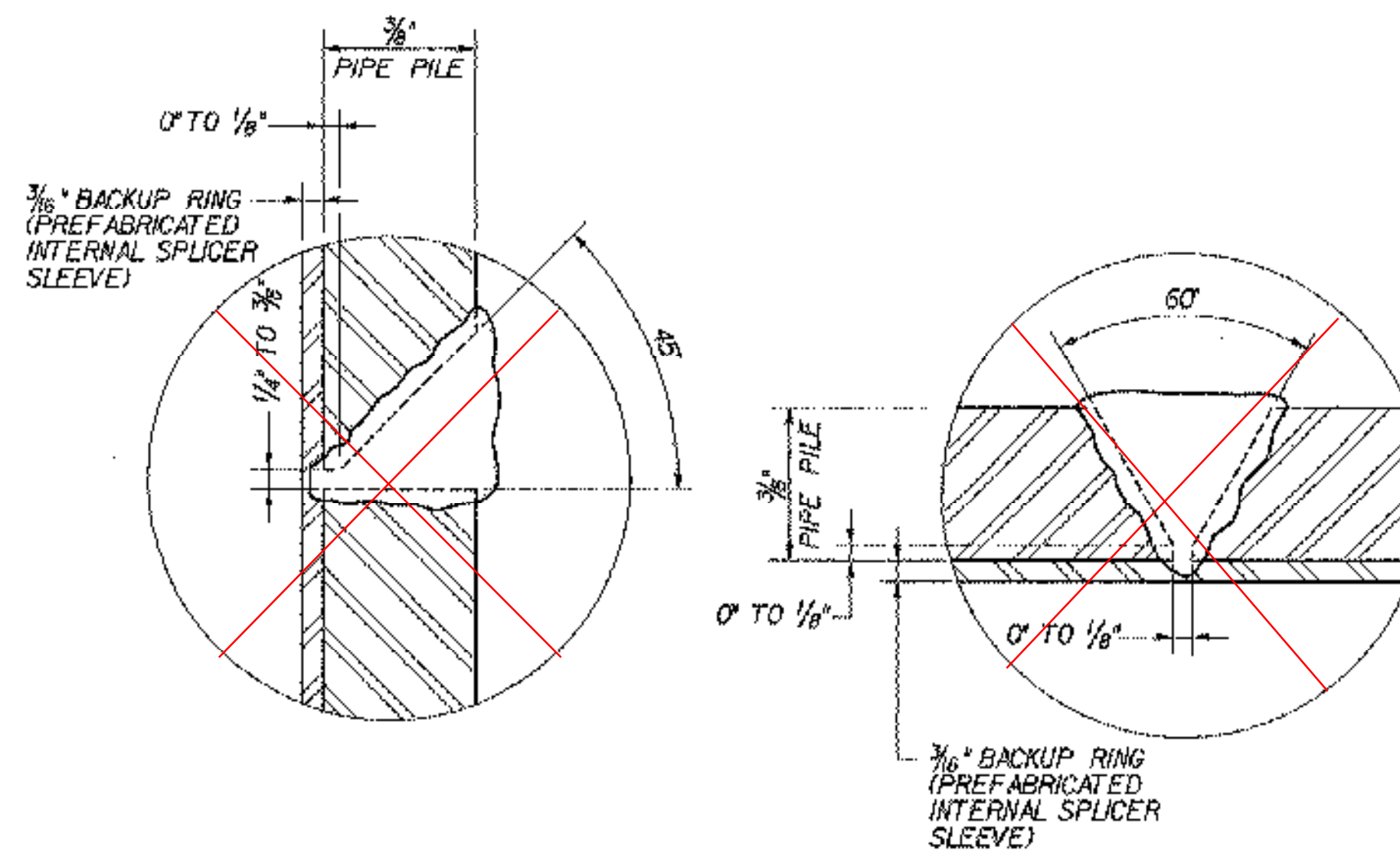

**PIPE PILE SPlice OPTIONS**

N.T.S.

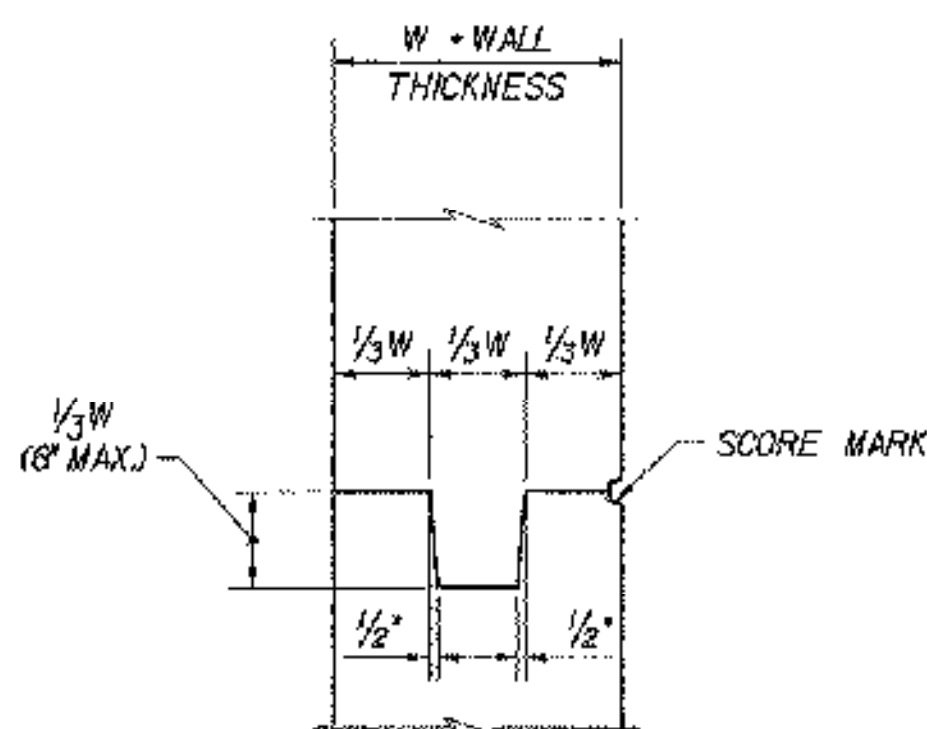

**TYPICAL CONCRETE CONSTRUCTION JOINT**

N.T.S.

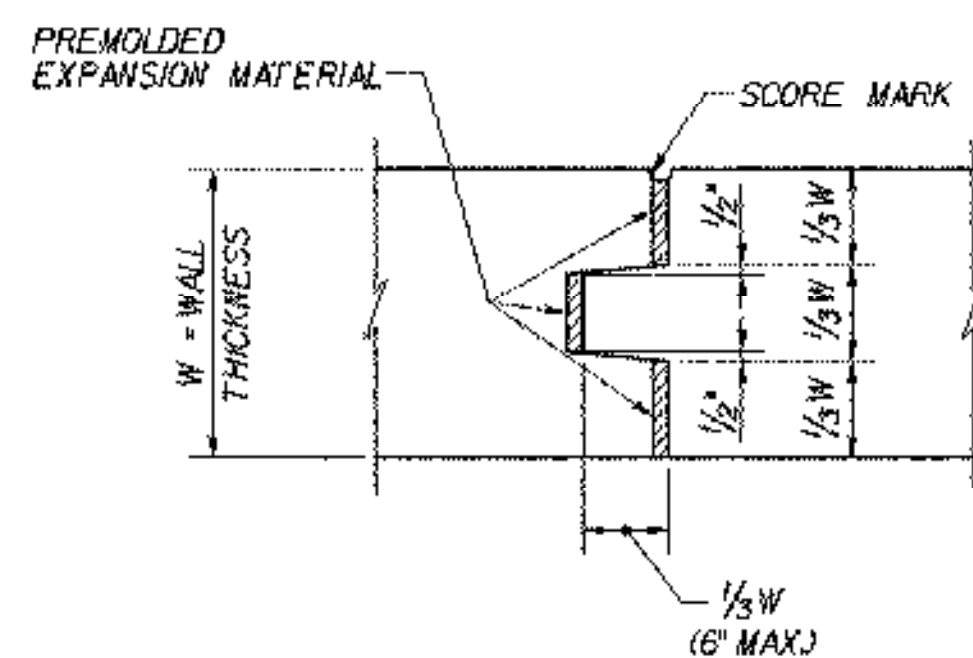

**TYPICAL CONCRETE EXPANSION JOINT**

N.T.S.

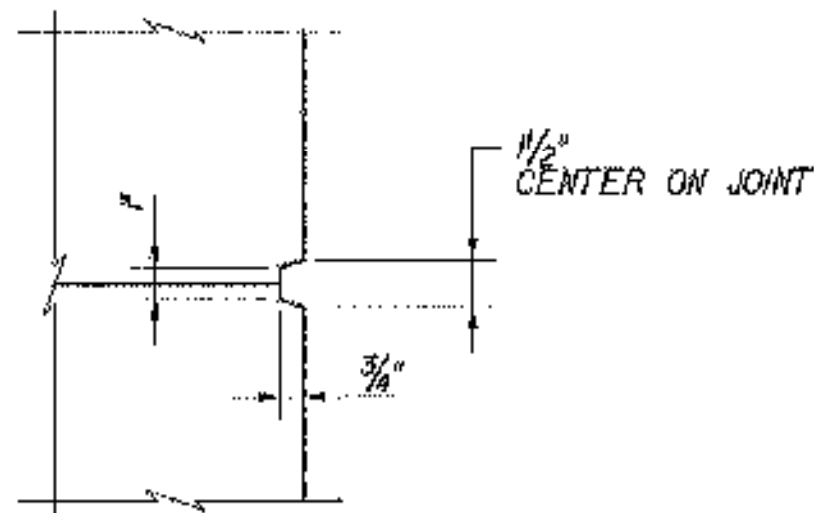

**SCORE MARK DETAIL**

N.T.S.

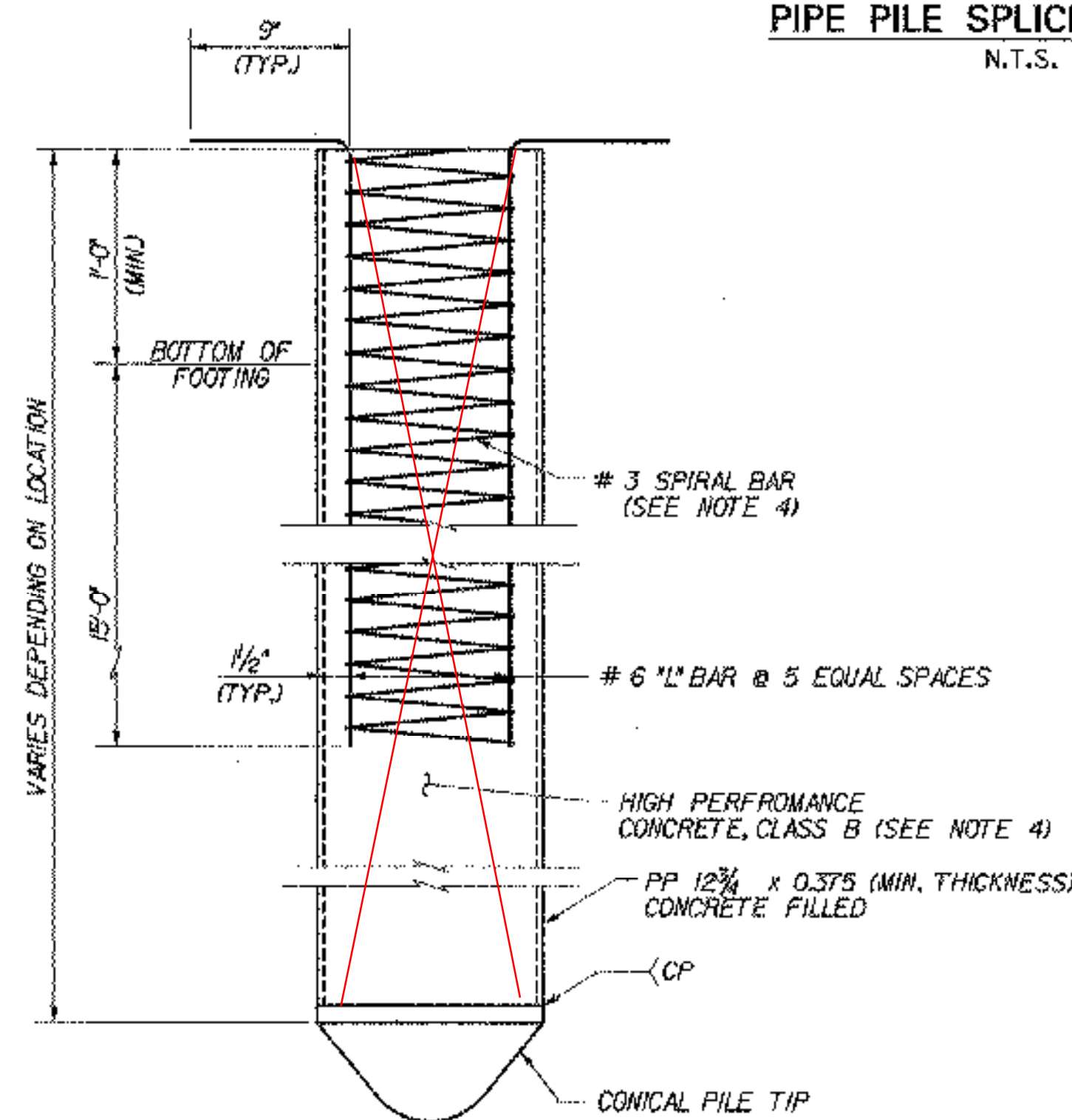

**ELEVATION**

SCALE: 1/2" = 1'-0"

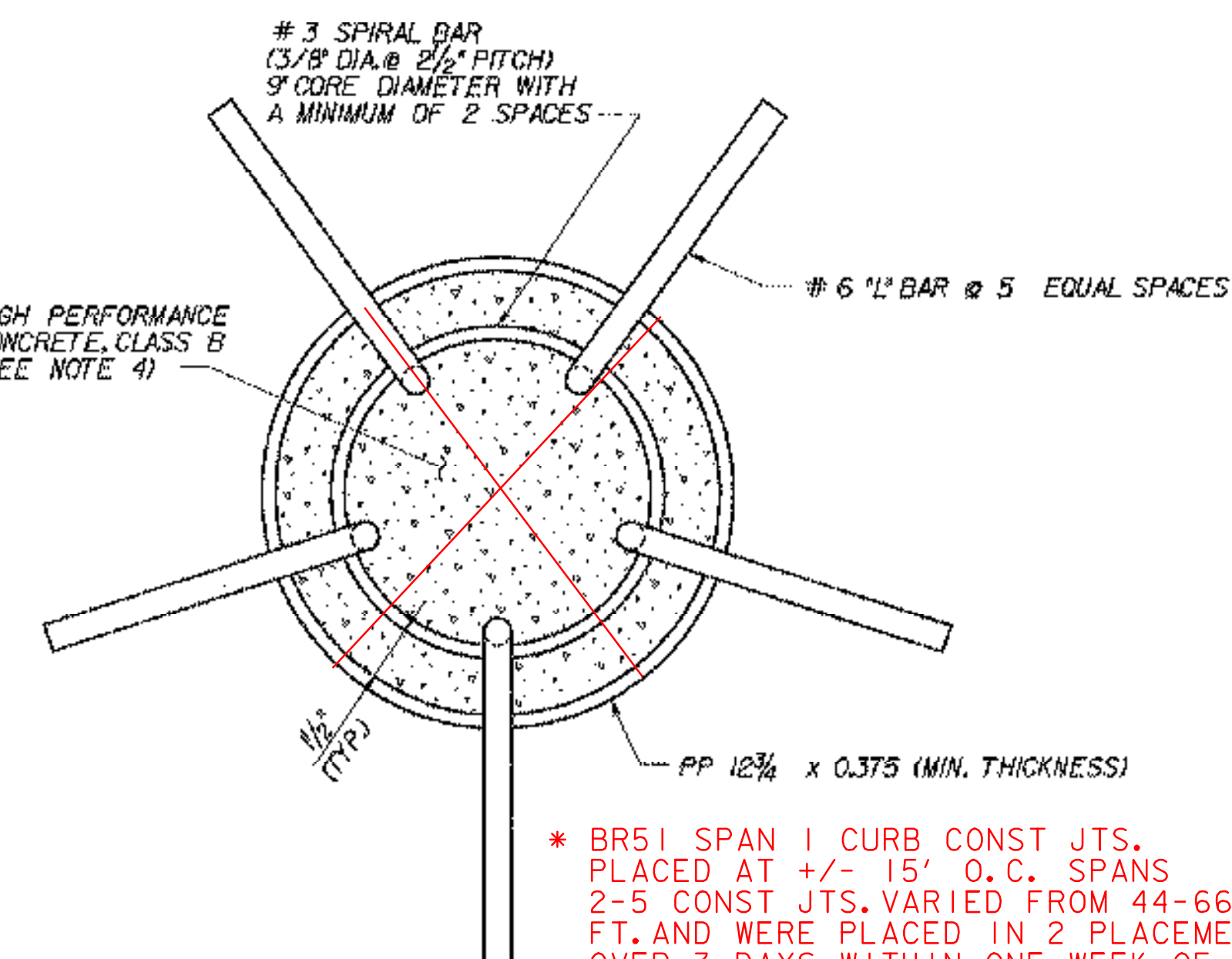

**PLAN**

SCALE: 3" = 1'-0"

\* BR51 SPAN 1 CURB CONST JTS. PLACED AT +/- 15' O.C. SPANS 2-5 CONST JTS. VARIED FROM 44-66 FT. AND WERE PLACED IN 2 PLACEMENTS OVER 3 DAYS WITHIN ONE WEEK OF THE COMPLETION OF DECK CURE. THIS WAS DONE AS AN EXPERIMENT WITH CONCURRENCE OF STRUCTURES, CONSTRUCTION, AND FHWA.

**CAST-IN-PLACE CONCRETE PILING**

CONCRETE PILING CHANGE TO "H" PILING AS PER CHANGE ORDER #2 "H" PILING PAID AS LUMP SUM.

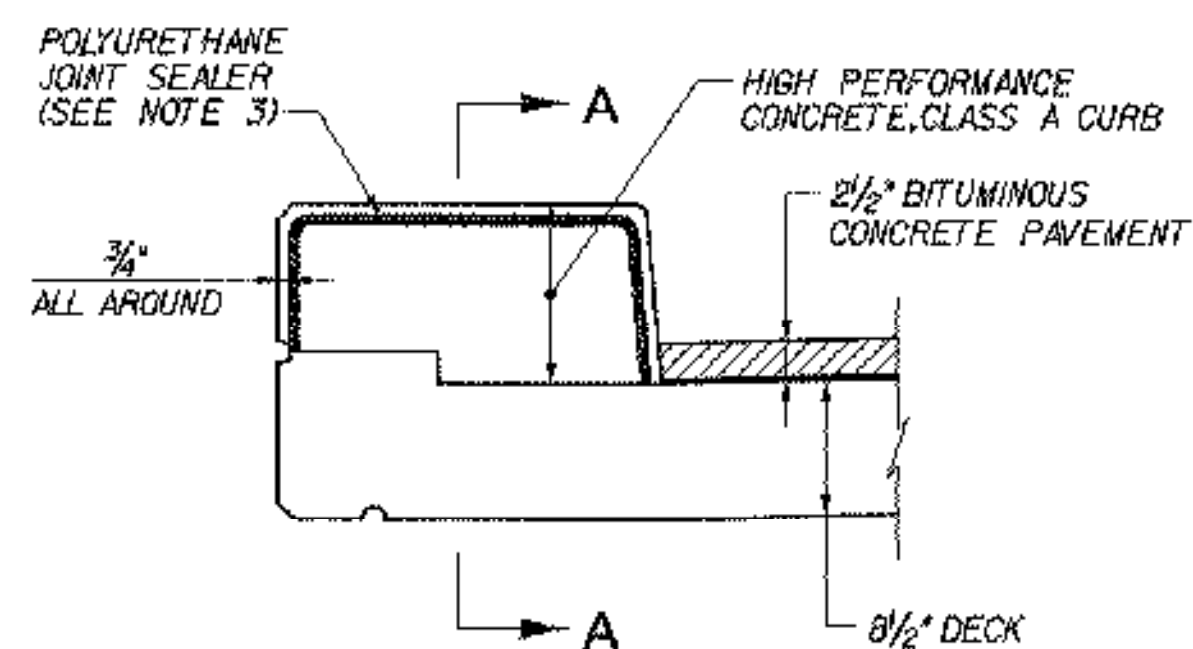

**TYPICAL SECTION THRU CONCRETE CURB CONSTRUCTION JOINT**

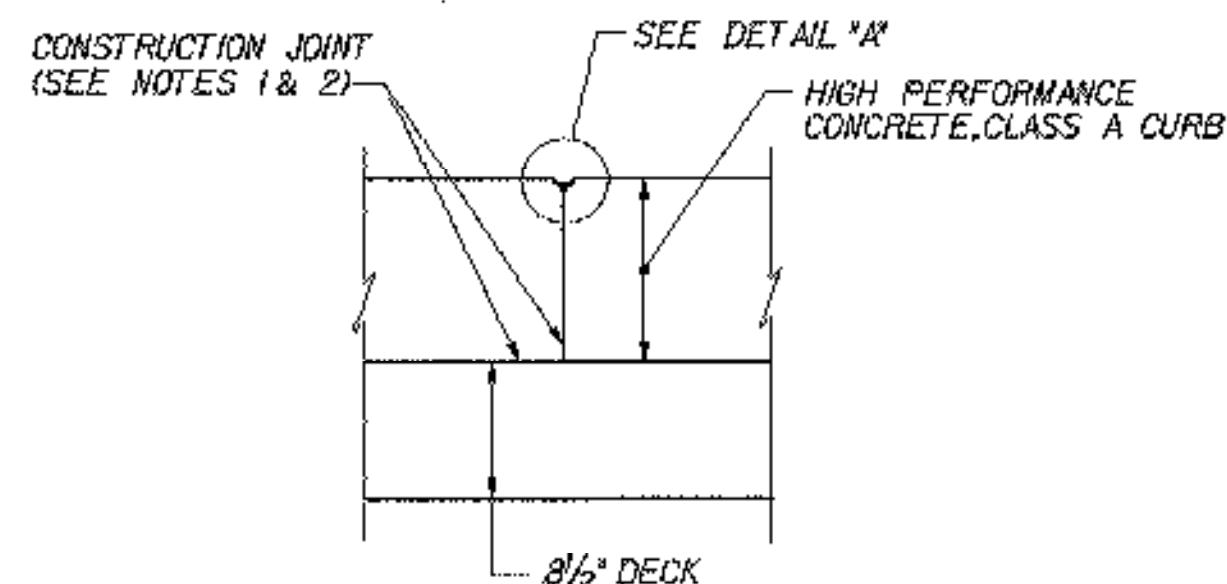

**SECTION A-A**

**CURB JOINT DETAILS**

N.T.S.

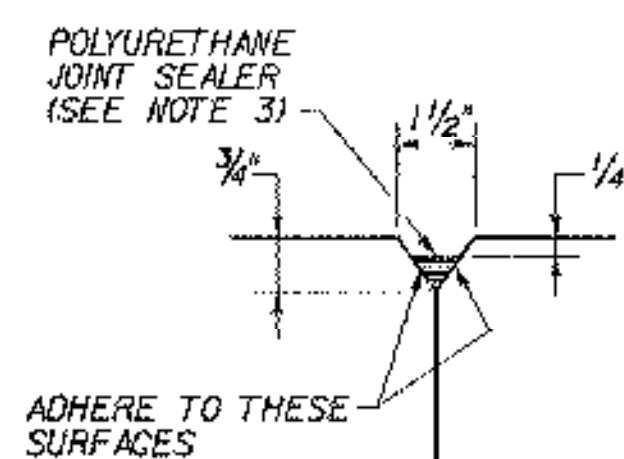

**DETAIL "A"**

**NOTES:**

1. CONSTRUCTION JOINTS THROUGH CONCRETE CURB SHALL BE SPACED MAXIMUM 15'-0" CENTER TO CENTER AND SHALL BE 1'-6" MINIMUM FROM THE CENTER OF THE NEAREST BRIDGE RAIL POST. CONCRETE SHALL BE PLACED IN ALTERNATING SECTIONS WITH A MINIMUM OF 48 HOURS DELAY BETWEEN ADJACENT POURS.
2. LONGITUDINAL REINFORCING SHALL PASS THROUGH CONCRETE CURB CONSTRUCTION JOINTS.
3. POLYURETHANE JOINT SEALER, PER SUBSECTION 524.06(c) OF THE SPECIFICATIONS, COLOR TO MATCH CONCRETE. COST SHALL BE INCIDENTAL TO ITEM 501.33, "HIGH PERFORMANCE CONCRETE, CLASS A".
4. THE COST OF CONCRETE, REINFORCING STEEL, AND CONICAL PILE TIP SHALL BE INCIDENTAL TO ITEM 505.25, "CAST-IN-PLACE CONCRETE PILING".

**STATE OF VERMONT AGENCY OF TRANSPORTATION**

Town Of	BOLTON	Bridge No.	
Highway No.	1-89	Log Sta.	
		Surv. Sta.	

**TYPICAL BRIDGE DETAILS**

Designed By	P.W. SZUSTAK	Drawn By	R.A. BOTZENHART
Checked By	J.P. HALSTEAD	Date	10/99
		Bridge Design Supervisor	J.P. HALSTEAD
		Date	10/99

PROJECT	BOLTON	PROJECT NO.	IM-089-2(29)
---------	--------	-------------	--------------

TVGA CAD Drawing No.	shgbrdet	Date	10/99
Bridge Sheet No.	C-46	Sheet	46 of 307

**TVGA** TVGA ENGINEERING, SURVEYING, P.C.