

NOTE: BRUSH CURB MASONRY AND REINFORCEMENT NOT SHOWN IN PLAN FOR CLARITY. (SEE NOTE 1)

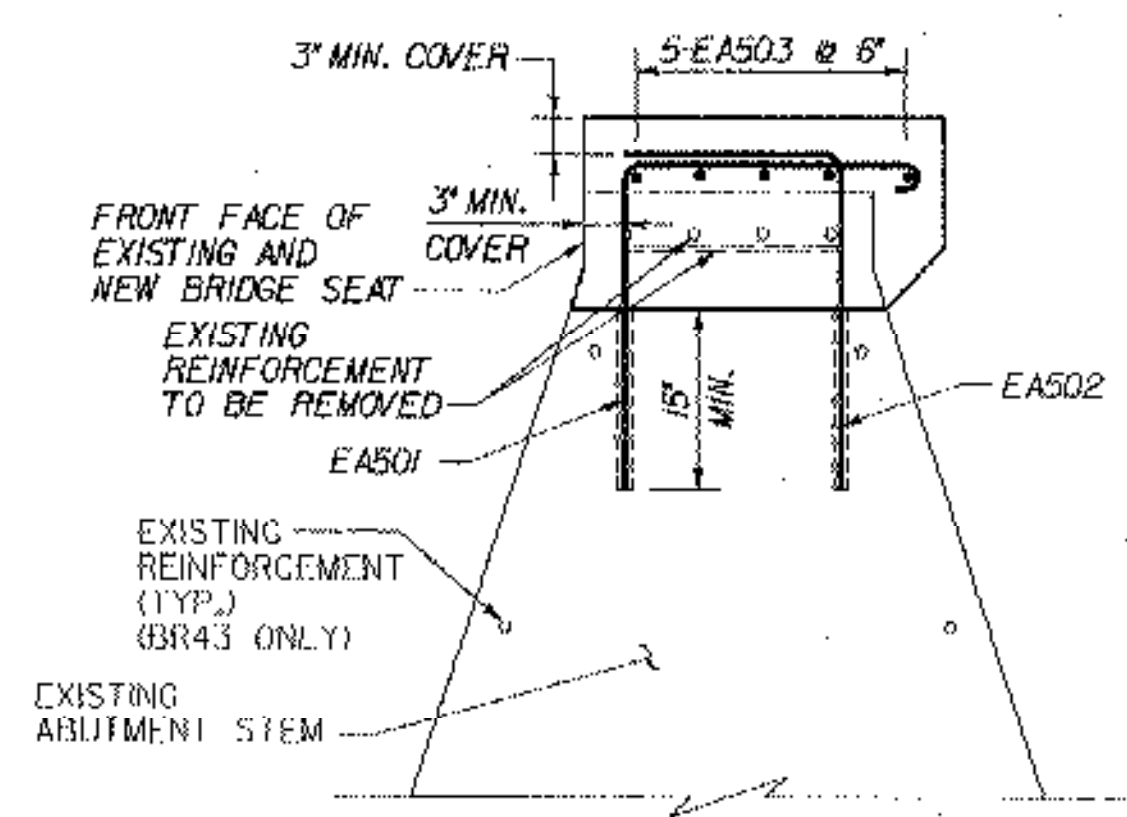

PLAN
N.T.S.

SECTION A-A
N.T.S.

REINFORCEMENT LAYOUT SHOWN IS INTENDED AS GUIDANCE ONLY. CONTRACTOR MUST MAKE ADJUSTMENTS IN ORDER TO FIT ACTUAL FIELD CONDITIONS, AS APPROVED BY THE ENGINEER, AT NO ADDITIONAL EXPENSE TO THE CONTRACT.

CONSTRUCTION JOINT LOCATED AT STEP IN BRIDGE SEAT. LOCATION SHALL BE REVISED AS DIRECTED BY THE RESIDENT ENGINEER AS REQUIRED TO MATCH ANY CONSTRUCTION JOINT IN THE EXISTING ABUTMENT STEM. REQUIRED REVISIONS TO REINFORCING STEEL LENGTHS WILL BE MADE BY THE CONTRACTOR AT NO ADDITIONAL EXPENSE TO THE CONTRACT.

NO CONSTRUCTION JOINT EXISTING. DID NOT PUT ONE IN NEW ABUTMENT CAP

NOTE: ACUTE WINGWALL REINFORCEMENT NOT SHOWN IN ELEVATION FOR CLARITY. LAYOUT SIMILAR TO OBTUSE WINGWALL, EXCEPT FOR EA512, WHICH IS REPLACED BY EA513.

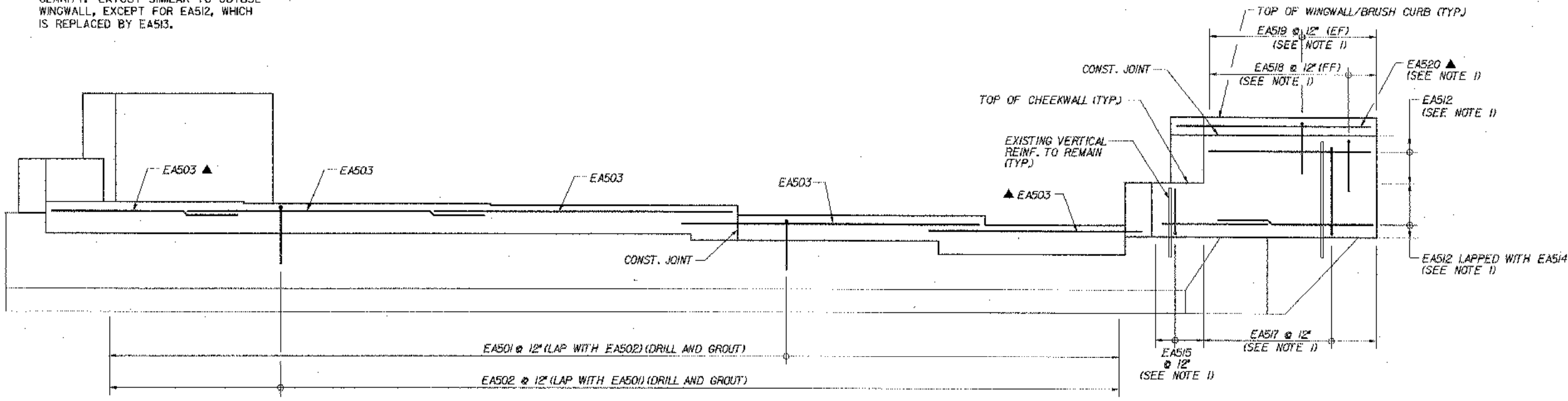

NOTES:

- FOR ADDITIONAL WINGWALL AND BRUSH CURB DETAILS, SEE TYPICAL WINGWALL DETAILS, BRIDGE SHEETS C-43 AND C-44.
- CONCRETE LIMITS AND DIMENSIONS ARE SHOWN IN ABUTMENT MASONRY PLANS FOR EACH BRIDGE.

ELEVATION
N.T.S.

KEY

- NF NEAR FACE
- FF FAR FACE
- EF EACH FACE
- ▲ REINFORCEMENT TO BE CUT TO FIT IN THE FIELD

STATE OF VERMONT
AGENCY OF TRANSPORTATION

Town Of	BOLTON	Bridge No.	
Highway No.	I-89	Log Sta.	
		Surv. Sta.	
TYPICAL FIXED ABUTMENT REINFORCEMENT			
Designed By	P.W. SZUSTAK	Drawn By	R.A. BOTZENHART
Checked By	Date	Bridge Design Supervisor	
J.P. HALSTEAD	10/99	J.P. HALSTEAD	Date 10/99
PROJECT	BOLTON	PROJECT NO.	IM-089-2(29)
		TVGA CAD Drawing No.	abrinf.f Date 10/99
		Bridge Sheet No.	C-41 Sheet 41 of 307