

**N.B. SPAN #1 FRAMING PLAN**  
SCALE: 1/8" = 1'-0"

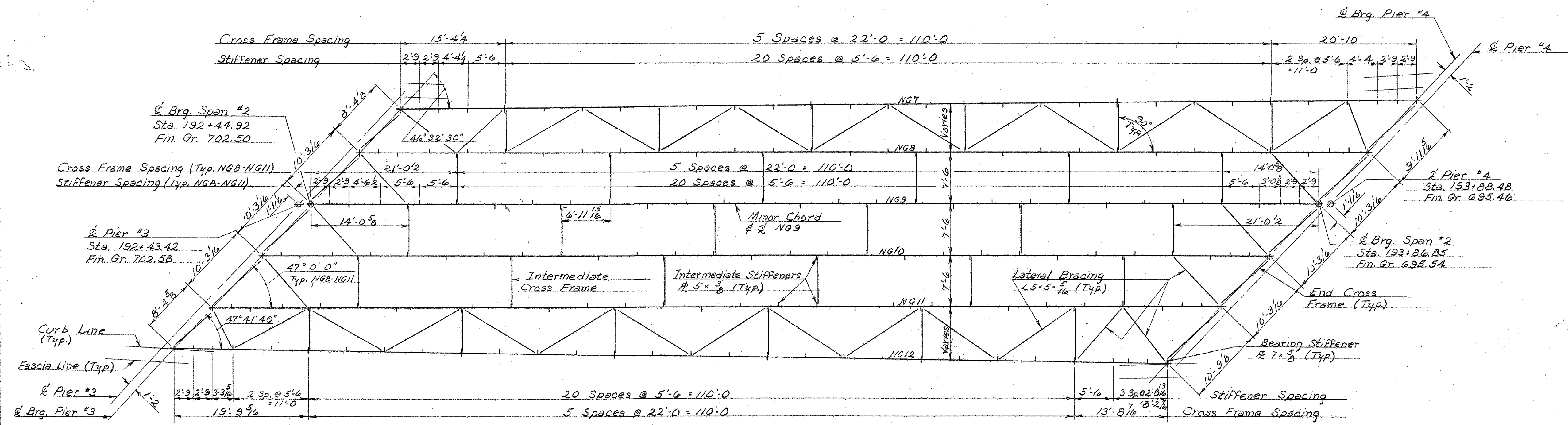

**N.B. SPAN #2 FRAMING PLAN**  
SCALE: 1/8" = 1'-0"

- NOTES**
1. See BR. 400 For General Notes.
  2. See BR. 410 For N.B. Girder Elevation.
  3. See BR. 411. For Framing Details.
  4. See BR. 406 For Intermediate and End Cross Frame Details.

THIS SHEET FOR REFERENCE ONLY  
BERLIN 10489-1(20)  
BRIDGES 40 N&S  
SHEET 86 OF 104

**STATE OF VERMONT**  
DEPARTMENT OF HIGHWAYS

PROJECT BERLIN-MONTPELIER  
TOWNS OF BERLIN & MONTPELIER

ROUTE No. I 89 STA. 193+50.7  
I 89 OVER VT. 12

N.B. SPANS #1 & #2 FRAMING PLAN  
SCALE AS NOTED

IN CHARGE W. SMITH  
DRAWN BY W. TRIPP CHECKED BY R. LADD  
11-67

PROJECT No. I 89-1(12)  
SHEET 160 OF 497 BR. 409