

S.B. SPAN #1 FRAMING PLAN
SCALE: 1/8" = 1'-0"

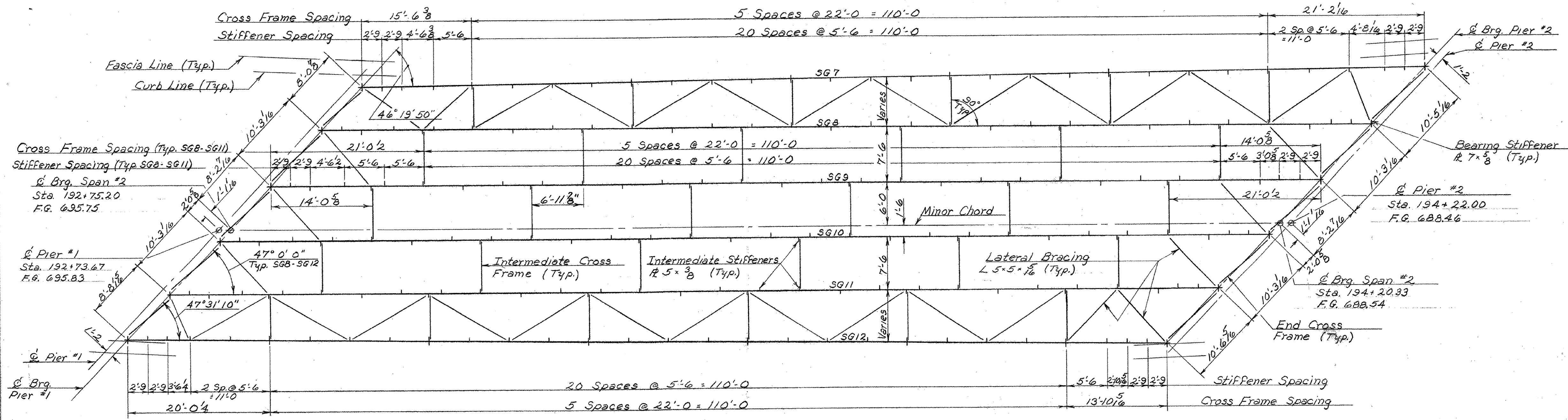

S.B. SPAN #2 FRAMING PLAN
SCALE: 1/8" = 1'-0"

- NOTES**
1. See BR. 400 For General Notes.
 2. See BR. 408 For S.B. Girder Elevation.
 3. See BR. 411 For Framing Details.
 4. See BR. 406 For Intermediate and End Cross Frame details.

THIS SHEET FOR REFERENCE ONLY
BERLIN 1089-1(C20)
BRIDGES 40 N&S
SHEET 84 OF 104

STATE OF VERMONT
DEPARTMENT OF HIGHWAYS

PROJECT BERLIN - MONTPELIER
TOWNS OF BERLIN & MONTPELIER
ROUTE NO. I 89 STA. 193+50.2
I 89 OVER VT. 12
S.B. SPAN #1 & #2 FRAMING PLAN
SCALE AS NOTED
IN CHARGE W. SMITH
DRAWN BY W. TRIPP CHECKED BY R. LADD
PROJECT NO. I 89-1(12)
SHEET 158 OF 197 BR. 407