

REMOVAL AND DISPOSAL OF GUARDRAIL  
 STA 396+00.00 - STA 396+26.70 LT  
 STA 396+00.00 - STA 397+85.93 RT

SPECIAL PROVISION  
 (GUARDRAIL APPROACH SECTION,  
 TO F-SHAPE CONCRETE RAIL)  
 STA 396+00.00 - STA 396+26.70 LT  
 HD STEEL BEAM GUARDRAIL, GALVANIZED  
 STA 396+00.00 - STA 399+67.00 RT

CHANGING ELEVATION OF DROP INLET,  
 CATCH BASIN, OR MANHOLES  
 STA 396+06.09  
 MANUFACTURED TERMINAL  
 SECTION, FLARED  
 STA 399+67.00 - STA 400+04.30 RT

MILLED RUMBLE STRIP  
 STA 396+00.00 - STA 396+50.00 LT  
 DURABLE 6" WHITE LINE, THERMOPLASTIC  
 STA 390+00.00 - STA 396+50.00 LT  
 STA 390+00.00 - STA 396+50.00 DASHED CL  
 DURABLE 6" YELLOW LINE, THERMOPLASTIC  
 STA 390+00.00 - STA 396+50.00 RT

DELINIATOR WITH STEEL POST  
 STA 396+41.60 LT  
 TRAFFIC SIGN, TYPE A  
 MM 52.81 LT (NOT SHOWN)

**SPEED  
LIMIT  
65**  
**MINIMUM  
SPEED  
40**

MATCH LINE STA 396+00

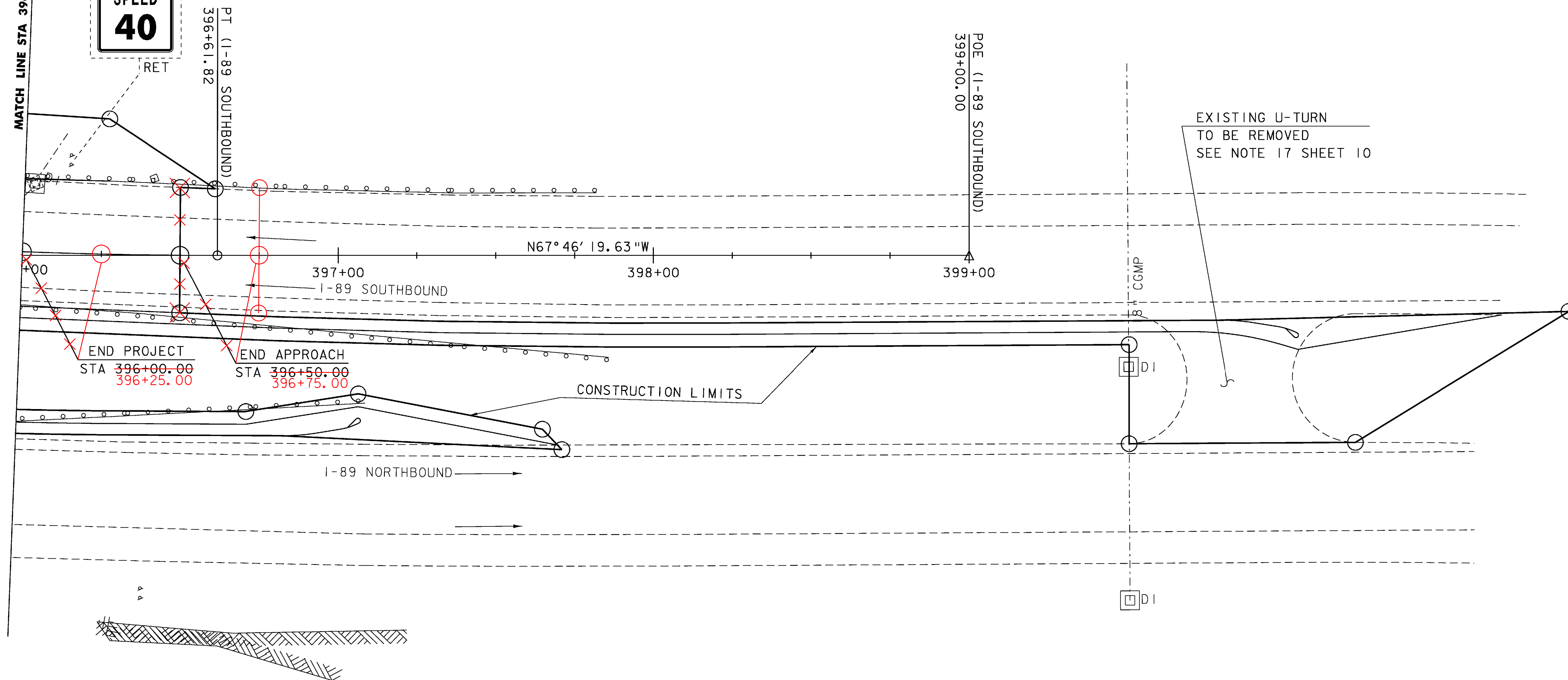

SCALE 1" = 20'-0"  
 20 0 20

**LAYOUT #3 (I-89 SOUTHBOUND)**

SIGN LEGEND	
N	- NEW
R	- REMOVE
RET	- RETAIN
R&S	- REMOVE & SALVAGE
S	- ERECTING SALVAGED SIGNS

PROJECT: <b>BERLIN</b>	PROJECT NO. : <b>IM 089-1 (20)</b>
DESIGN FILE NAME: 99a270\structures\99a270bdr.dgn	PLOT DATE: 05-DEC-2007
IPARM FILE NAME: s99a2701a3 sb.i	DRAWN BY: D.D.BEARD
DESIGNED BY: K.M.HIGGINS	CHECKED BY: R.S.YOUNG
SQUAD LEADER: C.P.WILLIAMS	SHEET: 21 OF 104
LAYOUT SOUTHBOUND 3	