

MILLED RUMBLE STRIPS
 STA 290+00.00 - STA 290+55.00 RT
 STA 295+55.00 - STA 296+25.00 RT

DURABLE 6" WHITE LINE, THERMOPLASTIC
 STA 290+00.00 - STA 296+25.00 RT
 STA 290+00.00 - STA 296+25.00 DASHED C

DURABLE 6" YELLOW LINE, THERMOPLASTIC
 STA 290+00.00 - STA 296+25.00 LT

REMOVAL AND DISPOSAL OF GUARDRAIL
 STA 290+00.00 - STA 290+82.70 LT
 STA 290+27.21 - STA 290+57.44 RT
 STA 295+39.15 - STA 296+50.00 RT
 STA 295+91.74 - STA 298+90.08 LT

SPECIAL PROVISION
 (GUARDRAIL APPROACH SECTION,
 TO F-SHAPE CONCRETE RAIL)
 STA 290+51.75 - STA 290+82.70 LT
 STA 290+27.20 - STA 290+57.45 RT
 STA 295+91.75 - STA 296+22.70 LT
 STA 295+39.15 - STA 295+69.35 RT

HD STEEL BEAM GUARDRAIL, GALVANIZED
 STA 290+00.00 - STA 290+51.75 LT
 STA 295+69.35 - STA 295+95.65 RT
 STA 296+22.70 - STA 296+25.00 LT

REMOVING SIGNS
 STA 290+49 RT
 STA 291+67 RT
 STA 292+93 RT
 STA 294+11 RT

TRAFFIC SIGNS, TYPE A
 STA 290+49 RT
 STA 291+67 RT
 STA 294+11 RT

ANCHOR FOR STEEL BEAM RAIL
 STA 295+86.00 RT

CHANGING ELEVATION OF DROP INLET,
 CATCH BASINS, OR MANHOLES
 STA 296+11.60 LT

SPECIAL PROVISION
 (BRIDGE RAILING, F-SHAPE CONCRETE).
 STA 290+82.70 - STA 295+91.75 LT
 STA 290+57.45 - STA 295+39.15 RT

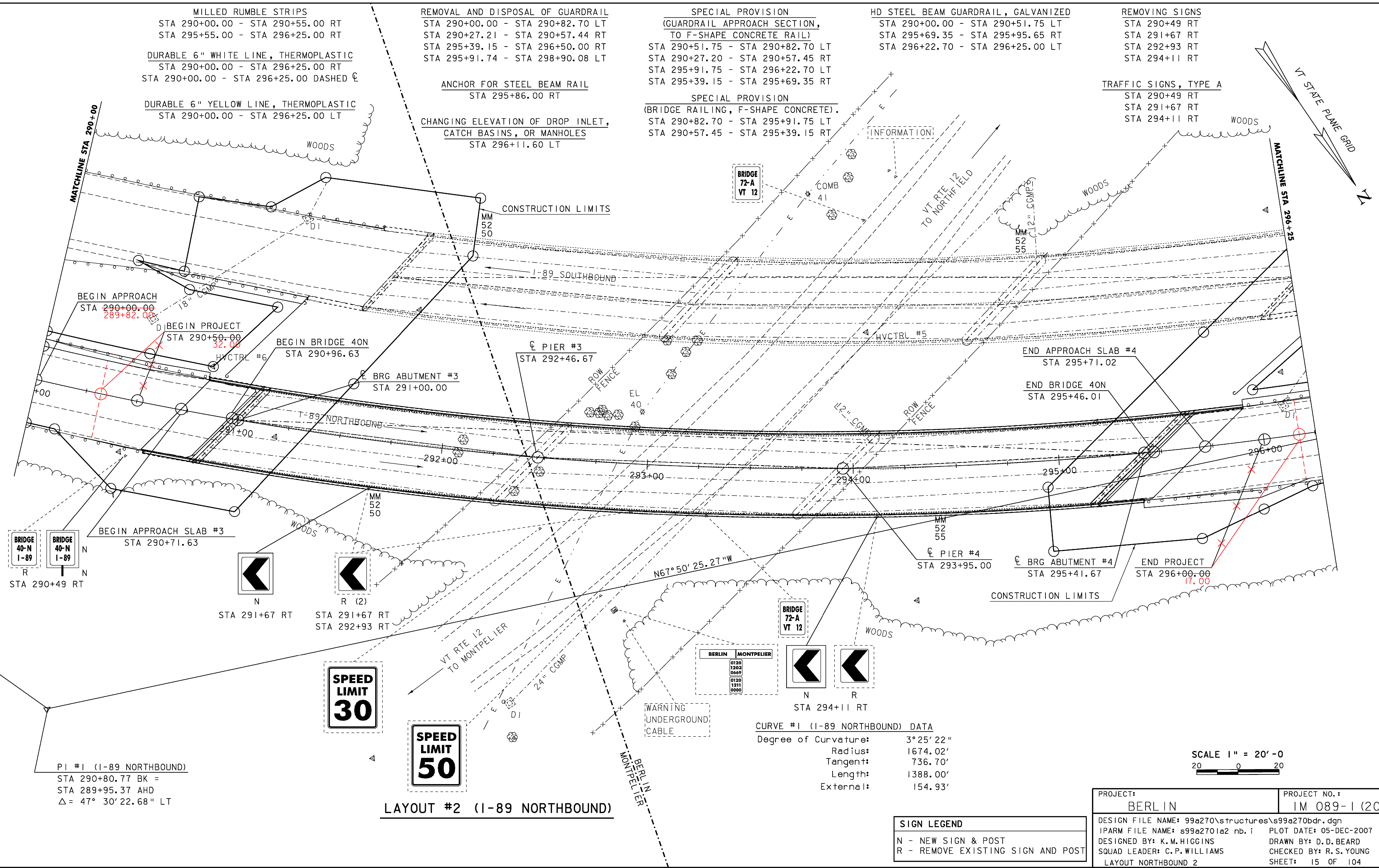

PI #1 (I-89 NORTHBOUND)
 STA 290+80.77 BK =
 STA 289+95.37 AHD
 $\Delta = 47^\circ 30' 22.68''$ LT

SPEED LIMIT 30

SPEED LIMIT 50

CURVE #1 (I-89 NORTHBOUND) DATA
 Degree of Curvature: 3°25'22"
 Radius: 1674.02'
 Tangent: 736.70'
 Length: 1388.00'
 External: 154.93'

SCALE 1" = 20' - 0
 20 0 20

LAYOUT #2 (I-89 NORTHBOUND)

SIGN LEGEND
 N - NEW SIGN & POST
 R - REMOVE EXISTING SIGN AND POST

PROJECT: BERLIN	PROJECT NO.: IM 089-1 (20)
DESIGN FILE NAME: s99a270\structures\s99a270bdr.dgn	PLOT DATE: 05-DEC-2007
IPARM FILE NAME: s99a2701a2 nb.i	DRAWN BY: D.D.BEARD
DESIGNED BY: K.M.HIGGINS	CHECKED BY: R.S.YOUNG
SQUAD LEADER: C.P.WILLIAMS	SHEET: 15 OF 104
LAYOUT NORTHBOUND 2	