

STATE OF VERMONT AGENCY OF TRANSPORTATION

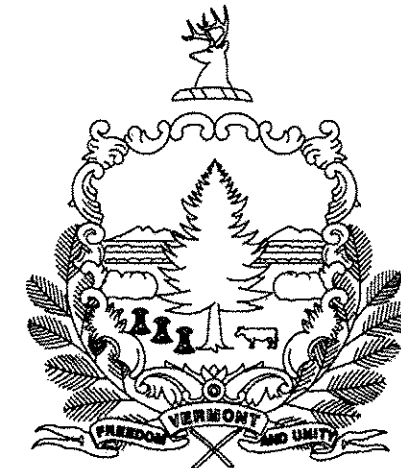

PROPOSED IMPROVEMENT BRIDGE PROJECT

TOWN OF BERLIN
COUNTY OF WASHINGTON
ROUTE NO.: INTERSTATE 89, BRIDGE 40 N & 40 S

PROJECT LOCATION: IN BERLIN ON INTERSTATE 89 NEAR MILE MARKER 52.5

PROJECT DESCRIPTION: REMOVAL AND REPLACEMENT OF THE BRIDGE DECK
AND PORTIONS OF THE SUBSTRUCTURE.
PAINT THE STRUCTURAL STEEL.

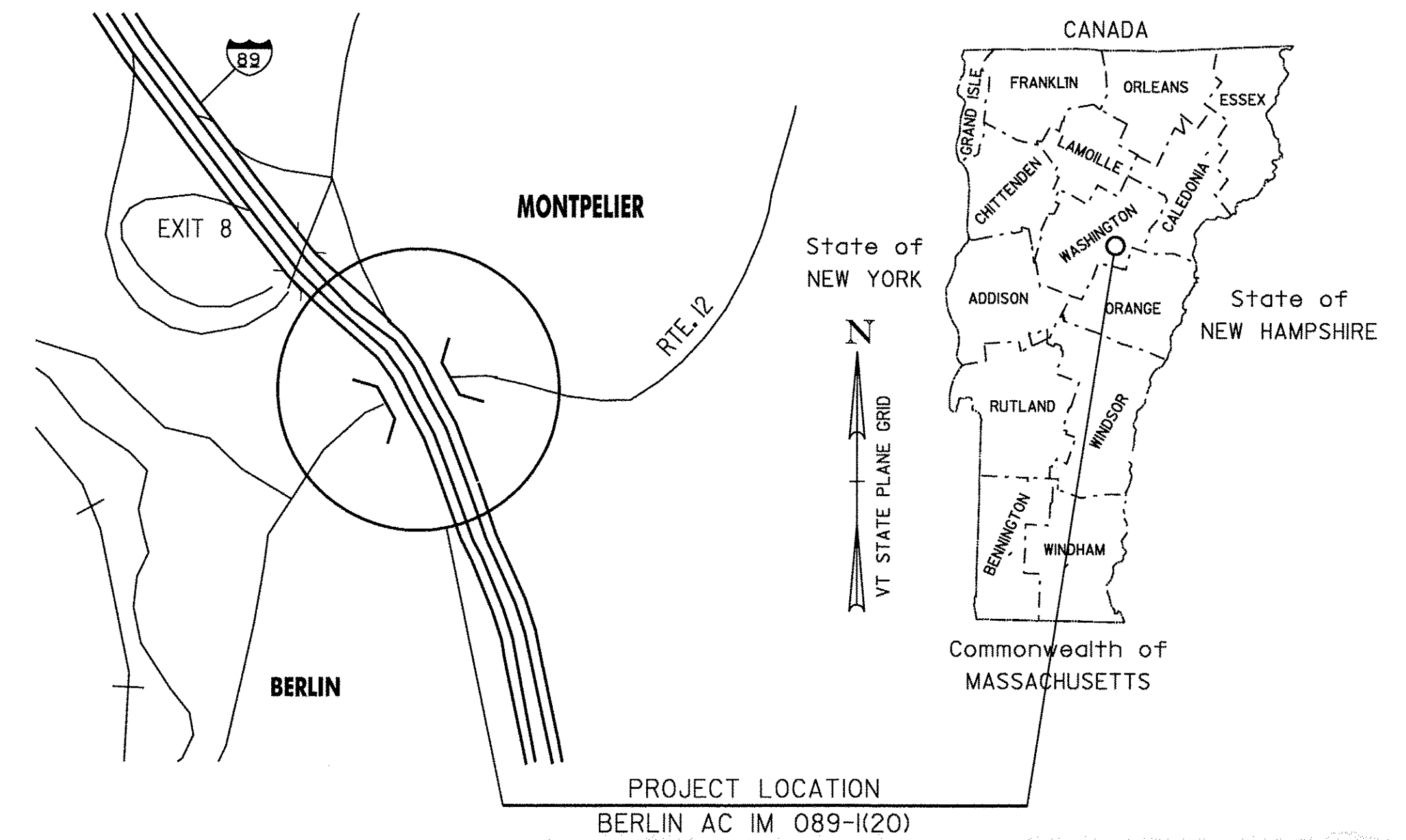

RECORD PLANS	
CONTRACTOR:	BECK & BELLUCCI INC. - FRANKLIN, NH
RESIDENT ENGINEER:	RICK HALE
CONSTRUCTION BEGAN:	APRIL 11, 2008
CONSTRUCTION COMPLETE:	APRIL 15, 2010
RECORD PLANS BY:	RICK HALE & AMOS KEMPTON
I HEREBY CERTIFY THAT ALL THE CONSTRUCTION REQUIRED BY THIS SET OF DRAWINGS HAS BEEN ACCOMPLISHED AS INDICATED HEREIN.	
BY	<i>Rick Hale</i> RESIDENT ENGINEER
DATE	11/3/11
NOTE: Any further information concerning final quantities, amounts or other details relative to this project may be found at Central Files in the electronic archives.	

BRIDGE 40S:
 LENGTH OF STRUCTURE = 449.39 FEET
 LENGTH OF ROADWAY = 100.61 FEET
 LENGTH OF PROJECT = 550.00 FEET

BRIDGE 40N:
 LENGTH OF STRUCTURE = 449.39 FEET
 LENGTH OF ROADWAY = 100.61 FEET
 LENGTH OF PROJECT = 550.00 FEET

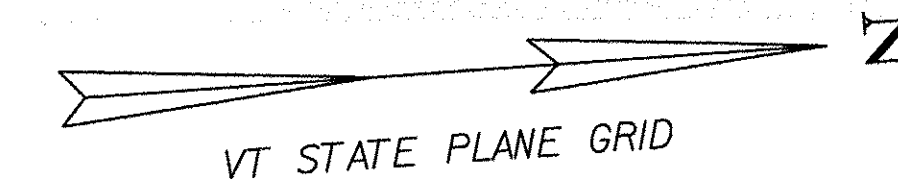
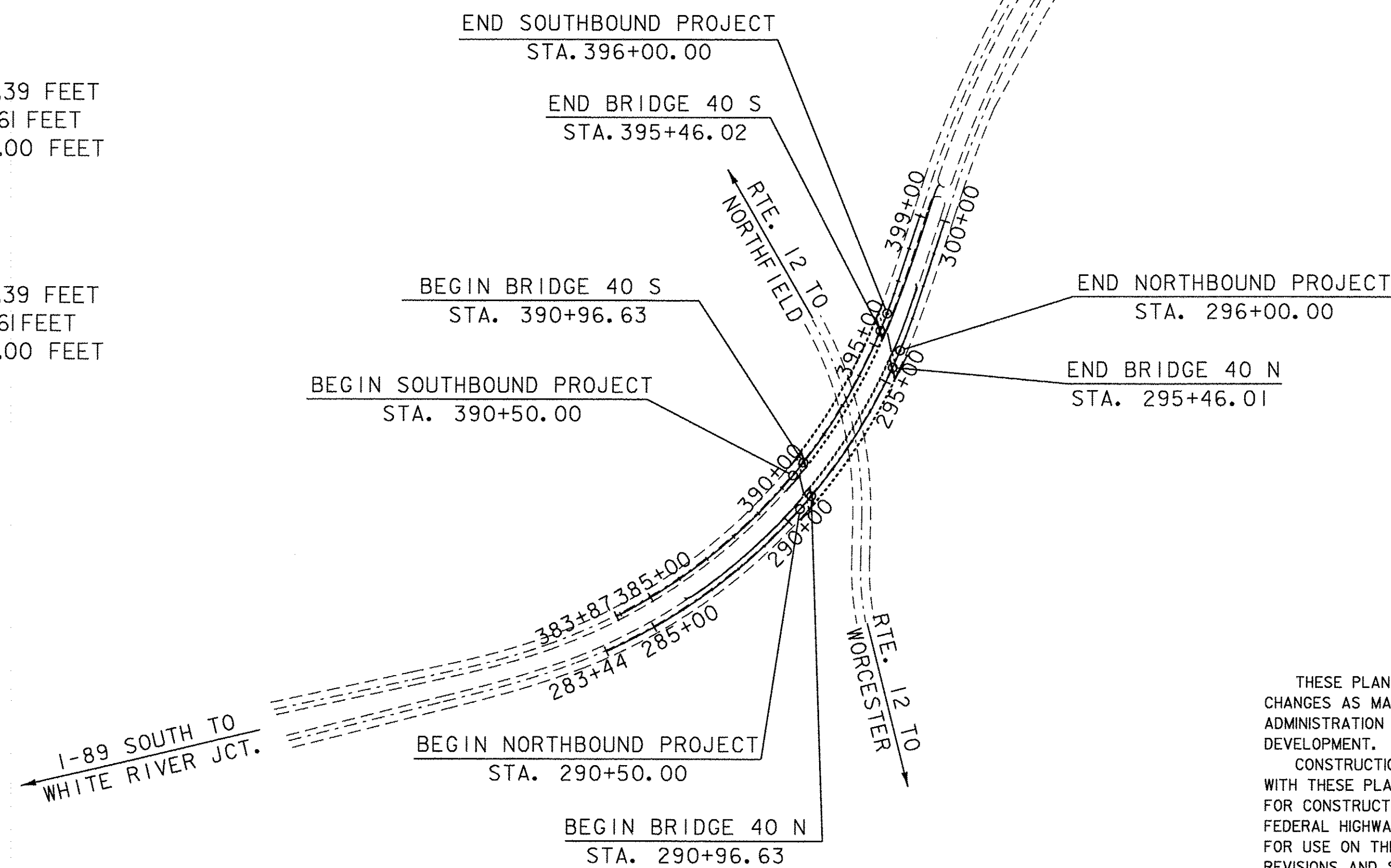

SCALE 1" = 300'-0"
 300 0 300

CONVENTIONAL SYMBOLS	
COUNTY LINE	
TOWN LINE	
LIMITS OF ACCESS	
POINT OF ACCESS	
FENCE LINE	
STONE WALL	
TRAVELED WAY	
GUARDED RAIL	
RAILROAD	
SURVEY LINE	
CULVERT	
POWER POLE	
TELEPHONE POLE	
TREES	
CONTROL OF ACCESS	
PROPERTY LINE	
R.O.W. TAKING LINE	
SLOPE RIGHTS	
TOP OF CUT	
TOE OF SLOPE	

SURVEYED BY :	R. GILMAN
SURVEYED DATE :	12-02-2001
DATUM	
VERTICAL	NAVD 88
HORIZONTAL	NAD - 83 (96)

THESE PLANS ARE SUBJECT TO SUCH ENGINEERING CHANGES AS MAY BE REQUIRED BY THE FEDERAL HIGHWAY ADMINISTRATION OR THE DIRECTOR OF PROGRAM DEVELOPMENT.
 CONSTRUCTION IS TO BE CARRIED ON IN ACCORDANCE WITH THESE PLANS AND THE STANDARD SPECIFICATIONS FOR CONSTRUCTION DATED 2006, AS APPROVED BY THE FEDERAL HIGHWAY ADMINISTRATION ON JUNE 15, 2006 FOR USE ON THIS PROJECT, INCLUDING ALL SUBSEQUENT REVISIONS AND SUCH REVISED SPECIFICATIONS AND SPECIAL PROVISIONS AS ARE INCORPORATED IN THESE PLANS.

PLOTTED 04-DEC-2007

DEPARTMENT OF TRANSPORTATION FEDERAL HIGHWAY ADMINISTRATOR	
APPROVED <i>Toel Kunkel</i>	DATE 12-21-07
DIRECTOR OF PROGRAM DEVELOPMENT	
APPROVED <i>Paul Johnson</i>	DATE 12/4/07
PROJECT MANAGER : C. P. WILLIAMS	
PROJECT NAME :	BERLIN
PROJECT NUMBER :	AC IM 089 - I (20)
SHEET 1 OF 104 SHEETS	