

ALL STATIONS AND OFFSETS ARE FROM ACTUAL SOUTHBOUND CENTERLINE STATIONS (SB CL), NOT OFFSET SURVEY BASELINE STATIONS.

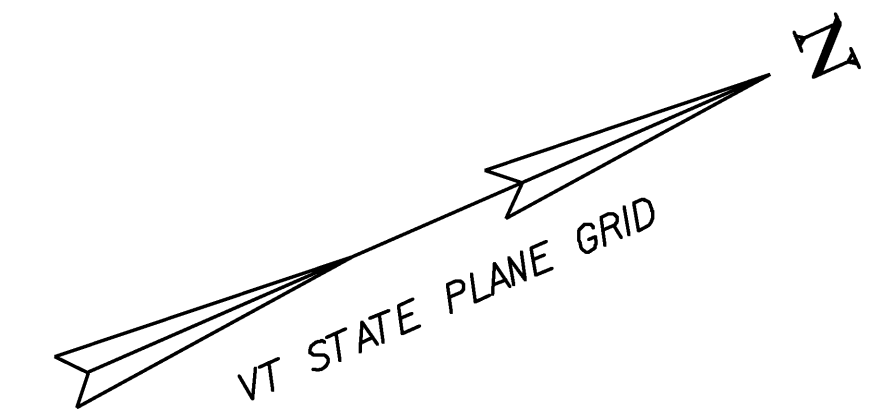

EMILY E. HOOD et al

**END ROW PROJECT SB I-91 MM 8676  
IM 091-2(72) STA. 4603+95 125.00' LT.**

TO ROW SHEET 4 OF 5  
MATCH LINE 4599+50

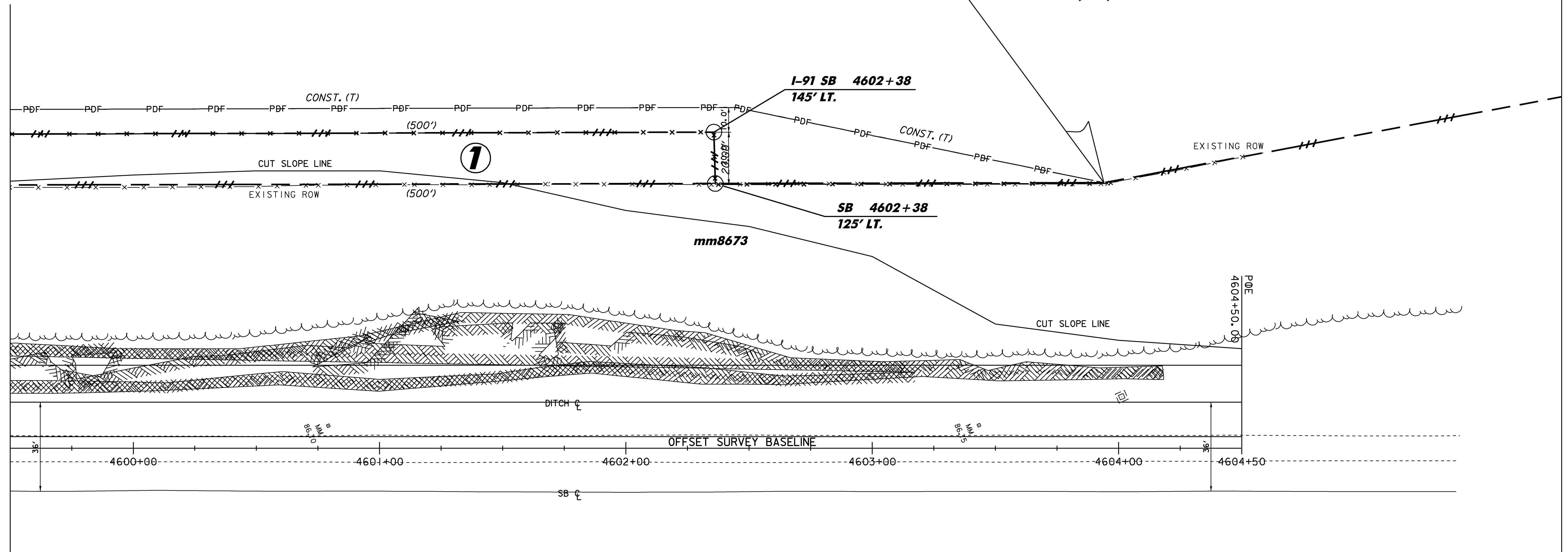

LEGEND	
PDF — PDF	PROJECT DEMARCATION FENCE
x — x — x — x	WOVEN WIRE FENCE WITH STEEL POSTS



LINES SHOWN ON THIS PLAN AS EXISTING PROPERTY LINES P/L ARE BELIEVED TO BE ACCURATE BUT SHOULD NOT BE RELIED UPON FOR PURPOSES UNRELATED TO THE STATE OF VERMONT'S ACQUISITION OF LAND AND RIGHTS FOR THIS PROJECT.

NOTE: ALIGNMENT IS THE CENTER POINT OF THE SHOULDER LINE AND EDGE OF PAVEMENT.

**FOR R.O.W. USE ONLY**

R.O.W. LAYOUT #2

PROJECT NAME:	HARTFORD - NEWBURY
PROJECT NUMBER:	IM 091-2(72)
FILE NAME:	d99a052_bdr_nul.dgn
PROJECT LEADER:	K. UPMAL
DESIGNED BY:	N. PAPPAS
ROW SHEET 5 OF 5	CHECKED BY: A. BOMBARDIER
	PLOT DATE: 21-JUL-2009
	DRAWN BY: N. PAPPAS
	SHEET 13 OF 45