

ALL STATIONS AND OFFSETS ARE FROM ACTUAL SOUTHBOUND CENTERLINE STATIONS(SB  $\zeta$ ), NOT OFFSET SURVEY BASELINE STATIONS.

**BEGIN ROW PROJECT SB I-91 MM 8661  
IM 091-2(72) STA. 4596+10 125.00' LT.**

EMILY E. HOOD et al

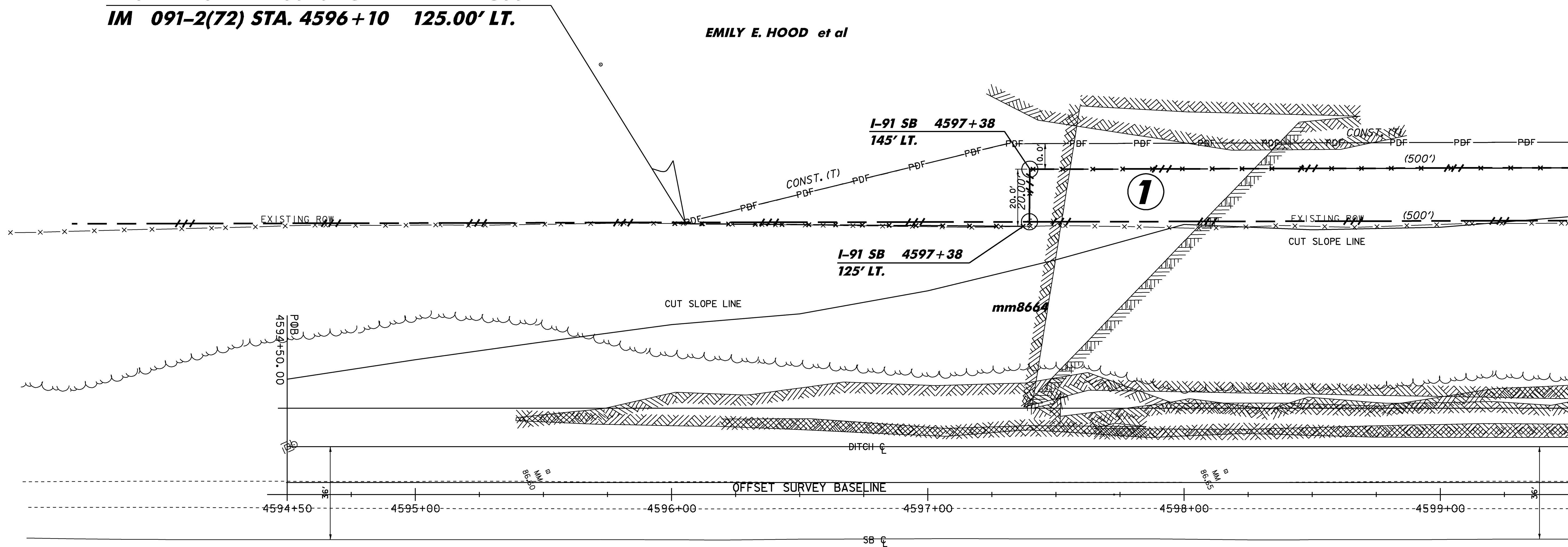

TO ROW SHEET 5 OF 5  
MATCH LINE 4599+50

LINES SHOWN ON THIS PLAN AS EXISTING PROPERTY LINES P/L ARE BELIEVED TO BE ACCURATE BUT SHOULD NOT BE RELIED UPON FOR PURPOSES UNRELATED TO THE STATE OF VERMONT'S ACQUISITION OF LAND AND RIGHTS FOR THIS PROJECT.

**FOR R.O.W. USE ONLY**

R.O.W. LAYOUT #1

LEGEND	
PDF ——— PDF	PROJECT DEMARCATION FENCE
x — x — x — x	WOVEN WIRE FENCE WITH STEEL POSTS



NOTE: ALIGNMENT IS THE CENTER POINT OF THE SHOULDER LINE AND EDGE OF PAVEMENT.

PROJECT NAME:	HARTFORD - NEWBURY
PROJECT NUMBER:	IM 091-2(72)
FILE NAME:	d99a052_bdr_nul.dgn
PROJECT LEADER:	K. UPMAL
DESIGNED BY:	N. PAPPAS
ROW SHEET 4 OF 5	
PLOT DATE:	21-JUL-2009
DRAWN BY:	N. PAPPAS
CHECKED BY:	A. BOMBARDIER
SHEET 12 OF 45	