

INDEX OF SHEETS

1	TITLE SHEET
2-3	PROJECT TYPICAL SHEETS
4-5	QUANTITY SHEETS
6	PAVING PROJECT LAYOUT - NORTHBOUND
7	PAVING PROJECT LAYOUT - SOUTHBOUND
8	RAMP DETAIL SHEET
9	WELCOME CENTER DETAIL SHEET
10	SIGN SUMMARY SHEET
11	CONSTRUCTION APPROACH SIGNING
12	EMERGENCY ACCESS TRAFFIC CONTROL PLAN

VAOT STANDARDS

C-1M	CURB DETAILS	06-13-97
D-8M	REINFORCED CONCRETE DROP INLET W/PRECAST COVER & GRATE	06-13-97
D-9M	REINFORCED CONCRETE DROP INLET TOPS	06-13-97
D-10M	REINFORCED CONCRETE DROP INLET TOPS	06-13-97
D-15M	CAST IRON GRATE (TYPE D & E)	06-13-97
D-16M	PRECAST REINF. CONC. CURB DROP INLET W/CAST IRON GRATE	06-13-97
E-100M	CONSTRUCTION APPROACH SIGNS	06-13-97
E-101M	CONSTRUCTION SIGN DETAILS	06-13-97
E-102M	CONSTRUCTION SIGN DETAILS	06-13-97
E-102AM	CONSTRUCTION SIGN DETAILS	06-13-97
E-103M	MAINLINE TRAFFIC CONTROL DIVIDED HIGHWAY - ONE LANE CLOSED	09-24-98
E-105M	TRAFFIC CONTROL FOR CONSTRUCTION VEHICLES U-TURNS ON DIVIDED HIGHWAYS	09-24-98
E-106M	TRAFFIC CONTROL - MISCELLANEOUS DETAILS	06-13-97
E-107M	DELINEATION, BARRICADES AND DETOURS FOR CONSTRUCTION AREAS	06-13-97
E-107AM	BREAKAWAY BARRICADE DETAILS	06-13-97
E-108M	CONSTRUCTION ZONE LONGITUDINAL DROP OFFS	06-13-97
E-108M	MAJOR MAINTENANCE OPERATION LANE CLOSURE	06-13-97
E-11M	MAINTENANCE OPERATION APPROACH SIGNS	02-17-98
E-120M	STANDARD SIGN PLACEMENT - FREEWAY/EXPRESSWAY	06-13-97
E-142M	REGULATORY SIGN DETAILS	06-13-97
E-143M	REGULATORY SIGN DETAILS	06-13-97
E-146M	REGULATORY SIGN DETAILS	06-13-97
E-150M	WARNING SIGN DETAILS	06-13-97
E-160M	FLANGED CHANNEL STEEL SIGN POST	06-13-97
E-162M	TUBULAR ALUMINUM SIGN POST	06-13-97
E-164M	SQUARE STEEL SIGN POST	06-13-97
E-191M	PAVEMENT MARKING DETAILS	06-13-97
E-192M	PAVEMENT MARKING DETAILS	10-13-98
E-193M	PAVEMENT MARKING DETAILS	06-13-97

RECORD PLANS

CONTRACTOR: PIKE INDUSTRIES, BELMONT, N.H.
 RESIDENT ENGINEER: CLARK, ROSS
 CONSTRUCTION BEGAN: June 14, 1999
 RECONSTRUCTION COMPLETE: 8-2-99
 RECORD PLANS BY: CADD

I HEREBY CERTIFY THAT ALL THE CONSTRUCTION REQUIRED BY THIS SET OF DRAWINGS HAS BEEN ACCOMPLISHED AS INDICATED HEREIN.
 BY: [Signature] RESIDENT ENGINEER
 DATE: 02/14/01

NOTE: Any further information concerning final quantities, amounts or other details relating to this project may be found on microfilm in Central Files.

CONVENTIONAL SIGNS

COUNTY LINE	---
TOWN LINE	---
LIMITS OF ACCESS	○---○
POINT OF ACCESS	X
FENCE LINE	x-x-x-x
STONE WALL	-----
TRAVELED WAY	=====
GUARD RAIL	○-○-○-○-○
RAILROAD	
SURVEY LINE	---
CULVERT	---
POWER POLE	⊕
TELEPHONE POLE	⊕
TREES	●
CONTROL OF ACCESS	---
PROPERTY LINE	---
R.O.W. TAKING LINE	---
SLOPE RIGHTS	○---SR
TOP OF CUT	△
TOE OF SLOPE	○

DATUM	
VERTICAL	N/A
HORIZONTAL	N/A

BY: [Signature]
 CIVIL ENGINEERING ASSOCIATES, INC.
 SHELBURNE, VERMONT

STATE OF VERMONT
 AGENCY OF TRANSPORTATION



PROPOSED IMPROVEMENTS
 TOWN OF WATERFORD
 COUNTY OF CALEDONIA
 INTERSTATE ROUTE 93

BEGINNING AT THE VERMONT/NEW HAMPSHIRE STATE LINE IN THE TOWN OF WATERFORD, STA 0+000 (MM 0.000) AND EXTENDING NORTHERLY ALONG INTERSTATE 93, NORTHBOUND AND SOUTHBOUND LANES, FOR A DISTANCE OF APPROXIMATELY 17,823 METERS (11.075 MILES) TO STA 17+823.4 (MM 11.075) AT THE INTERCHANGE WITH INTERSTATE ROUTE 91.

STATION TO STATION DATA	LENGTH (METERS)	(MILES)
TOWN OF WATERFORD NORTHBOUND STA 0+000 TO STA 17+823.4 (MM 0.000 TO MM 11.075)	17,823.4	11.075
SOUTHBOUND STA 0+000 TO STA 17+823.4 (MM 0.000 TO MM 11.075)	17,823.4	11.075
PROJECT TOTALS	35,646.8	22.150

WORK TO BE PERFORMED UNDER THIS PROJECT INCLUDES COLD PLANING AND RESURFACING OF THE NORTHBOUND AND SOUTHBOUND TRAVEL LANES AND INTERCHANGE I RAMP, THEN A FULL WIDTH OVERLAY INCLUDING THE U-TURNS, NEW PAVEMENT MARKINGS AND INCIDENTAL ITEMS.

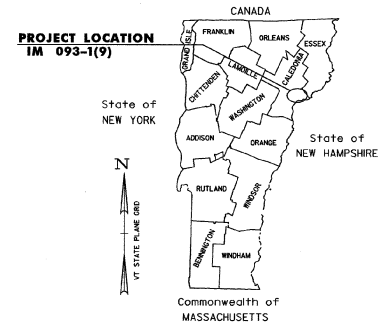
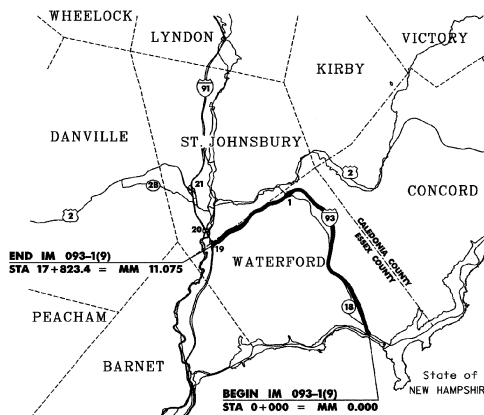

TRAFFIC DATA

WATERFORD I-93, MM 0.000 TO MM 11.075 NORTHBOUND					
TRAFFIC SECTION	ADT		DHV		ESAL'S (1999-2019)
	1999	2019	1999	2019	
N.H. STATE LINE TO INTERCHANGE #1 STA 0+000 TO INTERCHANGE	1900	2600	290	400	1,768,000
INTERCHANGE #1 TO END OF PROJECT INTERCHANGE TO STA 17+823	2700	4300	415	660	8,263,000

WATERFORD I-93, MM 0.000 TO MM 11.075 SOUTHBOUND					
TRAFFIC SECTION	ADT		DHV		ESAL'S (1999-2019)
	1999	2019	1999	2019	
N.H. STATE LINE TO INTERCHANGE #1 STA 0+000 TO INTERCHANGE	2000	2700	305	415	1,707,000
INTERCHANGE #1 TO END OF PROJECT INTERCHANGE TO STA 17+823	2400	3900	365	595	3,213,000

WATERFORD I-93, MM 0.000 TO MM 11.075 BITUMINOUS CONCRETE PAVEMENT SUPERPAVE MIXTURE DESIGN CRITERIA	
DESIGN LANE/DESIGN LIFE ESAL	8,263,000
DESIGN NUMBER OF GYRATIONS	96
PERFORMANCE GRADED ASPHALT BINDER	PG 58-34

RIGHT-OF-WAY LIMITS, IF APPLICABLE, ARE PROVIDED SOLELY FOR THE CONVENIENCE OF THE STATE AND ITS CONTRACTOR DURING THE COURSE OF THIS PAVING PROJECT. ANY REFERENCES TO OFFSETS ON THESE PLANS ARE APPROXIMATE AND SHOULD NOT BE RELIED UPON FOR ANY OTHER PURPOSES.

UNLESS OTHERWISE NOTED, ALL DRAWINGS AND DETAILS ON THESE PLANS ARE DRAWN 'NOT TO SCALE'.



THESE PLANS ARE SUBJECT TO SUCH ENGINEERING CHANGES AS MAY BE REQUIRED BY THE FEDERAL HIGHWAY ADMINISTRATION OR THE DIRECTOR OF PROJECT DEVELOPMENT.

CONSTRUCTION IS TO BE CARRIED ON IN ACCORDANCE WITH THESE PLANS AND THE STANDARD SPECIFICATIONS FOR CONSTRUCTION DATED 1995, AS APPROVED BY THE FEDERAL HIGHWAY ADMINISTRATION ON AUGUST 26, 1995 FOR USE ON THIS PROJECT, INCLUDING ALL SUBSEQUENT REVISIONS AND SUCH REVISED SPECIFICATIONS AND SPECIAL PROVISIONS AS ARE INCORPORATED IN THESE PLANS.

APPROVED	<u>[Signature]</u>	DATE	<u>3/1/99</u>
DIRECTOR OF PROJECT DEVELOPMENT			
DEPARTMENT OF TRANSPORTATION FEDERAL HIGHWAY ADMINISTRATION			
APPROVED	<u>[Signature]</u>	DATE	<u>2-24-99</u>
DIVISION ADMINISTRATOR			
PROJECT	WATERFORD IM 093-1(9)		
SHEET 1 OF 12 SHEETS			

NOTES

1. THE PAVEMENT WEARING COURSE SHALL BE TYPE IIS EXCEPT FOR THE BRIDGES. SEE SHEET 3 FOR DETAILS. THE LEVELING COURSE SHALL BE TYPE IVS UNLESS OTHERWISE DIRECTED BY THE RESIDENT ENGINEER. LEVELING HAS BEEN INCLUDED TO RESHAPE THE TRAVEL LANES AFTER COLD PLANING AND SHOULDERS PRIOR TO PAVING THE TOP COURSE. FOR THE SHOULDERS, AN ESTIMATED THICKNESS OF 15mm OF ITEM 406.30 HAS BEEN INCLUDED THROUGHOUT THE PROJECT LIMITS. ALL ASPHALT CEMENT USED IN THE SUPERPAVE BITUMINOUS CONCRETE PAVEMENT SHALL BE PG 58-34.
2. EMULSIFIED ASPHALT SHALL BE APPLIED ON EXISTING PAVEMENT SURFACES, BETWEEN ALL COURSES OF PAVEMENT AND ON COLD PLANED SURFACES AT THE RATE OF 0.07 L/SM OR AS DIRECTED BY THE RESIDENT ENGINEER.
3. SUPERPAVE BITUMINOUS CONCRETE PAVEMENT TOLERANCE = +/- 5 mm (TOTAL THICKNESS).
4. COLD PLANING TO BE COMPLETED ACCORDING TO THE TYPICAL OR AS NOTED OTHERWISE ON THE PLANS. A FULL DEPTH BUTT JOINT SHALL BE CONSTRUCTED AT THE PROJECT BEGINNING/END AND AT ALL RAMP APPROACHES AS DENOTED ON THE PROJECT PLANS OR AS OTHERWISE DIRECTED BY THE RESIDENT ENGINEER.
5. ITEMS 604.40, 604.412, 604.415 & 604.418 ARE ESTIMATED QUANTITIES AND SHALL BE PERFORMED AS DIRECTED BY THE RESIDENT ENGINEER. ALL D.I.'S SHALL BE RAISED OR REHABILITATED SUCH THAT THE NEW GRATE ELEVATION IS LEVEL WITH THE SURROUNDING TERRAIN.
6. AREAS ADJACENT TO THE SHOULDER, WHERE EXISTING GUARD RAIL IS BEING RETAINED, THAT HAVE BUILT UP EXCESS MATERIAL ARE TO BE GRADED IN ORDER TO ALLOW THE SHOULDER TO DRAIN. PAYMENT IS UNDER ITEM 203.99, SHOULDER BERM REMOVAL.
7. ALL EDGES OF PAVEMENT AND TREATED TIMBER CURB SHALL BE BACKED UP FULL HEIGHT WITH COLD PLANE GRINDINGS AS DIRECTED BY THE RESIDENT ENGINEER AND WILL BE PAID FOR UNDER ITEM 402.12, AGGREGATE SHOULDERS (MOD.)
8. GRASS GROWING ADJACENT TO PAVEMENT, OR THROUGH CRACKS IN THE PAVEMENT, WHICH MAY HAMPER THE PLACEMENT OF NEW BITUMINOUS CONCRETE, SHALL BE REMOVED BY THE CONTRACTOR, AS DIRECTED BY THE ENGINEER. PAYMENT FOR THIS WORK WILL NOT BE MADE DIRECTLY, BUT WILL BE CONSIDERED SUBSIDIARY TO ITEM 406.30, SUPERPAVE BITUMINOUS CONCRETE PAVEMENT (PG 58-34).

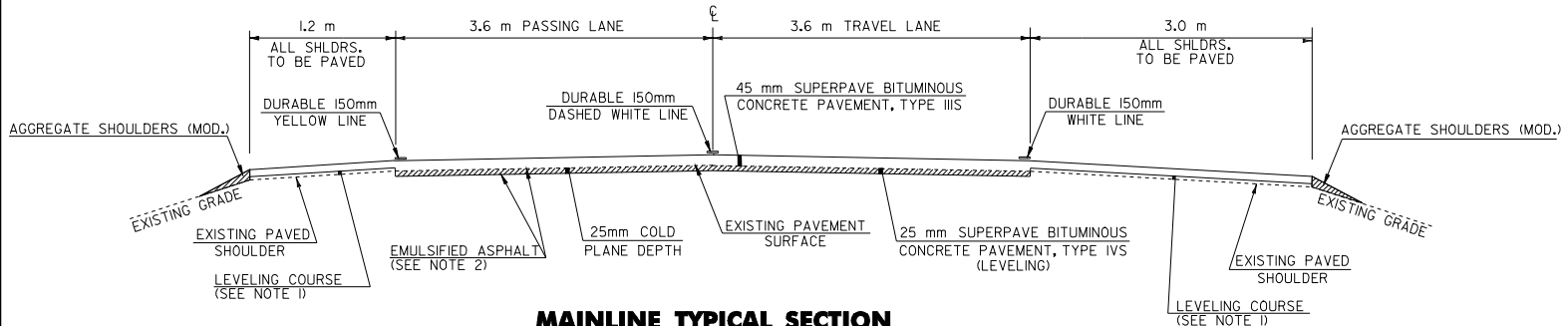

MAINLINE TYPICAL SECTION
WATERFORD
NORTHBOUND/SOUTHBOUND
STA 0+000 TO 17+823

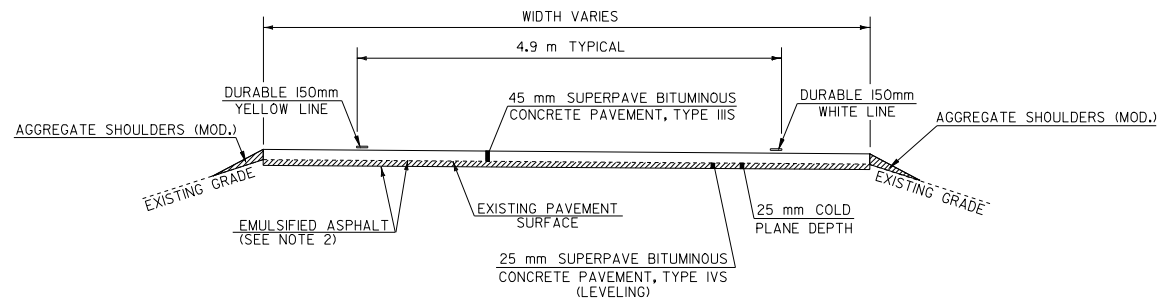

RAMP PAVEMENT TYPICAL
LOCATION
 INTERCHANGE 1
 ON & OFF RAMPS - SEE DETAILS SHEET 8

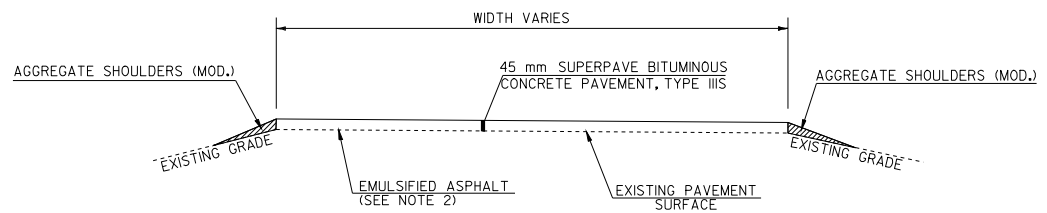

U-TURN PAVEMENT TYPICAL
LOCATION
 STA 0+283
 STA 1+070
 STA 5+240
 STA 5+240 RT - SB (EMERGENCY VEHICLE ACCESS)
 STA 8+764
 STA 11+522
 STA 12+689
 STA 14+754
 STA 17+700

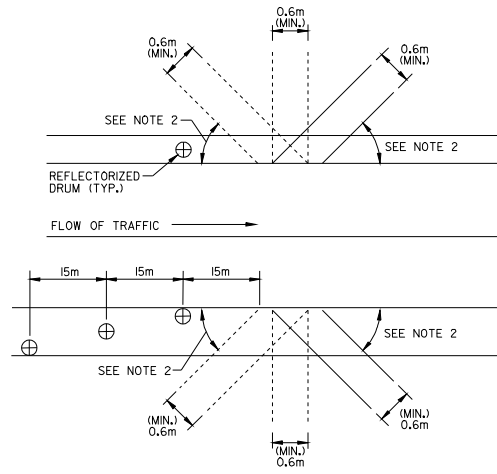

BLEEDER DETAIL

- NOTES:
1. BLEEDERS ARE TO BE CUT WHILE COLD PLANING, AT LOCATIONS SPECIFIED BY THE RESIDENT ENGINEER.
 2. ANGLE BLEEDERS TO BEST ACCEPT WATER FLOW.
 3. CUT ALL BLEEDERS TO THE DEPTH OF COLD PLANING AND GRADE TO DRAIN. PAYMENT SUBSIDIARY TO ITEM 210.10.
 4. BLEEDERS ARE TO BE FILLED DURING PAVING WITH ITEM 406.30 OR AS DESIGNATED BY THE RESIDENT ENGINEER.
 5. REFLECTORIZED DRUMS MUST BE PLACED AS SHOWN TO WARN MOTORISTS OF THE GAP IN THE SHOULDER.
 6. BLEEDERS ARE NOT REQUIRED IF THE COLD PLANED AREAS ARE PAVED BACK THE SAME DAY.



ARCHIVED ON CADD

PROJECT TYPICAL SHEET #1	DESIGNED BY	BCE/PJM	DATE	10-98
	DRAWN BY	C.E.A., INC.	DATE	10-98
	DESIGN FILE NO.	/pave/98g020/pa020.dgn		
	PRF FILE	pa020pt1.l	DATE PLOTTED	29-MAR-2001
	PROJ. NAME	WATERFORD		
PROJ. NO.	IM 093-1(9)			
SHEET	2	OF	12	SHEETS

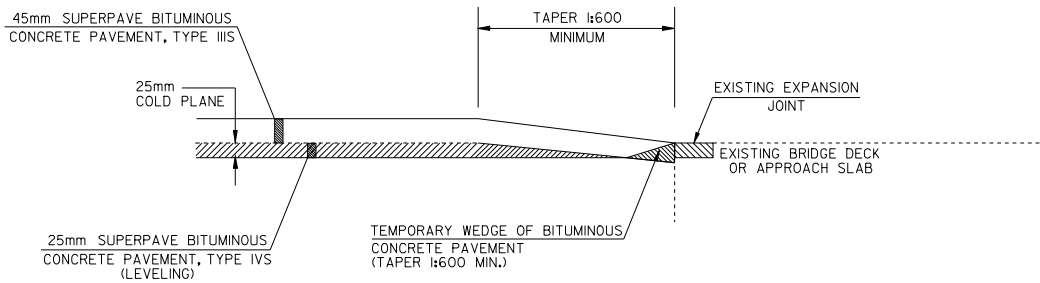

BRIDGE APPROACH DETAIL @ BEGINNING OF PROJECT

LOCATION
 STA 0+000 - SOUTHBOUND
 STA 0+000 - NORTHBOUND

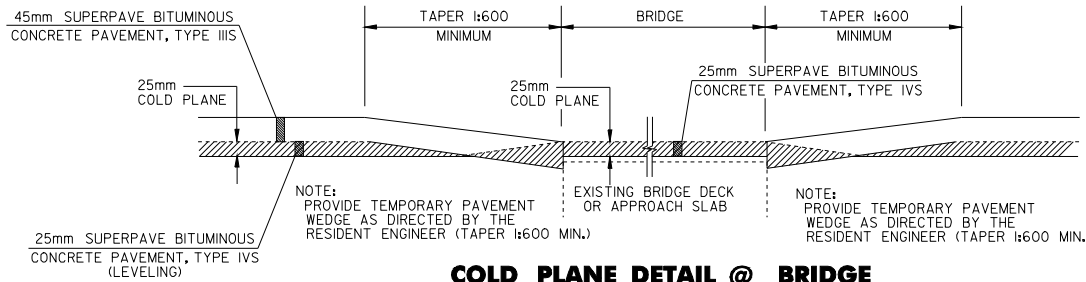

COLD PLANE DETAIL @ BRIDGE

LOCATION
NORTHBOUND
 BRIDGE #1-N, STA 0+590 NB
 BRIDGE #3-N, STA 7+403 NB
 BRIDGE #5-N, STA 10+275 NB
SOUTHBOUND
 BRIDGE #1-S, STA 0+590 SB
 BRIDGE #3-S, STA 7+403 SB
 BRIDGE #5-S, STA 10+275 SB

NOTE:
 SPECIAL PRECAUTIONS MUST BE TAKEN TO PREVENT DAMAGE TO THE EXISTING MEMBRANES AT BRIDGES. THE CONTRACTOR SHALL PERFORM COLD PLANING WITH CAUTION AT THESE LOCATIONS. ANY DAMAGES WHICH MAY OCCUR TO THE MEMBRANE, AS A RESULT OF THIS PROJECT, WILL BE THE RESPONSIBILITY OF THE CONTRACTOR AND WILL BE REPLACED AT NO COST TO THE STATE.

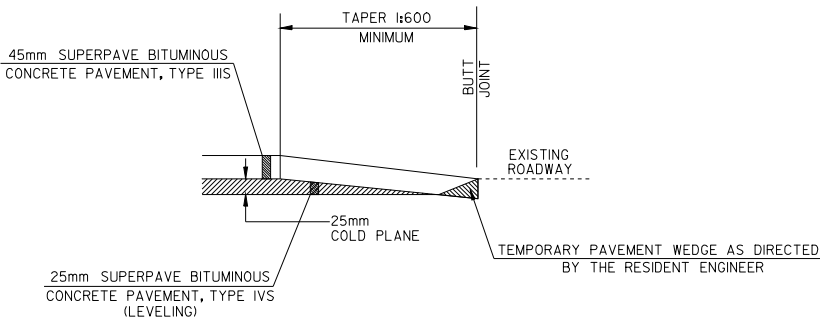

MAINLINE APPROACH AREA DETAIL @ END OF PROJECT

LOCATION
 STA 17+823 - SOUTHBOUND
 STA 17+823 - NORTHBOUND

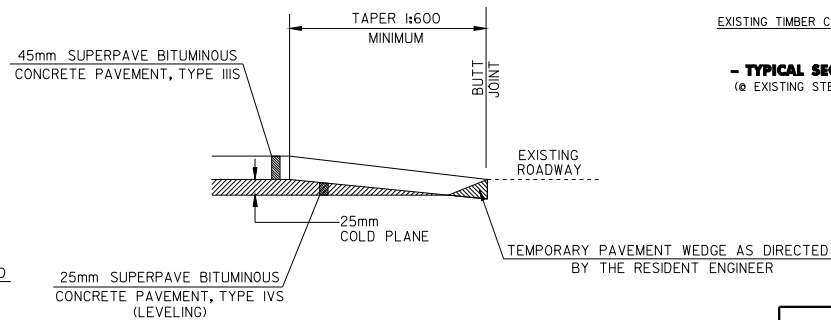

RAMP APPROACH AREA DETAIL

LOCATION
 EXIT 1 - SOUTHBOUND ON RAMP
 EXIT 1 - SOUTHBOUND OFF RAMP
 EXIT 1 - NORTHBOUND OFF RAMP
 EXIT 1 - NORTHBOUND ON RAMP

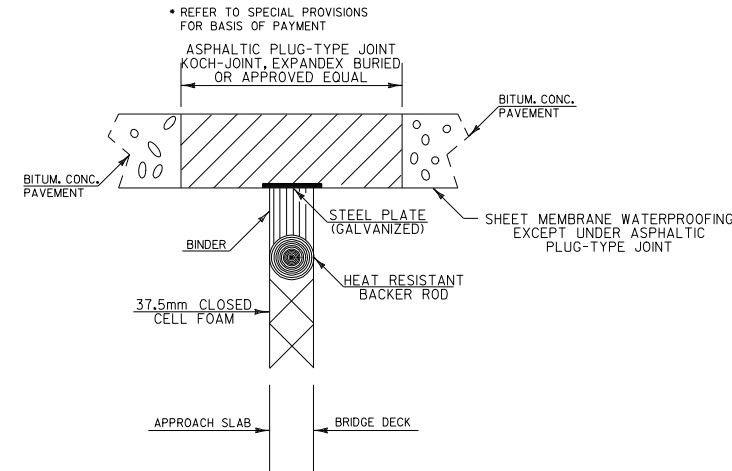

-WIDE BAND PAVEMENT JOINT DETAIL-

LOCATION
NORTHBOUND BOTH
 BRIDGE #1-N (16m), STA 0+590 NB @ EXPANSION JOINTS
 BRIDGE #3-N (11.5m), STA 7+403 NB @ EXPANSION JOINT
 BRIDGE #5-N (17.5m), STA 10+275 NB @ EXPANSION JOINT
SOUTHBOUND BOTH
 BRIDGE #1-S (15m), STA 0+590 SB @ EXPANSION JOINTS
 BRIDGE #3-S (11.5m), STA 7+403 SB @ EXPANSION JOINT
 BRIDGE #5-S (16.5m), STA 10+275 SB @ EXPANSION JOINT

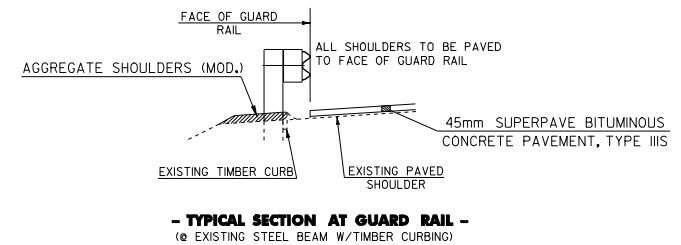

- TYPICAL SECTION AT GUARD RAIL -
 (@ EXISTING STEEL BEAM W/ TIMBER CURBING)

ARCHIVED ON CADD



PROJECT TYPICAL SHEET #2

DESIGNED BY BCE/PJM DATE 10-98
 DRAWN BY C.E.A., INC. DATE 10-98
 DESIGN FILE NO. /pave/98a020/pa020.dgn
 PRF FILE pa020p+2.i DATE PLOTTED 29-MAR-2001
 PROJ. NAME **WATERFORD**
 PROJ. NO. **IM 093-1(9)**
 SHEET **3** OF **12** SHEETS

**INTERSTATE ROUTE 93
NORTHBOUND
STA 0+000
(MM 0.000)
BEGIN PROJECT IM 093-1(9)**

**INTERSTATE ROUTE 93
NORTHBOUND
STA 17+823.4
(MM 11.075)
END OF PROJECT IM 093-1(9)**

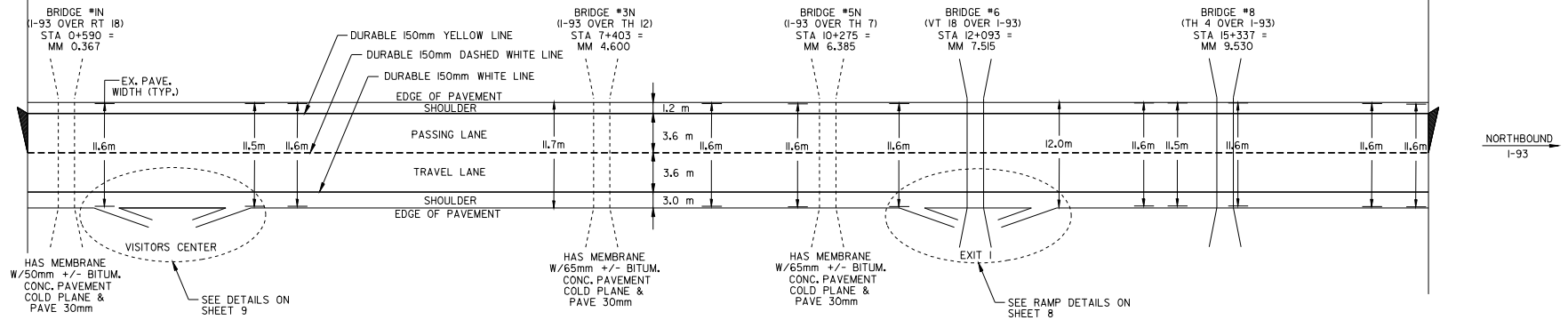

TEMPORARY AND DURABLE 150mm WHITE LINE
STA 0+000 TO 17+823 SOLID RT
STA 0+000 TO 17+823 DASHED C.L.

TEMPORARY AND DURABLE 150mm YELLOW LINE
STA 0+000 TO 17+823 SOLID LT

CHANGING ELEVATION/REHABILITATION OF D.I., C.B., OR M.H.

STA 0+068 RT - NB
STA 0+073 LT - NB
STA 0+205 RT - NB
STA 0+542 RT - NB
STA 0+550 LT - NB
STA 3+029 LT - NB
STA 3+121 LT - NB
STA 3+194 LT - NB
STA 3+285 LT - NB
STA 3+368 LT - NB
STA 7+447 LT - NB
STA 7+527 LT - NB
STA 7+599 LT - NB
STA 7+677 LT - NB
STA 8+491 LT - NB
STA 8+555 LT - NB
STA 8+626 LT - NB
STA 9+070 LT - NB
STA 9+160 LT - NB
STA 9+252 LT - NB
STA 10+226 RT - NB
STA 10+242 LT - NB
STA 10+304 RT - NB
STA 14+007 RT - NB
STA 14+082 RT - NB
STA 16+910 LT - NB
STA 16+978 LT - NB

TREATED-TIMBER-CURBING-
~~STA 7+453 TO 7+677 LT - NB~~
~~STA 8+406 TO 8+626 LT - NB~~
~~STA 14+007 TO 14+169 RT - NB~~

NOTE:
THERE ARE TWO TRAFFIC COUNTER LOOPS (ONE IN THE PASSING LANE, ONE IN THE TRAVEL LANE) AT STATION 12+730 +/- (NB). FOR ADDITIONAL INFORMATION, SEE THE SPECIAL PROVISIONS & CONTACT DAVE GOSSELIN @ 828-2694

PAVEMENT CORE DATA
4/9/98

CORE #	ROUTE	DIR	STATION - (MM)	DEPTH	PCC	COMMENTS
8	I-93	NB	3+460 (2,15)	210mm	NO	TRAVEL LANE, 64mm TOP, 146mm TYPE I.
9	I-93	NB	3+460 (2,15)	51mm	NO	TRAVEL LANE SHOULDER.
10	I-93	NB	3+460 (2,15)	64mm	NO	PASSING LANE SHOULDER.



**ARCHIVED
ON CADD**

**PAVING PROJECT
LAYOUT
(NORTHBOUND)**

DESIGNED BY BCE/PJM DATE 9-98
DRAWN BY C.E.A., INC. DATE 9-98
DESIGN FILE NO. /pave/98a020/pa020.dgn
PRF FILE pa020i01.i DATE PLOTTED 29-MAR-2001
PROJ. NAME **WATERFORD**
PROJ. NO. **IM 093-1(9)**
SHEET **6** OF **12** SHEETS

**INTERSTATE ROUTE 93
SOUTHBOUND
STA 0+000
(MM 0.000)
BEGIN PROJECT IM 093-1(9)**

**INTERSTATE ROUTE 93
SOUTHBOUND
STA 17+823.4
(MM 11.075)
END OF PROJECT IM 093-1(9)**

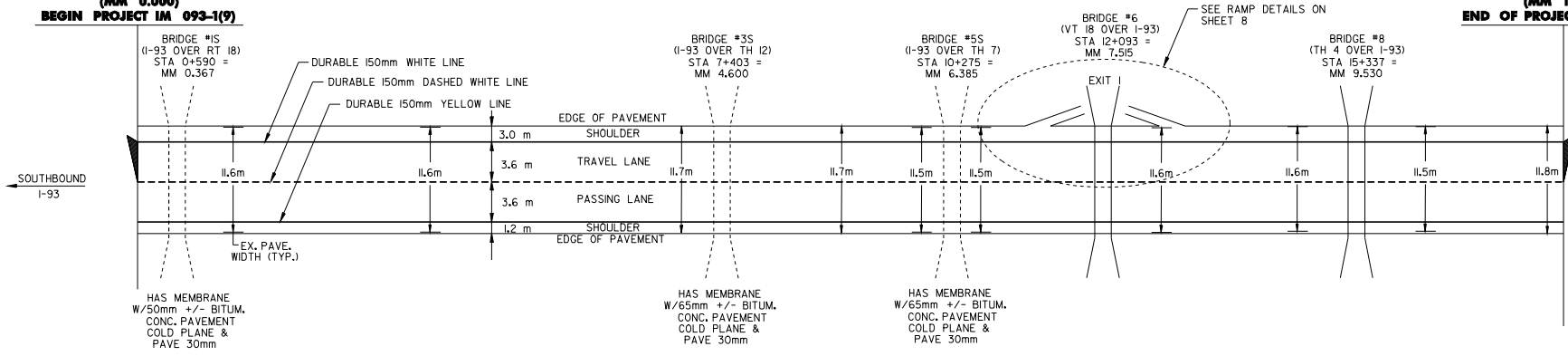

TEMPORARY AND DURABLE 150mm WHITE LINE
STA 0+000 TO 17+823 SOLID RT.
STA 0+000 TO 17+823 DASHED C.L.

TEMPORARY AND DURABLE 150mm YELLOW LINE
STA 0+000 TO 17+823 SOLID LT

CHANGING ELEVATION/REHABILITATION OF D.J., C.B., OR M.H.

- STA 0+583 LT - SB
- STA 0+591 RT - SB
- STA 1+852 RT - SB
- STA 1+944 RT - SB
- STA 2+041 RT - SB
- STA 2+120 RT - SB
- STA 2+223 RT - SB
- STA 2+837 RT - SB
- STA 2+930 RT - SB
- STA 3+007 RT - SB
- STA 3+099 RT - SB
- STA 3+194 RT - SB
- STA 3+285 RT - SB
- STA 3+793 RT - SB
- STA 3+886 RT - SB
- STA 3+979 RT - SB
- STA 4+071 RT - SB
- STA 4+162 RT - SB
- STA 4+255 RT - SB
- STA 5+805 RT - SB
- STA 5+875 RT - SB
- STA 5+966 RT - SB
- STA 6+042 RT - SB
- STA 6+433 RT - SB
- STA 6+224 RT - SB
- STA 6+301 RT - SB
- STA 6+384 RT - SB
- STA 7+415 RT - SB
- STA 7+520 RT - SB
- STA 7+803 RT - SB
- STA 7+881 RT - SB
- STA 9+051 RT - SB
- STA 9+144 RT - SB
- STA 9+220 RT - SB
- STA 9+401 RT - SB
- STA 10+125 RT - SB
- STA 10+214 RT - SB
- STA 10+421 RT - SB
- STA 14+048 LT - SB
- STA 14+114 LT - SB
- STA 14+802 RT - SB
- STA 14+865 RT - SB
- STA 16+300 LT - SB
- STA 16+383 LT - SB
- STA 17+355 LT - SB
- STA 17+429 LT - SB
- STA 17+505 LT - SB
- STA 17+583 LT - SB
- STA 17+644 LT - SB

~~TREATED TIMBER CURBING~~
~~STA 1+850 TO 2+284 RT - SB~~
~~STA 3+793 TO 4+319 RT - SB~~
~~STA 7+697 TO 7+885 RT - SB~~
~~STA 16+229 TO 16+383 LT - SB~~
~~STA 17+303 TO 17+644 LT - SB~~

NOTE:
THERE ARE TWO TRAFFIC COUNTER LOOPS (ONE IN THE PASSING LANE, ONE IN THE TRAVEL LANE) AT STATION 12+730 +/- (SB). FOR ADDITIONAL INFORMATION, SEE THE SPECIAL PROVISIONS & CONTACT DAVE GOSSELIN @ 828-2694

PAVEMENT CORE DATA
4/9/98

CORE #	ROUTE	DIR	STATION - (MM)	DEPTH	PCC	COMMENTS
1	I-93	SB	16+980 (10.55)	51mm	NO	SHOULDER RIGHT, SOLID, SHOULDER CRACKED
2	I-93	SB	16+980 (10.55)	178mm	NO	TRAVEL LANE, ON A CRACK THAT HAS BEEN FILLED.
3	I-93	SB	10+540 (6.55)	190mm	NO	TRAVEL LANE, 63mm 406
4	I-93	SB	10+540 (6.55)	32mm	NO	SHOULDER, ALL CRACKED.
5	I-93	SB	10+540 (6.55)	50mm	NO	PASSING LANE SHOULDER, TRANSVERSE CRACKING.
6	I-93	SB	2+330 (1.45)	38mm	NO	TRAVEL LANE SHOULDER.
7	I-93	SB	2+330 (1.45)	216mm	NO	TRAVEL LANE, 64mm TOP.

**ARCHIVED
ON CADD**

**PAVING PROJECT
LAYOUT
(SOUTHBOUND)**



DESIGNED BY	BCE/PJM	DATE	9-98
DRAWN BY	C.E.A., INC.	DATE	9-98
DESIGN FILE NO.	/pave/98a020/pa020.dgn		
PRF FILE	pa020i02.i	DATE PLOTTED	29-MAR-2001
PROJ. NAME	WATERFORD		
PROJ. NO.	IM 093-1(9)		
SHEET	7	OF	12 SHEETS

TEMPORARY AND DURABLE 150mm WHITE LINE ✓

- EXIT I
- SOUTHBOUND OFF RAMP "C" SOLID RT
- SOUTHBOUND OFF RAMP "D" DOTTED RT
- SOUTHBOUND ON RAMP "D" SOLID RT
- SOUTHBOUND ON RAMP "D" DASHED LANE LINE
- NORTHBOUND OFF RAMP "A" SOLID RT
- NORTHBOUND OFF RAMP "A" DOTTED RT
- NORTHBOUND ON RAMP "B" SOLID RT
- NORTHBOUND ON RAMP "B" DASHED LANE LINE

TEMPORARY AND DURABLE 150mm YELLOW LINE ✓

- EXIT I
- SOUTHBOUND OFF RAMP "C" SOLID LT
- SOUTHBOUND ON RAMP "D" SOLID LT
- NORTHBOUND OFF RAMP "A" SOLID LT
- NORTHBOUND ON RAMP "B" SOLID LT

TEMPORARY AND DURABLE 300mm WHITE LINE ✓

- EXIT I
- SOUTHBOUND OFF RAMP "C" SOLID LT
- SOUTHBOUND ON RAMP "D" SOLID LT
- NORTHBOUND OFF RAMP "A" SOLID LT
- NORTHBOUND ON RAMP "B" SOLID LT

TEMPORARY AND DURABLE LETTER OR SYMBOL ✓

- EXIT I
- SOUTHBOUND OFF RAMP "C" "STOP AHEAD"
- SOUTHBOUND OFF RAMP "D" "STOP" RT 18
- NORTHBOUND OFF RAMP "A" "STOP AHEAD"
- NORTHBOUND OFF RAMP "A" "STOP" RT 18
- NORTHBOUND OFF RAMP "B" "STOP" RT 18
- NORTHBOUND OFF RAMP "B" "YIELD" RT 18

TEMPORARY AND DURABLE 600mm STOP BAR ✓

- EXIT I
- SOUTHBOUND OFF RAMP "C" RT 18
- NORTHBOUND OFF RAMP "A" RT 18

REMOVING SIGNS ✓

- 18

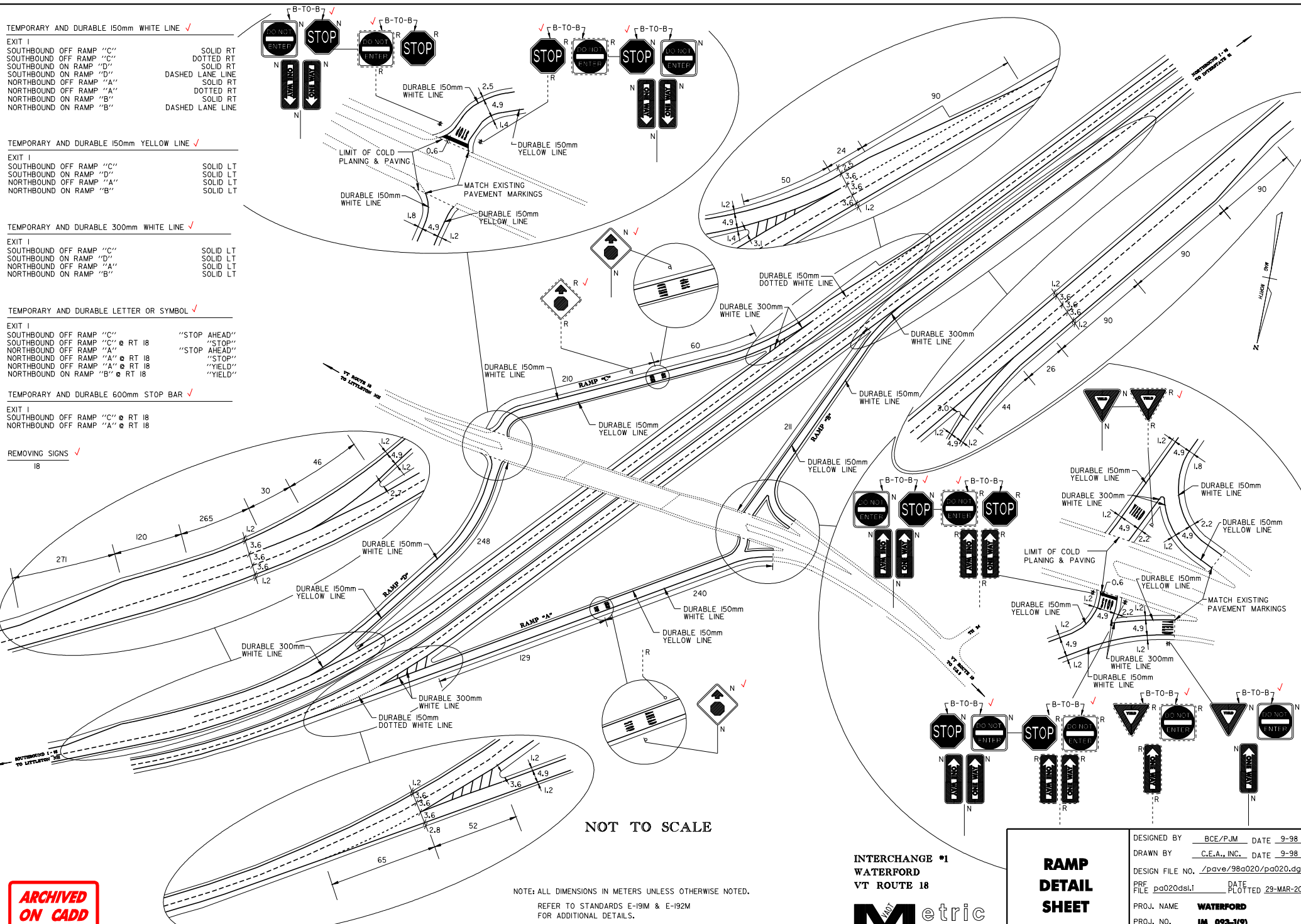

NOT TO SCALE

NOTE: ALL DIMENSIONS IN METERS UNLESS OTHERWISE NOTED.
REFER TO STANDARDS E-191M & E-192M FOR ADDITIONAL DETAILS.

INTERCHANGE #1
WATERFORD
VT ROUTE 18



RAMP
DETAIL
SHEET

DESIGNED BY	BCE/PJM	DATE	9-98
DRAWN BY	C.E.A., INC.	DATE	9-98
DESIGN FILE NO.	/pave/98d020/pa020.dgn		
PRF FILE	pa020dsl.i	DATE PLOTTED	29-MAR-2001
PROJ. NAME	WATERFORD		
PROJ. NO.	IM 093-1(9)		
SHEET	8	OF	12 SHEETS

ARCHIVED
ON CADD

TEMPORARY AND DURABLE LETTER OR SYMBOL ✓
WELCOME CENTER "YIELD"

✓TEMPORARY AND DURABLE 300mm WHITE LINE
WELCOME CENTER SOLID RT

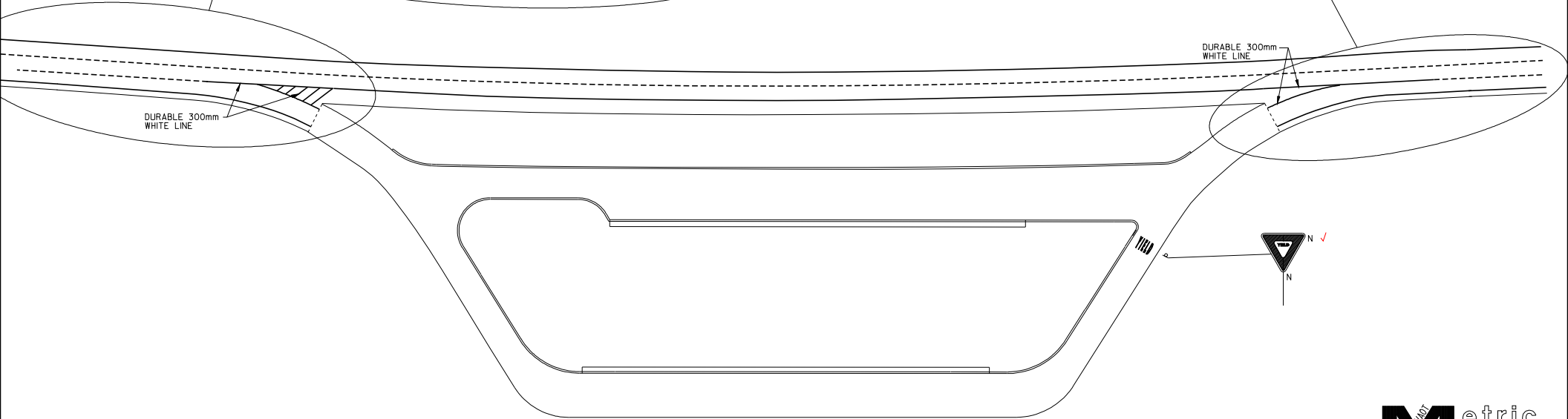
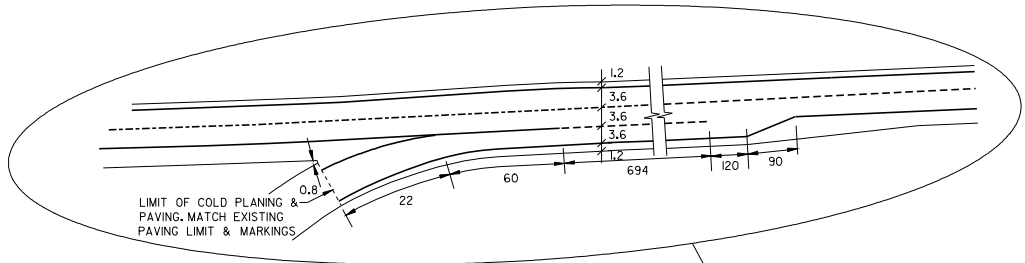
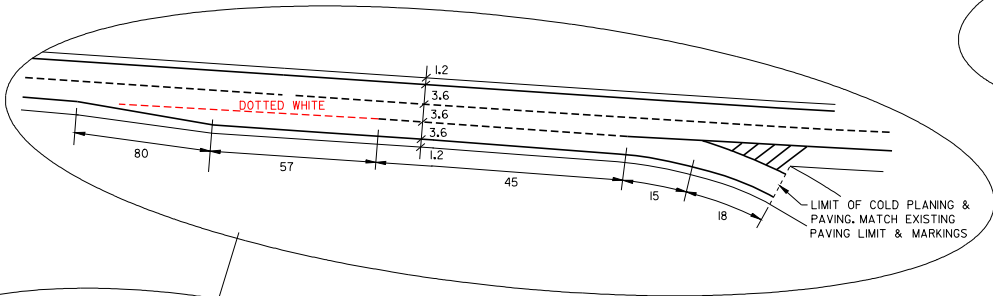

NOT TO SCALE

NOTE: ALL DIMENSIONS IN METERS UNLESS NOTED.

ARCHIVED
ON CADD

VERMONT WELCOME CENTER
NORTHBOUND I - 93

WELCOME CENTER DETAIL SHEET	DESIGNED BY	BCE/PJM	DATE	9-98
	DRAWN BY	C.E.A., INC.	DATE	9-98
	DESIGN FILE NO.	/pave/98a020/pa020.dgn		
	PRF FILE	pa020ds2.i	DATE PLOTTED	29-MAR-2001
	PROJ. NAME	WATERFORD		
PROJ. NO.	IM 093-1(9)			
SHEET	9	OF	12	SHEETS

NOTE:
THE CONTRACTOR SHALL CONTACT THE NHDOT
BEFORE INSTALLATION OF CONSTRUCTION SIGNS
IN NEW HAMPSHIRE

CONTACT: GREG PLACY
DISTRICT ENGINEER
DISTRICT I

PHONE: 603-788-4641

ADDRESS: P.O. BOX 379
LANCASTER, NH 03584

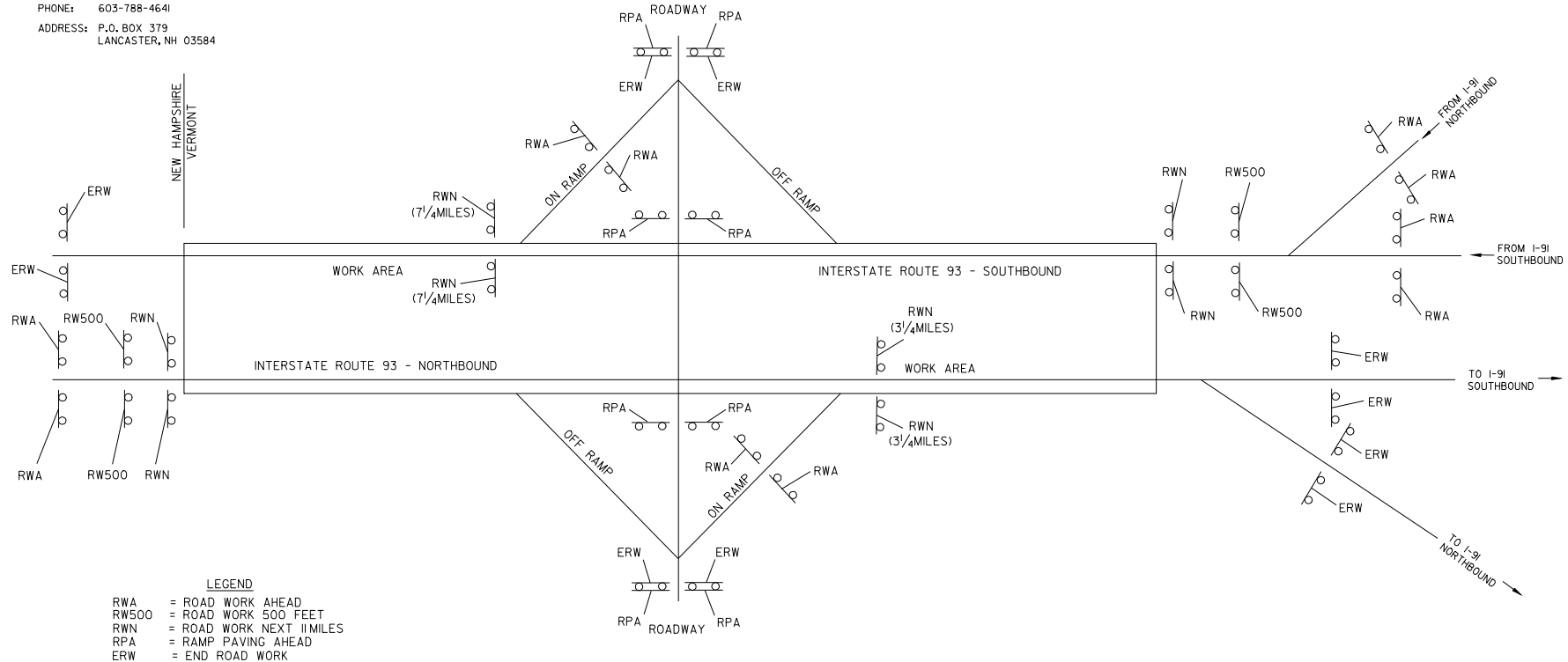

LEGEND

- RWA = ROAD WORK AHEAD
- RW500 = ROAD WORK 500 FEET
- RWN = ROAD WORK NEXT 1/4 MILES
- RPA = RAMP PAVING AHEAD
- ERW = END ROAD WORK

CONSTRUCTION APPROACH SIGNING

SEE STD. E-100M FOR SIGN PLACEMENT

LIST OF
CONSTRUCTION SIGNS

TOWN HIGHWAY	RWA	RW500	ERW	RWN	RPA
I-93 NORTHBOUND					
BEGIN PROJECT	2	2		2	
EXIT INTERCHANGE	2		2	2	4
END PROJECT			4		
I-93 SOUTHBOUND					
BEGIN PROJECT	4	2		2	
EXIT INTERCHANGE	2		2	2	4
END PROJECT			2		
TOTALS	10	4	10	8	8

NOTES:

1. ADDITIONAL RAMP SIGNING MAY BE REQUIRED AS DIRECTED BY THE RESIDENT ENGINEER.
2. THE BID PRICE FOR TRAFFIC CONTROL, ITEM 641.0, SHALL INCLUDE ALL APPROACH AND ON-PROJECT CONSTRUCTION SIGNING, BARRIERS, BARRELS, CONES, BARRICADES, TEMPORARY REGULATORY AND WARNING SIGNS, AND POSTS AS DETAILED IN STANDARD E-103M, MAINLINE TRAFFIC CONTROL - DIVIDED HIGHWAY. ALL ADJUSTING, RELOCATING, AND REMOVING OF THESE DEVICES AS DIRECTED BY THE RESIDENT ENGINEER, SHALL ALSO BE INCLUDED. THE FOLLOWING ITEMS WILL BE PAID UNDER THEIR SPECIFIC BID PRICES:

646.614, 646.615, 646.62, 646.66, AND 646.70 - TEMPORARY PAVEMENT MARKINGS
630.10, AND 630.15 - UNIFORMED TRAFFIC OFFICERS AND FLAGGERS

3. THREE (3) PORTABLE CHANGEABLE MESSAGE SIGNS WILL BE PROVIDED FOR USE ALONG THIS PROJECT. THE PLACEMENT OF THESE MESSAGE SIGNS AS WELL AS THEIR MESSAGE WILL BE APPROVED BY THE RESIDENT ENGINEER. THIS QUANTITY IS PAID FOR AS ITEM 641.5, PORTABLE CHANGEABLE MESSAGE SIGN.

ARCHIVED
ON CADD

DATUM _____
VERTICAL _____ N/A
HORIZONTAL _____ N/A



**CONSTRUCTION APPROACH
SIGNING**

DESIGNED BY BCE/PJM DATE 9-98
DRAWN BY C.E.A., INC. DATE 9-98
DESIGN FILE NO. /pave/98a020/pa020.dgn
PRF FILE pa020cas.i DATE PLOTTED 29-MAR-2001
PROJ. NAME **WATERFORD**
PROJ. NO. **IM 093-1(9)**
SHEET **11** OF **12** SHEETS

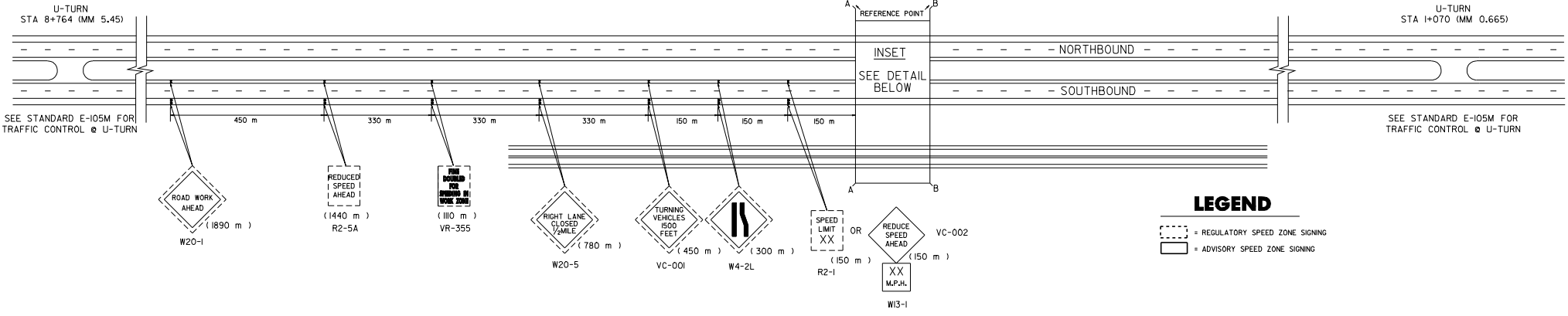

INSET DETAIL
(TO BE USED WITH ADVISORY OR LEGAL SPEED LIMIT)

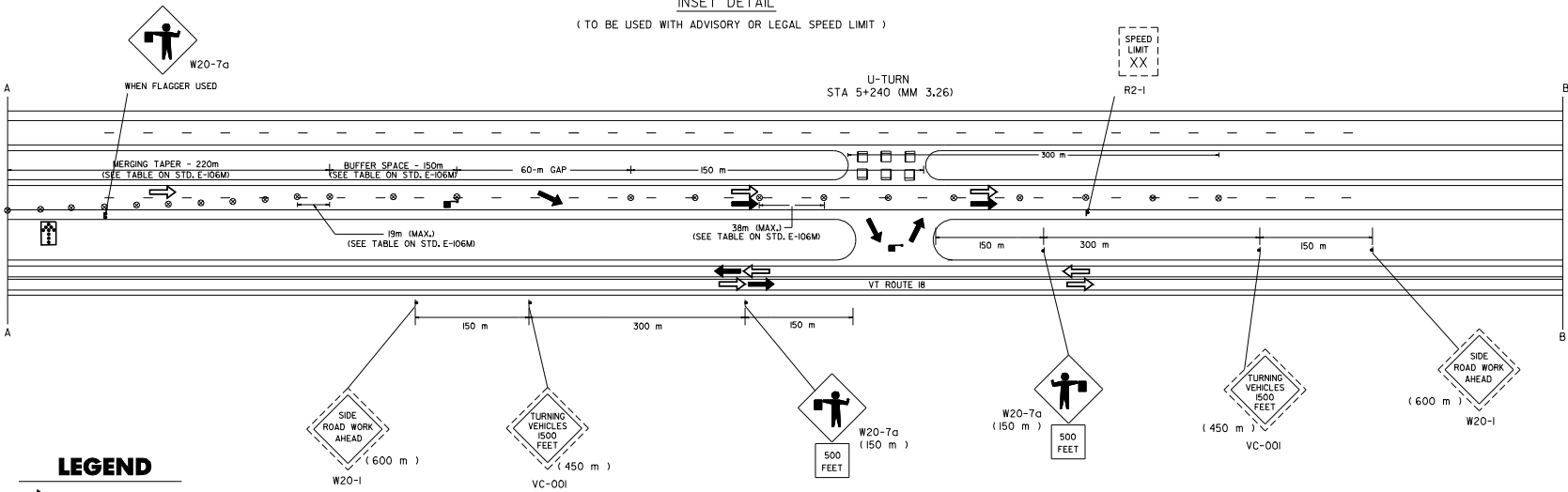

- NOTES:
1. THE CONTRACTOR MAY SUBMIT AN ALTERNATE TRAFFIC CONTROL PLAN FOR REVIEW BY THE RESIDENT ENGINEER IF DESIRED.
 2. SEE GENERAL NOTES ON STANDARD E-105M.
 3. WHEN EMERGENCY ACCESS IS NOT BEING USED SIGNS SHALL BE REMOVED OR COVERED AND THE GATE SHALL BE LOCKED.
 4. ACCESS GATE IS ONLY FOR CONTRACTOR VEHICLES AND EMERGENCY USE ONLY.
 5. CONTRACTOR WILL NOTIFY LOCAL EMERGENCY SERVICES OF WHEN THE GATE IS BEING USED AND COORDINATE APPROPRIATELY.

**ARCHIVED
ON CADD**

NOTE: ALL DIMENSIONS IN METERS UNLESS NOTED.

NOT TO SCALE



**TRAFFIC CONTROL FOR CONSTRUCTION
VEHICLE ENTERING/EXITING
EMERGENCY ACCESS & ROUTE 18
@ STA 5+240 (MM 3.26)**

DESIGNED BY	BCE/PJM	DATE	2-99
DRAWN BY	C.E.A., INC.	DATE	2-99
DESIGN FILE NO.	/pave/98d020/pa020.dgn		
PRF FILE	pa020ds3.i	DATE PLOTTED	29-MAR-2001
PROJ. NAME	WATERFORD		
PROJ. NO.	IM 093-1(9)		
SHEET	12	OF	12 SHEETS