

# GUARDRAIL LOCATIONS

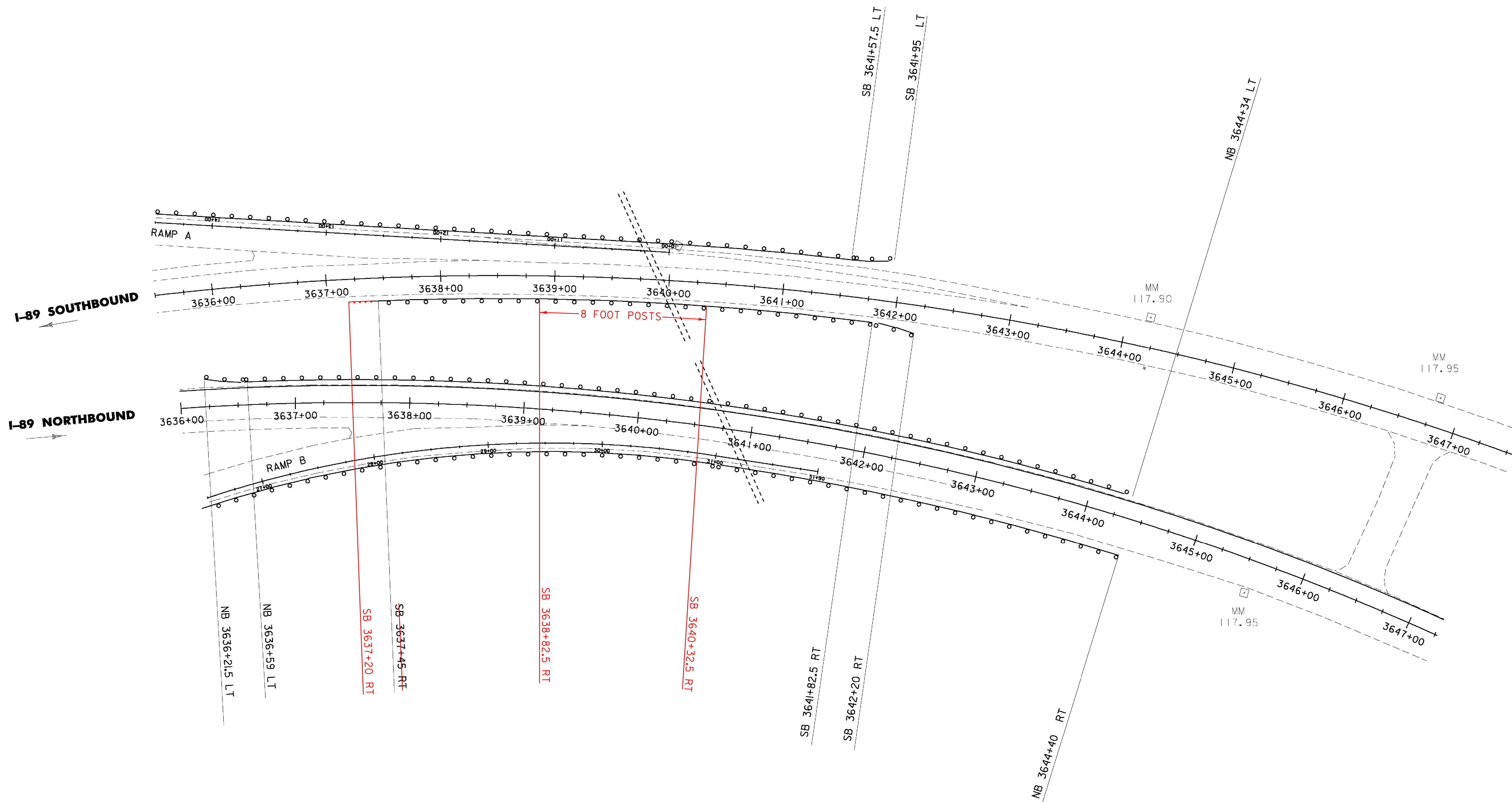

62I.20 STEEL BEAM GUARDRAIL, GALVANIZED

RAMP A 19+60 RT ~ SB 3641+57.5 LT  
~~SB 3637+45 RT ~ SB 3641+82.5 RT~~  
 RAMP B 22+98.5 RT ~ NB 3644+40 RT  
 NB 3636+59 LT ~ NB 3644+34 LT  
 SB 3637+20 RT ~ SB 3638+82.5 RT  
 SB 3640+32.5 RT ~ SB 3641+82.5 RT

62I.50 MANUFACTURED TERMINAL SECTION, FLARED

SB 3641+82.5 RT ~ SB 3642+20 RT  
 SB 3641+57.5 LT ~ SB 3641+95 LT  
 NB 3636+21.5 LT ~ NB 3636+59 LT

62I.60 ANCHOR FOR STEEL BEAM RAIL

NB 3644+34 LT  
 NB 3644+40 RT  
~~SB 3637+45 RT~~  
~~SB 3637+20 RT~~

62I.80 REMOVAL AND DISPOSAL OF GUARDRAIL

RAMP A 19+60 RT ~ SB 3641+95 LT  
 SB 3637+35 RT ~ SB 3642+20 RT  
 RAMP B 22+61 RT ~ NB 3644+40 RT  
 NB 3636+23 LT ~ NB 3644+36 LT

62I.205 STEEL BEAM GUARDRAIL, GALV. W/ 8' POSTS

SB 3638+82.5 RT ~ SB 3640+32.5 RT

THE CONTRACTOR SHALL WIDEN WITH EARTH BORROW ADJACENT TO THE 4.0' SHOULDER TO PROVIDE BACKING FOR THE NEW GUARDRAIL AND TO CONSTRUCT A FLARE FOR THE END TERMINAL. CONSTRUCTION OF THE WIDENING AND TERMINAL FLARE SHALL BE COMPLETED IN ACCORDANCE WITH STANDARD G-19.

<b>GUARDRAIL TREATMENT DETAIL SHEET 5</b>	PROJECT NAME:	ST. ALBANS - SWANTON
	PROJECT NUMBER:	IM 089-3(62)
	FILE NAME:	D96A058FRM.DGN
	PLOT DATE:	26-AUG-2009
PROJECT LEADER:	K. ROBIE	DRAWN BY: P. BEYOR
DESIGNED BY:	P. BEYOR	CHECKED BY: S. MENARD
PLOT FILE:	D96A058GRT5.1	SHEET 42 OF 117

DETAILS ARE NOT TO SCALE