

**STATE OF VERMONT  
AGENCY OF TRANSPORTATION  
RIGHT OF WAY PLANS  
DETAIL SHEET**

**TABLE OF PROJECT PROPERTY ACQUISITION**

PARCEL NO.	GRANTOR	SHEET NO.	BEGINNING STATION	ENDING STATION	TAKING	REM.	RIGHTS	TITLE TAKEN	DATE	TOWN OR CITY RECORDED	BK.	PG.	REMARKS
1A	TROMBLY, LEO A. & JOYCE F.	3	SB 3395+63 RT. SB 3395+63 LT.	SB 3396+46 LT. SB 3396+46 LT.	4170 S.F.±		EXCEPT & RESERVE			ST. ALBANS			30' WIDE UTILITY EASEMENT
1B		2,3	CH 30+06 LT. CH 30+43 RT.	CH 31+16 RT. CH 30+92 LT.			DRIVE (T) EASEMENT (T)						12' GRAVEL PRIVATE UNDER GROUND UTILITY RELOCATION INCLUDES HEADWALLS TREES TREES
			CH 30+52 RT. CH 30+76 RT. CH 31+11 LT.	CH 32+27 LT. CH 30+86 RT. CH 32+08 LT.			CULVERT & CHANNEL (T) TRANSPLANT (T) TRANSPLANT (T)						
2A	SANBORN, CRAIG R. & DEBORAH A.	2,3	SB 3396+42 LT. SB 3396+42 LT.	SB 3396+58 LT. SB 3396+58 LT.	910 S.F.±		EXCEPT & RESERVE			ST. ALBANS			30' WIDE UTILITY EASEMENT
2B			CH 30+43 RT. CH 31+35 LT. CH 31+38 LT.	CH 31+28 LT. CH 31+75 LT. CH 32+26 LT.			EASEMENT (T) INSTALL (T) CHANNEL (T)						PRIVATE UNDER GROUND UTILITY RELOCATION UNDERDRAIN PIPE

REVISION NO.	SHEET	DESCRIPTION OF REVISION	DATE	MADE BY	APPROVED BY
1	2,3	PARCEL NO. 2 SANBORN. ADD SB 3396+42 LT. - SB 3396+58, EXCEPT + RESERVE, 30' WIDE UTILITY EASE. CHANGE DITCH + DRIVE TO CHANNEL (T). PER C.O. 9174.	11-27-00	S. L. D.	R. P. D.
2	2,3	PARCEL NO. 1 TROMBLY. CHANGE CUL., DIT, + DR. (T) TO CULVERT + CHANNEL (T). ADD SB 3395+63 LT. - SB 3396+46 LT., EXCEPT + RESERVE, 30' WIDE UTILITY EASE. PER C.O. 9175.	11-27-00	S. L. D.	R. P. D.
3	1,3	PARCEL NO. 3. DELETE THIS PARCEL. PER C.O. 9176.	11-27-00	S. L. D.	R. P. D.

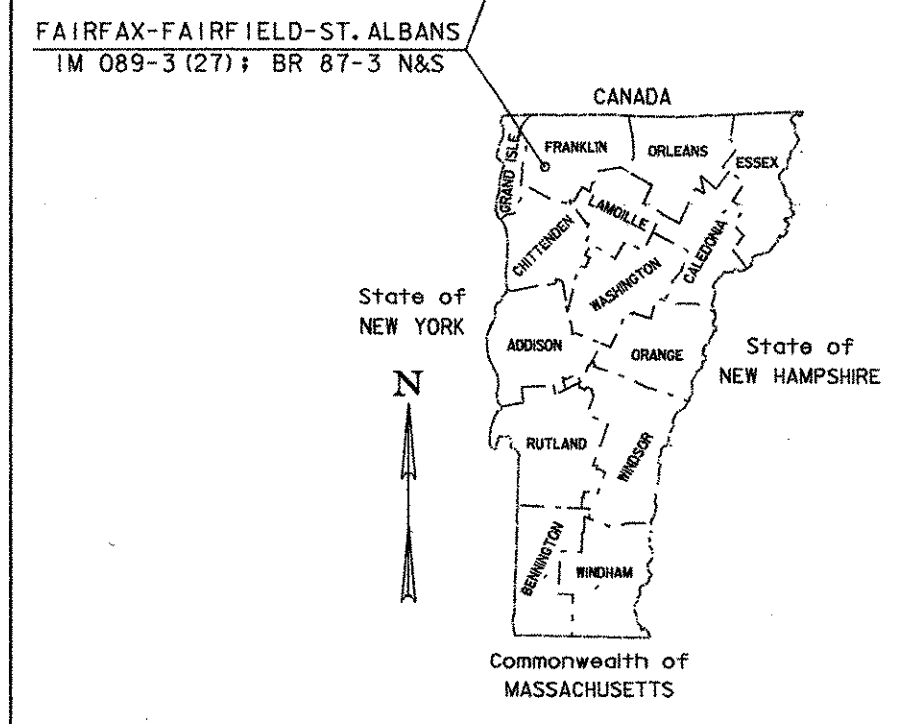
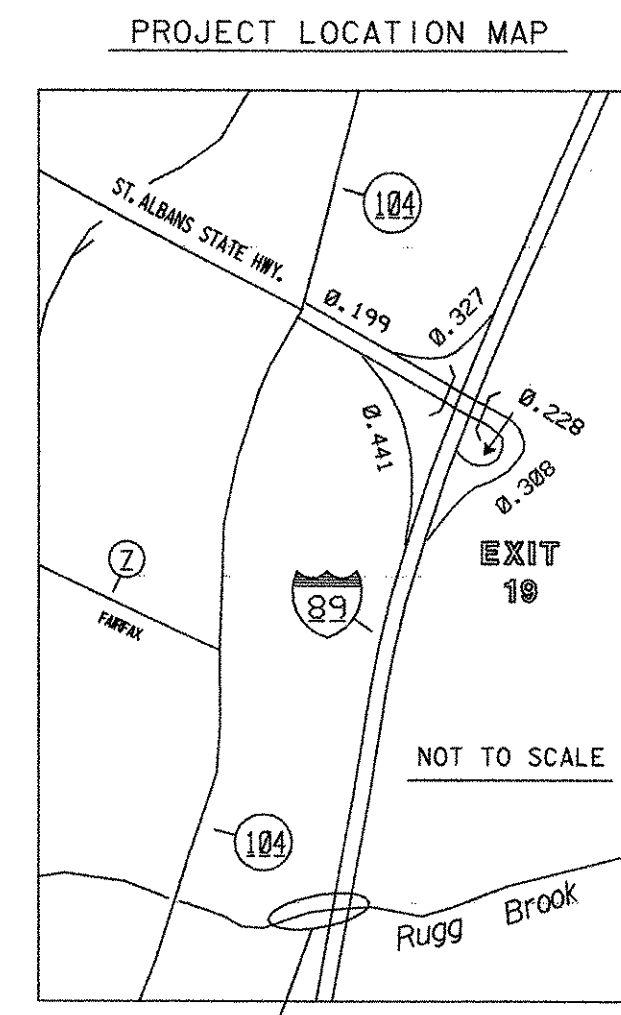

**RIGHT-OF-WAY**  
 NOV 27 2000  
 PRELIMINARY PLANS  
 COMPLETED PLANS  
 FINAL PLANS

<p>ACCT.SDesrochers \\vaot_cadd\fillingcab\ne\96a056\RightOfWay\ra056d.dgn DATE PLOTTED 27-NOV-2000</p>	<p>DR. (P)- DRAINAGE RIGHT DIT. (P)- DITCHING RIGHT CH. (P)- CHANNEL RT. DRIVE (T)- DRIVE RIGHT CUL. (P)- CULVERT RIGHT [W]- WATER SOURCES</p>	<p>PRESENT R.O.W.   TAKING WITHOUT ACCESS   TAKING WITHOUT ACCESS ALONG PROPERTY LINE   TAKING WITH ACCESS   PERMANENT EASEMENT   TEMPORARY EASEMENT</p>	<p>LEGEND</p> <p> C&amp;T (P) CLEARING &amp; TRIMMING   C.Z. (P) CLEAR ZONE   CONST. (T) CONSTRUCTION EASEMENT   SR SLOPE RIGHTS   P PROPERTY LINE   L TOP OF CUT   O TOE OF SLOPE</p>	<p> . . . UE (P) . . . PERMANENT UTILITY EASEMENT</p>	<p>R. O. W. PLANS          FAIRFAX-FAIRFIELD-ST. ALBANS          IM 089-3(27)          SHEET 1 OF 3</p>
-----------------------------------------------------------------------------------------------------------------	--------------------------------------------------------------------------------------------------------------------------------------------------------------------	------------------------------------------------------------------------------------------------------------------------------------------------------------------------------	----------------------------------------------------------------------------------------------------------------------------------------------------------------------------------------------------------------	-------------------------------------------------------	---------------------------------------------------------------------------------------------------------------------

APPROVED: ROGER P. DUMAS DATE: 8-22-00  
CHIEF, PLANS & TITLES