

**ABUTMENT NO. 1 FOOTING REINFORCING PLAN**

SCALE: 3/8" = 1'-0"

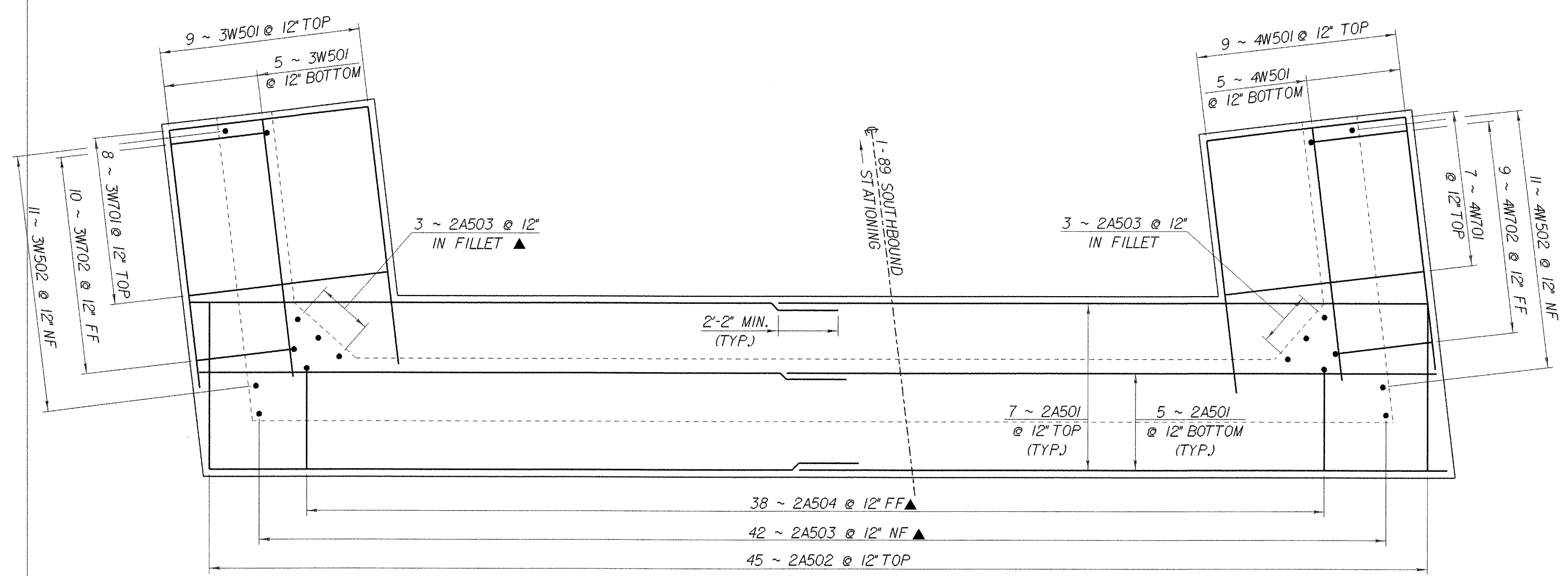

**ABUTMENT NO. 2 FOOTING REINFORCING PLAN**

SCALE: 3/8" = 1'-0"

**NOTE:**  
 NF = NEAR FACE  
 FF = FAR FACE  
 EF = EACH FACE  
 ▲ = CUT TO FIT IN FIELD  
 3" CLR. UNLESS OTHERWISE SPECIFIED ON THE PLANS.

<b>STATE OF VERMONT AGENCY OF TRANSPORTATION</b>	
Town Of <b>FAIRFAX-FAIRFIELD-ST. ALBANS</b>	Bridge No. 87S
Highway No. <b>1-89</b>	Log Sta. Surv. Sta.
<b>I-89 OVER VT 104</b>	
<b>ABUT. NOS. 1 &amp; 2 FOOTING REINFORCING</b>	
Designed By <b>M. LOZIER</b>	Drawn By <b>K. CHISHOLM</b>
Checked By <b>G. ROY</b>	Bridge Design Supervisor
Date <b>10/99</b>	Date <b>11/99</b>
PROJECT <b>FAIRFAX-FAIRFIELD-ST. ALBANS</b>	PROJECT NO. <b>1 M 089 - 3 (27)</b>
I.G.C. Info. <b>94\1106\Structures\s\1106abdgn</b>	sa056fglj
Bridge Sheet No. <b>BR222</b>	Sheet <b>100</b> of <b>370</b>