

SB CURVE#1 DATA
 $\Delta = 3^{\circ}18' - 43.38''$ LT.
 D = 0°15'
 R = 22918.32'
 T = 662.59'
 L = 1324.82'
 E = 9.58'
 BANK = 0.021 FT / FT

SOUTHBOUND: 8' UNDERDRAIN (MODIFICATION #1) SOUTHBOUND: 8' UNDERDRAIN (MODIFICATION #2)
 ② 3282+50 LT - 3285+00 LT W/FB @ 3282+50 LT ① 3282+50 LT - 3285+00 LT W/FB @ 3282+50 LT

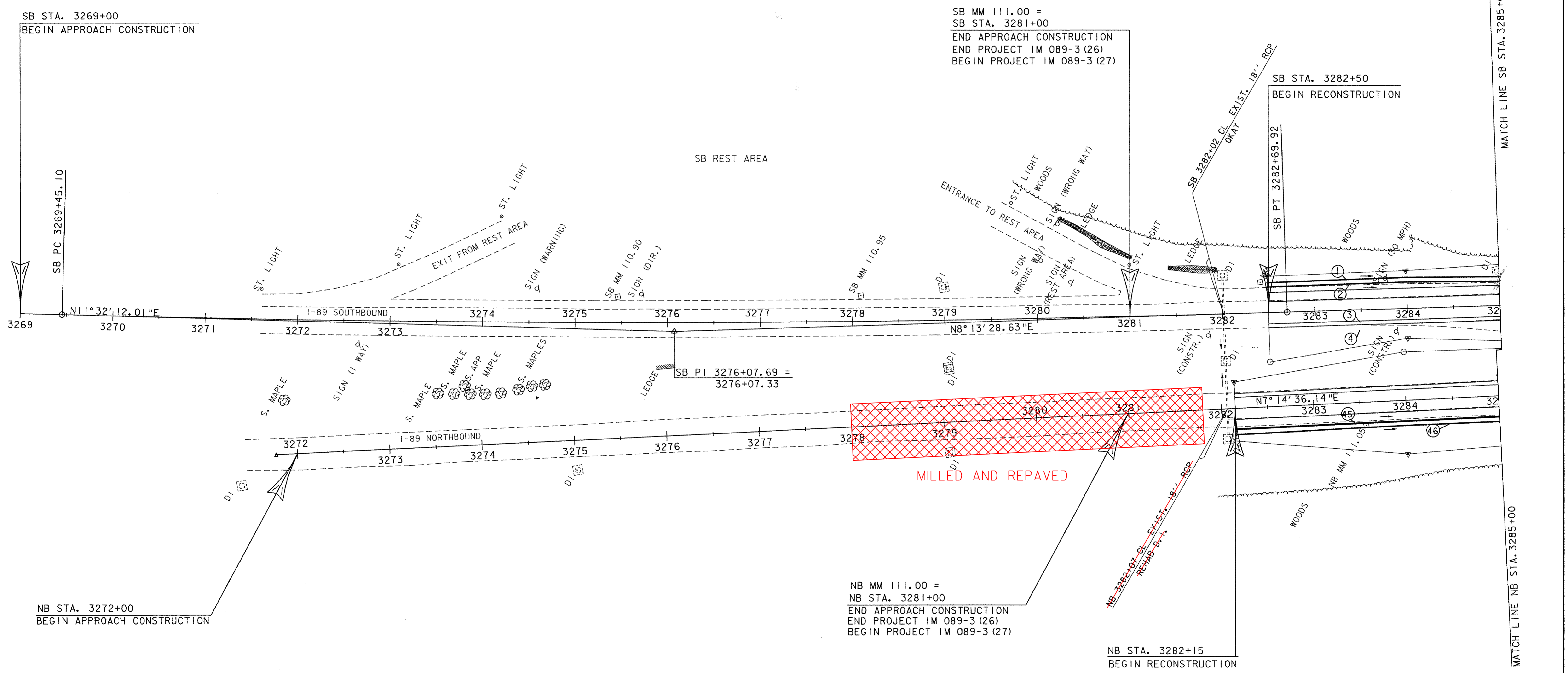

SB STA. 3269+00
 BEGIN APPROACH CONSTRUCTION

SB MM 111.00 =
 SB STA. 3281+00
 END APPROACH CONSTRUCTION
 END PROJECT IM 089-3 (26)
 BEGIN PROJECT IM 089-3 (27)

SB STA. 3282+50
 BEGIN RECONSTRUCTION

NB STA. 3272+00
 BEGIN APPROACH CONSTRUCTION

NB MM 111.00 =
 NB STA. 3281+00
 END APPROACH CONSTRUCTION
 END PROJECT IM 089-3 (26)
 BEGIN PROJECT IM 089-3 (27)

NB STA. 3282+15
 BEGIN RECONSTRUCTION

REMOVAL OF EXISTING FENCE (MOD.)
 STA. 3284+60 NB RT
 STA. 3284+90 NB RT

WOVEN WIRE FENCE W/STEEL POSTS
 STA. 3284+60 NB RT
 STA. 3284+90 NB RT

NORTHBOUND: 8' UNDERDRAIN (MODIFICATION #1)
 ④5 3282+15 RT - 3285+00 RT W/FB @ 3282+15 RT
 3289 21
 NORTHBOUND: 8' UNDERDRAIN (MODIFICATION #2)
 ④6 3282+15 RT - 3285+00 RT W/FB @ 3282+15 RT
 20 3284+95

SB 3269+00 - 3285+00
 NB 3272+00 - 3285+00

PROJECT: FAIRFAX - FAIRFIELD - ST. ALBANS	PROJECT NO.: IM 089-3(27)
DESIGN FILE NAME: /87A007B/DESIGN/DA007NUL.DGN	PLOT DATE: 18-AUG-2000
IPARM FILE NAME: DA007LOI	SURVEY DATE: 6/98
SURVEYED BY: ORVIS	DRAWN BY: SQUAD B
SQUAD LEADER: DELLA SANTA	SHEET: 49 OF 370

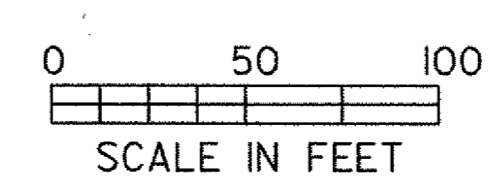

DATUM
 VERTICAL NAVD88
 HORIZONTAL NAD83(92)