

PROPERTY LINE FENCE W/STEEL POSTS, MOD. ITEM 583-II
S.B. 3380+00-3396+00 Lt.
N.B. 3380+00-3396+00 Rt.

*THREE CABLE GUARD RAIL w/LIGHT STEEL POSTS. ITEM 538
NB 3380+00 Lt. - 3383+54 Lt.
NB 3394+68 Lt. - 3396+00 Lt.
SB 3380+00 Lt. - 3382+41 Lt.
SB 3394+28 Lt. - 3396+00 Lt.

*JUTE MATTING-ITEM 623
N.B. 3380+00-3387+00 Rt.
S.B. 3380+00-3390+00 Rt.

NOTE: * DENOTES ITEMS TO BE INCLUDED IN STAGE II CONSTRUCTION.

INDIVIDUAL WATER SOURCES
DUG SPRING S.B.L. 3386+90 - 190' Lt.
FARM POND S.B.L. 3395+15 - 25' Lt.

4" Water pipe from City Water Main & Pumping Station to Radar Base

TREATED TIMBER CURB, ITEM 558
*BITUMINOUS CONCRETE CURB ITEM 555 TYPE III
NB 3380+00 Lt. - 3383+54 Lt.
1+08

Pipe Line to Allaire's barn

*STANDARD STEEL BEAM GUARD RAIL w/STEEL POSTS. ITEM 545-A (26" c/c)
NB 3395+00 - 3396+00 Rt.
SB 3395+40 - 3396+00 Rt.

CONTROL OF ACCESS IS COMPLETE ON THIS SHEET.

APPROX AERIAL UTILITIES RELOC ROUTE BY NET & T CO.

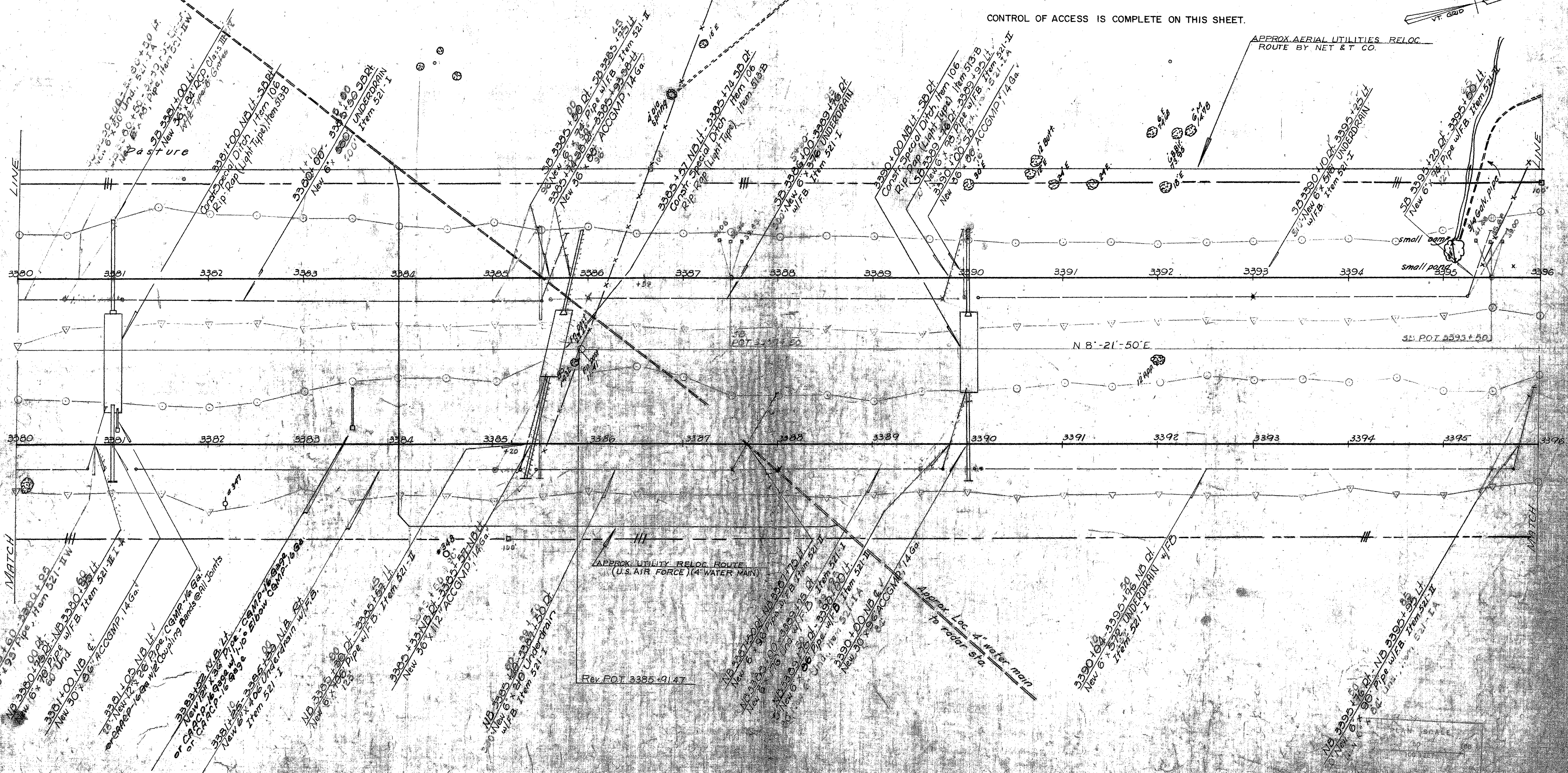

DATE: 3/68
DRAWN: [Name]
CHECKED: [Name]
SCALE: 1" = 40'

SCALE: 1" = 40'
DATE: 3/68

CONSTRUCTION
GEORGIA FAIRFAX FAIRFIELD ST ALBANS
188-3-111
Sheet 07 of 57

STA. 3380 = MM 112.90