

PROPERTY LINE FENCE W/STEEL POSTS, MOD.  
Item 583 II  
S.B. 3300+00 - 3316+00 Lt.  
N.B. 3300+00 - 3316+00 Rt.

\*THREE CABLE GUARD RAIL W/  
LIGHT STEEL POSTS, ITEM 538  
N.B. 3300+00 - 3307+00 Rt.  
S.B. 3300+00 - 3311+00 Lt.

\*JUTE MATTING - ITEM 623  
N.B. 3300+00 - 3313+00 Lt.

INDIVIDUAL WATER SOURCES  
DUG WELL S.B.L. 3303± - 1200'± Lt.  
DUG SPRING S.B.L. 3303± - 1300'± Lt.

NOTE: \* DENOTES ITEMS TO BE INCLUDED IN STAGE II CONSTRUCTION.

\* Bridge Railing for Bridge Approaches  
Item 572  
SB 3300+00 - 3300+60 Rt.  
SB 3300+00 - 3300+70 Lt.

CONTROL OF ACCESS IS COMPLETE ON THIS SHEET.

APPROX. AERIAL UTILITIES RELOC.  
ROUTE BY C.V.P.S. CORP. (TRANSMISSION)

APPROX. AERIAL UTILITIES RELOC.  
ROUTE BY NET & T CO.

BM #156  
ASMD ELEV.  
614.843

BM #157  
ASMD ELEV.  
634.874±

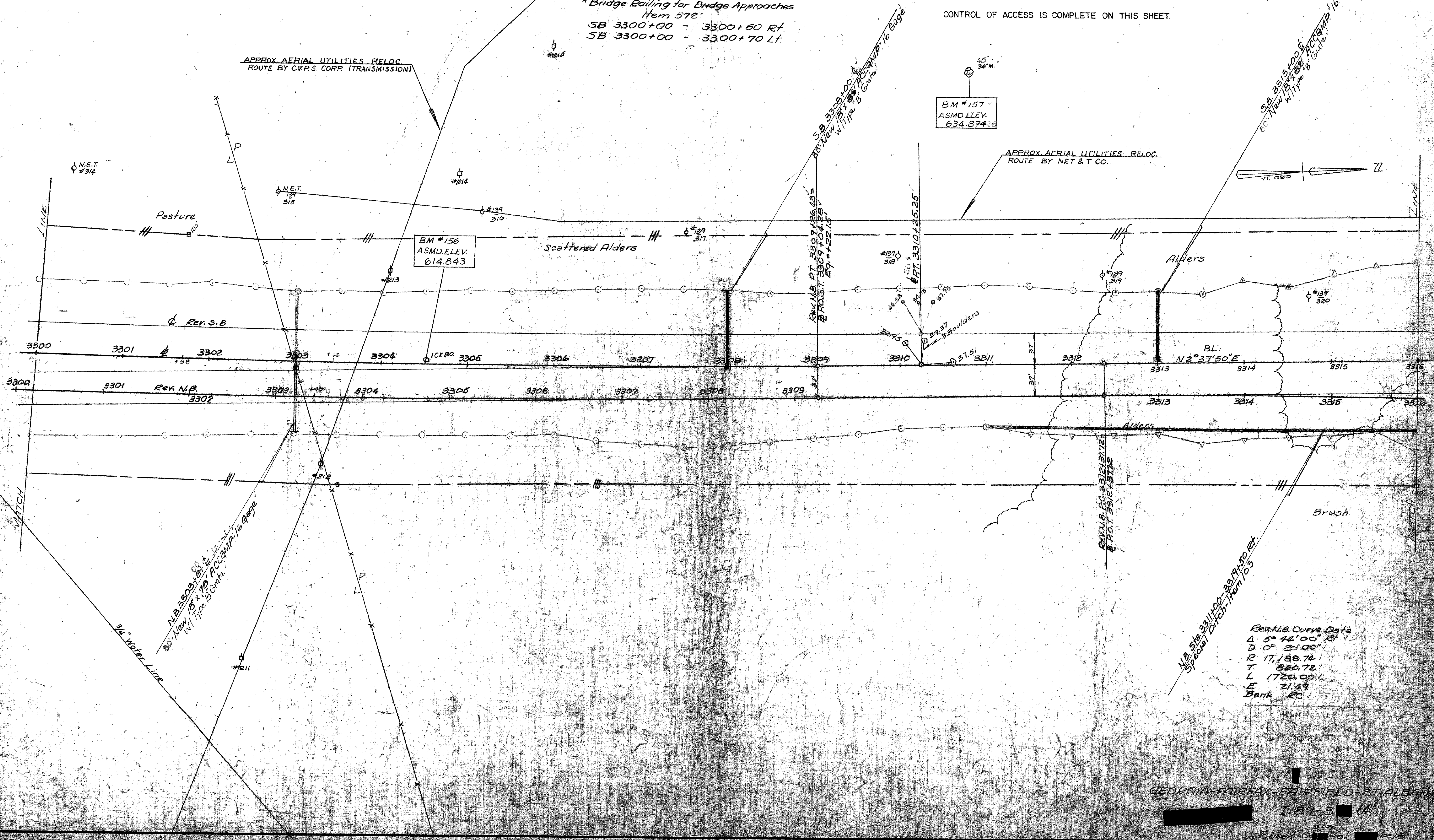
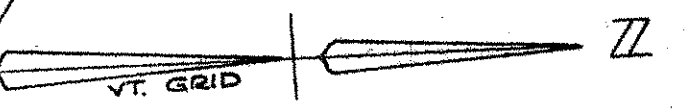

Rev. N.B. Curve Data  
Δ 5° 44' 00" Rt.  
D 0° 20' 00" Lt.  
R 17,188.74  
T 860.72  
L 1720.00  
E 21.49  
Bank RC



Construction  
GEORGIA-FAIRFAX-FAIRFIELD-ST ALBANS  
189-3 (4)  
Sheet 83 of 113

STA. 3300=MM 11.38

DATE: 1/16/83  
BY: [Signature]  
CHECKED: [Signature]  
NO. 1163  
PLAN: 189-3 (4)  
REVISIONS:  
NO. 1  
DATE: 1/16/83  
BY: [Signature]  
CHECKED: [Signature]