

TEMPORARY TRAFFIC BARRIER  
 ENDS AT SB MM 114.18  
 (SEE SHEET 284 FOR BEGINNING LOCATION)  
 NOTE: EVERY 10TH SECTION WILL BE A MODIFIED  
 BARRIER TO ALLOW SMALL ANIMALS TO  
 CROSS UNDERNEATH. (SEE SHEET 26.)

CURVE DATA  
 $\Delta = 16^{\circ}23'13.45''$  LT.  
 $D = 4^{\circ}46'28.73''$   
 $R = 1200'$   
 $T = 172.78'$   
 $L = 343.21'$   
 $E = 12.38'$

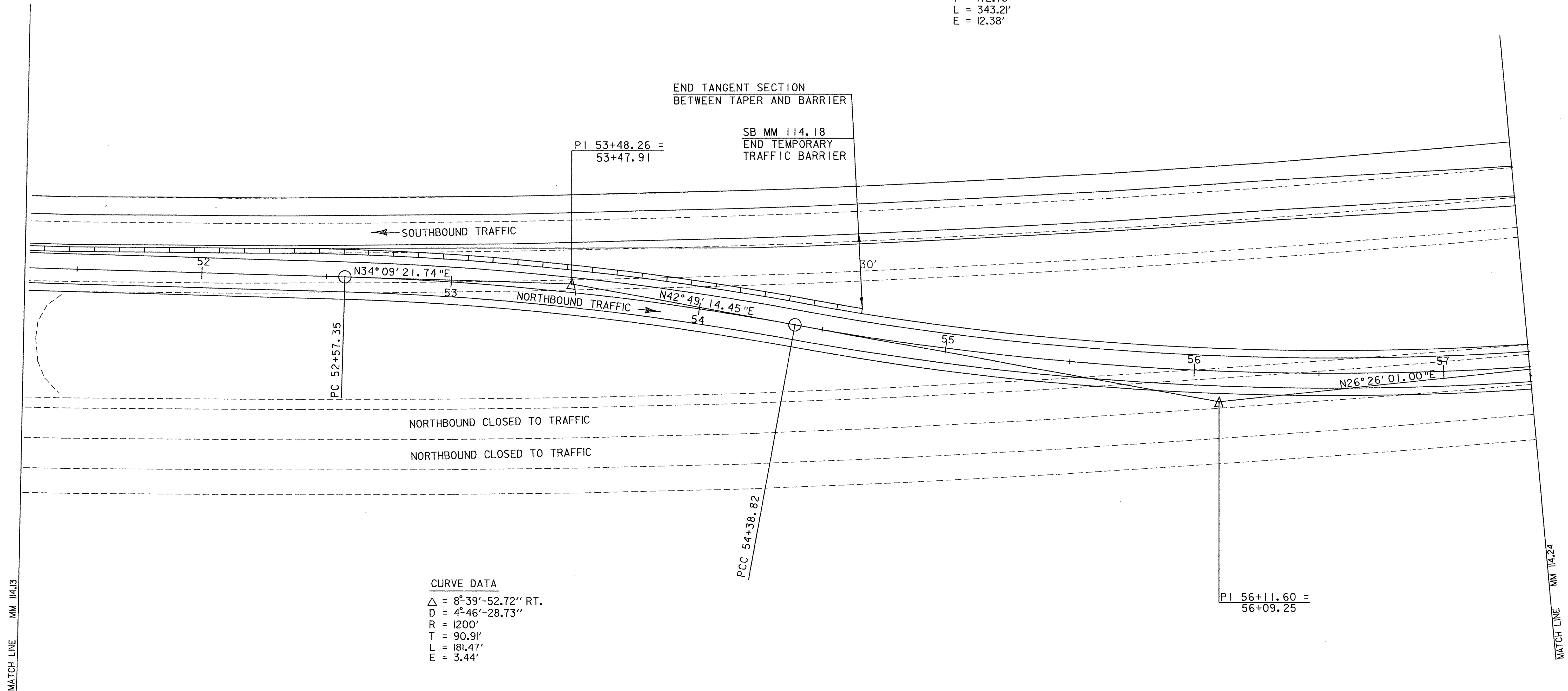

CURVE DATA  
 $\Delta = 8^{\circ}39'52.72''$  RT.  
 $D = 4^{\circ}46'28.73''$   
 $R = 1200'$   
 $T = 90.91'$   
 $L = 181.47'$   
 $E = 3.44'$

DATUM  
 VERTICAL ASSUMED  
 HORIZONTAL ASSUMED

# CROSSOVER TO END NORTHBOUND DETOUR

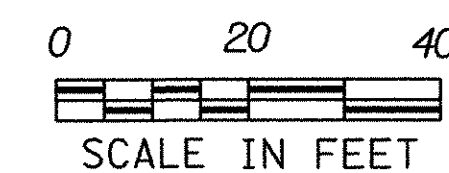

PROJECT: FAIRFAX-FAIRFIELD-ST. ALBANS	PROJECT NO.: IM 089-3(27)
DESIGN FILE NAME: /B7A007B/DESIGN/DA007NRC.DGN	PLOT DATE: 17-NOV-2000
IPARM FILE NAME: DA007NB5	SURVEY DATE: 11/95
SURVEYED BY: GILMAN	DRAWN BY: SQUAD B
SQUAD LEADER: DELLA SANTA	SHEET: 292 OF 370