

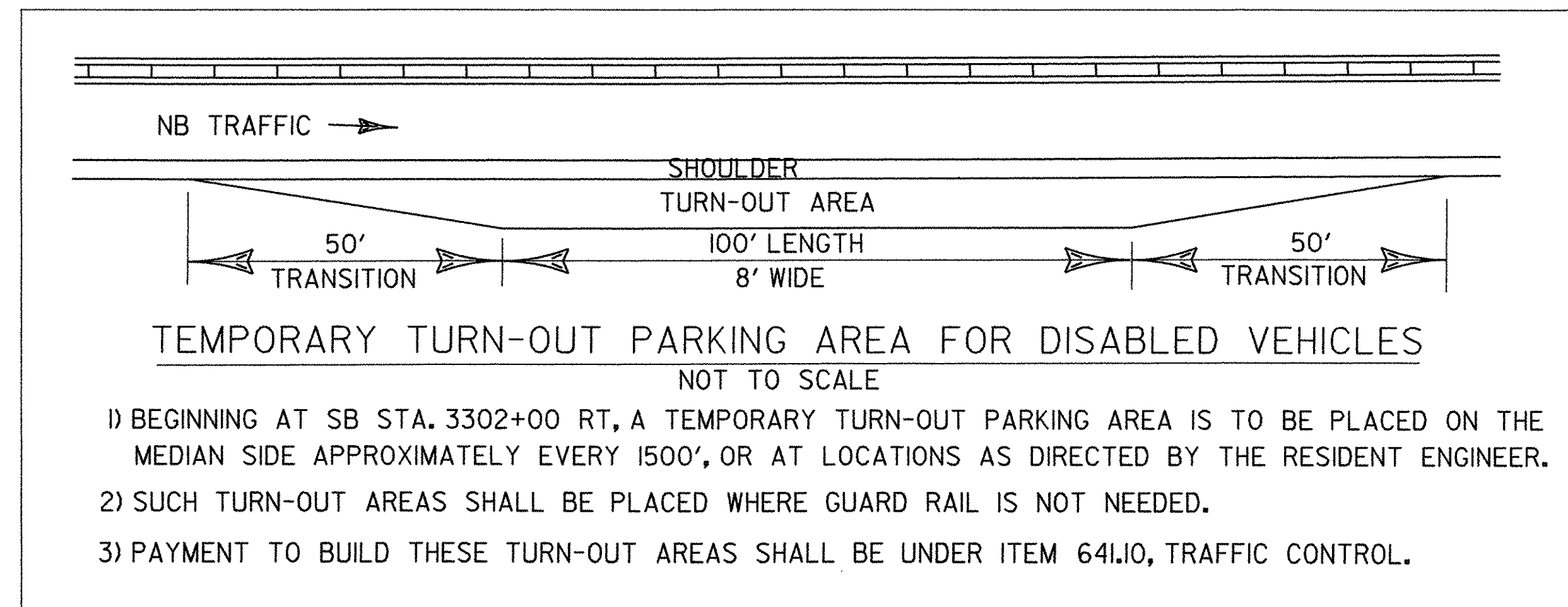

TEMPORARY TRAFFIC BARRIER  
 BEGINS AT SB MM 110.92  
 (SEE SHEET 292 FOR ENDING LOCATION)  
 NOTE: EVERY 10TH SECTION WILL BE A MODIFIED  
 BARRIER TO ALLOW FOR SMALL ANIMALS TO  
 CROSS UNDERNEATH.



- 1) BEGINNING AT SB STA. 3302+00 RT, A TEMPORARY TURN-OUT PARKING AREA IS TO BE PLACED ON THE MEDIAN SIDE APPROXIMATELY EVERY 1500', OR AT LOCATIONS AS DIRECTED BY THE RESIDENT ENGINEER.
- 2) SUCH TURN-OUT AREAS SHALL BE PLACED WHERE GUARD RAIL IS NOT NEEDED.
- 3) PAYMENT TO BUILD THESE TURN-OUT AREAS SHALL BE UNDER ITEM 641.10, TRAFFIC CONTROL.

MATCH LINE PCC STA. 203+36.11

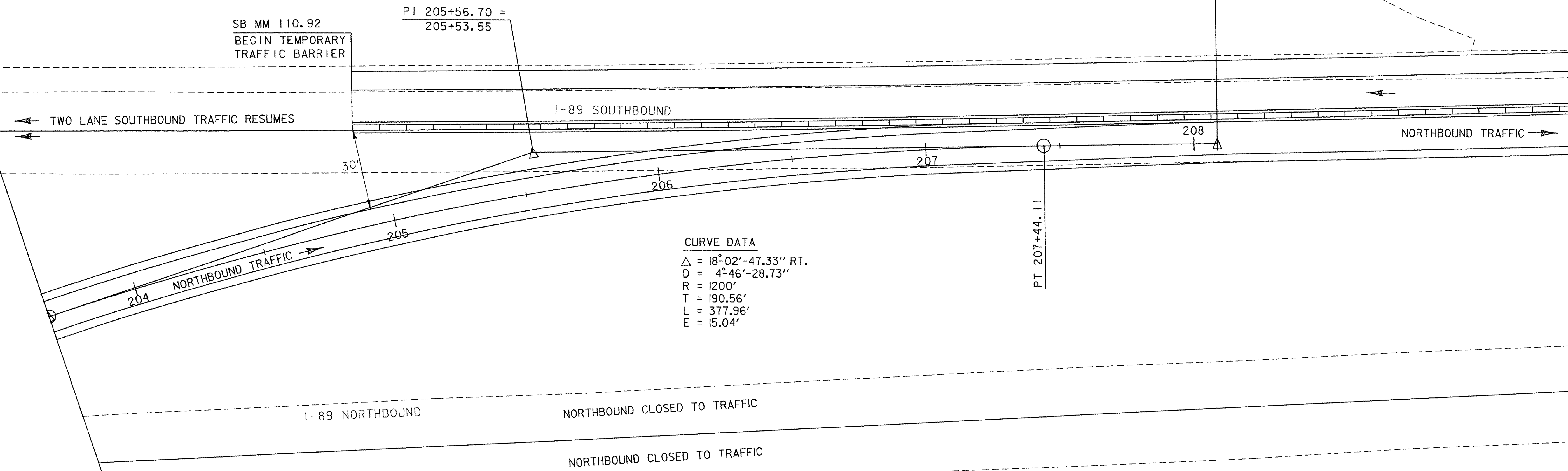

CURVE DATA  
 $\Delta = 18^{\circ}02' - 47.33''$  RT.  
 $D = 4^{\circ}46' - 28.73''$   
 $R = 1200'$   
 $T = 190.56'$   
 $L = 377.96'$   
 $E = 15.04'$

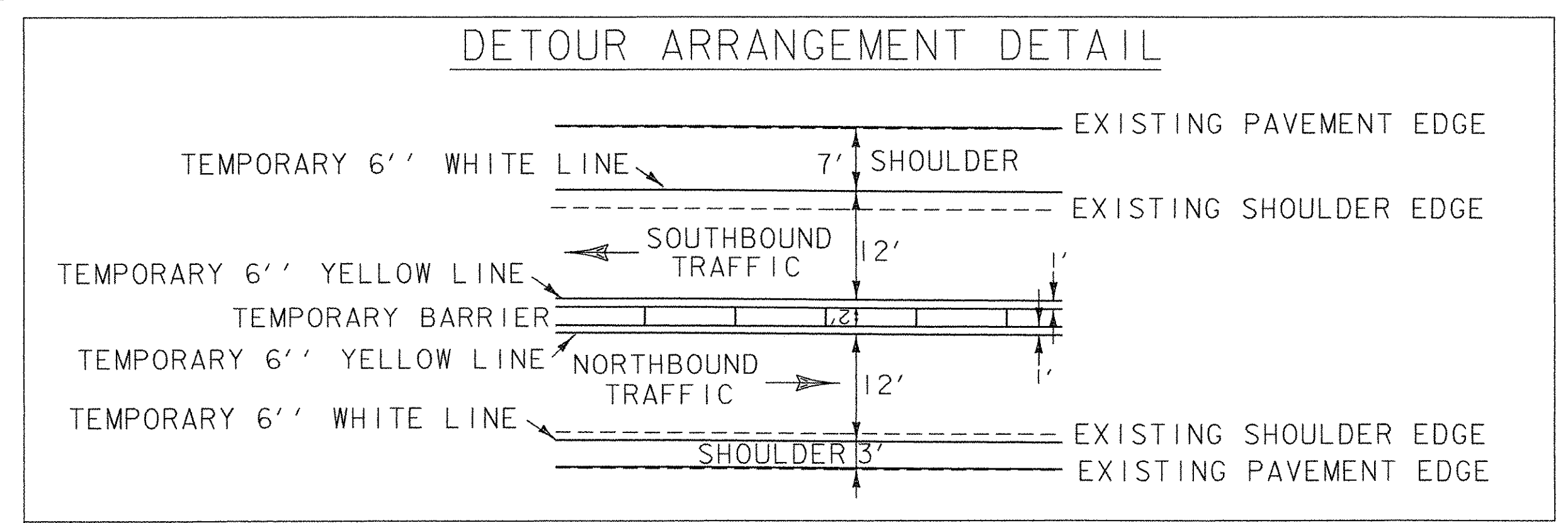

DATUM  
 VERTICAL NAVD88  
 HORIZONTAL NAD83(92)

CROSSOVER TO BEGIN NORTHBOUND DETOUR

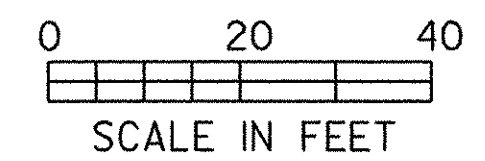

PROJECT: FAIRFAX - FAIRFIELD - ST. ALBANS	PROJECT NO.: IM 089-3(27)
DESIGN FILE NAME: /87A007B/DESIGN/DA007NBA.DGN	PLOT DATE: 22-AUG-2000
IPARM FILE NAME: DA007NB8	SURVEY DATE: 6/98
SURVEYED BY: ORVIS	DRAWN BY: SQUAD B
SQUAD LEADER: DELLA SANTA	SHEET: 284 OF 370