

TEMPORARY TRAFFIC BARRIER
 ENDS AT NB MM 114.17
 (SEE SHEET 277 FOR BEGINNING LOCATION)
 NOTE: EVERY 10TH SECTION WILL BE A MODIFIED
 BARRIER TO ALLOW SMALL ANIMALS TO
 CROSS UNDERNEATH. (SEE SHEET 26.)

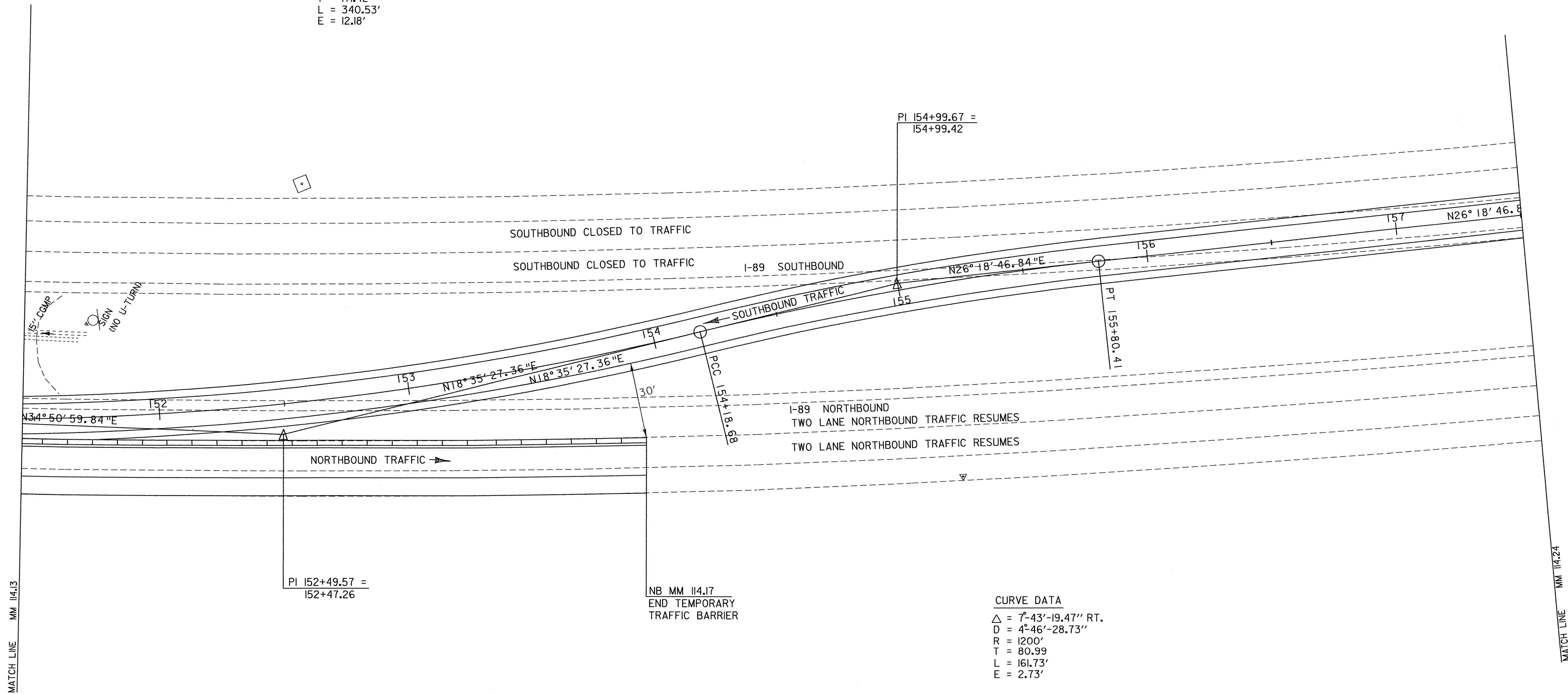

CURVE DATA
 $\Delta = 16^{\circ}15' - 32.48''$ LT.
 $D = 4^{\circ}46' - 28.73''$
 $R = 1200'$
 $T = 171.42'$
 $L = 340.53'$
 $E = 12.18'$



CURVE DATA
 $\Delta = 7^{\circ}43' - 19.47''$ RT.
 $D = 4^{\circ}46' - 28.73''$
 $R = 1200'$
 $T = 80.99'$
 $L = 161.73'$
 $E = 2.73'$

DATUM
 VERTICAL ASSUMED
 HORIZONTAL ASSUMED

CROSSOVER TO BEGIN SOUTHBOUND DETOUR

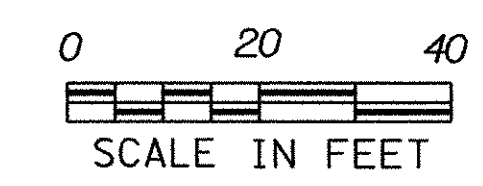

PROJECT: FAIRFAX-FAIRFIELD-ST. ALBANS	PROJECT NO.: IM 089-3(27)
DESIGN FILE NAME: /B7A007B/DESIGN/DA007SBC.DGN	PLOT DATE: 17-NOV-2000
IPARM FILE NAME: DA007SC2	SURVEY DATE: 11/95
SURVEYED BY: GILMAN	DRAWN BY: SQUAD_B
SQUAD LEADER: DELLA.SANTA	SHEET: 265 OF 370