

SOUTHBOUND WILL BE BUILT FIRST.

PAVEMENT MARKING SEQUENCE FOR SOUTHBOUND DETOUR

- 1) REMOVE EXISTING PAVEMENT MARKINGS ON NORTHBOUND.
- 2) INSTALL TEMPORARY PAVEMENT MARKINGS WITH MEDIAN BARRIER ON NORTHBOUND (ITEMS 646.614 AND 646.615).
- 3) WHEN SOUTHBOUND IS DONE (BEFORE WINTER):
 - A) REMOVE TEMPORARY MARKINGS AND MEDIAN BARRIER FROM NORTHBOUND.
 - B) INSTALL PAVEMENT MARKINGS FOR WINTER USE ON BOTH SOUTHBOUND AND NORTHBOUND (ITEMS 646.214 AND 646.215).

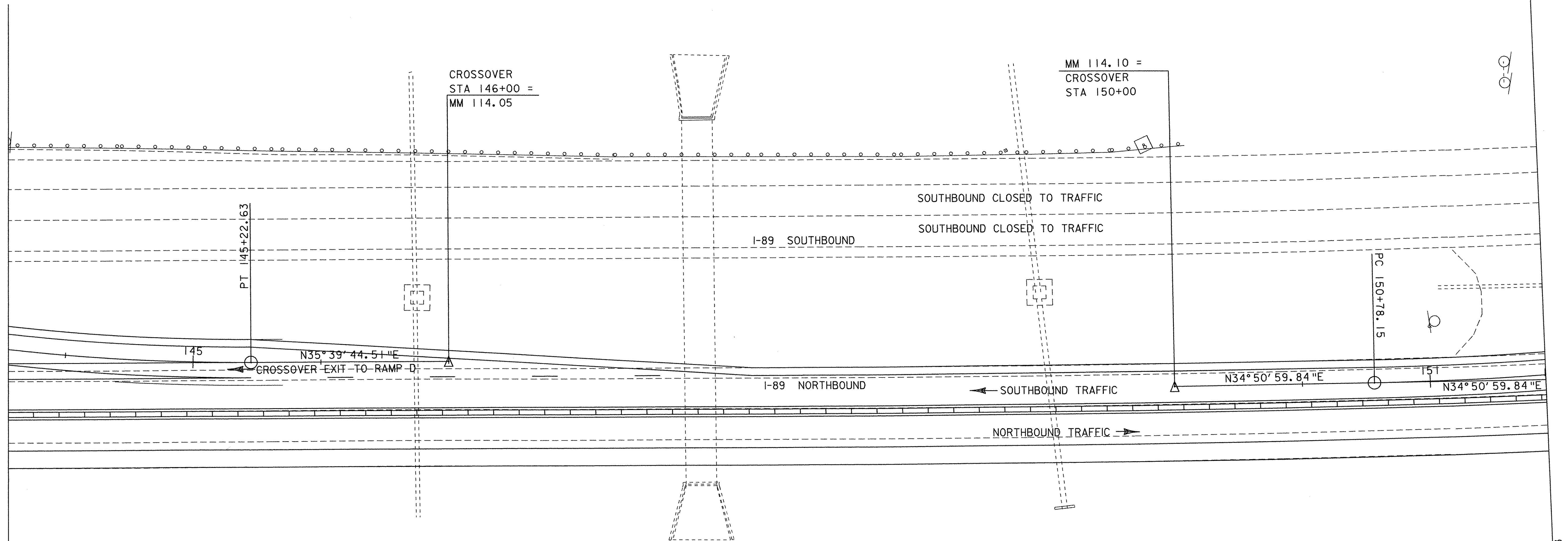
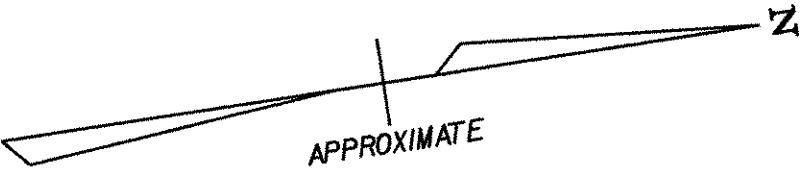

FOR CROSSOVER DETOUR

TEMPORARY 6'' YELLOW LINE

SB CROSSOVER 140+00 - 143+04 (RT. EDGE LINE)

SB CROSSOVER 150+00 - 159+00 (RT. EDGE LINE)

TEMPORARY 6'' WHITE LINE

SB CROSSOVER 140+00 - 143+04 (LT. EDGE LINE)

SB CROSSOVER 150+00 - 159+00 (LT. EDGE LINE)

NB MM 114.03 - 114.07 (DOTTED, DECEL. LANE)

FOR ENTRANCE TRANSITION TO CROSSOVER DETOUR

TEMPORARY 6'' YELLOW LINE (MODIFIED)

SB 114.27 - 114.34 (TRAVELING SB, LEFT EDGE LINE) (APPROXIMATE)

TEMPORARY 6'' WHITE LINE (MODIFIED)

SB 114.27 - 114.34 (TRAVELING SB, RIGHT EDGE LINE) (APPROXIMATE)

DATUM	
VERTICAL	ASSUMED
HORIZONTAL	ASSUMED

CROSSOVER TO BEGIN SOUTHBOUND DETOUR

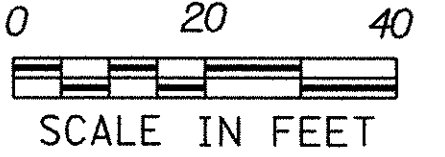

PROJECT:	FAIRFAX-FAIRFIELD-ST. ALBANS	PROJECT NO.:	IM 089-3(27)
DESIGN FILE NAME:	/87A007B/DESIGN/DA007SBC.DGN	PLOT DATE:	19-AUG-2000
IPARM FILE NAME:	DA007SCI	SURVEY DATE:	J1/95
SURVEYED BY:	GILMAN	DRAWN BY:	SQUAD B
SQUAD LEADER:	DELLA SANTA	SHEET:	264 OF 370