

CONSTRUCT DRIVEWAY ENTRANCE
STA. 50+93.3 LT

TRANSPLANT EVERGREEN TREES
CHAN. STA. 30+76 RT
CHAN. STA. 30+86 RT
CHAN. STA. 31+11 LT
CHAN. STA. 31+22 LT
CHAN. STA. 31+55 LT
CHAN. STA. 31+67 LT
CHAN. STA. 31+94 LT
CHAN. STA. 32+08 LT

*** REMOVE AND RESET LIGHT POLE**
STA. 51+41.2 RT
STA. 51+44.4 LT

*** LIGHT POLES TO BE RESET ACCORDING TO RESIDENT ENGINEER AND PROPERTY OWNER.**

ROBTOY, KEVIN L. & LISE G.

SANBORN

APPROXIMATE LOCATION OF
NEW 4" DIA. PVC UNDERDRAIN
CONNECT TO EXISTING 4" DIA.
PVC DRAINAGE PIPE

BM 61
SW CNR GARAGE FLOOR
ELEV. 536.51

DRIVE PI
STA. 51+20.11 BK=
STA. 50+99.60 AH
 $\Delta = 77^\circ 17' 52''$ RT

DRIVE PC
STA. 50+54.54

BEGIN DRIVE CONSTRUCTION
STA. 50+45.00

DRIVE POB
STA. 50+00.00

TO
VT 104

CHANNEL POB
STA. 30+00.00

TROMBLY, LEO A. & JOYCE F.

APPROX. RELOCATION FOR
UNDERGROUND UTILITIES

CULVERT &
CHANNEL (T)
EASEMENT
(T)

3'-0" STONE FILL,
TYPE III (TYP.)

1'-0" STONE FILL,
TYPE I (TYP.)

DRIVE CURVE DATA

$\Delta = 77^\circ 17' 52''$
D = 69°52'22"
R = 82.00'
T = 65.57'
L = 110.63
E = 23.00'
2T-L = 20.51'
BANKING = 0.021' /'

DRIVE POST
STA. 51+42.42
7'-0" X 5'-0" PRECAST
CONCRETE BOX CULVERT
 $\Delta = 95^\circ 25' 15''$ LT

EXISTING STRUCTURE DATA

36" DIA. X 20' CGMP

TROMBLY

LINES SHOWN ON THIS PLAN AS EXISTING
PROPERTY LINES P/L ARE BELIEVED TO
BE ACCURATE BUT SHOULD NOT BE RELIED
UPON FOR PURPOSES UNRELATED TO THE
TOWN OF ST. ALBANS' ACQUISITION OF LAND
AND RIGHTS FOR THIS PROJECT.

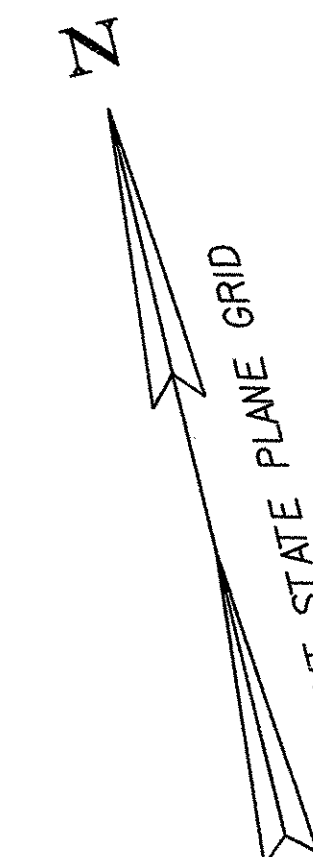

A-A

MATCH LINE

RIGHT-OF-WAY
NOV 27 2000
PRELIMINARY PLANS
COMPLETED PLANS
FINAL PLANS

SCALE 1" = 20'-0"
20 0 20

**STATE OF VERMONT
AGENCY OF TRANSPORTATION**

Town Of FAIRFAX-FAIRFIELD-ST. ALBANS
Highway No. 1-89

Bridge No. 87-3 N & S
Log Sta.
Surv. Sta.

**1-89 OVER THE RUGG BROOK
DRIVE BOX CULVERT PLAN**

Designed By G. ROY
Checked By M. LOZIER
PROJECT FAIRFAX-FAIRFIELD-ST. ALBANS

Drawn By G. ROY
Bridge Design Supervisor R.R. WHITCOMB
Date 6/00

PROJECT NO. 1M 089 - 3 (27)

I.G.C. Info. 96a056Structures\sa056bdr.dgn sa056(01)

R. O. W. SHEET 2 OF 3 SHEETS

130 OF 370