

RAMP C CURVE DATA

$\Delta = 71^{\circ}52' - 28.05''$ RT.
 D = 10'
 R = 572.96'
 T = 415.32'
 L = 718.74'
 E = 134.69'

MATCH EXISTING CROSS SLOPE

REMOVAL AND DISPOSAL
 OF GUARD RAIL
 RAMP C 10+97 RT-11+73 RT
 RAMP C 15+22 RT-16+00 RT

STONE FILL, TYPE II
 (FOR SLOPE PROTECTION)
 RAMP C 14+25 RT-14+75 RT

REMOVAL OF EXISTING FENCE (MOD.)
 RAMP C 8+28 RT-16+00 RT

CHAIN LINK FENCE, 6 FEET
 RAMP C 8+28 RT-16+00 RT

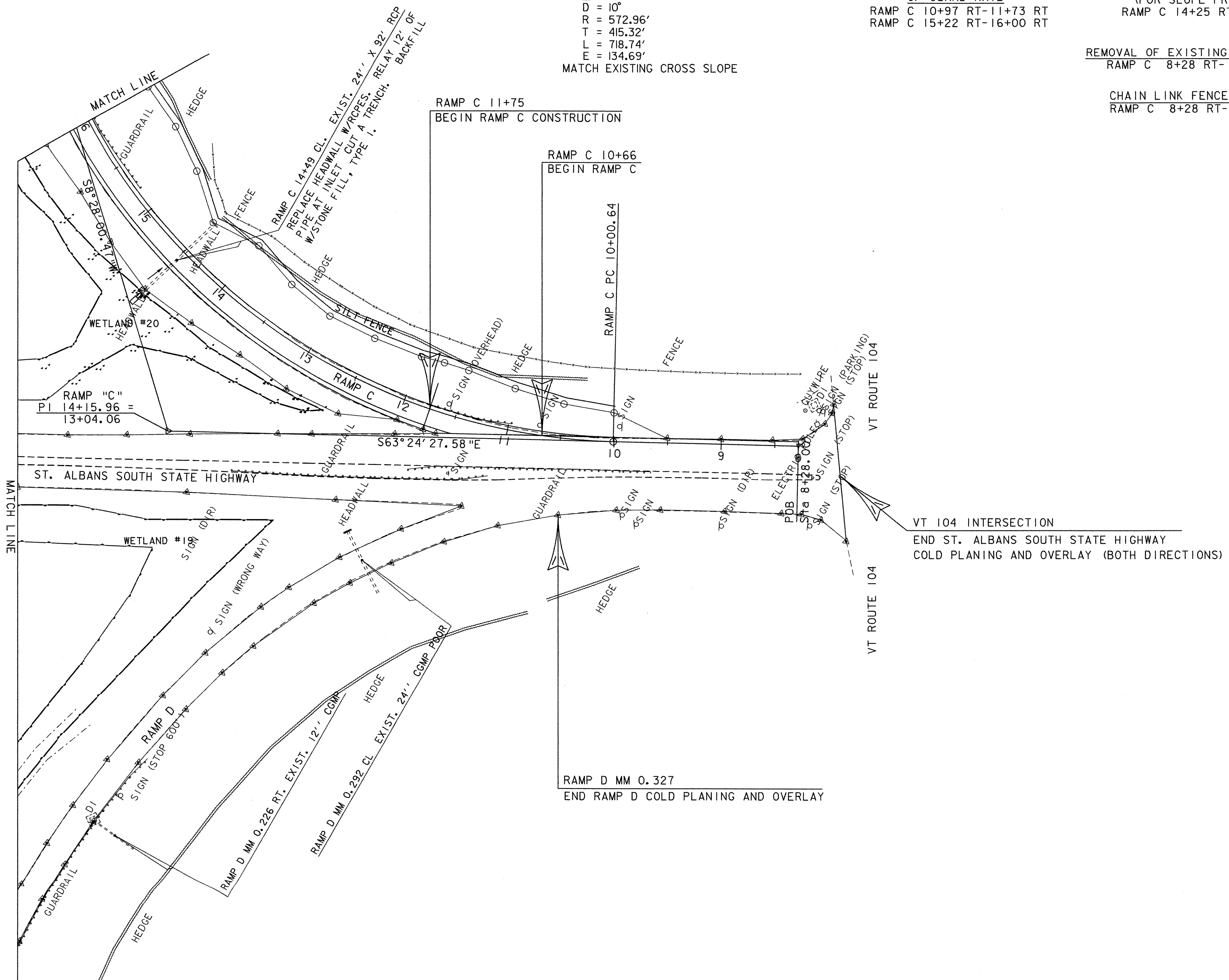
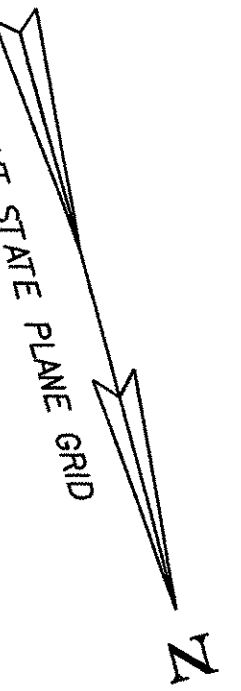

DATUM	
VERTICAL	NAVD88
HORIZONTAL	NAD83(92)

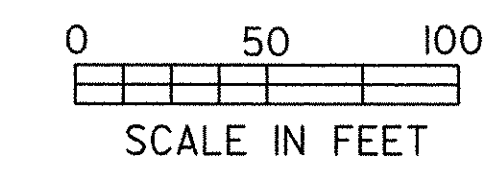

RAMP C 8+28 - 16+00	
PROJECT: FAIRFAX - FAIRFIELD - ST. ALBANS	PROJECT NO.: IM 089-3(27)
DESIGN FILE NAME: /87A007B/DESIGN/DA007NUI.DGN	PLOT DATE: 18-AUG-2000
IPARM FILE NAME: DA007L3	SURVEY DATE: 6/98
SURVEYED BY: ORVIS	DRAWN BY: SQUAD B
SQUAD LEADER: DELLA SANTA	SHEET: 72 OF 370