

REMOVAL AND DISPOSAL
OF GUARD RAIL
(SOUTHBOUND)
3381+00 LT - 3382+81 LT
3394+12 LT - 3397+00 LT
3395+66 RT - 3397+00 RT

STEEL BEAM GUARD RAIL
(SOUTHBOUND)
3385+10 LT - 3397+00 LT
3395+50 RT - 3397+00 RT

SOUTHBOUND: 8' UNDERDRAIN (MODIFICATION #1)
① 3381+02 RT - 3385+46 RT W/FB @ 3381+02 RT
② 3385+51 RT - 3389+96 RT W/FB @ 3389+96 RT
③ 3390+02 RT - 3395+00 RT W/FB @ 3390+02 RT

REMOVAL OF EXISTING FENCE (MOD.)
STA. 3385+00 SB LT - 3397+00 SB LT
CHAIN LINK FENCE, 6 FEET
STA. 3385+00 SB LT - 3397+00 SB LT

SOUTHBOUND: 8' UNDERDRAIN (MODIFICATION #2)
④ 3381+02 RT - 3385+46 RT W/FB @ 3381+02 RT
⑤ 3385+51 RT - 3389+96 RT W/FB @ 3389+96 RT
⑥ 3390+02 RT - 3395+00 RT W/FB @ 3390+02 RT

SOUTHBOUND: 8' UNDERDRAIN CARRIER PIPE
⑦ 3385+46 LT W/FB @ 3385+46 LT
⑧ 3389+96 RT W/FB @ 3389+96 RT
⑨ 3395+00 RT W/FB @ 3395+00 RT



MATCH LINE SB STA. 3381+00

MATCH LINE SB STA. 3397+00

MATCH LINE NB STA. 3381+00

MATCH LINE NB STA. 3397+00

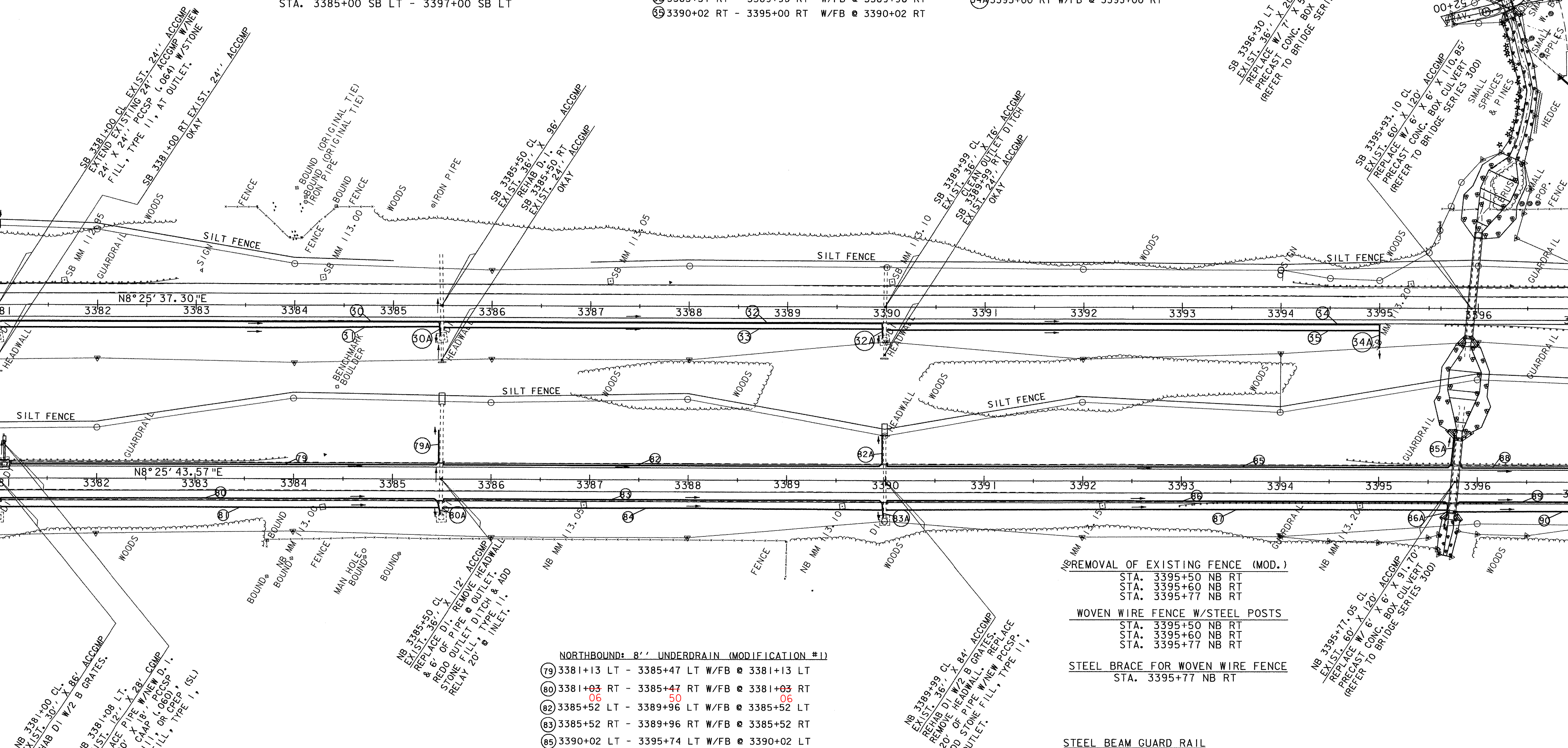

NORTHBOUND: 8' UNDERDRAIN CARRIER PIPE
⑦9A 3385+47 LT W/FB @ 3385+47 LT
⑧0A 3385+47 RT W/FB @ 3385+47 RT
⑧2A 3389+96 LT W/FB @ 3389+96 LT
⑧2A 3389+96 RT W/FB @ 3389+96 RT
⑧5A 3395+74 LT W/FB @ 3395+74 LT
⑧6A 3395+71 RT W/FB @ 3395+71 RT

NORTHBOUND: 8' UNDERDRAIN (MODIFICATION #1)
⑦9 3381+13 LT - 3385+47 LT W/FB @ 3381+13 LT
⑧0 3381+03 RT - 3385+47 RT W/FB @ 3381+03 RT
⑧2 3385+52 LT - 3389+96 LT W/FB @ 3385+52 LT
⑧3 3385+52 RT - 3389+96 RT W/FB @ 3385+52 RT
⑧5 3390+02 LT - 3395+74 LT W/FB @ 3390+02 LT
⑧6 3390+02 RT - 3395+71 RT W/FB @ 3390+02 RT
⑧8 3395+82 LT - 3397+00 LT W/FB @ 3395+82 LT
⑧9 3395+79 RT - 3397+00 RT W/FB @ 3395+79 RT
NORTHBOUND: 8' UNDERDRAIN (MODIFICATION #2)
⑧1 3381+03 RT - 3385+47 RT W/FB @ 3381+03 RT
⑧4 3385+52 RT - 3389+96 RT W/FB @ 3385+52 RT
⑧7 3390+02 RT - 3395+71 RT W/FB @ 3390+02 RT
⑨0 3395+79 RT - 3397+00 RT W/FB @ 3395+79 RT
3396+00

REMOVAL OF EXISTING FENCE (MOD.)
STA. 3395+50 NB RT
STA. 3395+60 NB RT
STA. 3395+77 NB RT
WOVEN WIRE FENCE W/STEEL POSTS
STA. 3395+50 NB RT
STA. 3395+60 NB RT
STA. 3395+77 NB RT
STEEL BRACE FOR WOVEN WIRE FENCE
STA. 3395+77 NB RT

STEEL BEAM GUARD RAIL
(NORTHBOUND)
3381+00 LT - 3383+00 LT
3394+50 LT - 3396+50 LT
3394+50 RT - 3396+50 RT

REMOVAL AND DISPOSAL
OF GUARD RAIL
(NORTHBOUND)
3381+00 LT - 3383+95 LT
3394+68 LT - 3397+00 LT
3393+00 RT - 3396+25 RT

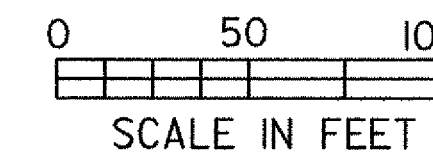

PROJECT: FAIRFAX - FAIRFIELD - ST. ALBANS		PROJECT NO.: IM 089-3(27)	
DESIGN FILE NAME:	/B7A007B/DESIGN/DA007NUI.DGN	PLOT DATE:	07-SEP-2000
IPARM FILE NAME:	DA007L08	SURVEY DATE:	6/98
SURVEYED BY:	ORVIS	DRAWN BY:	SQUAD B
SQUAD LEADER:	DELLA SANTA	SHEET:	63 OF 370

DATUM	
VERTICAL	NAVD88
HORIZONTAL	NAD83(92)