

STEEL BEAM GUARD RAIL  
(SOUTHBOUND)  
3333+00 LT - 3343+00 LT  
3333+50 RT - 3336+50 RT

REMOVAL AND DISPOSAL  
OF GUARD RAIL  
(SOUTHBOUND)  
3333+00 LT - 3349+00 LT  
3334+12 RT - 3336+88 RT

REMOVAL OF EXISTING FENCE (MOD.)  
STA. 3336+12 SB LT  
STA. 3336+40 SB LT  
WOVEN WIRE FENCE W/STEEL POSTS  
STA. 3336+12 SB LT  
STA. 3336+40 SB LT



MATCH LINE SB STA. 3333+00

MATCH LINE SB STA. 3349+00

MATCH LINE NB STA. 3333+00

MATCH LINE NB STA. 3349+00

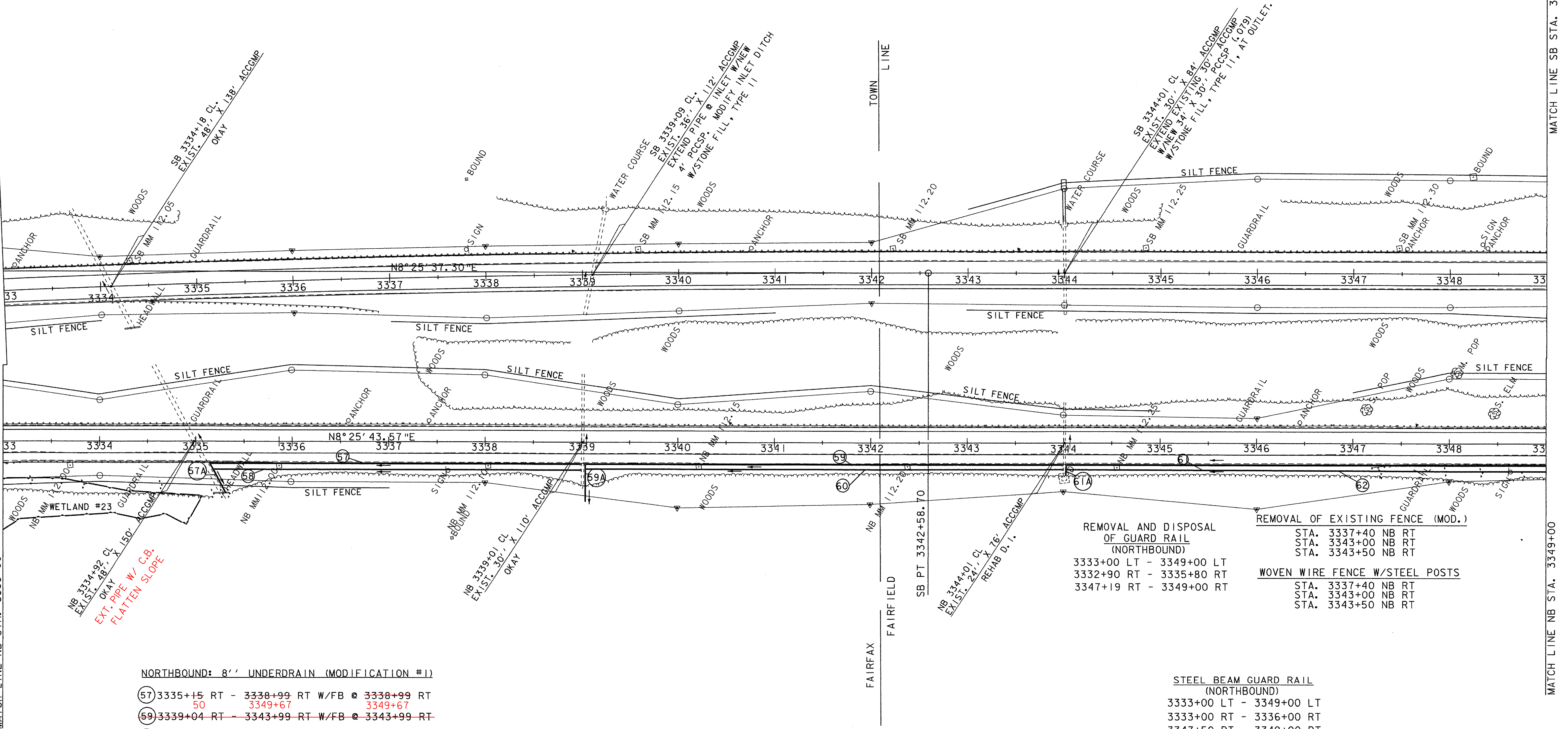

NORTHBOUND: 8" UNDERDRAIN (MODIFICATION #1)

- (57) 3335+15 RT - 3338+99 RT W/FB @ 3338+99 RT
- 50 3349+67 3349+67
- (59) 3339+04 RT - 3343+99 RT W/FB @ 3343+99 RT
- (61) 3344+03 RT - 3349+68 RT W/FB @ 3349+68 RT

NORTHBOUND: 8" UNDERDRAIN (MODIFICATION #2)

- (58) 3335+18 RT - 3338+99 RT W/FB @ 3338+99 RT
- 40 3349+63 3349+63
- (60) 3339+05 RT - 3343+99 RT W/FB @ 3343+99 RT
- (62) 3344+03 RT - 3349+68 RT W/FB @ 3349+68 RT

NORTHBOUND: 8" UNDERDRAIN CARRIER PIPE

- (57A) 3335+15 RT W/FB @ 3335+15 RT
- (59A) 3339+04 RT W/FB @ 3339+04 RT
- (61A) 3344+03 RT W/FB @ 3344+03 RT

REMOVAL AND DISPOSAL  
OF GUARD RAIL  
(NORTHBOUND)  
3333+00 LT - 3349+00 LT  
3332+90 RT - 3335+80 RT  
3347+19 RT - 3349+00 RT

REMOVAL OF EXISTING FENCE (MOD.)  
STA. 3337+40 NB RT  
STA. 3343+00 NB RT  
STA. 3343+50 NB RT  
WOVEN WIRE FENCE W/STEEL POSTS  
STA. 3337+40 NB RT  
STA. 3343+00 NB RT  
STA. 3343+50 NB RT

STEEL BEAM GUARD RAIL  
(NORTHBOUND)  
3333+00 LT - 3349+00 LT  
3333+00 RT - 3336+00 RT  
~~3347+50 RT - 3349+00 RT~~

DATUM	
VERTICAL	NAVD88
HORIZONTAL	NAD83(92)

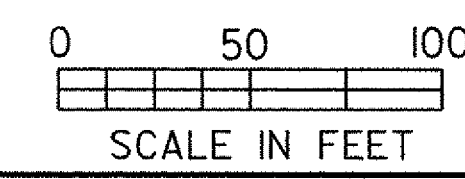

PROJECT: FAIRFAX - FAIRFIELD - ST. ALBANS		PROJECT NO.: IM 089-3(27)
DESIGN FILE NAME: /87A007B/DESIGN/DA007NUI.DGN	PLOT DATE: 18-AUG-2000	
IPARM FILE NAME: DA007L05	SURVEY DATE: 6/98	
SURVEYED BY: ORVIS	DRAWN BY: SQUAD B	
SQUAD LEADER: DELLA SANTA	SHEET: 57 OF 370	