

**PLAN VIEW**

MARK: 2201-1104-C  
 FIXED BEARING  
 (6) REQ'D @ ABUT. 5  
 (6) TOTAL REQ'D

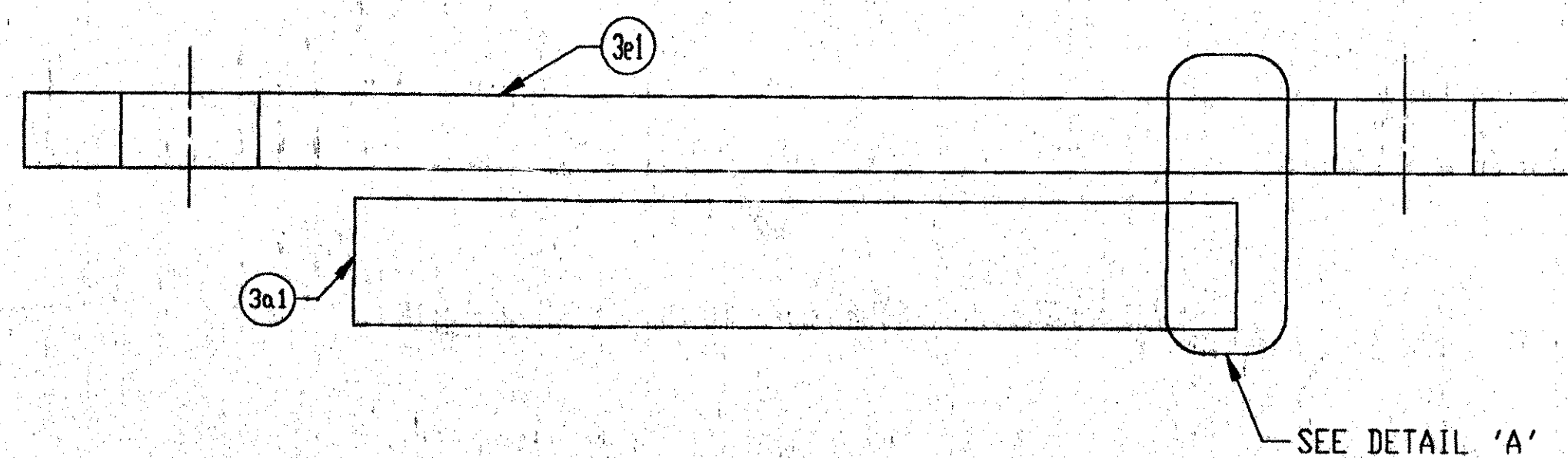

**SECTION 'A-A'**

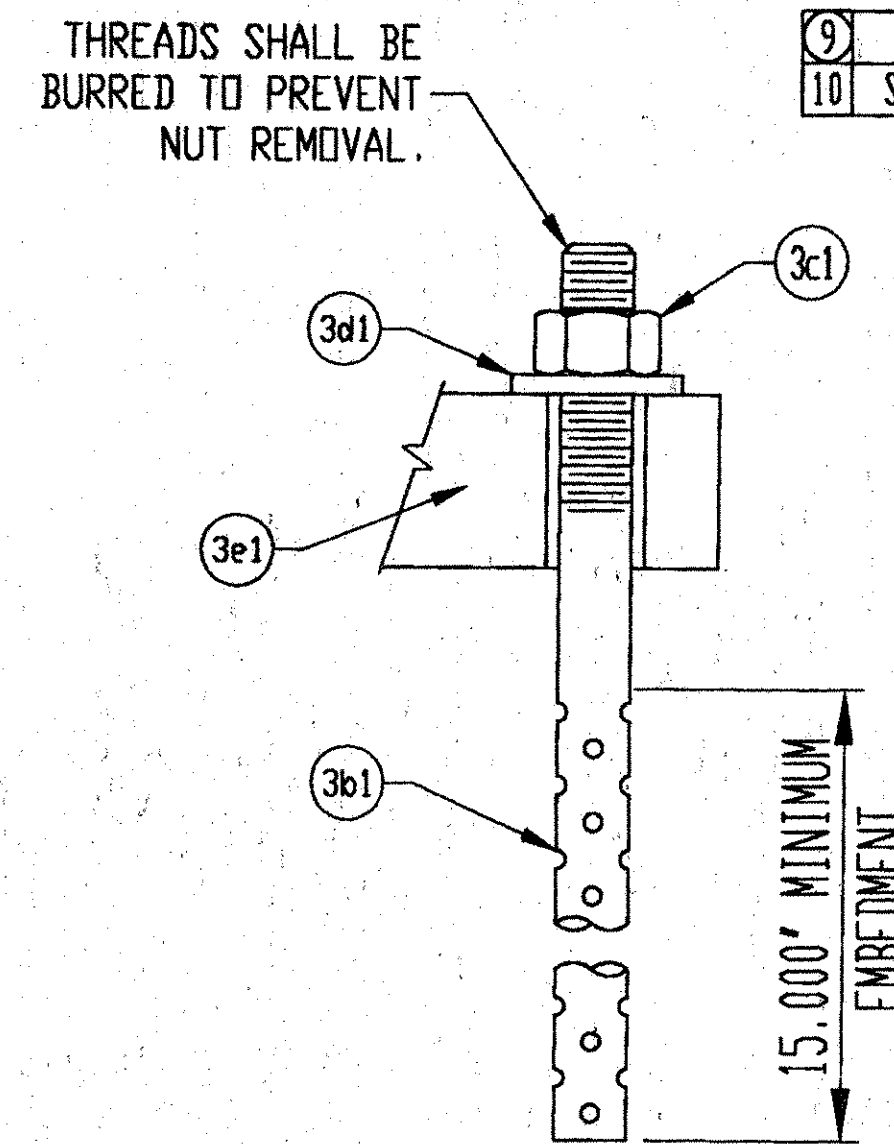

**ANCHOR ASSEMBLY DETAIL**

ALL MATERIALS AND CONSTRUCTION SHALL CONFORM TO STATE OF VERMONT AGENCY OF TRANSPORTATION STANDARD SPECIFICATIONS FOR CONSTRUCTION DATED 1990, AND ITS LATEST REVISIONS, AND THE AASHTO STANDARD SPECIFICATIONS FOR HIGHWAY BRIDGES, DATED 1996, AND ITS LATEST REVISIONS.

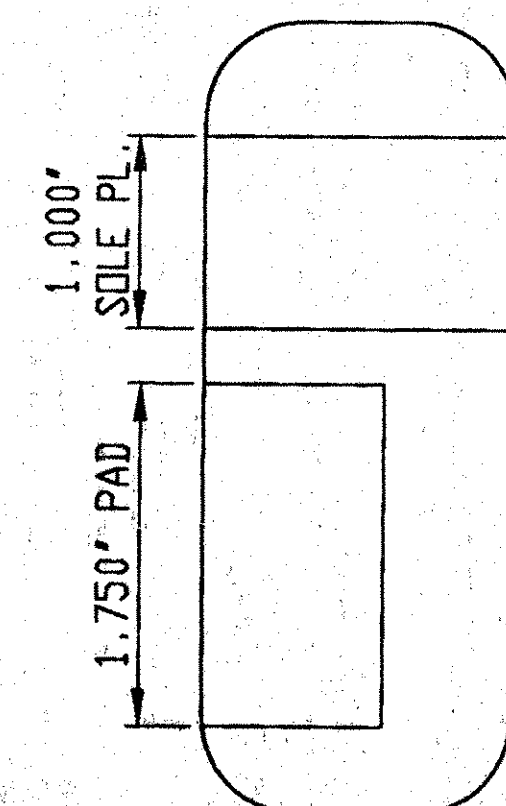

**DETAIL 'A'**

LINE	PART	MARK	NO REQ'D	DESCRIPTION	REMARKS
1		3A	6	PREFORMED FABRIC PAD	
2	FABRIC PAD	3a1	6	1.75' X 9.000' X 12.000'	VERMONT SPEC. 731.01, AASHTO 18.4.10.1
3		3B	24	SWEDGE ANCHOR ROD	
4	SWEDGE ANCHOR ROD	3b1	24	1.50' X 21.000' #14' THREADED, 15' MIN. SWEDGED	ASTM A36 GALVANIZED A153
5		3C	24	HEAVY HEX NUT	
6	HEAVY HEX NUT	3c1	24	1.50'	ASTM A307 GR. DH, GALVANIZED A153
7		3D	24	WASHER PLATE	
8	WASHER PLATE	3d1	24	.375' X 3.000' X 3.000' w/ 1.625'Ø HOLE	ASTM A36, GALVANIZED A123
9		3E	6	SOLE PLATE	
10	SOLE PLATE	3e1	6	1.000' X 15.000' X 21.000'	ASTM A709 GR. 36, GALVANIZED A123

**GENERAL NOTES:**

- PAD AND MATERIALS SHALL CONFORM TO VERMONT DEPARTMENT OF TRANSPORTATION—DIVISION OF HIGHWAYS—SPECIFICATIONS FOR 531 & 731. *AGENCY STANDARD SPECIFICATIONS FOR CONSTRUCTION SECTIONS*
- THESE SHOP DRAWINGS WERE PREPARED IN ACCORDANCE WITH THE CONTRACT PLANS AND SPECIFICATIONS. THE D.S. BROWN COMPANY DOES NOT ACCEPT LIABILITY FOR THE DESIGN OF THE PRODUCTS DETAILED IN THESE SHOP DRAWINGS.
- THE BEARINGS SHALL BE SUBJECTED TO RANDOM IN-HOUSE ELASTOMER TESTING AND RANDOM IN-HOUSE PROOF LOAD TESTING IN ACCORDANCE WITH AASHTO DIVISION I, SECTION 14 (METHOD "A") AND AASHTO DIVISION II, SECTION 18.
- THE D.S. BROWN COMPANY IS TO ONLY SUPPLY THE PARTS SHOWN ON THIS DRAWING.

SURFACES TO BE GALVANIZED OR METALIZED. PRIOR TO GALVANIZING OR METALIZING, ALL CORNERS AND EDGES OF STEEL PLATES, SHAPES, ETC., SHALL BE GROUND TO A 1/16 INCH RADIUS.

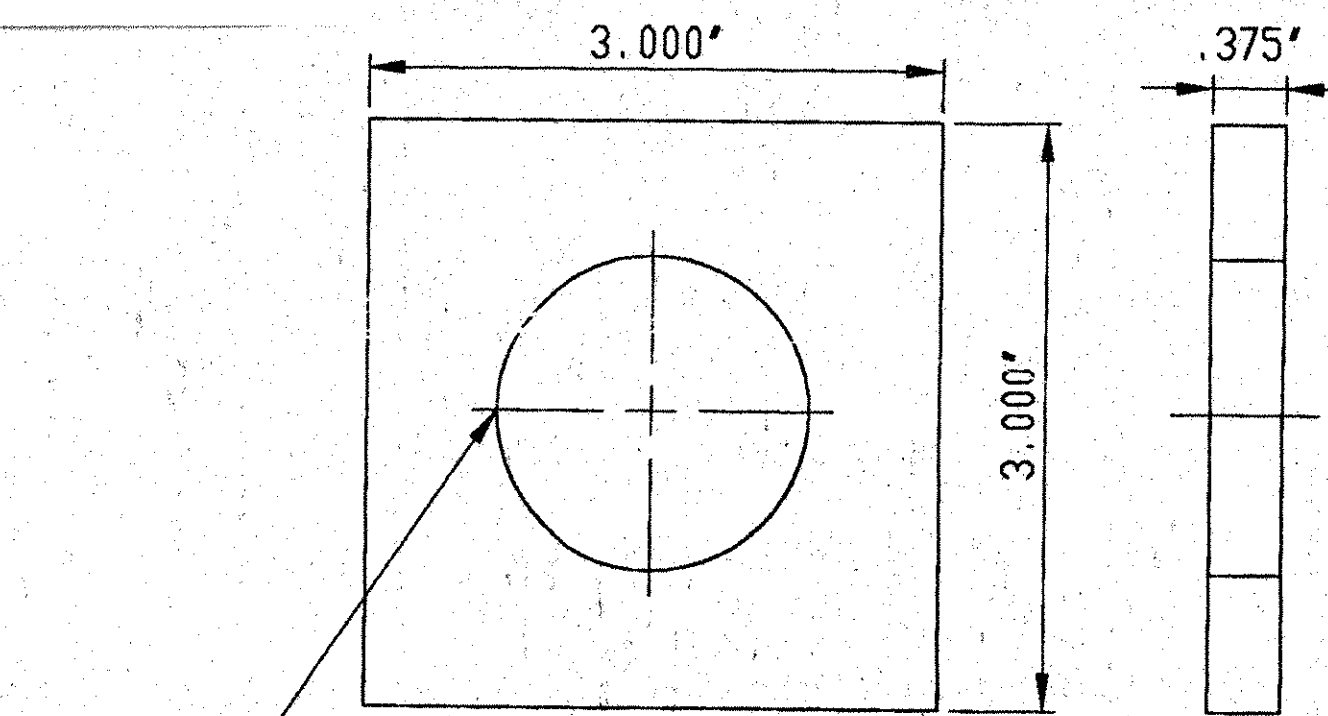

**WASHER PLATE DETAIL**

V.A.O.T. RECEIVED  
 OK'D BY *[Signature]* OK'D BY *[Signature]*  
 2-28-01  
 FEB 26 2001  
 RESUBMIT APPROVED *[Signature]*  
 BY *[Signature]* DATE 3-8-01

2201-1106-3, 6 OF 6  
SHEET 3 OF 7

D.S. BROWN

F.A.P. NO.: -  
 STATE PROJ. NO.: 1M-089-3(27)  
 BRIDGE NO: 885  
 DESIGNER: VT AGENCY OF TRANSPORTATION  
 CONTRACTOR: J.A. MCDONALD

DATE	SYM	REVISION	DR	CK

THE D.S. BROWN COMPANY, INC.  
 NORTH BALTIMORE, OHIO 45872-0158 U.S.A.

SCALE: N/A  
 DATE: 1/19/01  
 1-89 OVER ST. ALBANS S. STATE HIGHWAY (EXIT 19)  
 FRANKLIN COUNTY VERMONT  
 PREFORMED FABRIC BEARING

DRAWN BY: COPPUS  
 415  
 DRAWING NUMBER  
 2201-1106-03