

PLAN SURVEYED BY DATE
 COULLEY 3/63
 NORTH BOOKED BY
 INSTRUMENT CHECKED
 NO. TRACED

*JUTE MATTING, ITEM 628
 NB 3365+00 Rt. - NB 3380+00 Rt.
 SB 3365+00 Rt. - SB 3380+00 Rt.

*THREE CABLE GUARD RAIL w/STEEL POSTS
 ITEM 542
 NB 3364+50 Lt. - 3380+00 Lt.
 SB 3364+00 Lt. - 3380+00 Lt.

TREATED TIMBER GUARD
 BURNING CONG. CURB
 ITEM 558 Item 555-Type II
 S.B. 3364+00-3380+00 Lt.
 N.B. 3364+00-3380+00 Rt.
 3370+00

NOTE: * DENOTES ITEMS TO BE INCLUDED
 IN STAGE II CONSTRUCTION.

CONTROL OF ACCESS IS COMPLETE ON THIS SHEET.

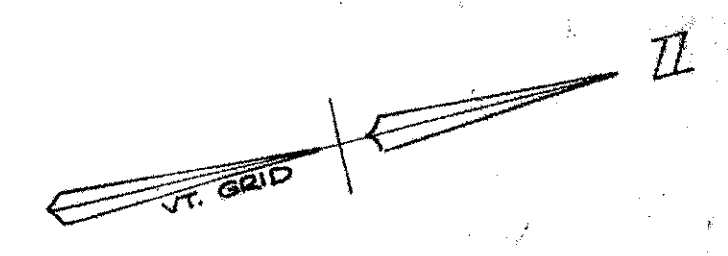

BM #164
 ASMD. ELEV.
 588.76

Rev POT 3366+50.00

Rev POT 3374+45.01

APPROX AERIAL UTILITIES RELOC.
 ROUTE BY NET & T CO

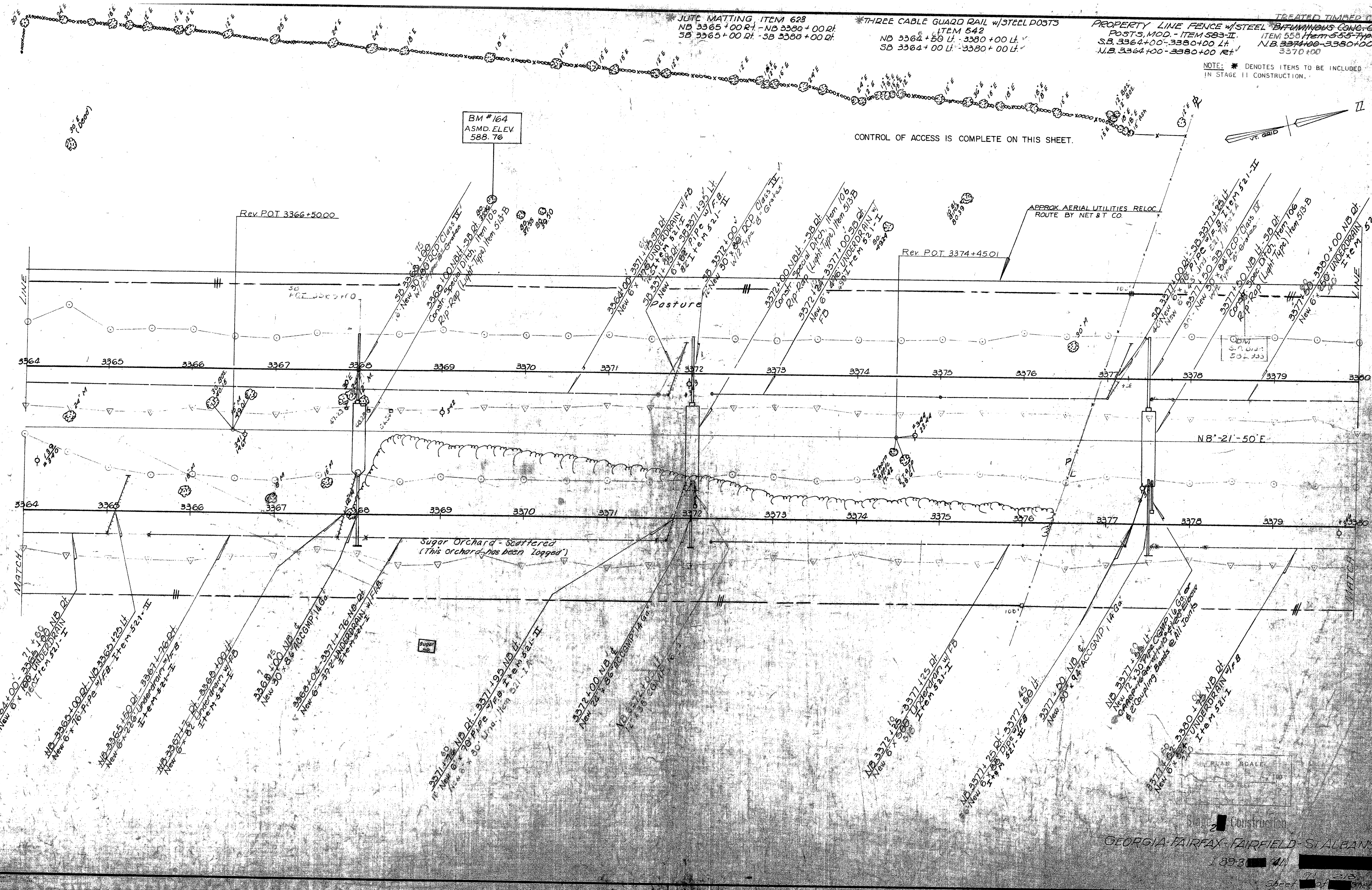

GRAPHIC SCALE
 1" = 100'

Construction
 GEORGIA FAIRFAX FAIRFIELD-STALBANS

1893 141

STA. 3364 = MM 112.60