

SB MM 110.82 =
CROSSOVER
STA. 100+00

PI STA. 102+51.41 =
102+49.50

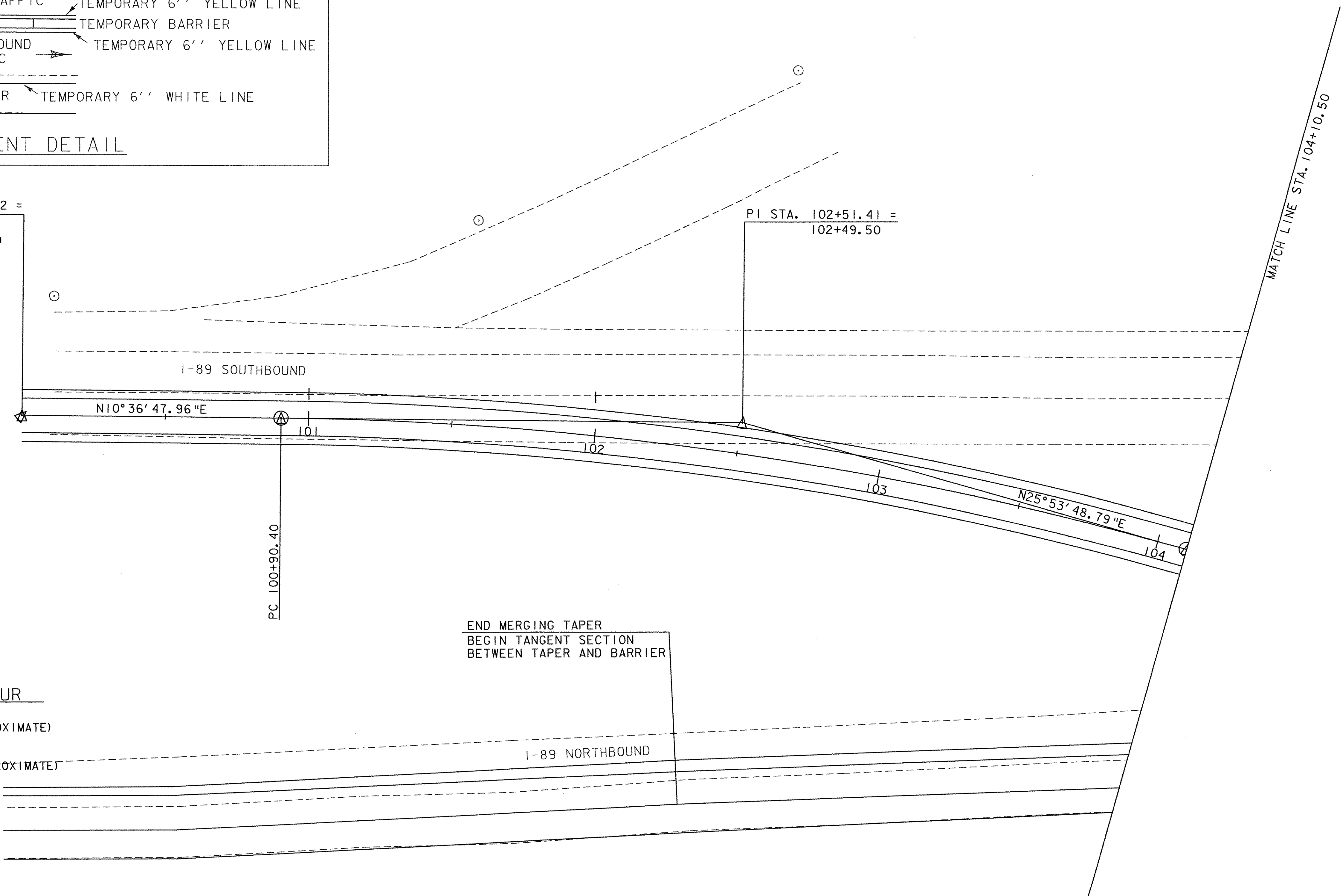

FOR CROSSOVER DETOUR

TEMPORARY 6'' YELLOW LINE
SB CROSSOVER 100+00 - 108+00 (RT. EDGE LINE)
TEMPORARY 6'' WHITE LINE
SB CROSSOVER 100+00 - 108+00 (LT. EDGE LINE)

FOR DETOUR ON NORTHBOUND LANES

TEMPORARY 6'' YELLOW LINE
NB 3276+60 - 3446+50 (TRAVELING NB, LEFT EDGE)
NB 3279+40 - 3446+50 (TRAVELING SB, LEFT EDGE)
TEMPORARY 6'' WHITE LINE
NB 3276+60 - 3446+50 (TRAVELING NB, RIGHT EDGE)
NB 3279+40 - 3446+50 (TRAVELING SB, RIGHT EDGE)

FOR EXIT TRANSITION FROM CROSSOVER DETOUR

TEMPORARY 6'' YELLOW LINE (MODIFIED)
SB MM 110.75 - 110.82 (TRAVELING SB, LEFT EDGE LINE) (APPROXIMATE)
TEMPORARY 6'' WHITE LINE (MODIFIED)
SB MM 110.75 - 110.82 (TRAVELING SB, RIGHT EDGE LINE) (APPROXIMATE)

COLD PLANING-BITUMINOUS PAVEMENT
NB 3276+60 - 3446+50 RT (4' WIDE)
(TO SMOOTH OUT PAVEMENT BETWEEN
TRAVELWAY AND SHOULDER FOR DETOUR)

CURVE DATA
Δ = 15°17'-00.83" RT.
D = 4°46'-28.73"
R = 1200'
T = 161.00'
L = 320.10'
E = 10.75'

DATUM	
VERTICAL	NAVD88
HORIZONTAL	NAD83(92)

CROSSOVER TO END SOUTHBOUND DETOUR

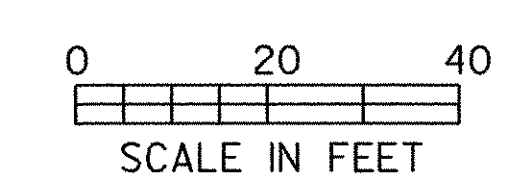

PROJECT: FAIRFAX - FAIRFIELD - ST. ALBANS	PROJECT NO.: IM 089-3(27)
DESIGN FILE NAME: /87A007B/DESIGN/DA007SBA.DGN	PLOT DATE: 09-SEP-2000
IPARM FILE NAME: DA007SC4	SURVEY DATE: 6/98
SURVEYED BY: ORVIS	DRAWN BY: SQUAD B
SQUAD LEADER: DELLA SANTA	SHEET: 276 OF 370