

A-A

MATCHLINE

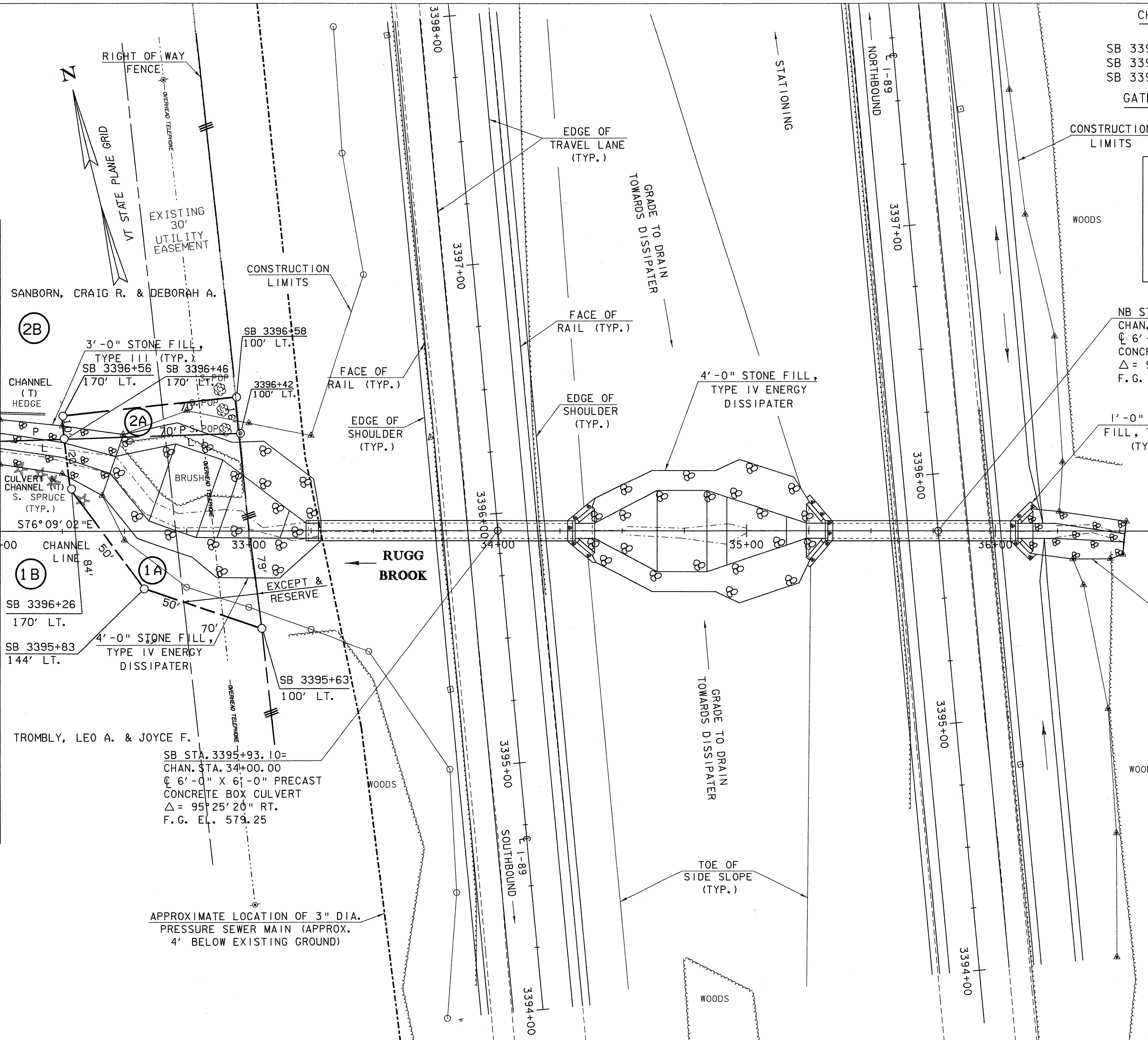

CHAIN-LINK FENCE, 6 FEET
(FOR UTILITY USE)
SB 3395+62, 100' LT. TO 170' LT.
SB 3395+62, 170' LT. TO 3396+62, 170' LT.
SB 3396+62, 100' LT. TO 170' LT.

GATE FOR CHAIN-LINK FENCE, 6 FEET
(FOR UTILITY USE)
SB 3395+62 LT.

LINES SHOWN ON THIS PLAN AS EXISTING PROPERTY LINES P/L ARE BELIEVED TO BE ACCURATE BUT SHOULD NOT BE RELIED UPON FOR PURPOSES UNRELATED TO THE TOWN OF ST. ALBANS' ACQUISITION OF LAND AND RIGHTS FOR THIS PROJECT.

NB STA. 3395+77.05=
CHAN. STA. 35+77.01
Ø 6'-0" X 6'-0" PRECAST
CONCRETE BOX CULVERT
Δ = 95°25'13" RT.
F.G. EL. 598.62

1'-0" STONE
FILL, TYPE I
(TYP.)

CHANNEL POE
STA. 36+75.00

RIGHT-OF-WAY
NOV 27 2000
PRELIMINARY PLANS
COMPLETED PLANS
FINAL PLANS

EXISTING STRUCTURE DATA
NB: 60" DIA. X 120' ACCGMP
SB: 60" DIA. X 120' ACCGMP

SCALE 1" = 20'-0"
20 0 20

STATE OF VERMONT AGENCY OF TRANSPORTATION	
Town Of FAIRFAX-FAIRFIELD-ST. ALBANS	Bridge No. 87-3 N & S
Highway No. 1-89	Log Sta. Surv. Sta.
1-89 OVER THE RUGG BROOK	
87-3 N & S PLAN	
Designed By G. ROY	Drawn By G. ROY
Checked By M. LOZIER	Bridge Design Supervisor R.R. WHITCOMB
PROJECT FAIRFAX-FAIRFIELD-ST. ALBANS	PROJECT NO. 1M 089 - 3 (27)
I.G.C. Info. 96a056Structures\sa056bdr.dgn	so056i021
R. O. W. SHEET 3 OF 3 SHEETS	