

REMOVAL AND DISPOSAL
OF GUARD RAIL
(SOUTHBOUND)
3381+00 LT - 3382+81 LT
3394+12 LT - 3397+00 LT
3395+66 RT - 3397+00 RT

STEEL BEAM GUARD RAIL
(SOUTHBOUND)
3385+10 LT - 3397+00 LT
3395+50 RT - 3397+00 RT

SOUTHBOUND: 8' UNDERDRAIN (MODIFICATION #1)
① 3381+02 RT - 3385+46 RT W/FB @ 3381+02 RT
② 3385+51 RT - 3389+96 RT W/FB @ 3389+96 RT
③ 3390+02 RT - 3395+00 RT W/FB @ 3390+02 RT

REMOVAL OF EXISTING FENCE (MOD.)
STA. 3385+00 SB LT - 3397+00 SB LT
CHAIN LINK FENCE, 6 FEET
STA. 3385+00 SB LT - 3397+00 SB LT

SOUTHBOUND: 8' UNDERDRAIN (MODIFICATION #2)
① 3381+02 RT - 3385+46 RT W/FB @ 3381+02 RT
② 3385+51 RT - 3389+96 RT W/FB @ 3389+96 RT
③ 3390+02 RT - 3395+00 RT W/FB @ 3390+02 RT

SOUTHBOUND: 8' UNDERDRAIN CARRIER PIPE
① 3385+46 LT W/FB @ 3385+46 LT
② 3389+96 RT W/FB @ 3389+96 RT
③ 3395+00 RT W/FB @ 3395+00 RT



MATCH LINE SB STA. 3381+00

MATCH LINE SB STA. 3397+00

MATCH LINE NB STA. 3381+00

MATCH LINE NB STA. 3397+00

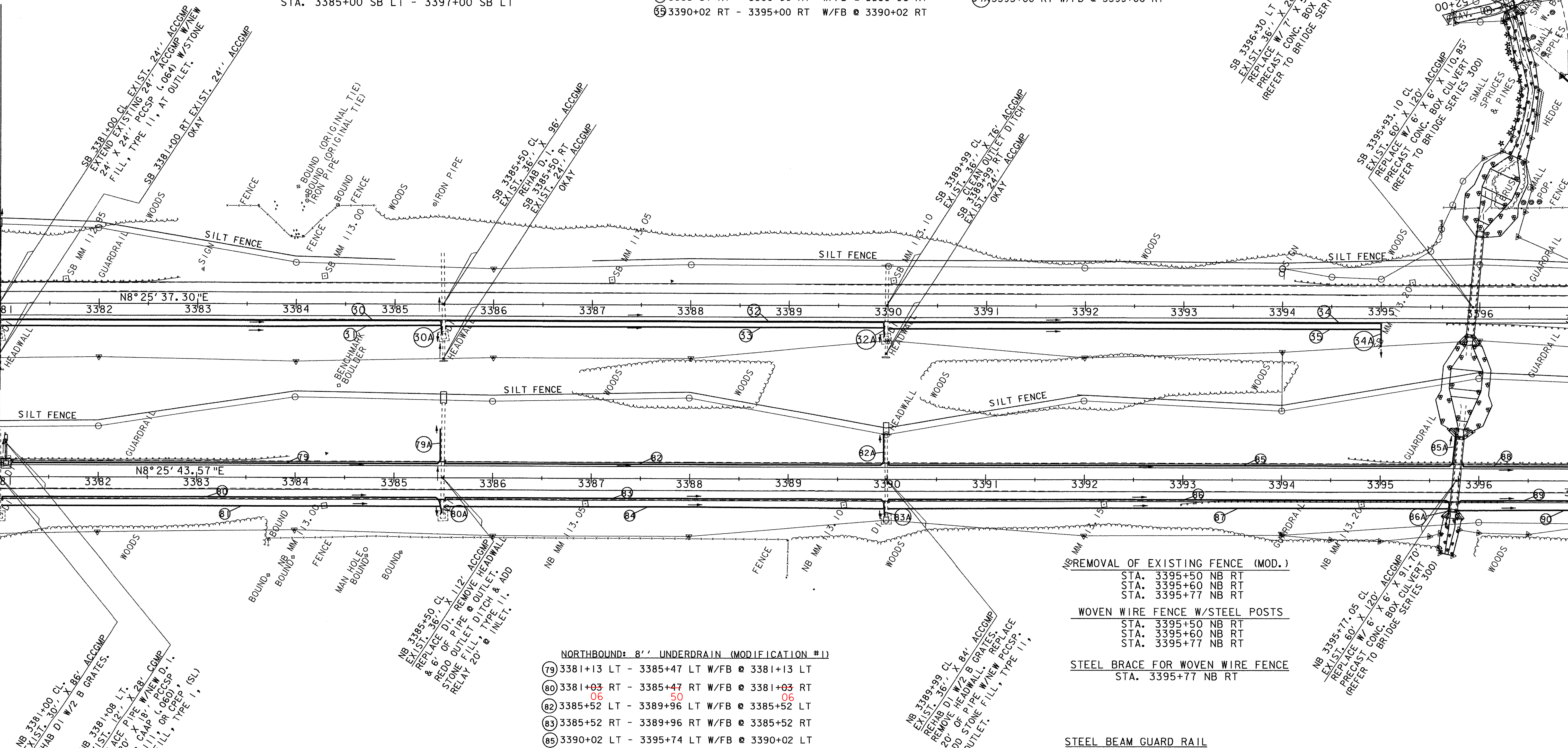

NB 3381+00 CL.
EX. LST. 30' X 86' ACCOMP.
REHAB D.I. W/2 B GRATES.
NB 3381+08 LT.
EX. LST. 12' X 28' CGMP.
REPLACE W/ 20' PIPE W/NEW D. I.
(C. 064) C. 448' (C. 060) PCCSP.
W/STONE FILL, TYPE I, OR GREP.
AT OUTLET, TYPE I, (SL)

NORTHBOUND: 8' UNDERDRAIN CARRIER PIPE
⑦9A 3385+47 LT W/FB @ 3385+47 LT
⑧0A 3385+47 RT W/FB @ 3385+47 RT
⑧2A 3389+96 LT W/FB @ 3389+96 LT
⑧2A 3389+96 RT W/FB @ 3389+96 RT
⑧5A 3395+74 LT W/FB @ 3395+74 LT
⑧6A 3395+71 RT W/FB @ 3395+71 RT

NORTHBOUND: 8' UNDERDRAIN (MODIFICATION #1)
⑦9 3381+13 LT - 3385+47 LT W/FB @ 3381+13 LT
⑧0 3381+03 RT - 3385+47 RT W/FB @ 3381+03 RT
⑧2 3385+52 LT - 3389+96 LT W/FB @ 3385+52 LT
⑧3 3385+52 RT - 3389+96 RT W/FB @ 3385+52 RT
⑧5 3390+02 LT - 3395+74 LT W/FB @ 3390+02 LT
⑧6 3390+02 RT - 3395+71 RT W/FB @ 3390+02 RT
⑧8 3395+82 LT - 3397+00 LT W/FB @ 3395+82 LT
⑧9 3395+79 RT - 3397+00 RT W/FB @ 3395+79 RT
NORTHBOUND: 8' UNDERDRAIN (MODIFICATION #2)
⑧1 3381+03 RT - 3385+47 RT W/FB @ 3381+03 RT
⑧4 3385+52 RT - 3389+96 RT W/FB @ 3385+52 RT
⑧7 3390+02 RT - 3395+71 RT W/FB @ 3390+02 RT
⑨0 3395+79 RT - 3397+00 RT W/FB @ 3395+79 RT
3396+00

NB 3389+99 CL.
EX. LST. 36' X 84' ACCOMP.
REHAB D.I. W/2 B GRATES.
REHAB HEADWALL, REMOVE
20' OF PIPE W/NEW PCCSP.
ADD STONE FILL, TYPE I, AT
OUTLET.

REMOVAL OF EXISTING FENCE (MOD.)
STA. 3395+50 NB RT
STA. 3395+60 NB RT
STA. 3395+77 NB RT
WOVEN WIRE FENCE W/STEEL POSTS
STA. 3395+50 NB RT
STA. 3395+60 NB RT
STA. 3395+77 NB RT
STEEL BRACE FOR WOVEN WIRE FENCE
STA. 3395+77 NB RT

STEEL BEAM GUARD RAIL
(NORTHBOUND)
3381+00 LT - 3383+00 LT
3394+50 LT - 3396+50 LT
3394+50 RT - 3396+50 RT

NB 3395+77.05 CL.
EX. LST. 60' X 120' ACCOMP.
REPLACE W/ 6' X 120' PCCSP.
REFER TO BRIDGE SERIES 300)

PROJECT: FAIRFAX - FAIRFIELD - ST. ALBANS		PROJECT NO.: IM 089-3(27)	
DESIGN FILE NAME: /B7A007B/DESIGN/DA007NUI.DGN	PLOT DATE: 07-SEP-2000		
IPARM FILE NAME: DA007L08	SURVEY DATE: 6/98		
SURVEYED BY: ORVIS	DRAWN BY: SQUAD B		
SQUAD LEADER: DELLA SANTA	SHEET: 63 OF 370		

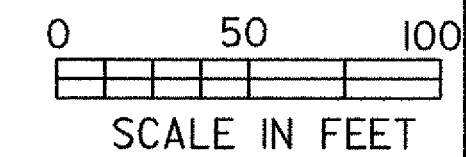

DATUM	
VERTICAL	NAVD88
HORIZONTAL	NAD83(92)

COMBINED