

REMOVAL AND DISPOSAL  
OF GUARD RAIL  
(SOUTHBOUND)  
3365+00 LT - 3381+00 LT  
STEEL BEAM GUARD RAIL  
(SOUTHBOUND)  
3365+00 LT - 3366+00 LT  
3371+50 LT - 3375+00 LT

REMOVAL OF EXISTING FENCE (MOD.)  
STA. 3365+00 SB LT - STA. 3366+75 SB LT  
STA. 3377+00 SB LT  
CHAIN LINK FENCE, 6 FEET  
STA. 3365+00 SB LT - STA. 3366+75 SB LT  
WOVEN WIRE FENCE W/STEEL POSTS  
STA. 3377+00 SB LT

SOUTHBOUND: 8" UNDERDRAIN (MODIFICATION #1)  
19 3365+00 LT - 3367+73 LT  
20 3365+00 RT - 3367+73 RT  
22 3367+78 LT - 3371+97 LT W/FB @ 3367+78 LT  
23 3367+78 RT - 3371+97 RT W/FB @ 3367+78 RT  
25 3372+02 LT - 3377+47 LT W/FB @ 3372+02 LT  
26 3372+02 RT - 3377+47 RT W/FB @ 3372+02 RT  
28 3377+52 RT - 3380+95 RT W/FB @ 3377+52 RT

SOUTHBOUND: 8" UNDERDRAIN CARRIER PIPE  
19A 3367+73 LT W/FB @ 3367+73 LT  
20A 3367+73 RT W/FB @ 3367+73 RT  
22A 3371+97 LT W/FB @ 3371+97 LT  
23A 3371+97 RT W/FB @ 3371+97 RT  
25A 3377+47 LT W/FB @ 3377+47 LT  
26A 3377+47 RT W/FB @ 3377+47 RT  
28A 3380+95 RT W/FB @ 3380+95 RT

SOUTHBOUND: 8" UNDERDRAIN (MODIFICATION #2)  
21 3365+00 RT - 3367+73 RT  
24 3367+78 RT - 3371+97 RT W/FB @ 3367+78 RT  
27 3373+00 RT - 3377+47 RT W/FB @ 3373+00 RT  
29 3377+52 RT - 3380+95 RT W/FB @ 3377+52 RT

MATCH LINE SB STA. 3365+00

MATCH LINE NB STA. 3365+00

MATCH LINE SB STA. 3381+00

MATCH LINE NB STA. 3381+00

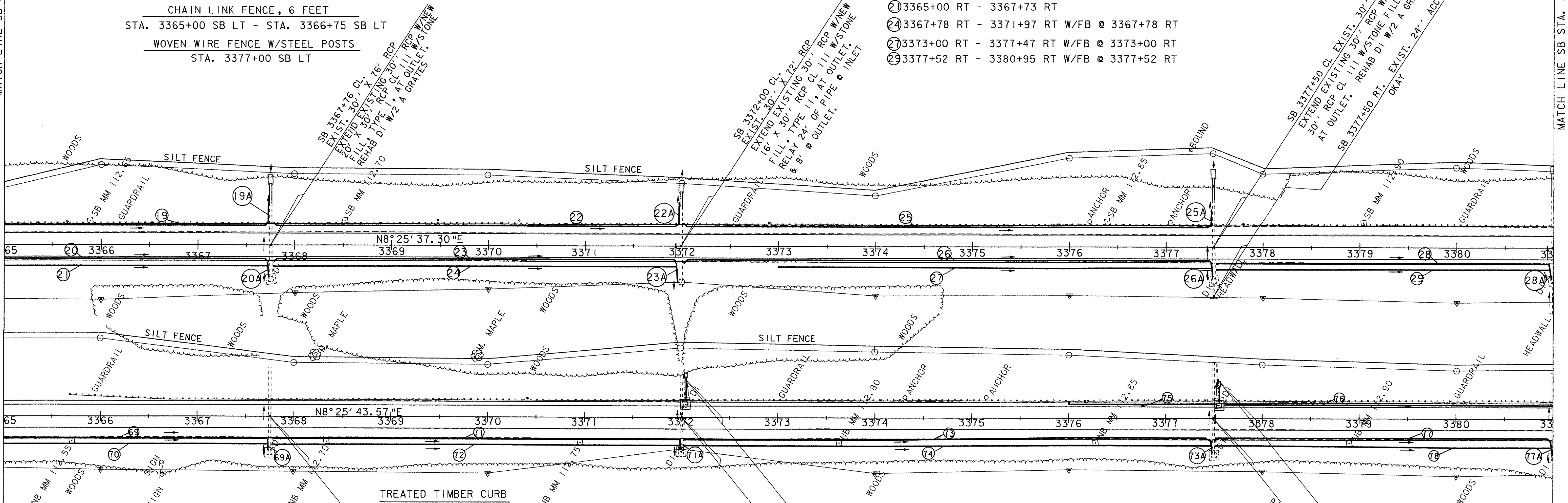

REMOVAL OF EXISTING FENCE (MOD.)  
STA. 3372+00 NB RT  
WOVEN WIRE FENCE W/STEEL POSTS  
STA. 3372+00 NB RT

REMOVAL AND DISPOSAL  
OF GUARD RAIL  
(NORTHBOUND)  
3365+68 LT - 3381+00 LT  
STEEL BEAM GUARD RAIL  
(NORTHBOUND)  
3367+00 LT - 3381+00 LT

TREATED TIMBER CURB  
(NORTHBOUND)  
3367+00 LT - 3381+10 LT

NORTHBOUND: 8" UNDERDRAIN (MODIFICATION #1)  
69 3365+00 RT - 3367+73 RT W/FB @ 3363+53 RT  
71 3367+78 RT - 3371+99 RT W/FB @ 3371+99 RT  
73 3372+03 RT - 3377+48 RT W/FB @ 3372+03 RT  
75 3376+00 LT - 3377+54 LT W/FB @ 3376+00 LT  
76 3377+52 LT - 3381+05 LT W/FB @ 3377+52 LT  
77 3377+52 RT - 3381+00 RT W/FB @ 3377+52 RT

NORTHBOUND: 8" UNDERDRAIN (MODIFICATION #2)  
70 3365+00 RT - 3367+73 RT W/FB @ 3363+53 RT  
72 3367+78 RT - 3371+99 RT W/FB @ 3371+99 RT  
74 3372+03 RT - 3377+48 RT W/FB @ 3372+03 RT  
78 3377+52 RT - 3381+00 RT W/FB @ 3377+52 RT

NORTHBOUND: 8" UNDERDRAIN CARRIER PIPE  
69A 3367+73 RT W/FB @ 3367+73 RT  
71A 3371+99 RT W/FB @ 3371+99 RT  
73A 3377+48 RT W/FB @ 3377+48 RT  
77A 3381+00 RT W/FB @ 3381+00 RT

NB 3372+01 CL. EXIST. 24' X 36' ACCOMP. REHAB D.I. W/B GRATE  
NB 3372+05 LT. EXIST. 12' X 38' CGMP. REPL LACE PIPE W/NEW D.I. RCP CL. 11" W/NEW D.I. W/STONE FILL, OR CPEP. AT OUTLET.

NB 3377+50 CL. EXIST. 30' X 94' ACCOMP. REHAB D.I. W/B GRATES. NB 3377+56 LT. EXIST. 12' X 30' CGMP. REPL LACE PIPE W/NEW D.I. RCP CL. 11" W/NEW D.I. W/STONE FILL, OR CPEP. AT OUTLET.

DATUM	
VERTICAL	NAVD88
HORIZONTAL	NAD83(92)

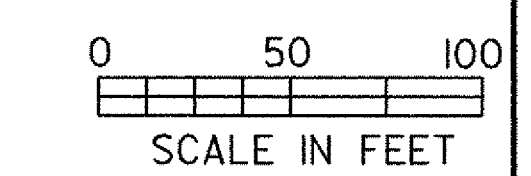

PROJECT: FAIRFAX - FAIRFIELD - ST. ALBANS		PROJECT NO.: IM 089-3(27)
DESIGN FILE NAME: /87A007B/DESIGN/DA007NUI.DGN	PLOT DATE: 18-AUG-2000	
IPARM FILE NAME: DA007LOT	SURVEY DATE: 6/98	
SURVEYED BY: ORVIS	DRAWN BY: SQUAD B	
SQUAD LEADER: DELLA SANTA	SHEET: 61 OF 370	