

TYPICAL WELD TERMINATION AND COPING DETAIL

N.T.S.
 X NO WELD PLACED FOR 1/4" MIN. 1/2" MAX. EXCEPT MUST MAINTAIN 1" MINIMUM FROM EDGE OF FLANGED

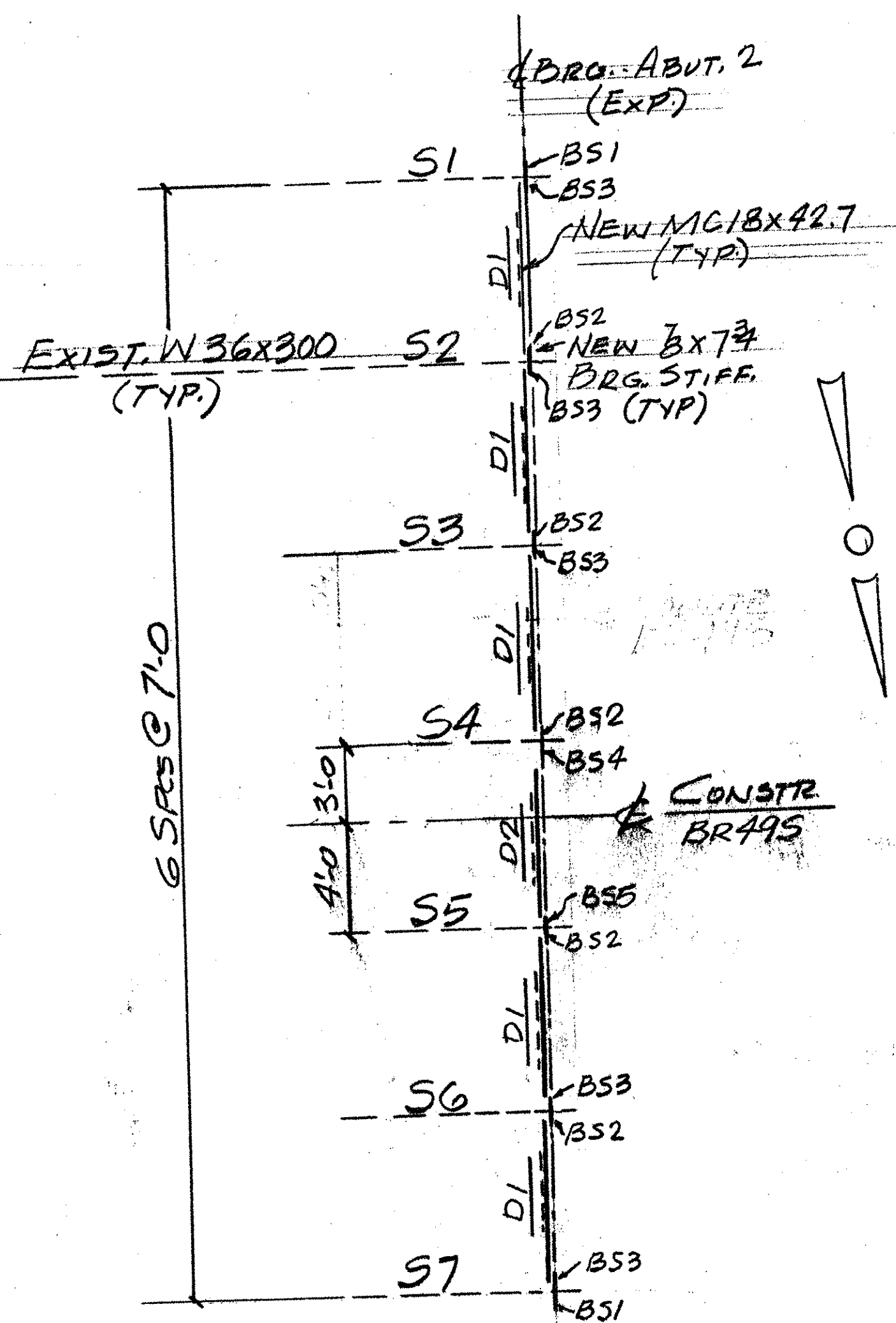

FRAMING PLAN
 @ ABUT. 2
 BRIDGE 495

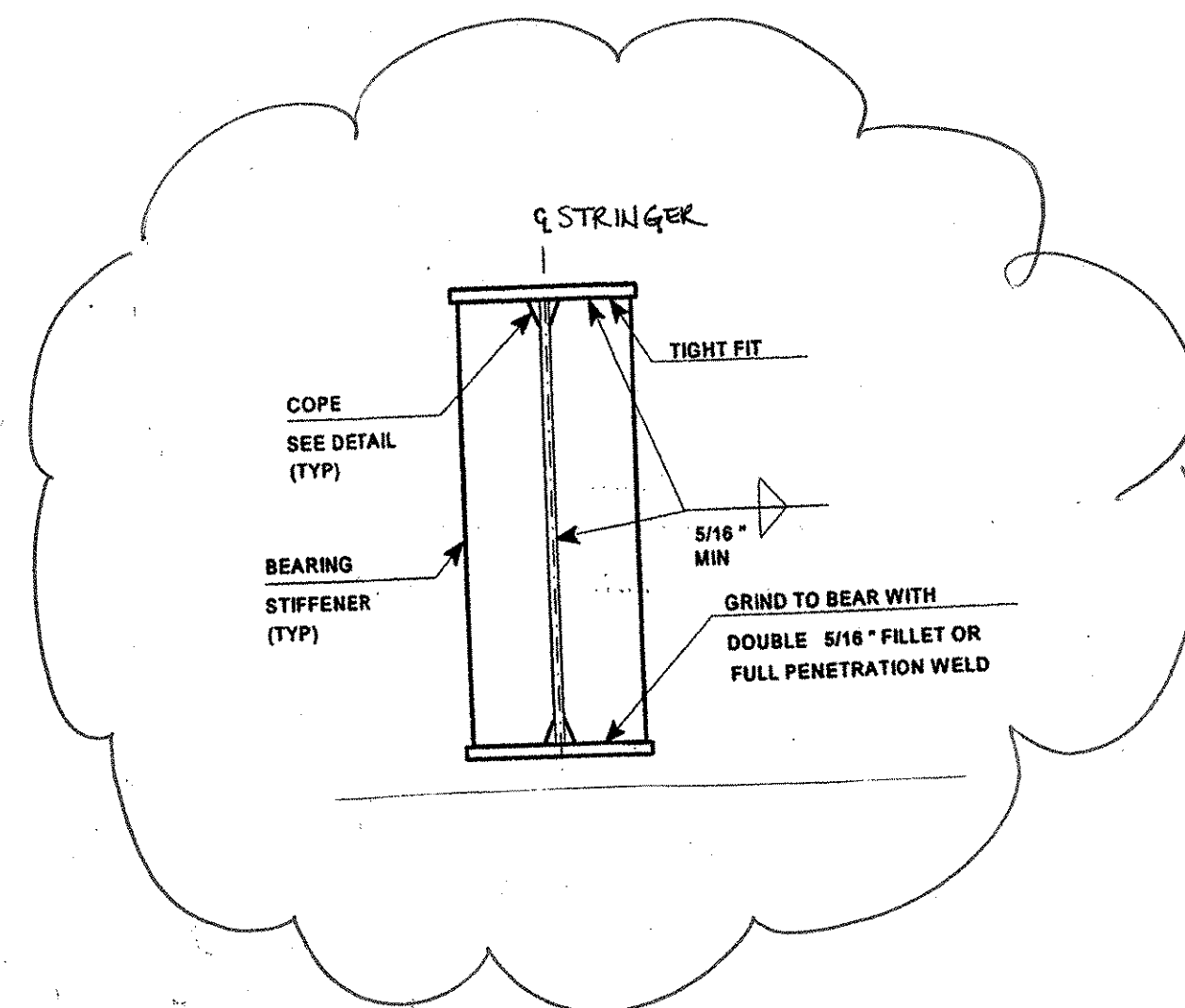
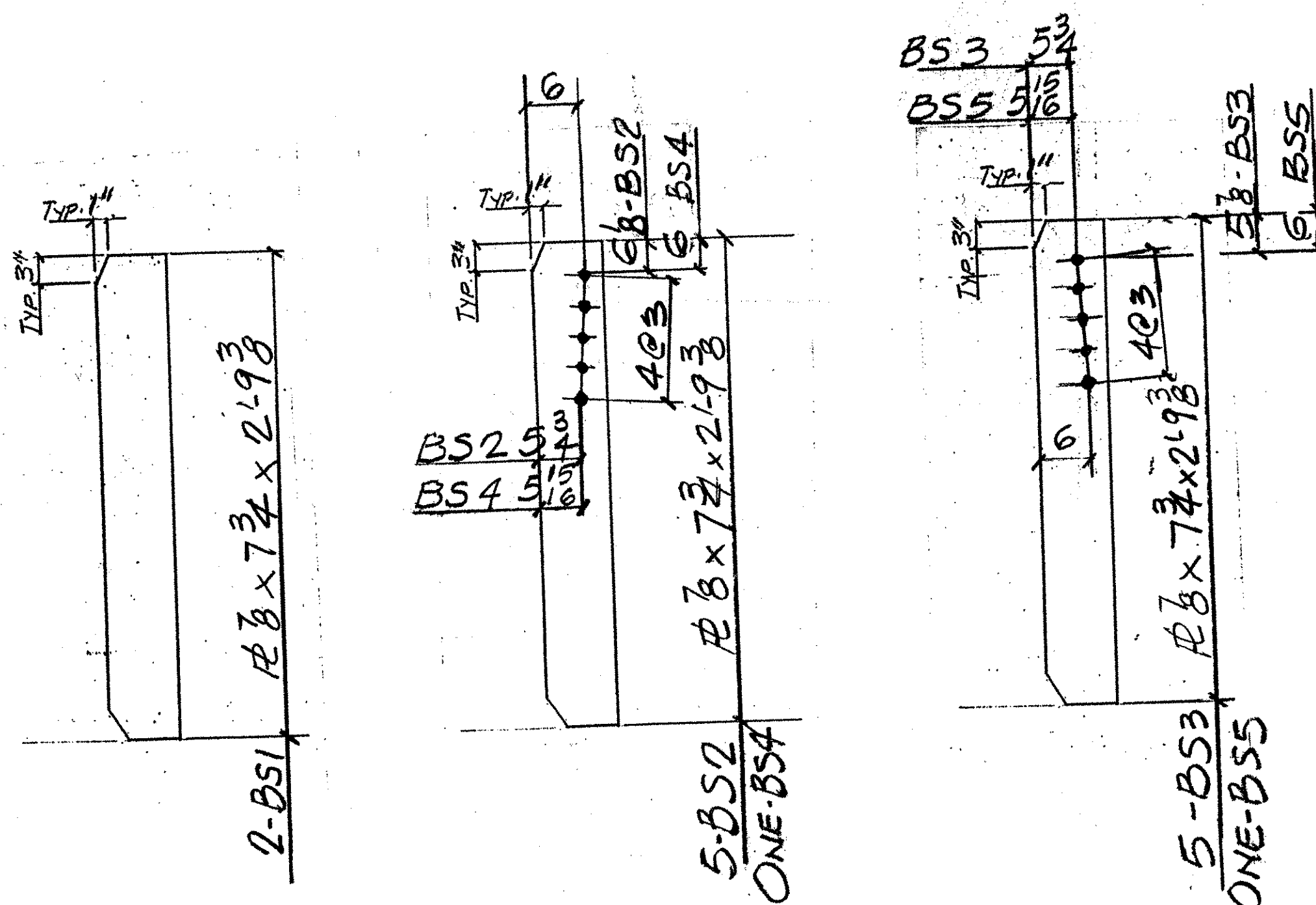
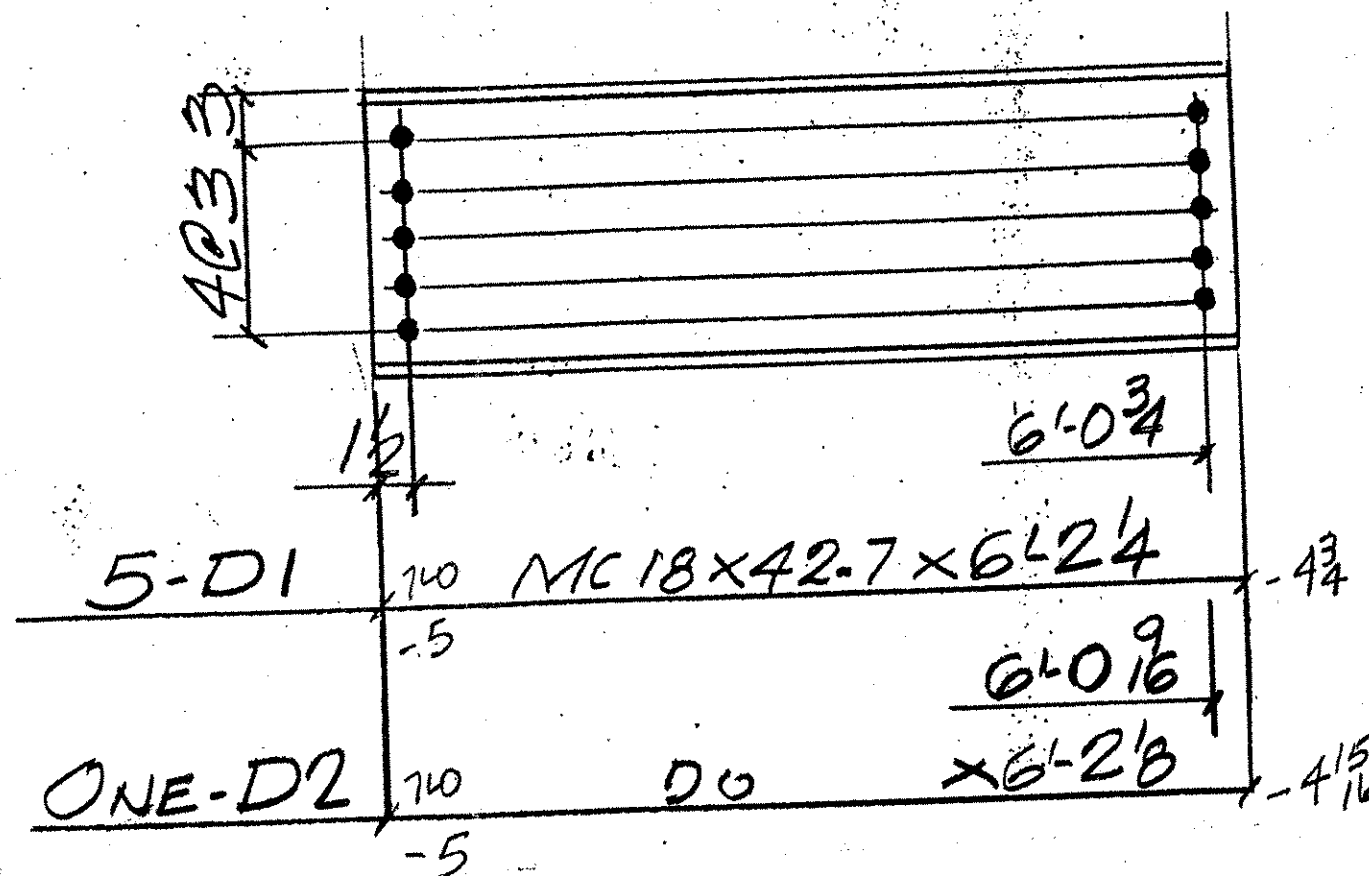

ABM INFO		SHOP BILL				JOB NO. 120-495	DRG. NO. 51-5		
PAGE	LINE	NO.	DESCRIPTION	FT	IN	ASSEM. MARK	SHIPPING MARK	REMARKS	WEIGHT
	5		MC18x42.7	6	24		D1		
	1		DO	6	28		D2		
	2		2Bx7 1/2	2	9 3/8		B51		
	5		DO	2	9 3/8		B52		
	5		DO	2	9 3/8		B53		
	1		DO	2	9 3/8		B54		
	1		DO	2	9 3/8		B55		
	60		3/8" BOLTS	23			FIELD	1305-TYPE 3 1/2 X 1 1/2 W.	

PAY ITEM 506.60

OUT FOR APPROVAL	1201									
OUT FOR APPROVAL	1201									
ISSUED TO SHOP										
FIELD & OFFICE										
REV. REMARKS	DATE	DWN	CHK	APP	QA	NO.	DIA.	LGT	TYPE	WASHER
PROJECT NO. IM-089-2(26) STATE BRIDGE NO. 495										
MATERIAL: AASHTO M270-50W ELECTRODES: — HOLES: 1/8" SHOP BOLTS: —										
SURFACE PREP. & PAINT: NO PAINT										
DESCRIPTION: BRG. STIFFS & DIAPHRAGMS	DRAWN BY	DATE								
JOB: BRIDGE 495	JPF	12-00								
IB9-SB-OVERTH7	CHKD BY	EJ								
MIDDLESEX-BOLTON, VT.	APPROV BY									
CUSTOMER: WINTERSET INC.										
CASCO BAY STEEL STRUCTURES, INC.	JOB NO.	DRG. NO.								
75 SPRING HILL ROAD SACO, MAINE 04072	120-495	51-5								
PHONE (207) 282-7360 FAX. (207) 282-1179	REV.	△								

TVGA
 Engineering, Surveying, P.C.
 NO EXCEPTIONS TAKEN REJECTED
 FURNISH AS CORRECTED
 REVISE AND RESUBMIT
 ENGINEER has reviewed Shop Drawings and Samples and conformance with the information given in the Contract Documents and compliance with the design concept of the completed Project as a functioning whole as indicated in the Contract Documents. Such reviews do not extend to matters of methods, techniques, sequences or procedures of construction or to safety precautions and programs incident thereto. Contractor is responsible for dimensions to be confirmed and controlled at the job site; for information that pertains solely to the fabrication processes or to techniques of construction and for coordination of the work of all trades.
 BY: JFW/SJ
 DATE: 2/26/01