

S.P.R. DIV. NO.	STATE	PROJECT NO.	SHEET NO.	TOTAL SHEETS
1	VT.	I-89-2(7)	111	295

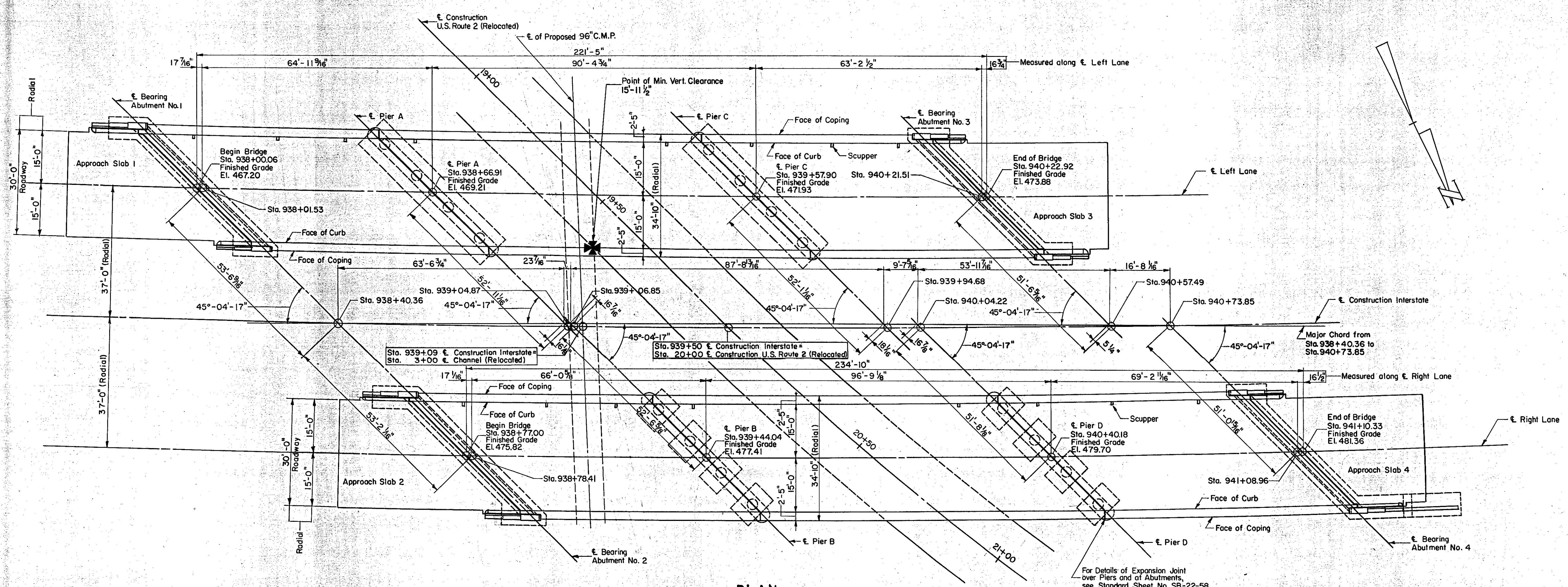

PLAN
Scale: 1/16" = 1'-0"

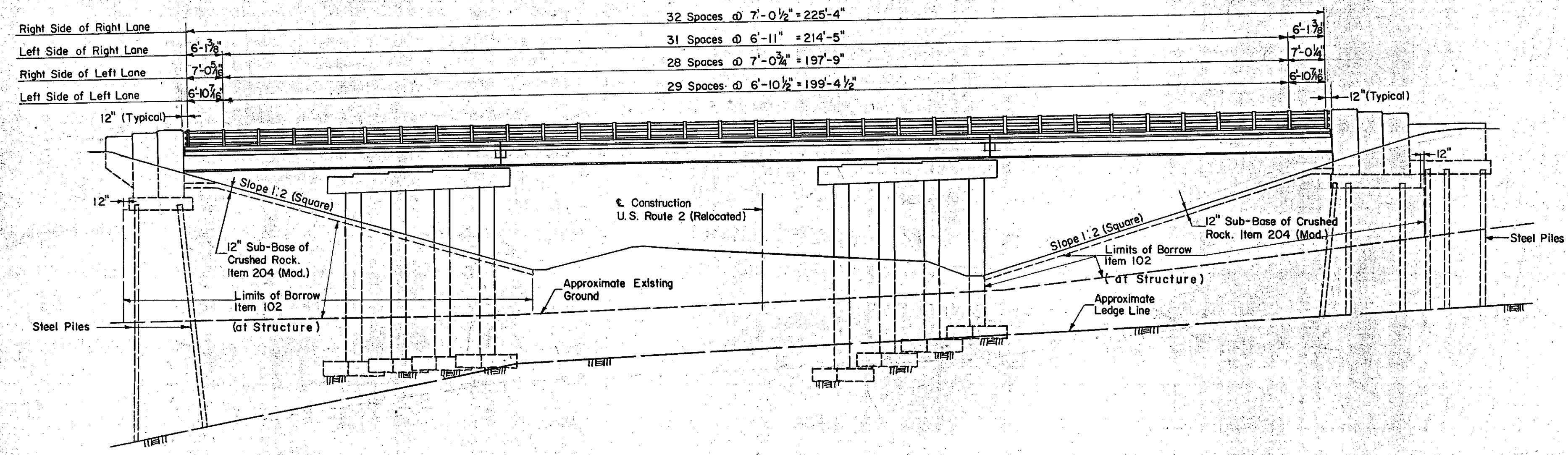

NORTHERLY ELEVATION
Scale: 1/16" = 1'-0"

- Notes:
1. Railing Posts to be set normal to Grade.
 2. Omit set screws at upgrade end of railing panels at Expansion Joints over Piers.
 3. All stations refer to € Construction Interstate.
 4. All dimensions are horizontal dimensions.
 5. For Scupper layout, see Framing Plan Sheet No. 119.
 6. For details of railing, see Standard Sheet No. SB-56-57.
 7. For Bridge Deck Construction, see Standard Sheet No. SB-22-58 (Detail A).

BR 50 N & S

CONTRACT NO. 2

PLAN AND ELEVATION

STATE OF VERMONT
DEPARTMENT OF HIGHWAYS
INTERSTATE PROJECT in the town of
WATERBURY
INTERSTATE OVER STA. 939+50
U.S. ROUTE 2 (RELOC.) OVER STA. 20+00

THE CLARKESON ENGINEERING CO., INC.
CONSULTING ENGINEERS
BOSTON MASSACHUSETTS
SURVEYED BY: S.A.L. CHECKED BY: J.B. & D.S. SCALE: AS NOTED
DRAWN BY: S.A.L. IN CHARGE: J.V.B. DATE: 6-19-58

PROJECT NO. I-89-2(7) SHEET 247 OF 307

ESTIMATED QUANTITIES

ITEM NO.	DESCRIPTION	UNIT	SUPERSTRUCTURE		
			NET	OVER-RUN	TOTAL FINAL
102	Borrow	C. Y.	2400	2400	21435
556-C	Granite Bridge Curb (Type I)	L. F.	1004	-	1004
572	Bridge Railing	L. F.	885	-	883