

# GENERAL NOTES

## SPECIFICATIONS

### CONSTRUCTION:

- VERMONT AGENCY OF TRANSPORTATION 2006 STANDARD SPECIFICATION FOR HIGHWAY AND BRIDGE CONSTRUCTION & LATEST REVISION.
- AASHTO STANDARD BRIDGE DESIGN SPECIFICATIONS FOR HIGHWAY BRIDGES, 2002 EDITION, WITH LATEST REVISIONS.
- WELDING - ANSI/AASHTO/AWS BRIDGE WELDING CODE D1.5 (LATEST EDITION)

## MATERIALS

ALL STRUCTURAL STEEL SHALL COMPLY WITH AASHTO M270, GRADE 50W, UNPAINTED WEATHERING REQUIREMENTS UNLESS NOTED OTHERWISE.

ALL MATERIAL SHALL BE DOMESTIC.

## FABRICATION

V- INDICATES CHARPY V-NOTCH TESTED (ZONE 2) PER STD. SPECS. SUBSECTION 714.01

HEAT NUMBERS SHALL BE PRESERVED AND VISIBLE TO THE INSPECTOR.

### BEARING AREAS IDENTIFIED ON SHOP DRAWINGS:

THE BOTTOM FLANGE OF GIRDERS AT THE BEARINGS SHALL BE SHOP STRAIGHTENED AS REQUIRED TO PROVIDE UNIFORM CONTACT BETWEEN THE GIRDER FLANGE AND THE BEARINGS AT THE BRIDGE SEAT.

THERE SHALL BE NO PAINT, CRAYON, OR CHALK MARKS ON THE STEEL EXCEPT WHERE NOTED "PAINTED".

FIELD SPLICES SHALL BE SHOP ASSEMBLED, AND THE HOLES IN THE WEB & FLANGES SHALL BE DRILLED FROM THE SOLID USING THE OUTSIDE SPLICE PLATES AS TEMPLATES.

(R) DENOTES RADIOGRAPHIC INSPECTION REQUIRED AT BUTT SPLICE WELDS.

(T) DENOTES WELD SUBJECT TO TENSION STRESSES.

### IDENTIFICATION MARKING STEEL MEMBERS

#### SUBSECTION 506.16

IDENTIFICATION MARKS MAY BE PAINTED ON MEMBERS THAT WILL RECEIVE FIELD COATS OF PAINT. IDENTIFICATION MARKS ON UN-PAINTED STEEL SHALL BE IMPRESSED INTO THE MEMBER (WITH A LOW STRESS STAMP) IN A NON-STRESSED OR LOW STRESSED AREA OF THE MEMBER.

## ERECTION NOTES

### UN-PAINTED AREAS:

7/8" HEAVY HEX HEAD HIGH STRENGTH BOLTS (A325-3) WITH ONE HARDENED WASHER (F436-3) ARE PROVIDED FOR THIS PROJECT. NUTS SHALL BE A563, GR DH3.

### PAINTED AREAS:

7/8" HEAVY HEX HEAD HIGH STRENGTH BOLTS (A325-1) MECH GALV WITH ONE HARDENED WASHER (F436-1) ARE PROVIDED FOR THIS PROJECT. NUTS SHALL BE A563, GR DH.

PLACE WASHER UNDER THE TURNED ELEMENT.

FIELD WELDS ARE NOT BY CAROLINA STEEL GROUP, LLC.

## SHOP PAINTING

### SURFACE PREPARATION

SSPC-SP10 (NEAR WHITE BLAST CLEANING). PRIOR TO BLAST CLEANING, ALL OIL, GREASE OR OTHER FOREIGN MATTER SHALL BE REMOVED BY SOLVENT CLEANING (SSPC-SP1).

### PAINT APPLICATION

SHOP PAINTING SHALL BE DONE IN ACCORDANCE WITH THE STANDARD SPECIFICATIONS, SUBSECTION 513.

ALL STRUCTURAL STEEL WITHIN 7 FEET OF END OF GIRDER AT EXPANSION END OF THE BRIDGE, SHALL BE COATED WITH A (3) COAT PROTECTIVE PAINT SYSTEM, UNLESS OTHERWISE SHOWN ON SHOP DRAWINGS AND/OR AS ILLUSTRATED IN THE PAINT SKETCH BELOW.

SHOP APPLICATION OF PAINT SHALL BE PER MANUFACTURER'S RECOMMENDATIONS.

△ INTERMEDIATE AND TOP COATS TO BE STAGGERED A MINIMUM OF 1/2" FROM THE FAYING SURFACES AND EACH OTHER.

(3) COAT SHOP APPLIED PROTECTIVE PAINT SYSTEM: PER STANDARD SPECIFICATIONS, SUBSECTION 708

EPOXY PAINT SHALL BE ONE OF THE EPOXY PAINT ON THE APPROVED PRODUCTS LIST ON FILE WITH THE AGENCY'S MATERIALS AND RESEARCH SECTION.

PRIMER COAT - EPOXY PRIMER - ~~CARBONZINC II HS~~ CARBOZINC 859 ZR △  
 INTERMEDIATE COAT - EPOXY - ~~CARBOLGUARD 893~~ CARBOGUARD 888 △  
 TOP COAT - ALIPHATIC POLYURETHANE - CARBOthane 133 HB  
 COLOR TO BE DARK BROWN, FEDERAL COLOR CHIP No .20059 TO BLEND WITH THE WEATHERING STEEL.

PAINT MANUFACTURER: CARBOLINE

### PAINT NOTE "A"

MIST COAT OF PRIMER (1.5 MILS DFT) FOR THE TOP SURFACE OF GIRDERS TOP FLANGE AND END DIAPHRAGMS.

### PAINT NOTE "B"

MIST COAT OF PRIMER ON EDGES AND THE BOTTOM SURFACE OF BOTTOM FLANGE FOR BEARING AREAS DIMENSIONED ON SHOP DRAWINGS.

### PAINT NOTE "C"

HATCHED AREAS SHOWN ON DETAIL DRAWINGS ARE BOUNDARIES OF THE FIELD BOLTED CONTACT SURFACES AND SHALL BE GIVEN THE PRIME COAT ONLY.

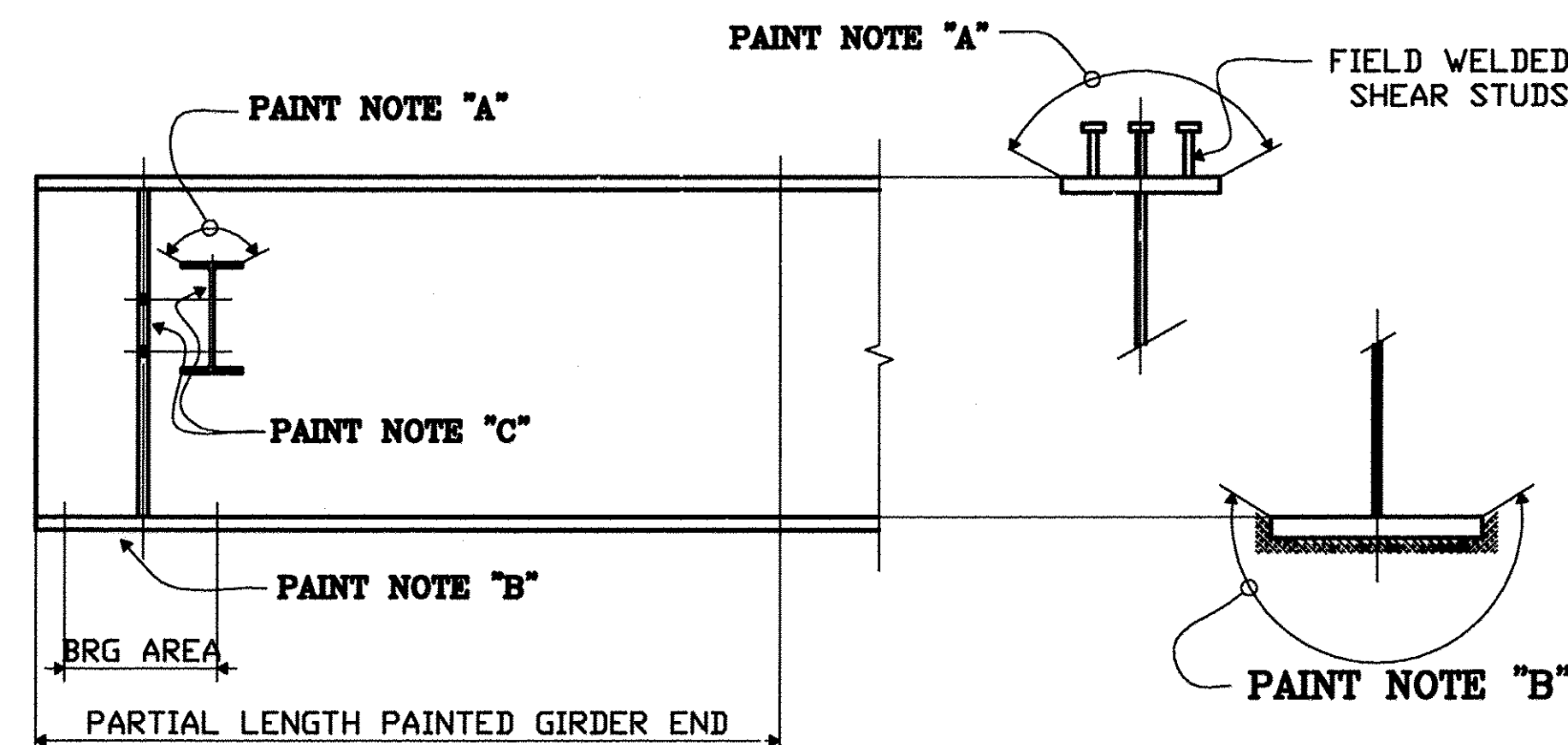

PAINT ILLUSTRATION SKETCH

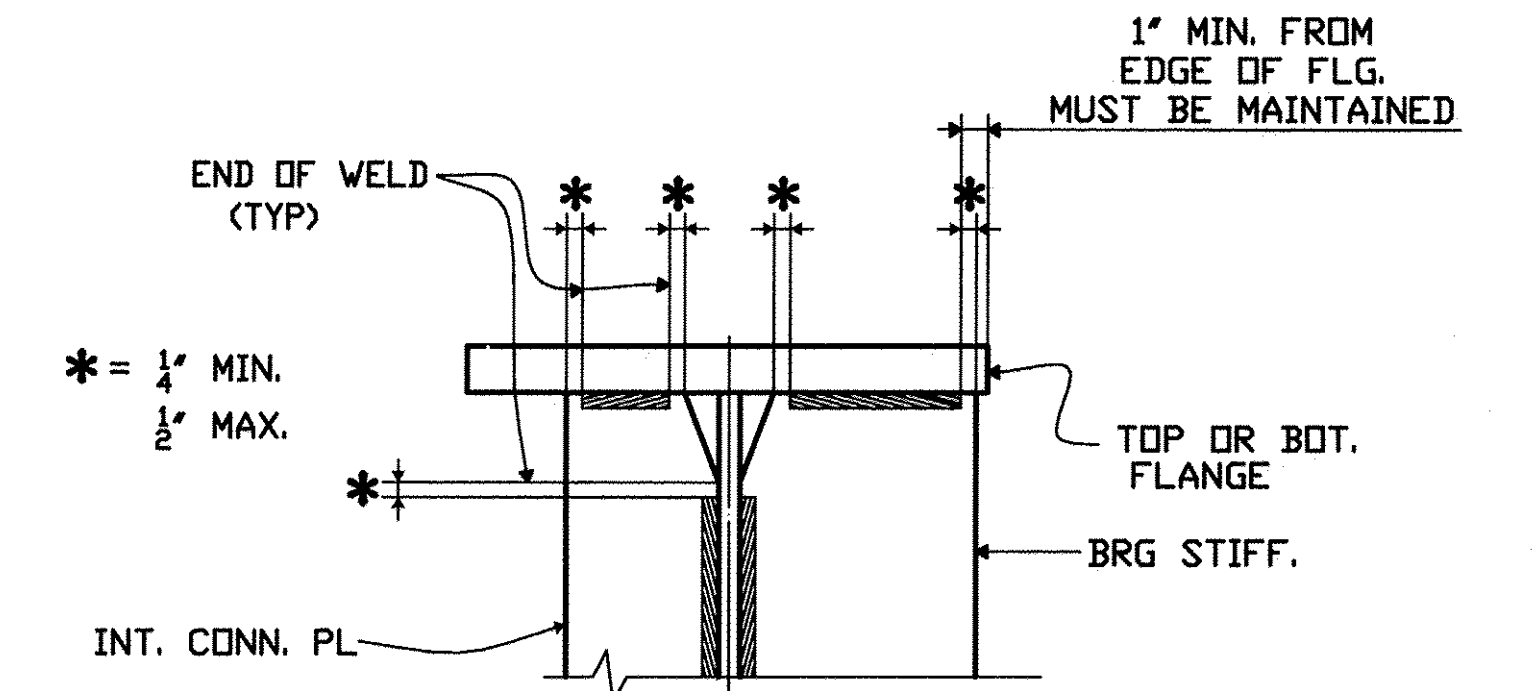

STIFFENER WELD TERMINATION DETAIL

## TVGA CONSULTANTS

NO EXCEPTIONS TAKEN  REJECTED  
 FURNISH AS CORRECTED  
 REVISE AND RESUBMIT  
 ENGINEER has reviewed Shop Drawings and Samples and other data which Contractor is required to submit, only for conformance with the information given in the Contract Documents and compliance with the design portion of the complete Project as a functioning whole as embodied in the Contract Documents. Such review does not extend to means, methods, techniques, sequences or procedures of construction or to safety precautions and programs incident thereto. Such review is not a substitute for any LEED certification or accreditation. Contractor is responsible for dimensions to be confirmed and controlled at the job site for information that pertains solely to the fabrication processes or to techniques of construction, and for coordination of the work of all trades.  
 BY: *And Led*  
 DATE: 12/1/2009

PROJECT No: ACIM 091-1(33)  
 STA. 22+47.71 TO STA. 25+05.93  
 BRIDGE No. 3S (SOUTHBOUND)  
 TOWN OF GUILDFORD

FABRICATED BY	NASH	ORDER NO.	08-18537H32
HOLES	SHOP FASTENERS	DETAILS OF	GENERAL NOTES
SHOP PAINT		PROJECT	I-91 OVER BROAD BROOK AND BROAD BROOK ROAD
SHOP INSPECTION		LOCATION	WINDHAM COUNTY, VT
GENERAL NOTES		CUSTOMER	MEC CONSTRUCTION
			CAROLINA STEEL GROUP, LLC.
DATE	NO.	BY	REVISIONS
04/07/09	R1	PDC/SB	REVISED PAINT SYSTEM.
07/06/09	R2	PDC/SB	DELETED PAINT STAGGERING NOTE
MADE BY	GM	CHECKED BY	PDC/SB
SOUND LEADER	Presse Manufacturing Co. Inc.	DATE	09-08
		SHEET	HN101