

JUNCTION BOX

JUNCTION BOX 1

PULL BOX (MOD) - REMOVAL

- PULL BOX 1
- PULL BOX 2
- PULL BOX 3
- PULL BOX 4
- PULL BOX 5

WIRED CONDUIT (MOD) (2" PVC, WITH 3-#6 COPPER AND 1 #6 COPPER GROUND)

- METER ON BLDG TO PULL BOX 6
- PULL BOX 6 TO POLE #13
- POLE #13 TO POLE #3

WIRED CONDUIT (MOD) (2" PVC, WITH 3- #8 COPPER AND 1- #6 COPPER GROUND)

- PULL BOX 6 TO POLE #14
- POLE #3 TO POLE #4
- POLE #4 TO POLE #5
- POLE #5 TO POLE #6
- POLE #6 TO POLE #7
- POLE #7 TO POLE #8
- POLE #3 TO POLE #2
- POLE #2 TO POLE #1
- POLE #3 TO POLE #9
- POLE #9 TO POLE #10
- POLE #10 TO POLE #11
- POLE #11 TO POLE #12

ELECTRICAL CONDUIT SLEEVE (6" PVC)

- ACROSS SIDE ROADWAY (POLE #13 TO POLE #3)
- ACROSS FRONT ROADWAY (POLE #3 TO POLE #9)

REMOVE AND RESET CURB

TO BE USED WITH ELECTRICAL CONDUIT SLEEVE, AS REQD

STREET LIGHTING LOCATIONS													
POLE NO.	INSTALL NEW T-BASE	LIGHT POLE TAG	HAND HOLE COVER	NEW LAMP REQ'D	REMOVE/ RESET POLE	ELECT WIRING	NEW LUMINAIRE REQ'D	REMOVE POLE & BASE	EXIST. BREAK-AWAY	EXIST. LUMINAIRE WATTS TYPE	EXIST. MOUNT HEIGHT	NEW CONC. BASE	REMARKS
	679.23	679.21 MOD 3	679.21 MOD 2	679.50 MOD	679.25	678.24	679.50	679.25 MOD				679.21 MOD 1	
1	X				X	X	X		NONE	150 W. HPS	30	X	INSTALL NEW 100 W LUM TO REPLACE EXIST 150 W
2				X	X	X			NONE	100 W. HPS	30	X	NEW BASE ELEV. TO BE APPROX. 15" HIGHER THAN EXISTING, TRAF COUNT STAND & LOOP LOC NEARBY, IF DAMAGED CONTRACTOR TO REPAIR AT HIS EXPENSE
3		X		X	X	X			T-BASE	100 W. HPS	30	X	NEW BASE ELEVATION TO BE APPROX. 6" HIGHER THAN EXISTING REPLACE NON FUNCTIONING PHOTO CELL
4				X	X	X			NONE	150 W. HPS	30	X	NEW BASE ELEV. TO BE APPROX. 4" HIGHER THAN EXISTING
5				X	X	X			NONE	150 W. HPS	30	X	NEW BASE ELEV. TO BE APPROX. 12" HIGHER THAN EXISTING
6				X	X	X			NONE	150 W. HPS	30	X	NEW BASE ELEV. TO BE APPROX. 12" HIGHER THAN EXISTING
7				X	X	X			NONE	100 W. HPS	30	X	NEW BASE ELEV. TO BE APPROX. 12" HIGHER THAN EXISTING
8		X			X	X	X		T-BASE	150 W. HPS	30	X	NEW BASE ELEVATION TO BE APPROX. 12" HIGHER THAN EXISTING, INSTALL NEW 100W LUMINAIRE TO REPLACE EXISTING 150W, NEW TAG TO SHOW 100W
9			X	X	X	X			NONE	150 W. HPS	30	X	NEW BASE ELEV. TO BE APPROX. 10" HIGHER THAN EXISTING
10			X	X	X	X			NONE	150 W. HPS	30	X	NEW BASE ELEV. TO BE APPROX. 12" HIGHER THAN EXISTING
11				X	X	X			NONE	150 W. HPS	30	X	NEW BASE ELEV. TO BE APPROX. 12" HIGHER THAN EXISTING
12				X	X	X			NONE	150 W. HPS	30	X	NEW BASE ELEV. TO BE APPROX. 12" HIGHER THAN EXISTING
13		X		X	X	X			NONE	250 W. HPS	30	X	NEW BASE ELEVATION TO BE APPROX. 6" HIGHER THAN EXISTING REPLACE EXISTING TAG WITH NEW SHOWING 250W LUMINAIRE
14		X		X	X	X			NONE	250 W. HPS	30	X	NEW BASE ELEVATION TO BE APPROX. 10" HIGHER THAN EXISTING REPLACE EXISTING TAG WITH NEW SHOWING 250W LUMINAIRE

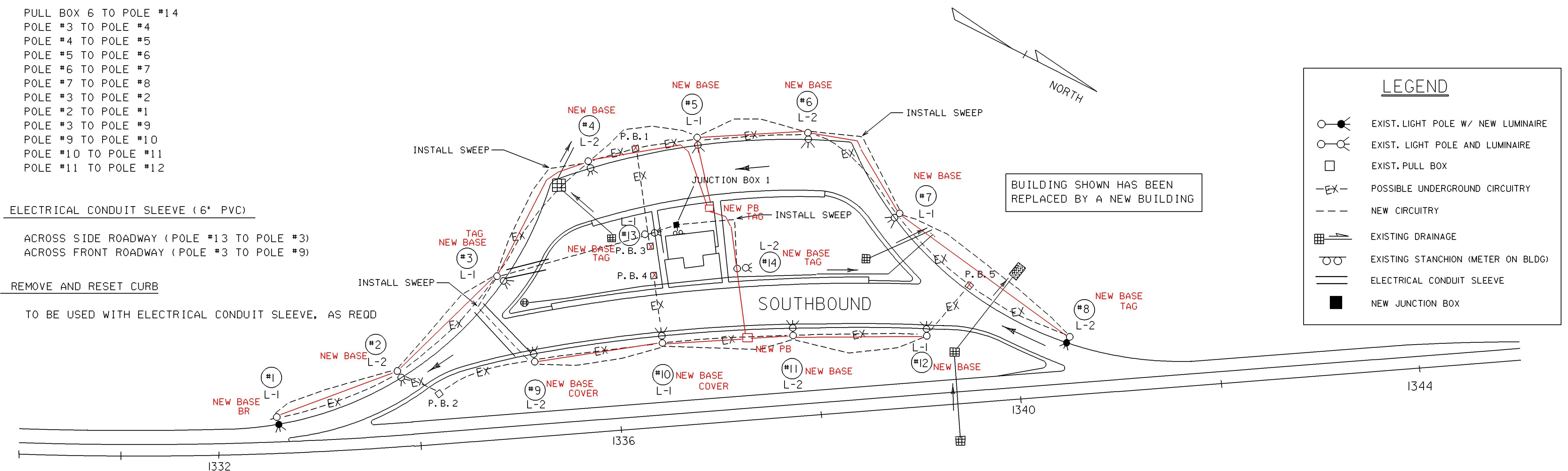

NOTES

1. THE LOCATION OF EXISTING CONDUIT IS UNKNOWN IN THE AREA OF THE BUILDING. THEREFORE, WORK SHALL PROCEED IN THE FOLLOWING MANNER AT THIS LOCATION:
 - A. THE CONTRACTOR SHALL DETERMINE WHETHER THE CONDUIT IN THE AREA OF THE BUILDING IS PVC OR STEEL. (THIS MAY BE ACCOMPLISHED BY EXCAVATION AROUND POLE 13 AND 14.) NO EXTRA PAYMENT WILL BE MADE FOR THIS DETERMINATION.
 - I. IF STEEL, THE CONTRACTOR SHALL REPLACE CONDUIT AS PER PLAN.
 - II. IF PVC, THE CONTRACTOR SHALL PERFORM AN INSULATION TEST AS PER SHEET 12 OF THESE PLANS AND SECTION 679.08 OF THE VAOT STANDARD SPECIFICATIONS.
 - A. IF TEST SHOWS THAT CONDUIT IS IN POOR CONDITION, THE CONTRACTOR SHALL REPLACE CONDUIT AS PER PLAN.
 - B. IF TEST SHOWS THAT CONDUIT IS IN GOOD CONDITION, AND INSPECTION OF CONDUIT AND WIRE APPEARANCE IS SATISFACTORY, THE EXISTING CONDUIT MAY BE RETAINED, AT THE ENGINEERS DISCRETION.
2. PULLBOX 3 AND 4 COULD NOT BE LOCATED DURING FIELD INSPECTION. THEREFORE IT IS UNKNOWN WHERE THE CONDUIT IS LOCATED THAT SERVES THE OUTLYING LIGHTING. REGARDLESS, THE NEW CONDUIT, AS DESIGNED, SHOULD PROVIDE AN ADEQUATE SOLUTION. SEE "PULLBOXES" ON SHEET 12 FOR FURTHER GUIDANCE.

LEGEND

- EXIST. LIGHT POLE W/ NEW LUMINAIRE
- EXIST. LIGHT POLE AND LUMINAIRE
- EXIST. PULL BOX
- POSSIBLE UNDERGROUND CIRCUITRY
- NEW CIRCUITRY
- EXISTING DRAINAGE
- EXISTING STANCHION (METER ON BLDG)
- ELECTRICAL CONDUIT SLEEVE
- NEW JUNCTION BOX

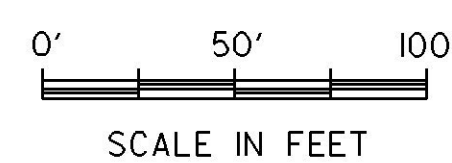

ARCHIVED ON CADD

SITE 8
LYNDON REST AREA, I-91

PREPARED BY RPD DATE 9-94
 MODIFIED BY EGF/P.G.J DATE 4/97
 DESIGN SUPERVISOR ARK DATE
 PROJ.

STATEWIDE IM LITE (6)

TRAFFIC SHEET NO. OF
 SHEET 10 OF 37 SHEETS

\\traf\940290\10290.dgn\1029001
 PLOTTED:05-01-2004