

FLASHING BEACON (MOD 1)  
STANCHION NEAR POWER POLE

WIRED CONDUIT (2 1/2" PVC, WIRING AS REQUIRED BY POWER COMPANY)  
POWER SOURCE (SOUTH) TO NEW STANCHION (SOUTH)

WIRED CONDUIT (MOD) (2" PVC, WITH 3- #8 COPPER AND 1- #6 COPPER GROUND)

ELECTRICAL CONDUIT SLEEVE (6" PVC)

PULL BOX (MOD) - REMOVAL

NEW STANCHION (SOUTH) TO PULL BOX 1  
PULL BOX 1 TO POLE #9  
STANCHION PULL BOX 1 TO POLE #8  
POLE #8 TO POLE #7  
POLE #9 POLE #7 TO POLE #10  
POLE #7 TO POLE #6  
STANCHION (NORTH) TO POLE #2  
STANCHION POLE #2 TO POLE #1 PB #1  
PB #1 POLE #2 TO POLE #4  
POLE #2 TO POLE #3  
POLE #3 TO POLE #5 PB  
PB #1 TO POLE #1  
POLE #2 TO POLE #5  
S.B. 1-91

STANCHION  
ACROSS US 302 (PULL BOX 1 TO POLE #9)  
ACROSS RAMP A (POLE #8 TO POLE #7)  
ACROSS US 302 (POLE #7 TO POLE #10)  
~~ACROSS US 302 (POLE #2 TO POLE #1 AND POLE #2 TO POLE #4)~~  
ACROSS RAMP C (POLE #2 TO POLE #4)  
ACROSS RAMP D (POLE #3 TO POLE #5)  
ACROSS US 302 TO STANCHION TO PB#1

~~PULL BOX 2~~  
✓ PULL BOX 3  
✓ PULL BOX 4  
✓ PULL BOX 5  
✓ PULL BOX 6  
~~PULL BOX 7~~

REMOVE AND RESET CURB

TO BE USED WITH ELECTRICAL CONDUIT SLEEVE, AS REQD

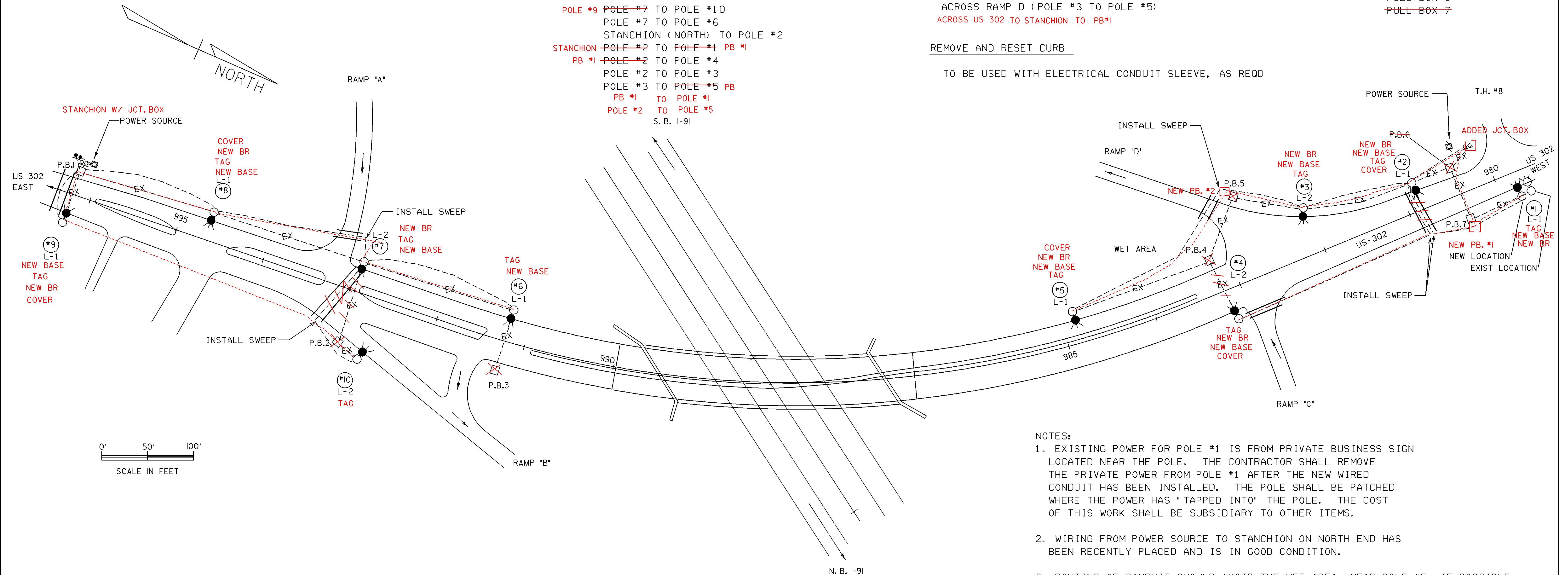

NOTES:

- EXISTING POWER FOR POLE #1 IS FROM PRIVATE BUSINESS SIGN LOCATED NEAR THE POLE. THE CONTRACTOR SHALL REMOVE THE PRIVATE POWER FROM POLE #1 AFTER THE NEW WIRED CONDUIT HAS BEEN INSTALLED. THE POLE SHALL BE PATCHED WHERE THE POWER HAS "TAPPED INTO" THE POLE. THE COST OF THIS WORK SHALL BE SUBSIDIARY TO OTHER ITEMS.
- WIRING FROM POWER SOURCE TO STANCHION ON NORTH END HAS BEEN RECENTLY PLACED AND IS IN GOOD CONDITION.
- ROUTING OF CONDUIT SHOULD AVOID THE WET AREA, NEAR POLE #5, IF POSSIBLE.

STREET LIGHTING LOCATIONS

POLE NO.	INSTALL NEW T-BASE	LIGHT POLE TAG	HAND HOLE COVER	NEW LAMP REQ'D	REMOVE/RESET POLE	ELECT WIRING	NEW LUMINAIRE REQ'D	REMOVE POLE & BASE	EXIST. BREAK-AWAY	NEW LUMINAIRE WATTS TYPE	EXIST. MOUNT HEIGHT	NEW CONC. BASE	REMARKS
	679.23	679.21 MOD 3	679.21 MOD 2	679.50 MOD	679.25	678.24	679.50	679.25 MOD				679.21 MOD 1	
1	X ✓	X ✓			X ✓	X ✓	X ✓		COUP	150 W. HPS	30	X ✓	NEW BASE TO BE POURED 15 FT SOUTH (EAST) OF EXISTING.
2	X ✓	X ✓	X ✓		X ✓	X ✓	X ✓		NONE	150 W. HPS	30	X ✓	NEW BASE ELEV. TO BE APPROX. 10" HIGHER THAN EXISTING
3	X ✓	X ✓			X ✓	X ✓	X ✓		NONE	150 W. HPS	30	X ✓	NEW BASE ELEV. TO BE APPROX. 8" HIGHER THAN EXISTING
4	X ✓	X ✓	X ✓		X ✓	X ✓	X ✓		NONE	150 W. HPS	30	X ✓	NEW BASE ELEV. TO BE APPROX. 8" HIGHER THAN EXISTING
5	X ✓	X ✓	X ✓		X ✓	X ✓	X ✓		NONE	150 W. HPS	30	X ✓	NEW BASE ELEV. TO BE APPROX. 6" HIGHER THAN EXISTING
6		X ✓			X ✓	X ✓	X ✓		NONE	150 W. HPS	30	X ✓	NEW BASE ELEV. TO BE APPROX. 6" HIGHER THAN EXISTING
7	X ✓	X ✓			X ✓	X ✓	X ✓		NONE	150 W. HPS	30	X ✓	NEW BASE ELEV. TO BE APPROX. 6" HIGHER THAN EXISTING
8	X ✓	X ✓	X ✓		X ✓	X ✓	X ✓		NONE	150 W. HPS	30	X ✓	NEW BASE ELEV. TO BE APPROX. 6" HIGHER THAN EXISTING
9	X ✓	X ✓	X ✓		X ✓	X ✓	X ✓		NONE	150 W. HPS	30	X ✓	NEW BASE ELEV. TO BE APPROX. 6" HIGHER THAN EXISTING
10		X ✓			X	X	X ✓		T-BASE	150 W. HPS	30	X	

LEGEND

- EXIST. LIGHT POLE AND LUMINAIRE
- EXIST. LIGHT POLE W/ NEW LUMINAIRE
- EXIST. PULL BOX
- EXIST. UNDERGROUND CIRCUITRY
- NEW CIRCUITRY
- EXIST. STANCHION
- NEW STANCHION
- EXIST. UTILITY POLE
- ELECTRICAL CONDUIT SLEEVE

**ARCHIVED ON CADD**

SITE 5  
NEWBURY (WELLS RIVER), EXIT #17, I-91

PREPARED BY R.P.D. DATE 9-94  
MODIFIED BY EGF/P.G.J. DATE 4/97  
DESIGN SUPERVISOR ARK DATE  
PROJ.

STATEWIDE IM LITE (6)

TRAFFIC SHEET NO. 7 OF 37 SHEETS