

**LEGEND**

	EXIST. LIGHT POLE W/ NEW LUMINAIRE
	EXIST. UTILITY POLE
	EXIST. PULL BOX
	POSSIBLE UNDERGROUND CIRCUITRY
	NEW CIRCUITRY
	ELECTRICAL CONDUIT SLEEVE
	NEW STANCHION

**NOTES:**

1. CONDUIT RUN FROM POLE #2 TO PULL BOX #3 SHALL BE PLACED UNDER THE EXISTING SIDEWALK. REMOVAL OF SIDEWALK TO BE PAID BY SOLID ROCK EXCAVATION (MOD). REMOVAL OF SIDEWALK SUBBASE (6' DEPTH) TO BE PAID BY COMMON EXCAVATION. ~~SIDEWALK TO BE REPLACED BY 6 INCHES OF SUBBASE AND 5 INCHES OF CONCRETE SIDEWALK. ESTIMATED ITEMS ARE PROVIDED FOR THESE.~~ **BITUMINOUS CONCRETE SIDEWALK**
2. CONDUIT RUN FROM POLE #5 TO POLE #7 SHALL RUN BETWEEN SIDEWALK AND CURB, THUS AVOIDING THE EXISTING SHRUBBERY.
3. WHERE ELECTRICAL CONDUIT SLEEVE IS TO BE PLACED, IT WILL BE NECESSARY TO REMOVE AND RESET CURB, AS WELL AS REMOVE AND REPLACE SIDEWALK. ESTIMATED ITEMS ARE PROVIDED FOR THESE. SEE NOTE 1 ABOVE AND "CONDUIT" SECTION OF GENERAL NOTES (SHEET 12).
4. ~~PULL BOX 1 IS RAISED ABOUT 5 INCHES. FILL AROUND PULL BOX WITH GRANULAR BORROW AND 2' OF TOPSOIL. NEW PULL BOX~~
5. DO NOT PLACE CONDUIT IN CONDUIT SLEEVE ACROSS DRIVES.

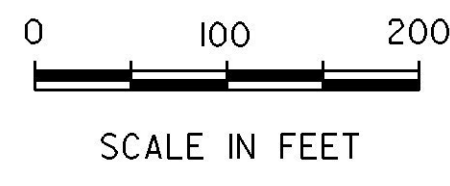
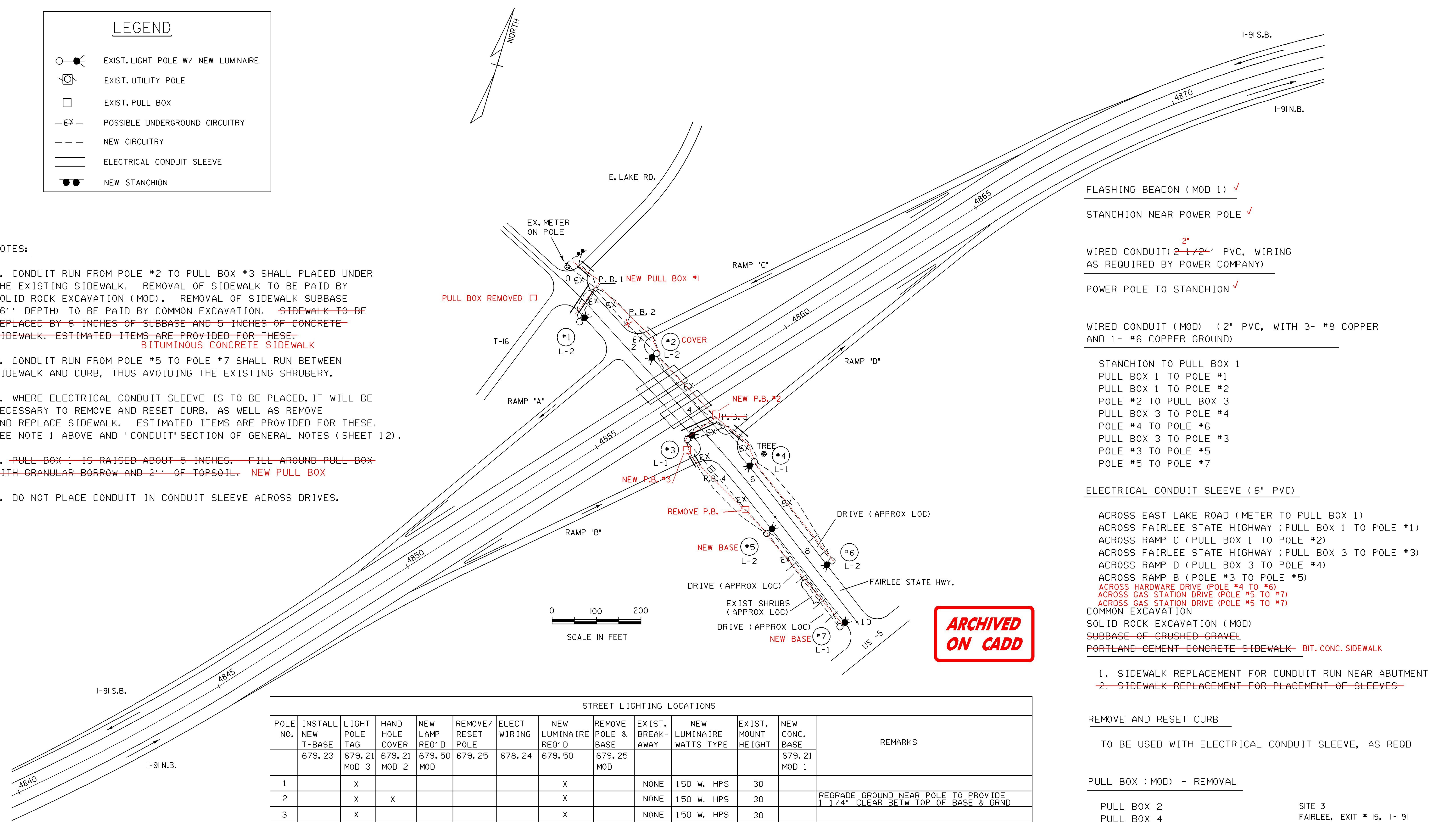

**ARCHIVED ON CADD**

- FLASHING BEACON (MOD 1) ✓
- STANCHION NEAR POWER POLE ✓
- WIRED CONDUIT (2" PVC, WIRING AS REQUIRED BY POWER COMPANY)
- POWER POLE TO STANCHION ✓
- WIRED CONDUIT (MOD) (2" PVC, WITH 3- #8 COPPER AND 1- #6 COPPER GROUND)
- STANCHION TO PULL BOX 1
- PULL BOX 1 TO POLE #1
- PULL BOX 1 TO POLE #2
- POLE #2 TO PULL BOX 3
- PULL BOX 3 TO POLE #4
- POLE #4 TO POLE #6
- PULL BOX 3 TO POLE #3
- POLE #3 TO POLE #5
- POLE #5 TO POLE #7
- ELECTRICAL CONDUIT SLEEVE (6" PVC)
- ACROSS EAST LAKE ROAD (METER TO PULL BOX 1)
- ACROSS FAIRLEE STATE HIGHWAY (PULL BOX 1 TO POLE #1)
- ACROSS RAMP C (PULL BOX 1 TO POLE #2)
- ACROSS FAIRLEE STATE HIGHWAY (PULL BOX 3 TO POLE #3)
- ACROSS RAMP D (PULL BOX 3 TO POLE #4)
- ACROSS RAMP B (POLE #3 TO POLE #5)
- ACROSS HARDWARE DRIVE (POLE #4 TO #6)
- ACROSS GAS STATION DRIVE (POLE #5 TO #7)
- ACROSS GAS STATION DRIVE (POLE #5 TO #7)
- COMMON EXCAVATION
- SOLID ROCK EXCAVATION (MOD)
- SUBBASE OF CRUSHED GRAVEL
- PORTLAND CEMENT CONCRETE SIDEWALK - BIT. CONC. SIDEWALK

1. SIDEWALK REPLACEMENT FOR CONDUIT RUN NEAR ABUTMENT
  2. SIDEWALK REPLACEMENT FOR PLACEMENT OF SLEEVES
- REMOVE AND RESET CURB
- TO BE USED WITH ELECTRICAL CONDUIT SLEEVE, AS REQD

**PULL BOX (MOD) - REMOVAL**

- PULL BOX 2
- PULL BOX 4
- PULL BOX # 1
- PULL BOX # 3
- PULL BOX 0+000 RT
- PULL BOX 6+75 RT

SITE 3  
FAIRLEE, EXIT # 15, I-91

PREPARED BY R.P.D. DATE 9-94  
MODIFIED BY EGF/PGJ DATE 4/97  
DESIGN SUPERVISOR ARK DATE  
PROJ.

STATEWIDE IM LITE (6)

TRAFFIC SHEET NO. 5 OF 37 SHEETS

STREET LIGHTING LOCATIONS													
POLE NO.	INSTALL NEW T-BASE	LIGHT POLE TAG	HAND HOLE COVER	NEW LAMP REQ'D	REMOVE/ RESET POLE	ELECT WIRING	NEW LUMINAIRE REQ'D	REMOVE POLE & BASE	EXIST. BREAK-AWAY	NEW LUMINAIRE WATTS TYPE	EXIST. MOUNT HEIGHT	NEW CONC. BASE	REMARKS
	679.23	679.21 MOD 3	679.21 MOD 2	679.50 MOD	679.25	678.24	679.50	679.25 MOD		150 w. HPS	30	679.21 MOD 1	
1		X					X		NONE	150 w. HPS	30		
2		X	X				X		NONE	150 w. HPS	30		REGRADE GROUND NEAR POLE TO PROVIDE 1 1/4" CLEAR BETW TOP OF BASE & GRND
3		X					X		NONE	150 w. HPS	30		
4		X					X		NONE	150 w. HPS	30		FENCE AND MAILBOX LOCATED NEARBY. CONTRACTOR TO REPAIR ANY DAMAGE AT OWN EXP.
5		X			X	X	X		NONE	150 w. HPS	30	X	NEW BASE ELEV. TO BE APPROX. 4" HIGHER THAN EXISTING
6		X					X		NONE	150 w. HPS	30		
7		X			X	X	X		NONE	150 w. HPS	30	X	NEW BASE ELEV. TO BE APPROX. 10" HIGHER THAN EXISTING

11/01/94/250/10230.dgn/1029051  
PLOTED 05-JAN-2003