

STREET LIGHTING LOCATIONS									
POLE NO.	LOCATION	OFF-SET	LENGTH OF POLE ARM	WALL THICK	BREAK-AWAY	LUMINAIRE WATTS TYPE	MOUNT HEIGHT	CONC. BASE	REMARKS
✓ 1	452+75	+26'	26' 6'	.188	T-BASE	150 W HPS	30'	30' X 6'	ALL NEW INSTALLATION
✓ 2	454+15	+26'	26' 6'	.188	T-BASE	150 W HPS	30'	30' X 6'	ALL NEW INSTALLATION

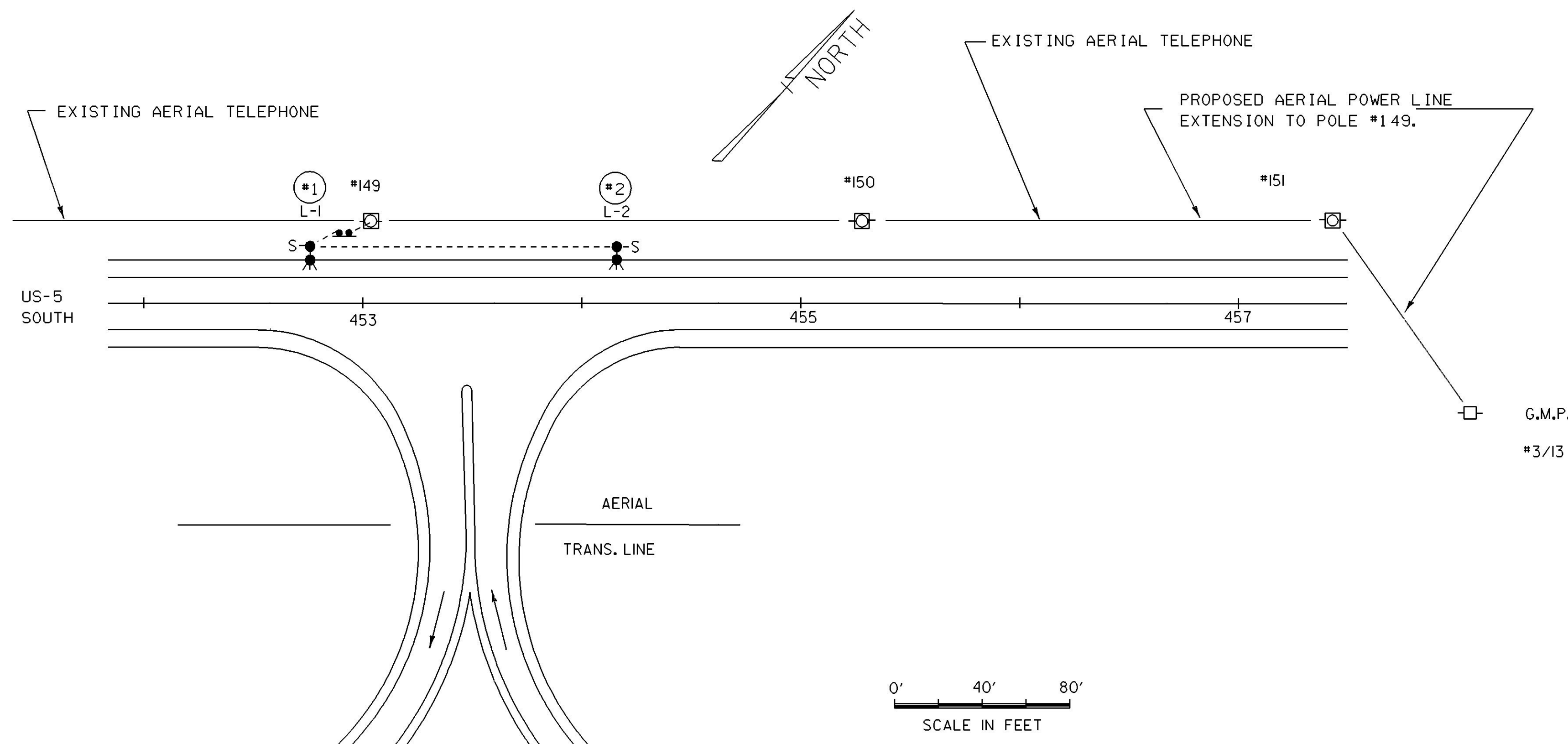

THE CONTRACTOR SHALL PERFORM THE FOLLOWING WORK AT THIS LOCATION

- PERFORM AN INSULATION TEST ON ALL CONDUCTORS EXCEPT THE GROUND CONDUCTOR (INCLUDING NEUTRAL, DISCONNECT FROM GROUND BEFORE TESTING). PERFORM A RESISTANCE TO GROUND TEST AT SPECIFIED GROUNDS, SEE VERMONT STANDARD SPECIFICATIONS 679.08. FURNISH THE RESIDENT ENGINEER THE READINGS OBTAINED FROM THE ABOVE TESTS. SEE SHEET #12 FOR ADDITIONAL INFORMATION ON INSULATION TEST.
- INSTALL TWO NEW CONCRETE LIGHT POLE BASES WITH STAINLESS STEEL ANCHOR BOLTS, NUTS AND WASHERS (FLAT AND LOCK), TWO ALUMINUM POLES, LUMINAIRE ARMS, LUMINAIRES, BREAKAWAY FEATURES, (TRANSFORMER BASES), WIRING, WATERPROOF DISCONNECT KITS AND CONDUIT SWEEPS. (SEE SHEET #12).
- CONCRETE BASE ELEVATION TO BE EQUAL TO EDGE OF SHOULDER ELEVATION. SEE TYPICAL BREAKAWAY INSTALLATION DETAIL ON SHEET 12
- INSTALL METAL TAGS TO THE LIGHT POLES WITH THE INFORMATION AS NOTED AND DETAILED ON THE PLANS (SEE SHEET 12).
- INSTALL (OR PROVIDE TO GMP) POLE RISER CONDUIT, WEATHERHEAD OR CONDULATOR AND ALL NECESSARY WIRING AND HARDWARE ON POLE #149.
- INSTALL STANCHION WITH DISCONNECT ONLY (NO METER).

FLASHING BEACON (MOD 2) ✓
STANCHION NEAR GMP #149

ELECTRICAL CONDUIT (2" PVC) ✓
SWEEP AT POLE #1
SWEEP AT POLE #2

WIRED CONDUIT (2" PVC, WIRING AS REQUIRED BY POWER COMPANY) ✓
GMP #149 TO STANCHION

WIRED CONDUIT (2" PVC, WITH 3- #8 COPPER AND 1- #6 COPPER GROUND) ✓
STANCHION TO POLE #1
POLE #1 TO POLE #2

POWER SOURCE NOTE

GREEN MOUNTAIN POWER CORP. TO PROVIDE A 120 / 240 VOLT, SINGLE PHASE UNMETERED POWER SUPPLY AT POLE #149.

THE CONTACT PERSON FOR GREEN MOUNTAIN POWER CORP. IN BELLOWS FALLS IS DAVID COMSTOCK, FIELD SERVICES ASSOCIATE, PHONE (802) 463-3120.

MONTHLY CHARGES FOR THE STREET LIGHTS SHALL BE BILLED TO THE, DISTRICT TRANSPORTATION ADMINISTRATOR, ALLAN REMICK, PO BOX 8236, NORTH BRATTLEBORO, VT. 05304.

LEGEND	
	NEW LIGHT POLE W/ NEW LUMINAIRE
	EXIST. UTILITY POLE
	EXIST. UTILITY POLE, COMBINATION
	EXIST. TELEPHONE POLE
	NEW UNDERGROUND CIRCUITRY
	SWEEP WITH PLUG
	NEW STANCHION

ARCHIVED ON CADD

SITE 1
PUTNEY, EXIT #4, 1-91

PREPARED BY RPD DATE 9-94
MODIFIED BY EGF/PGJ DATE 4/97
DESIGN SUPERVISOR ARK DATE _____
PROJ.

STATEWIDE IM LITE (6)

TRAFFIC SHEET NO. _____ OF _____
SHEET 3 OF 37 SHEETS

Plotting information and scale: /tr01/940290/10290.dgn/1029031 PLOTTED: 05-JUL-2001